

## Citroën C4 (B7) / DS4 / DS5

Partnr.: CT-051-D1U

- Fitting instructions electric wiring kit tow bar with 13-P socket up to DIN/ISO Norm 11446.
- We would expressly point out that assembly not carried out properly by a competent installer will result in cancellation of any right to damage compensation, in particular those arising by virtue of the product liability act.
- Contents of these kits and their fitting manuals are subject to alteration without notice, please ensure that these instructions are read and fully understood before commencing installation.
- Do not overload circuits; the maximum loads per connection are detailed in this manual.
- Attention! Before Installation, please read this manual carefully and inform your customer to consult the vehicle owners manual to check for any vehicle modifications required before towing.
- In the event of functional problems, troubleshooting must be limited to about 0.5 hours, contact the technical support:  
[ukts@ecs-electronics.com](mailto:ukts@ecs-electronics.com) / 07440 202 052.



# Part list

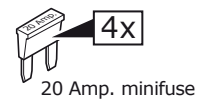
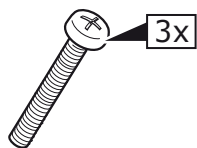
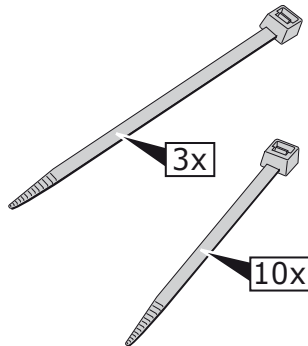
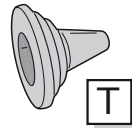
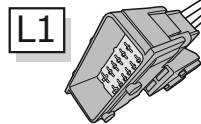
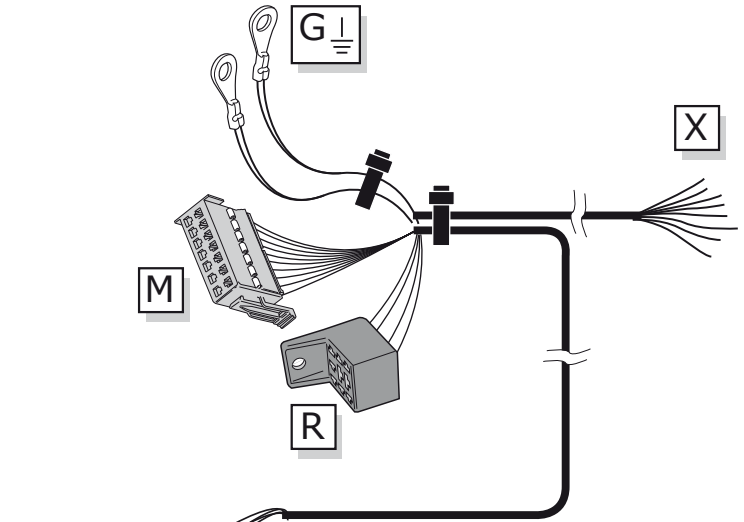
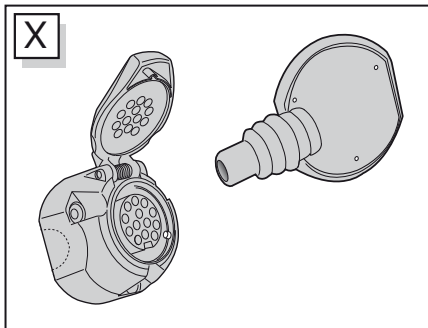
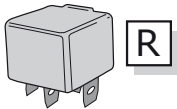
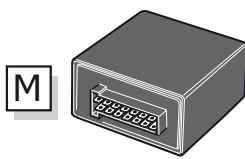
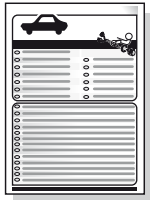
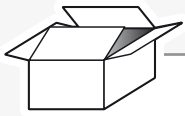

Citroën C4

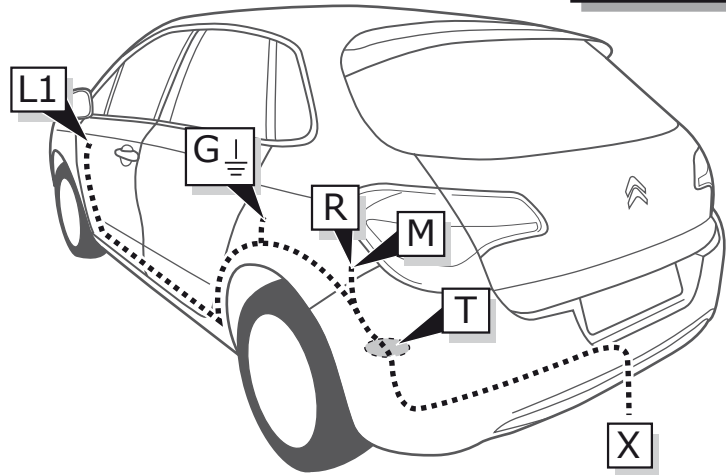

Citroën DS4

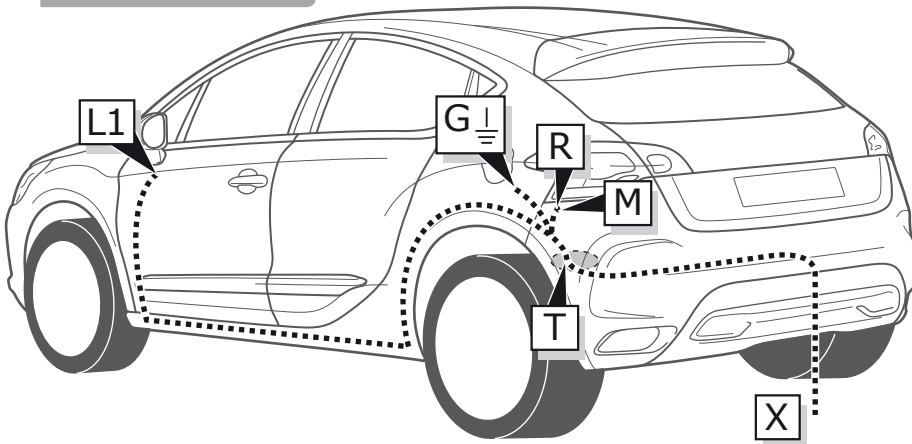

Citroën DS5

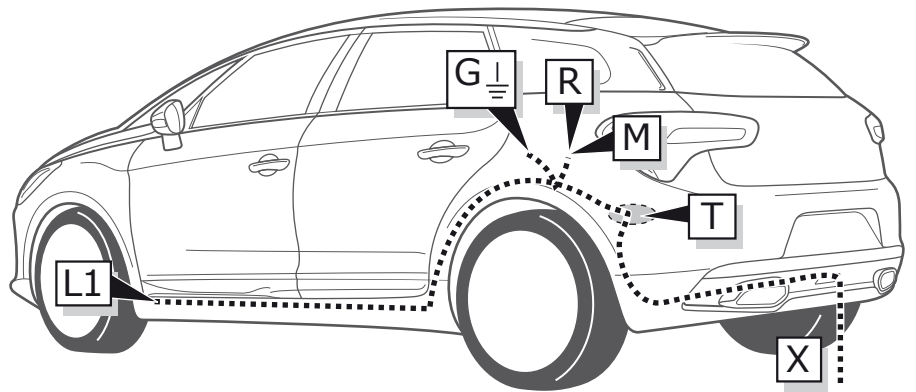

1

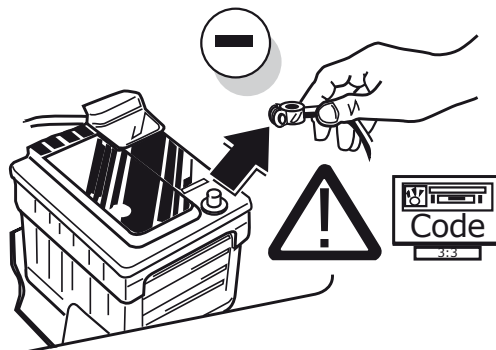

2

### Citroën C4 / DS4

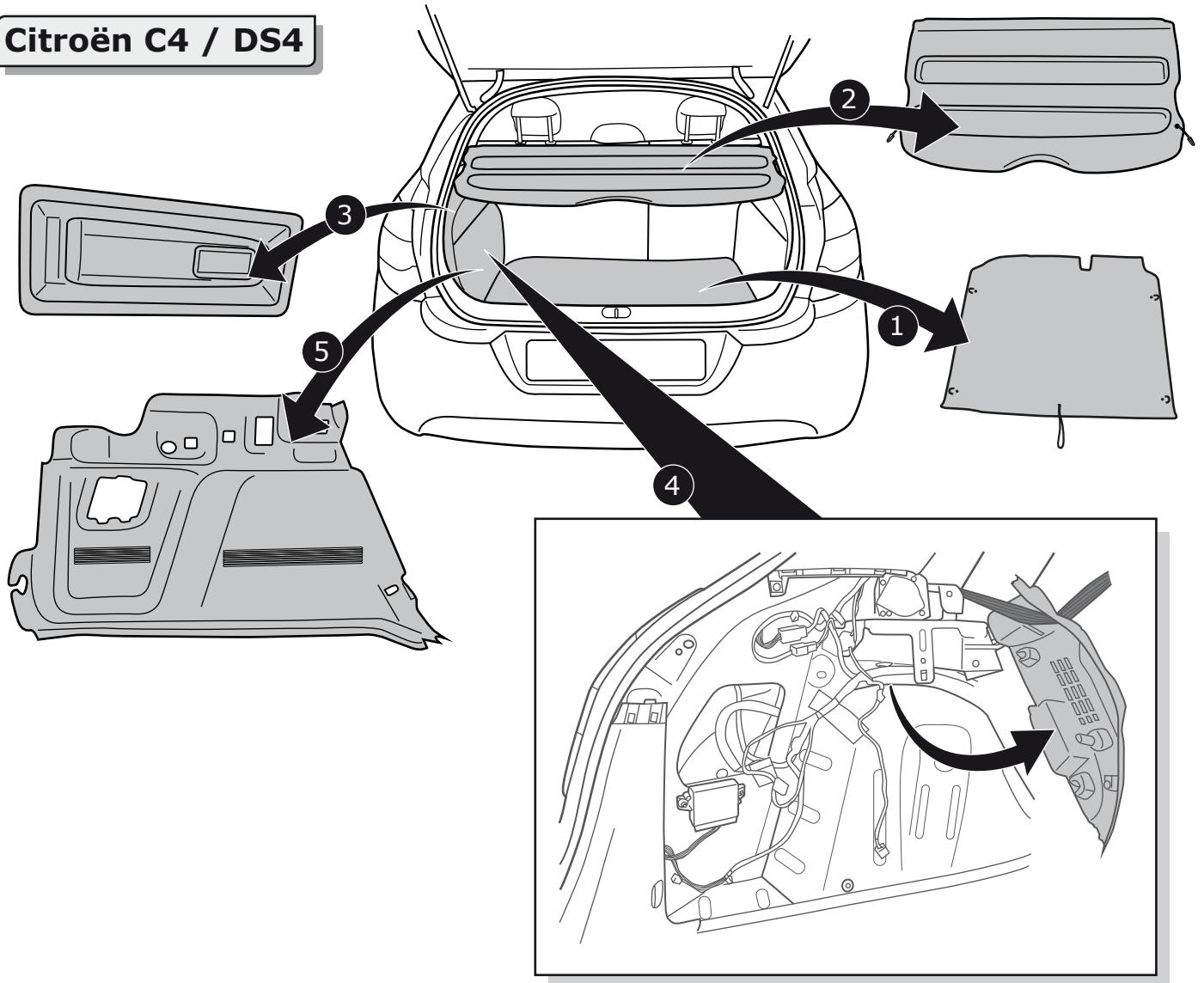

3

### Citroën C4 / DS4

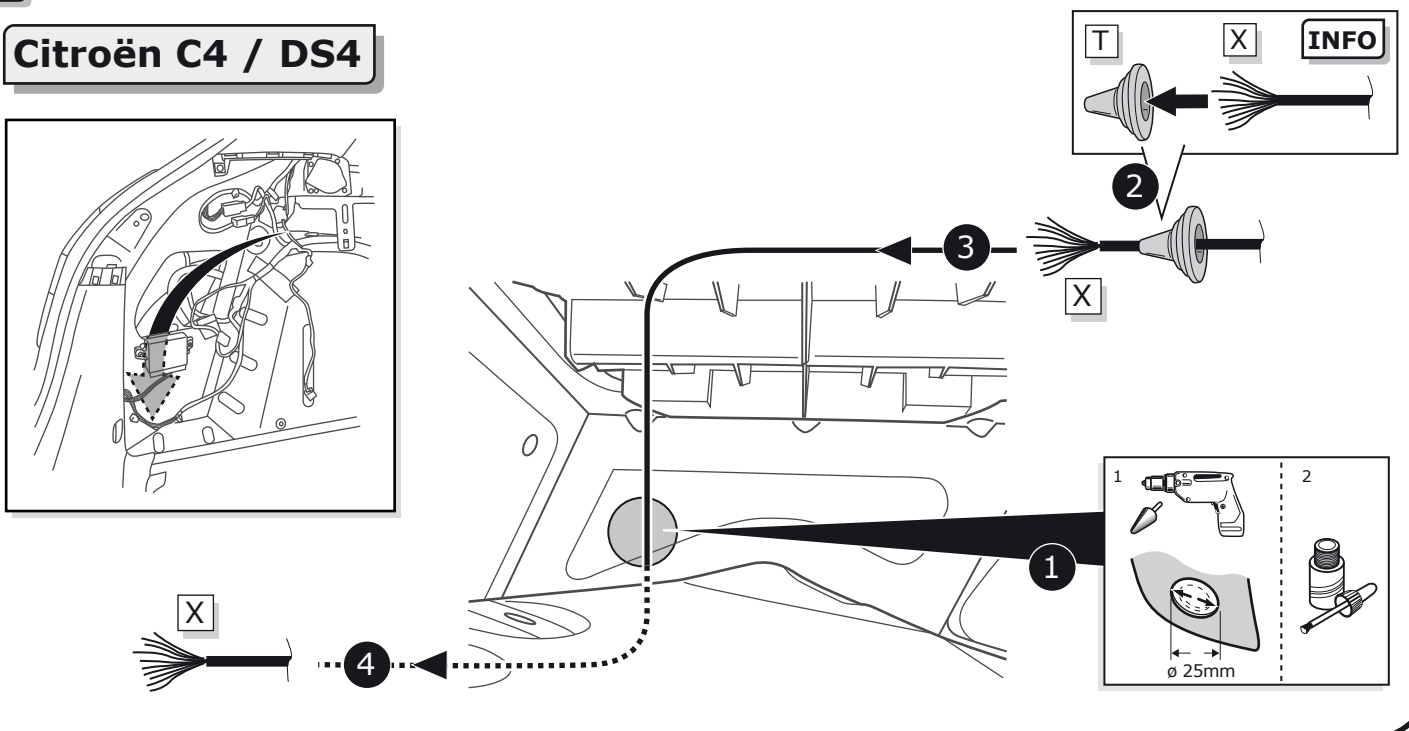

4

### Citroën DS5

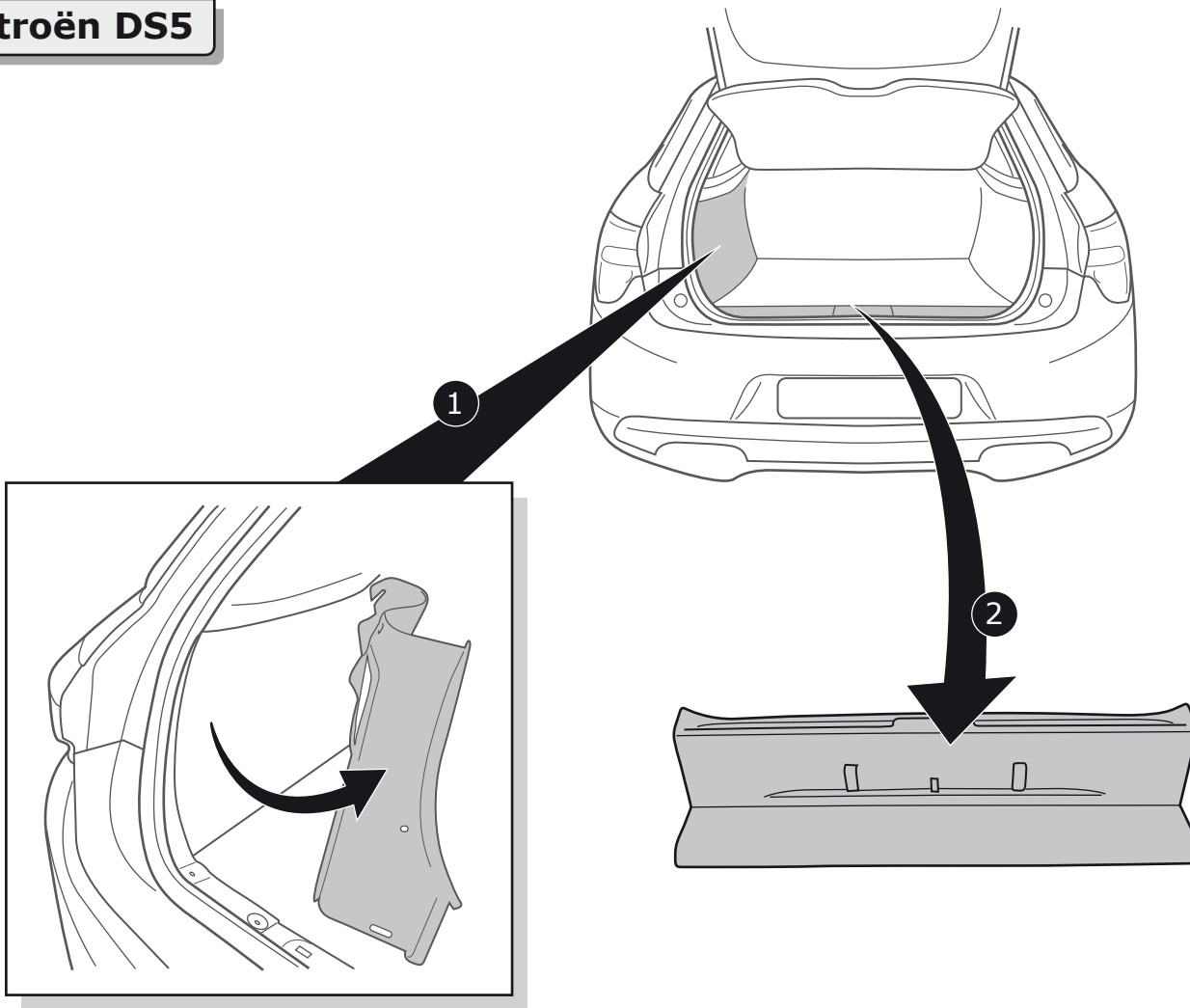

5

### Citroën DS5

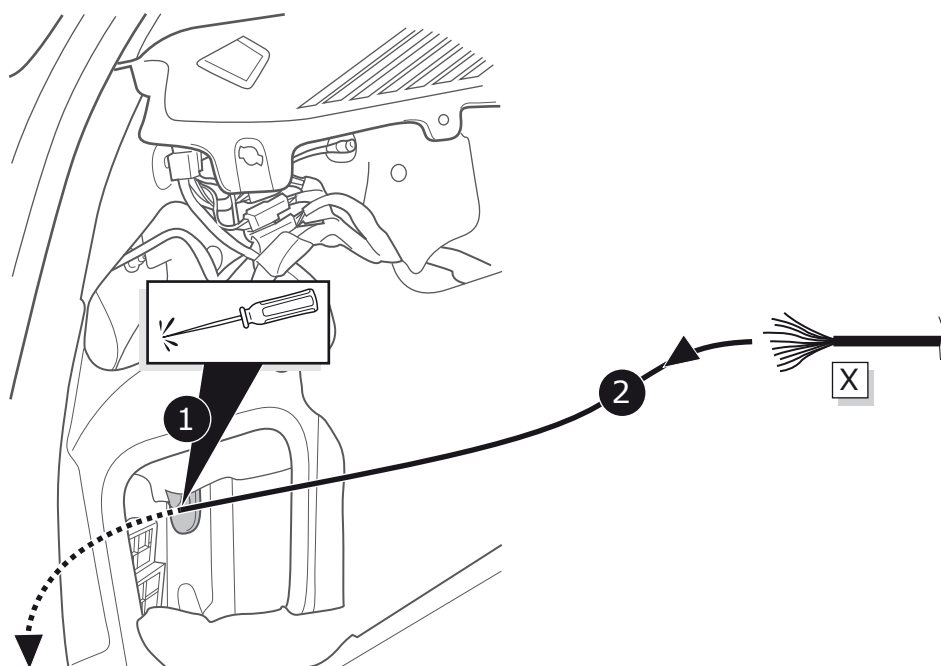
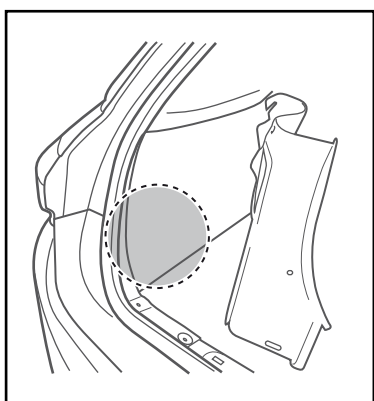

**A**

Option 1

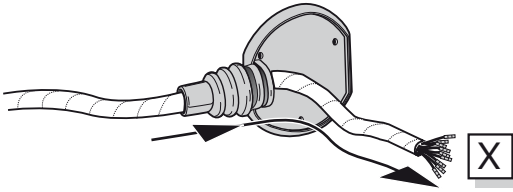

Option 2

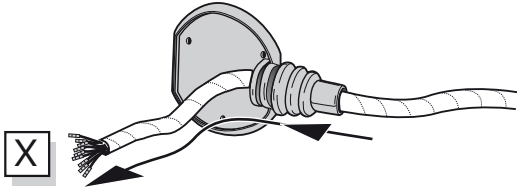
**INFO**

SOCKET CONNECTION



Pag. 11

**B**

Option 1

1

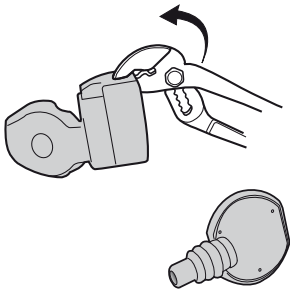

2

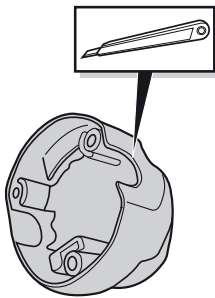

3

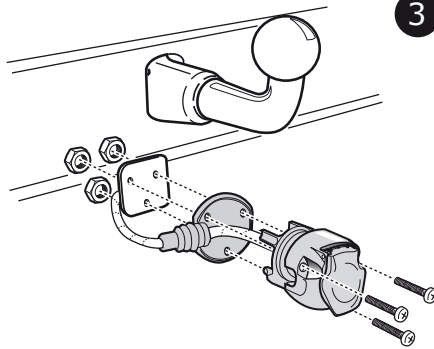

4

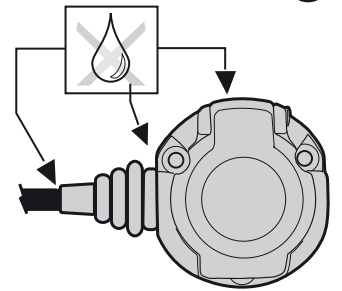
**C**

Option 2

1

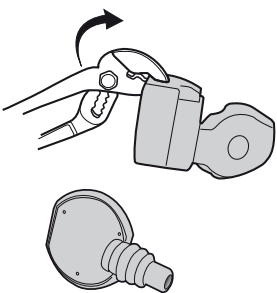

2

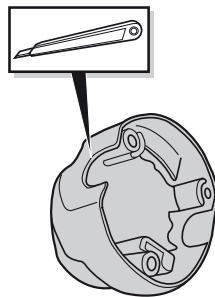

3

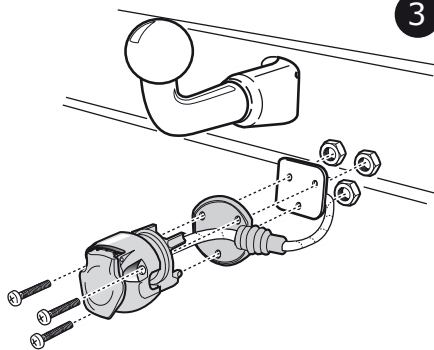

4

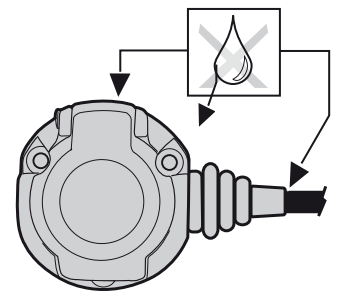
**6**

1

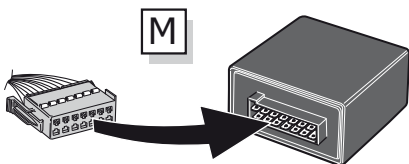

2

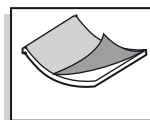

3

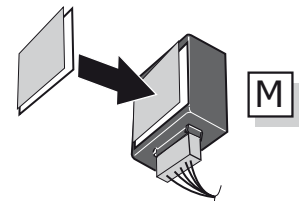

4

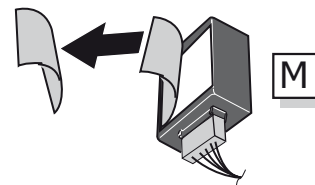

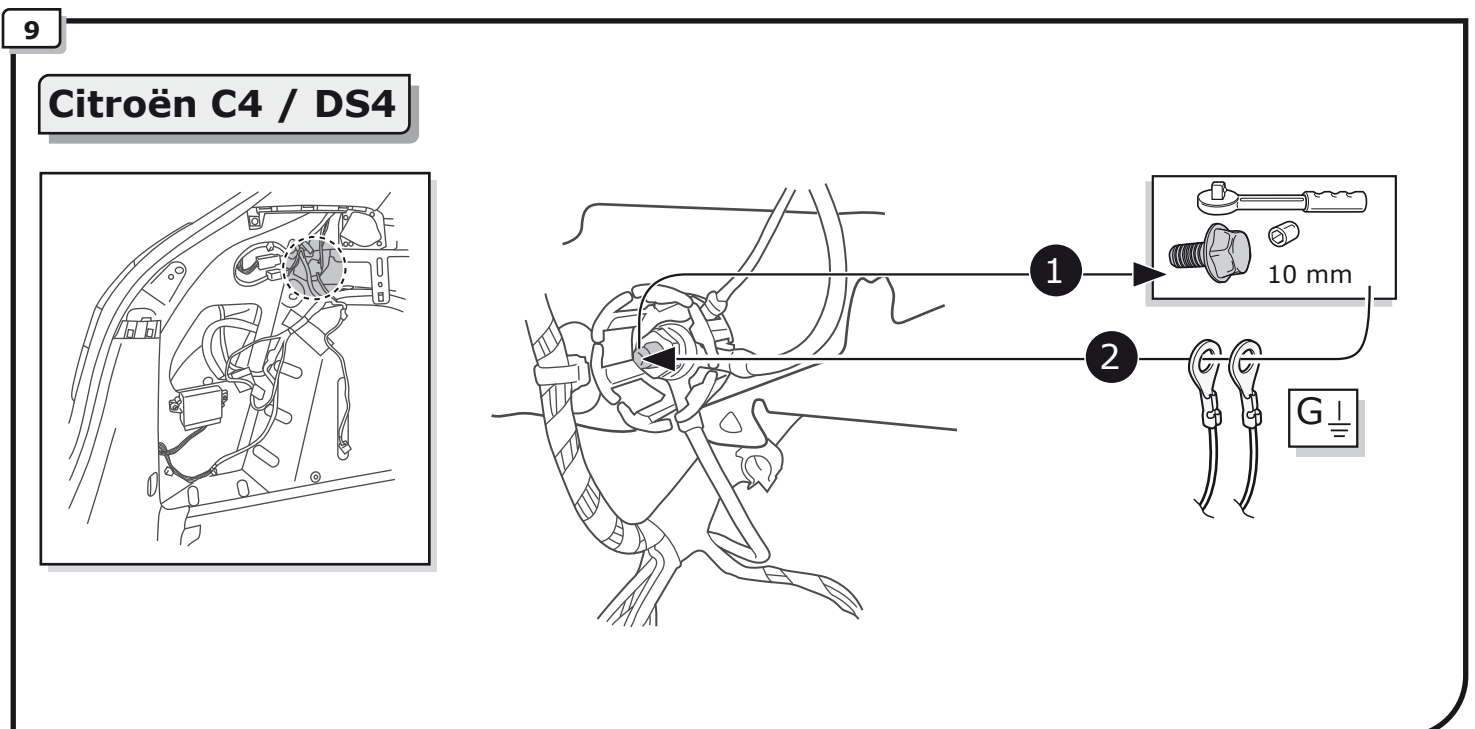
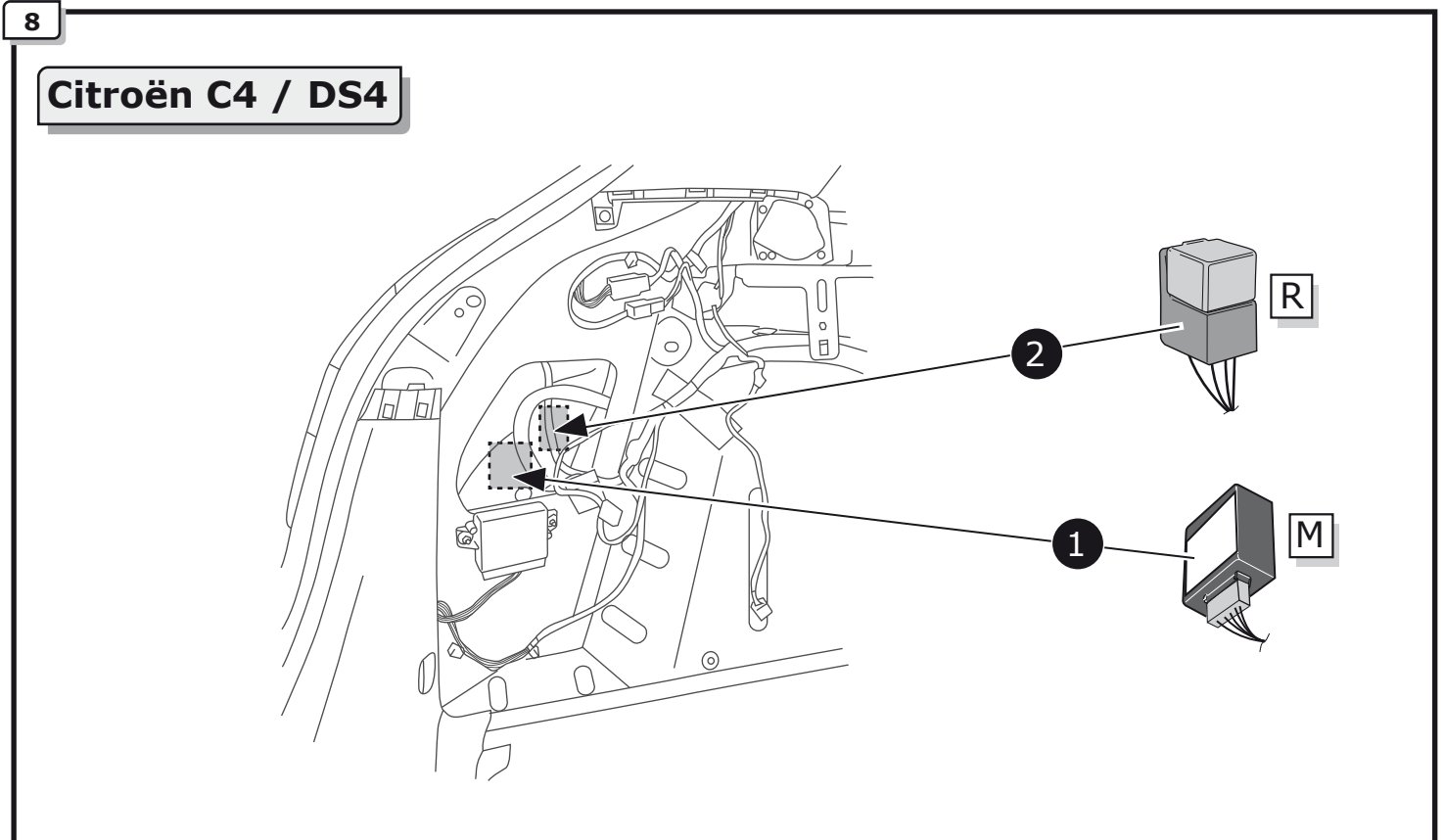
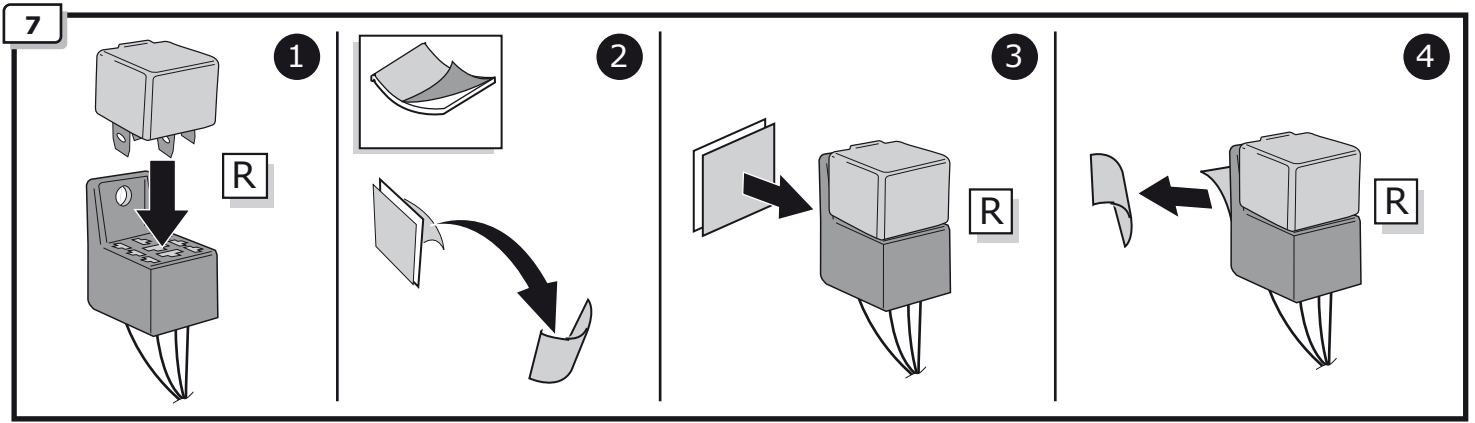

10

### Citroën DS5

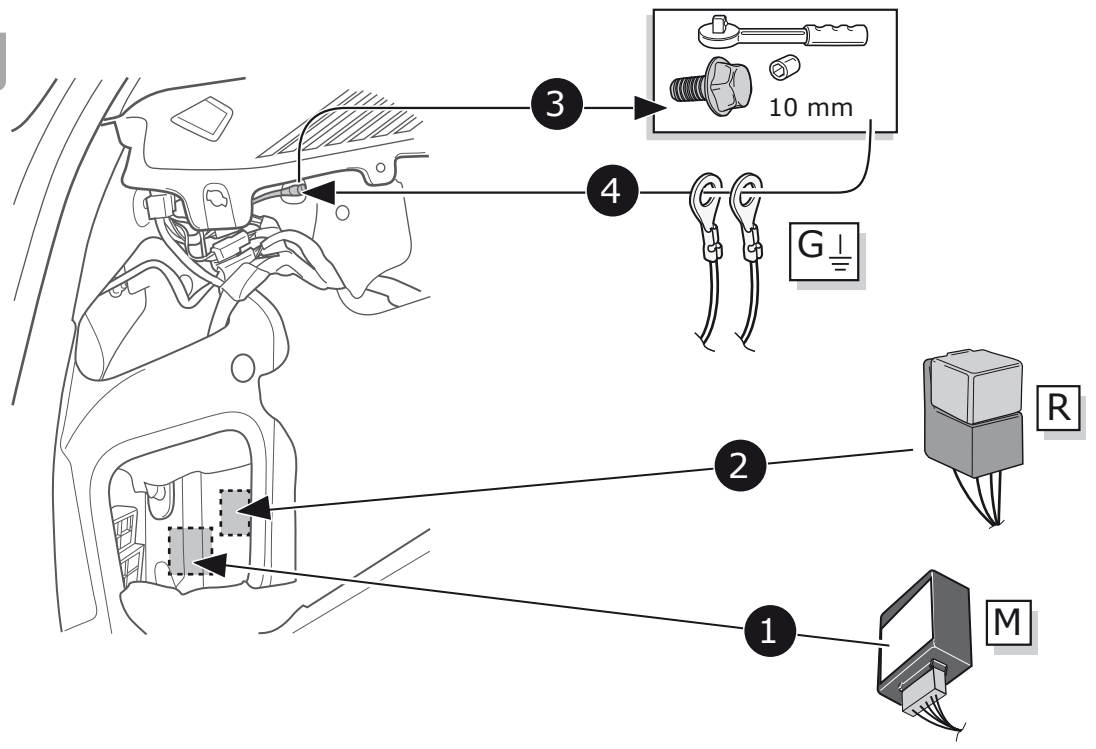

11

### Citroën C4 / DS4

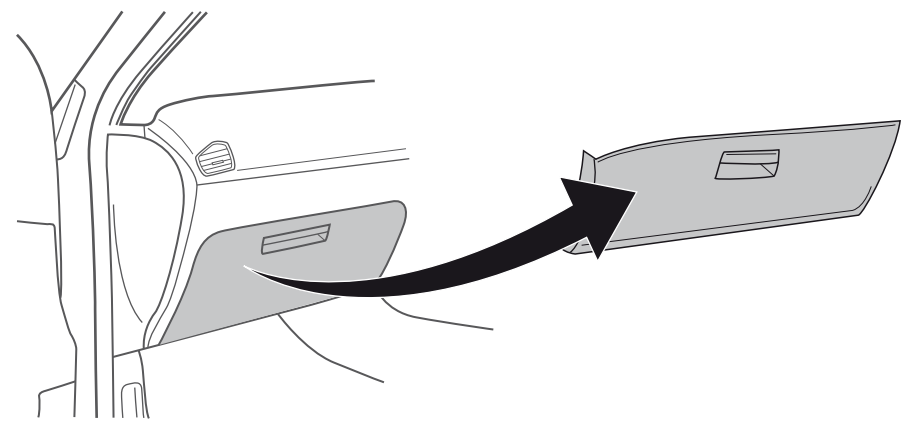

12

### Citroën DS5

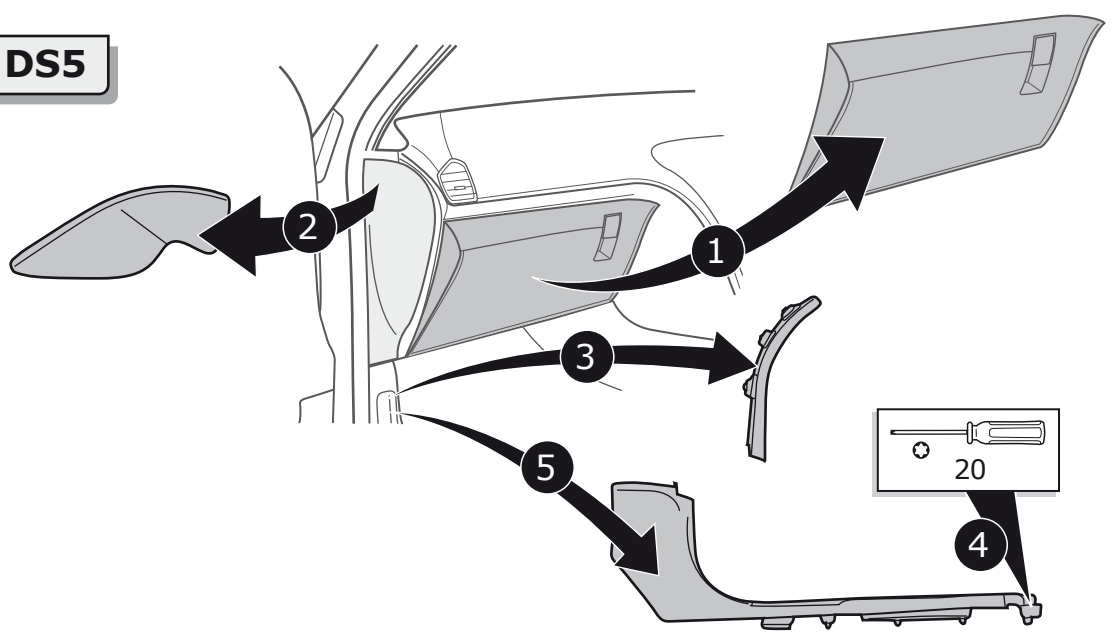



13

### Citroën C4 / DS4

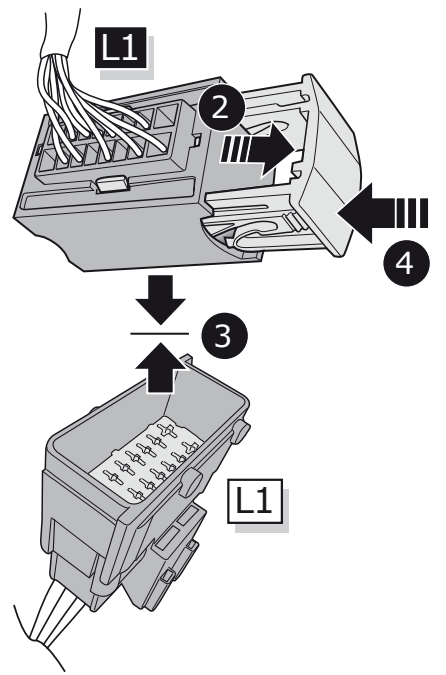
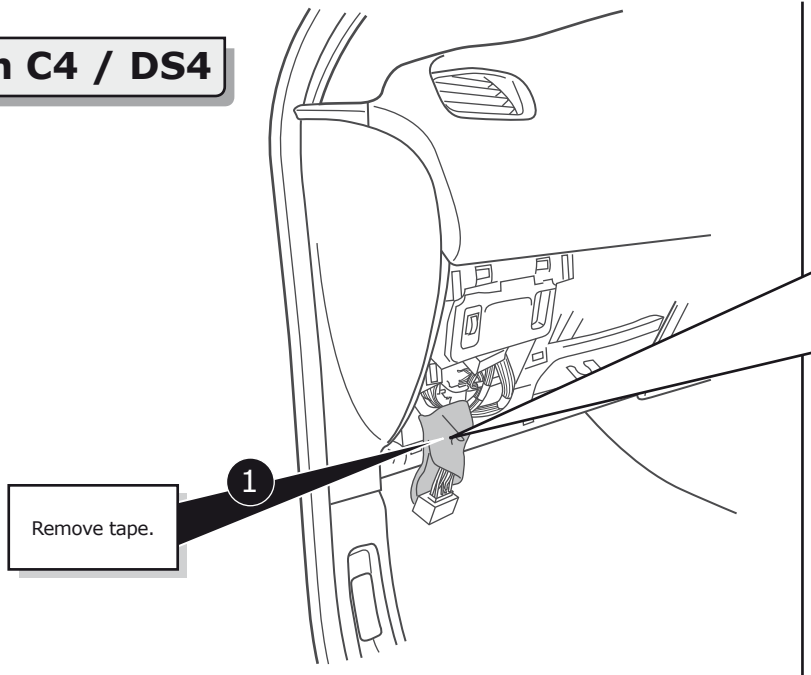

14

### Citroën DS5

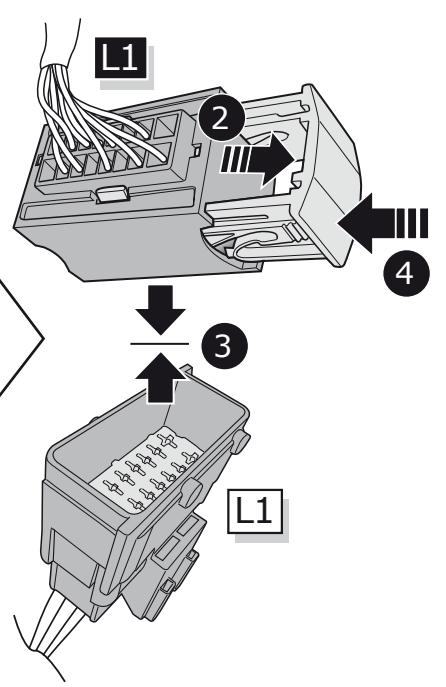
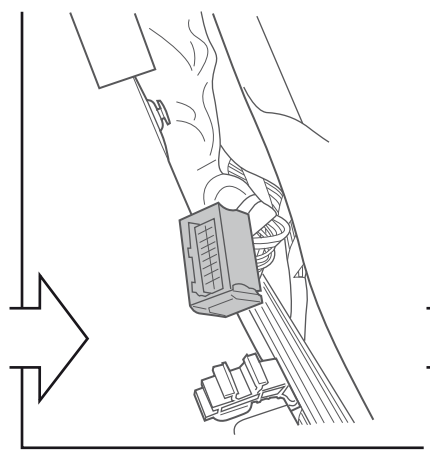
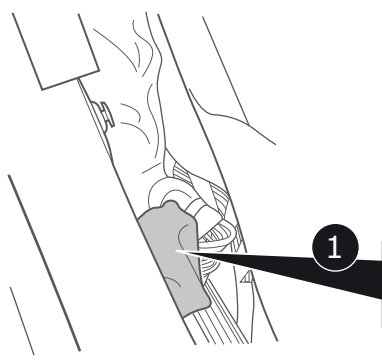
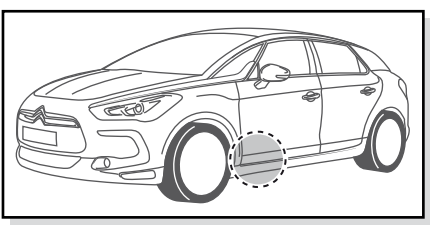

15

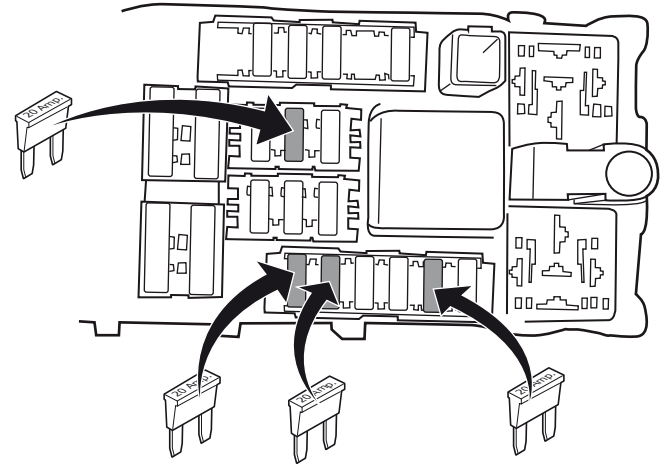
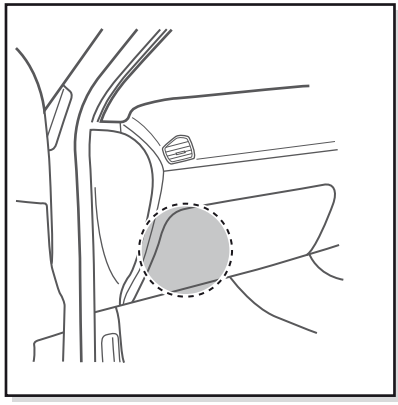

16

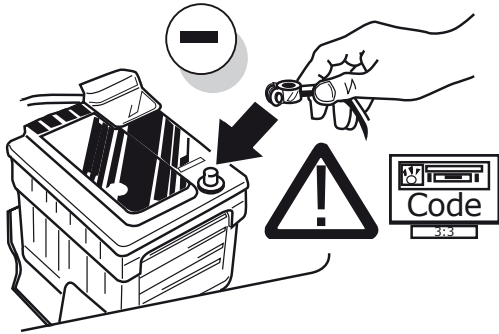

17

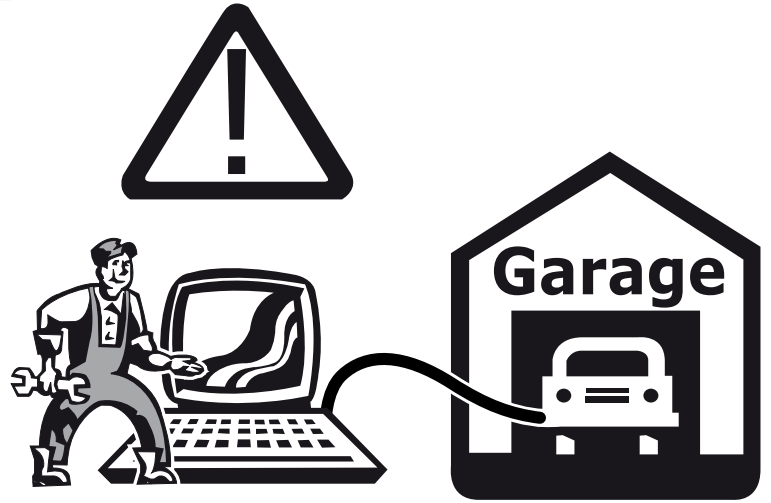

18



TEST ALL THE CIRCUITS WITH A TEST DEVICE WITH THE CORRECT POWER LOAD FOR EACH FUNCTION. A TEST DEVICE WITH LED'S CANNOT BE USED FOR THIS PURPOSE.

INFO

REINSTALL TRIM.

19

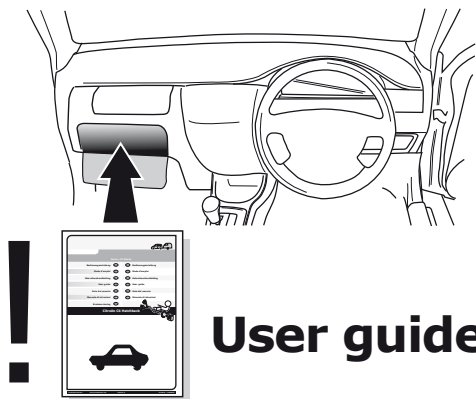









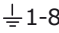

**User guide**

**TECHNICAL SUPPORT**

**CALL 07440 202 052**

**ECS ELECTRONICS** MONDAY TO FRIDAY  
 08.00 - 11.00 am  
 12.00 - 05.00 pm  
 ukts@ecs-electronics.com  
 www.ecs-electronicsuk.co.uk

## SOCKET CONNECTION

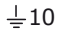
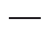
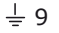
DIN/ISO 11446													
	1/L	2	3/31	4/R	5/58-R	6/54	7/58-L	8	9	10	11	12	13
Pmax	21W	21W		21W	42W	3x21W	42W	21W	180W/15Amp	180W/15Amp			
Colour	Yellow	Blue	White	Green	Brown	Red 1,00 mm <sup>2</sup>	Black	Black/ Red	Brown/ White	Red 2,50 mm <sup>2</sup>	White	-	White