

**Citroën C4 Picasso 06/2013 >>**

**Citroën C4 Spacetourer 06/2018 >>**

**Citroën Grand C4 Spacetourer 06/2018 >>**

**Peugeot 308 HB 10/2013 >>**

**Peugeot 308 SW 06/2014 >>**

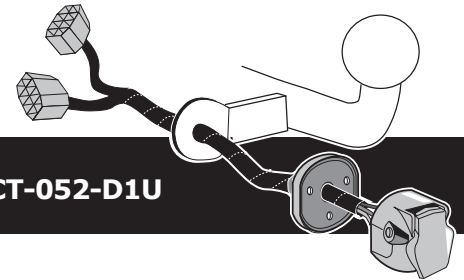

**Partnr.: CT-052-D1U**

- Fitting instructions electric wiring kit tow bar with 13-P socket up to DIN/ISO Norm 11446.
- We would expressly point out that assembly not carried out properly by a competent installer will result in cancellation of any right to damage compensation, in particular those arising by virtue of the product liability act.
- Contents of these kits and their fitting manuals are subject to alteration without notice, please ensure that these instructions are read and fully understood before commencing installation.
- Do not overload circuits; the maximum loads per connection are detailed in this manual.
- Attention! Before Installation, please read this manual carefully and inform your customer to consult the vehicle owners manual to check for any vehicle modifications required before towing.
- In the event of functional problems, troubleshooting must be limited to about 0.5 hours, contact the technical support:  
[ukts@ecs-electronics.com](mailto:ukts@ecs-electronics.com) / 07440 202 052.



# Part list

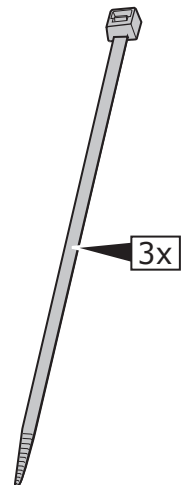
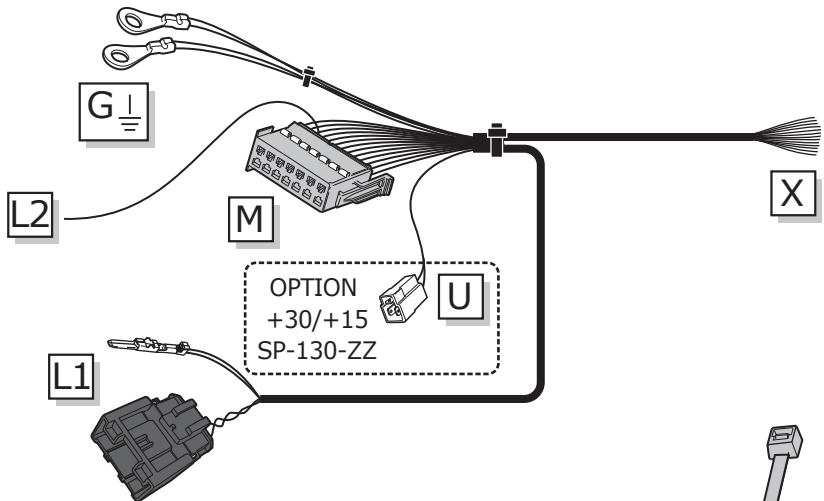
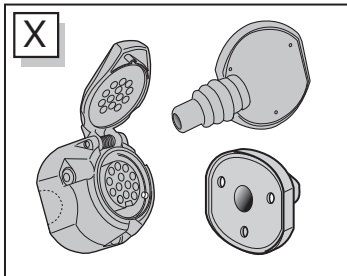
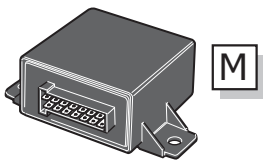
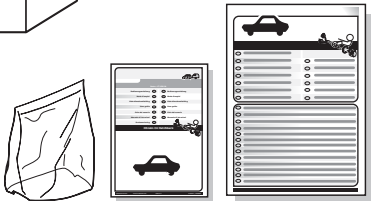
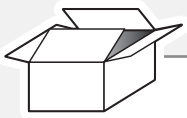

\* OPTION +30/+15 preparation for

|             |     |
|-------------|-----|
|             |     |
| Brown/White | Red |

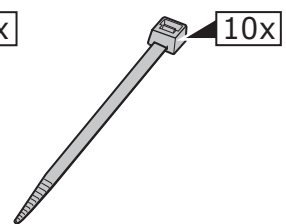
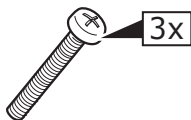

**ROUTING**

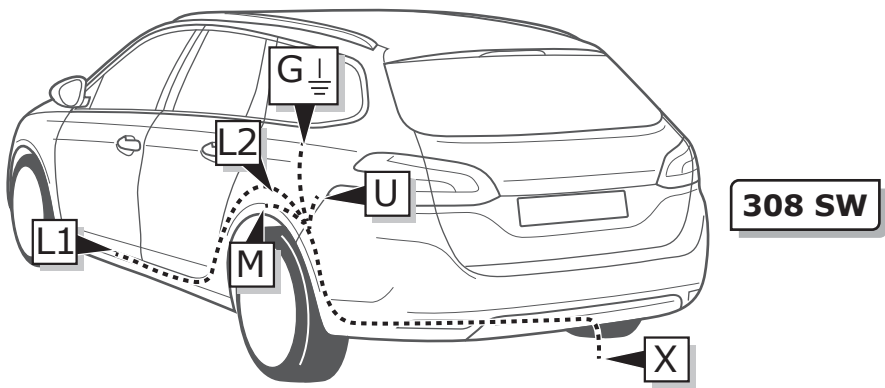
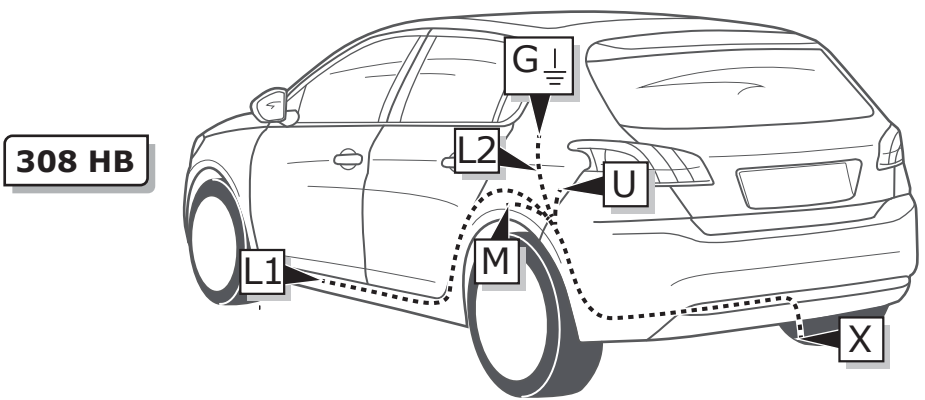
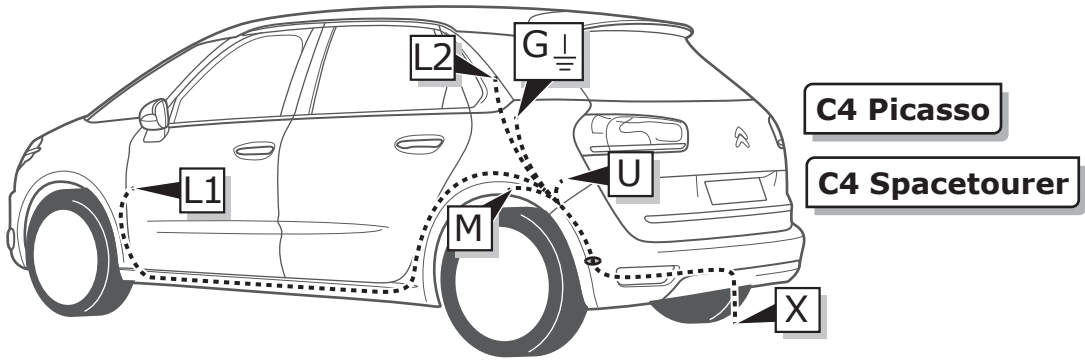

**1**

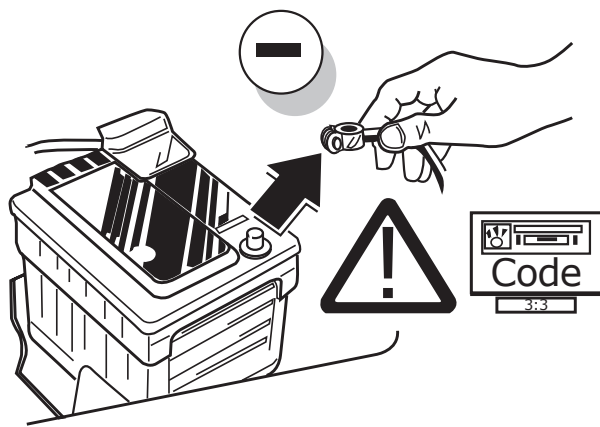

2

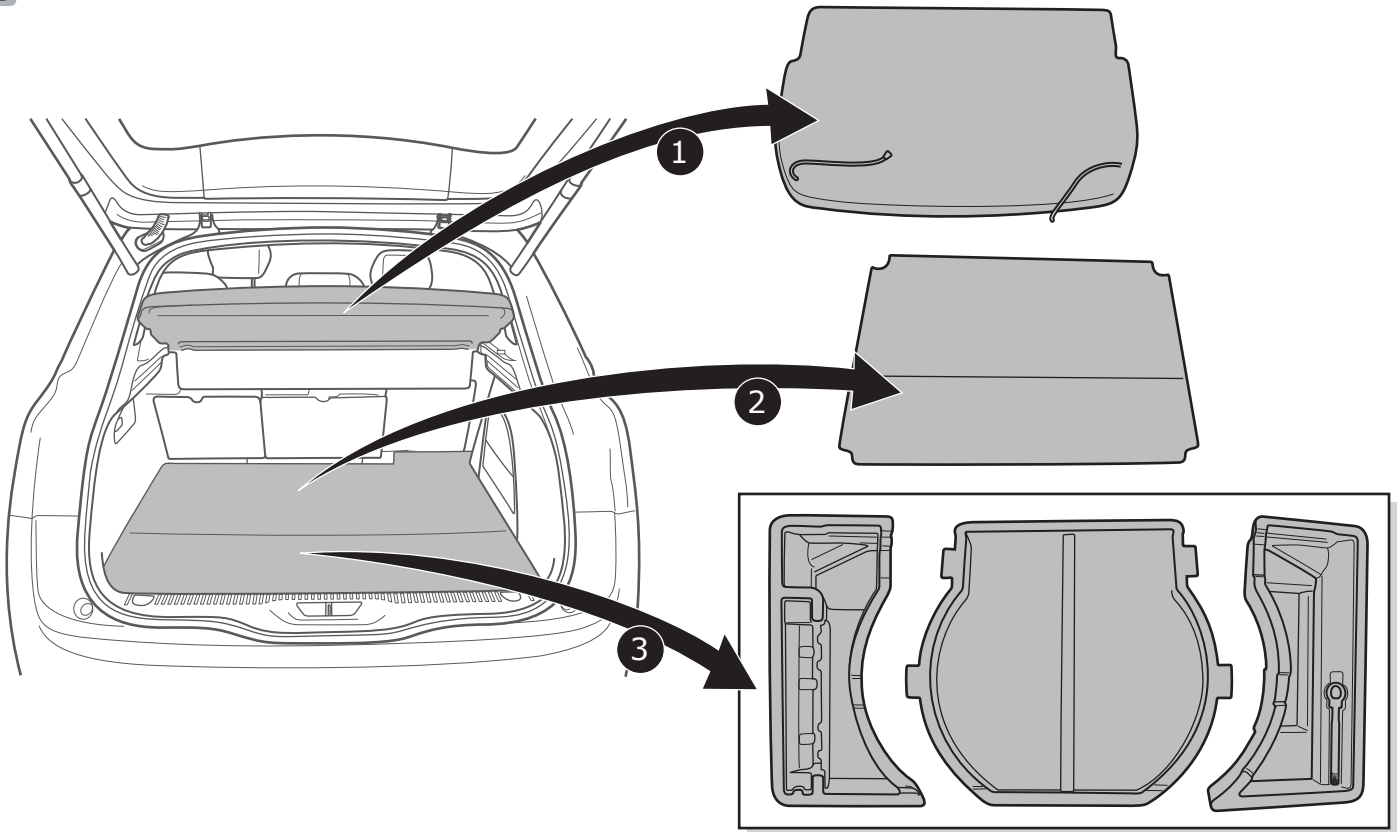

3

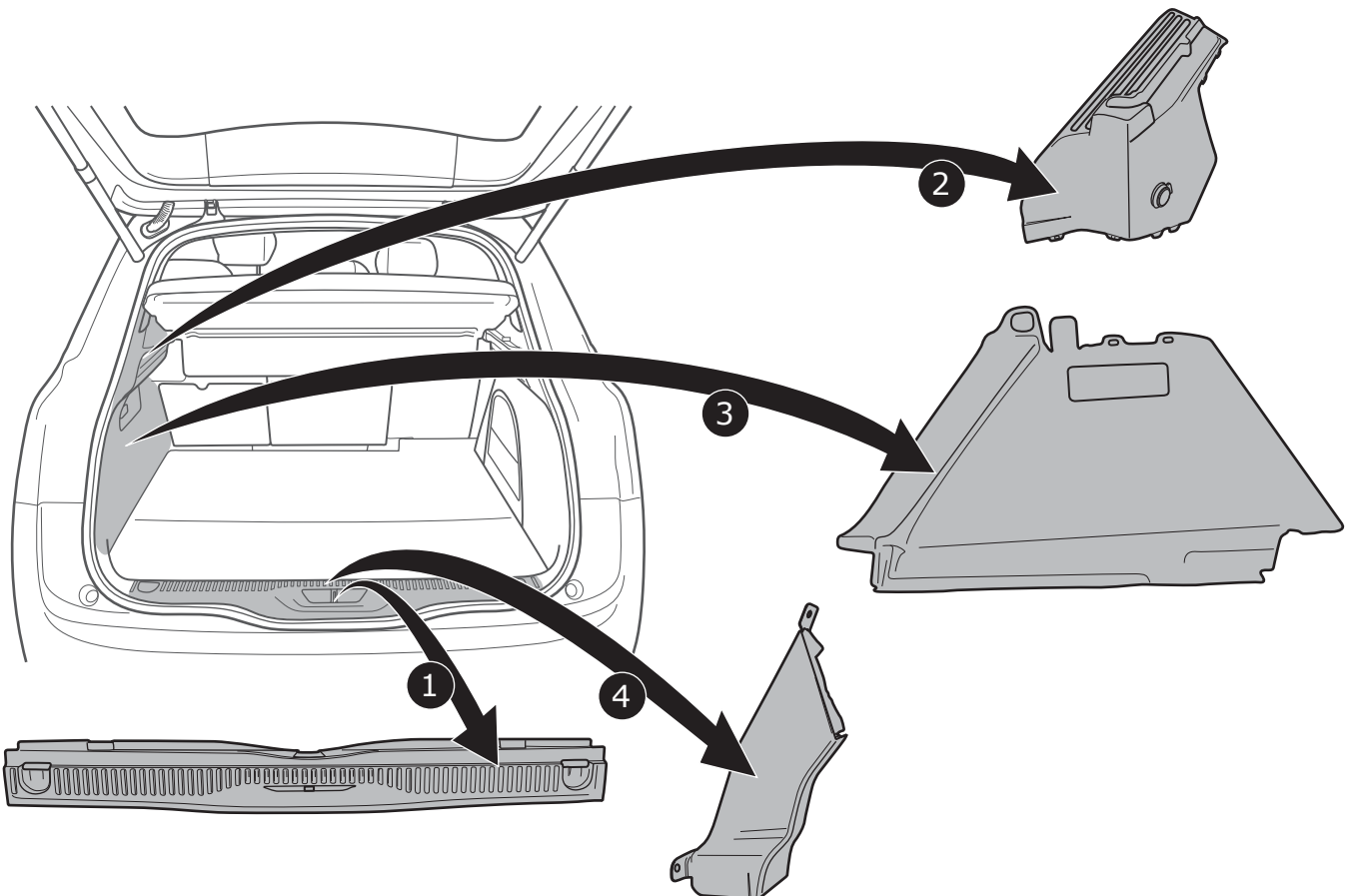

# 308 HB

4

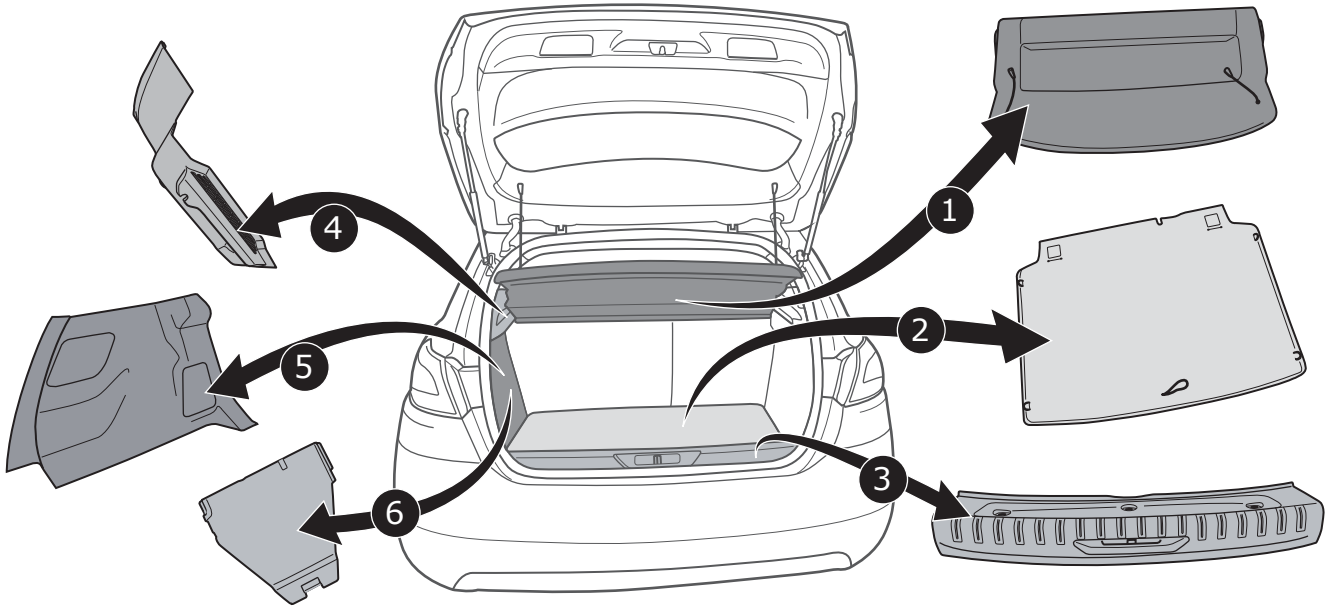

# 308 SW

5

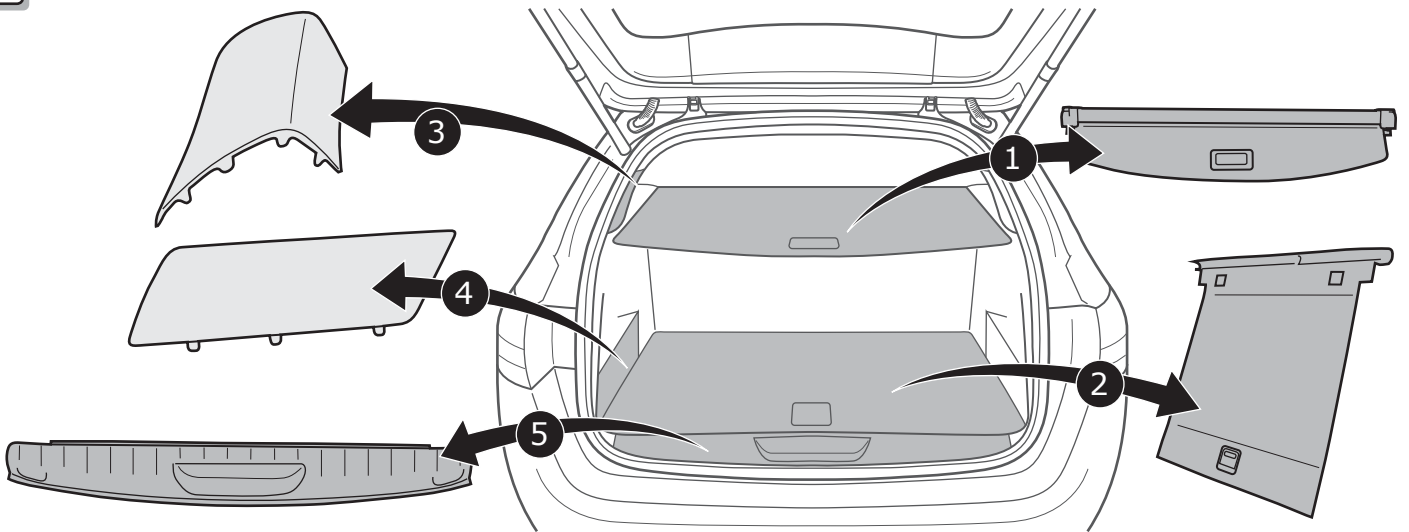

6

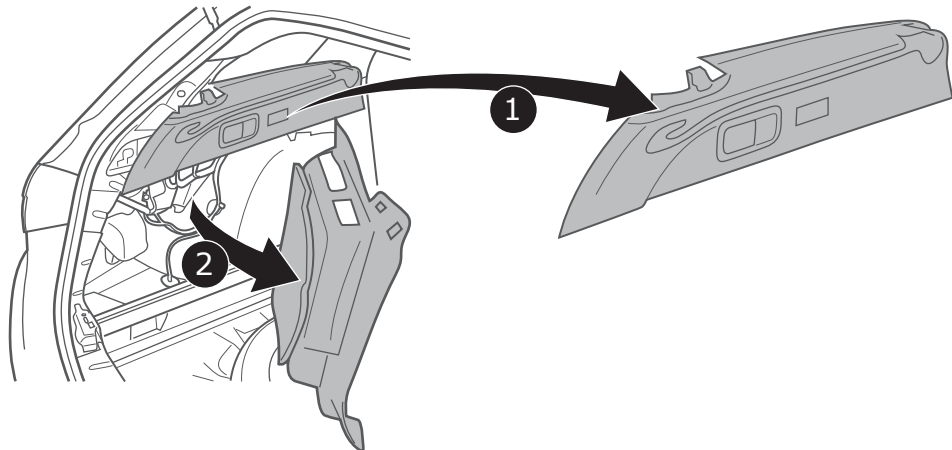

7

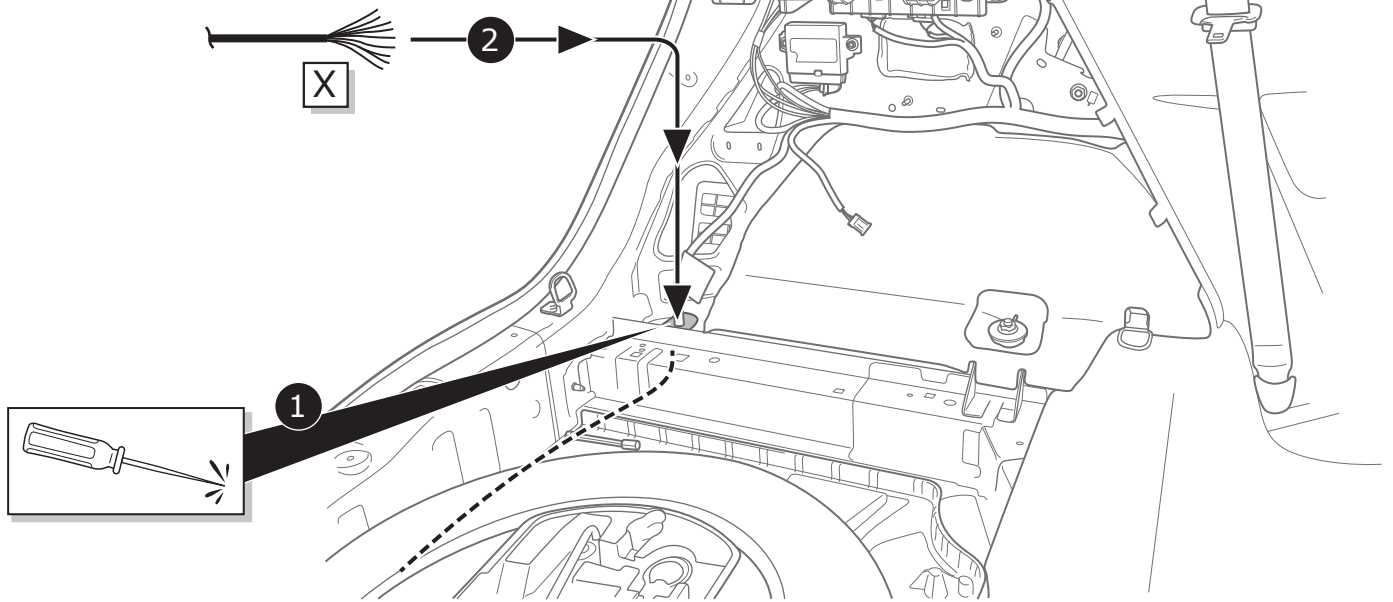
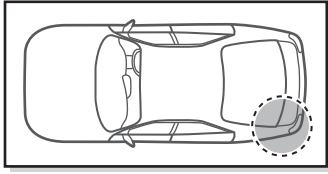

308 SW

8

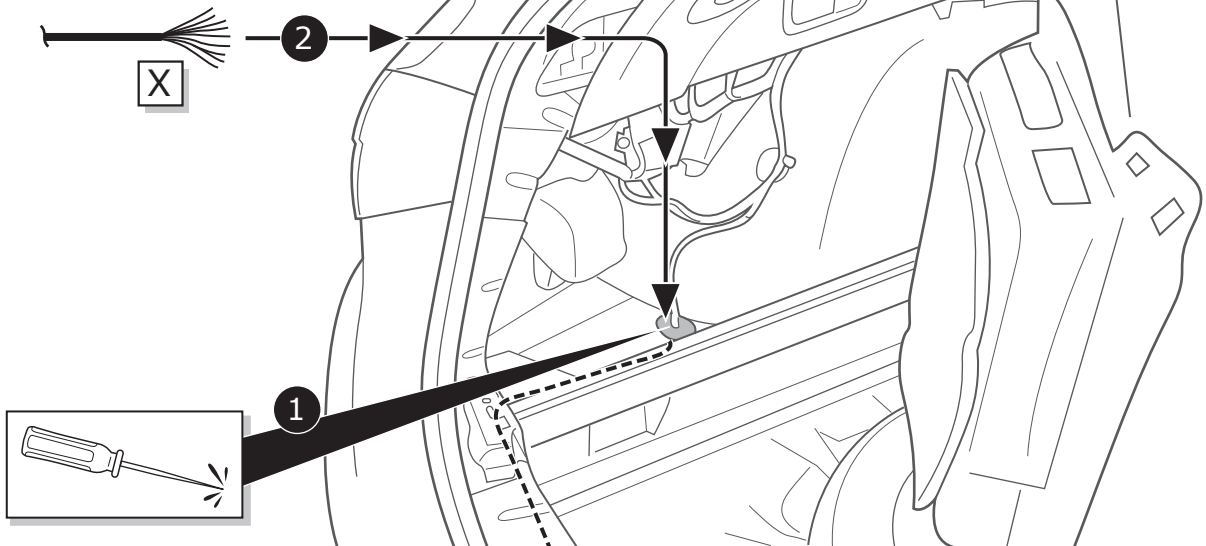
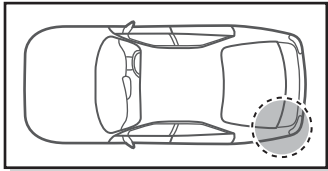

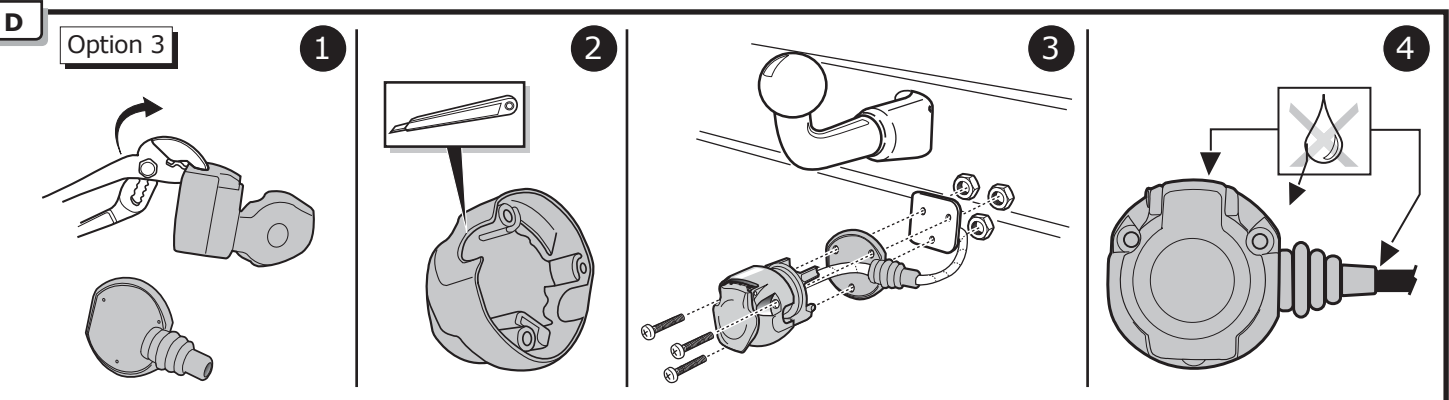
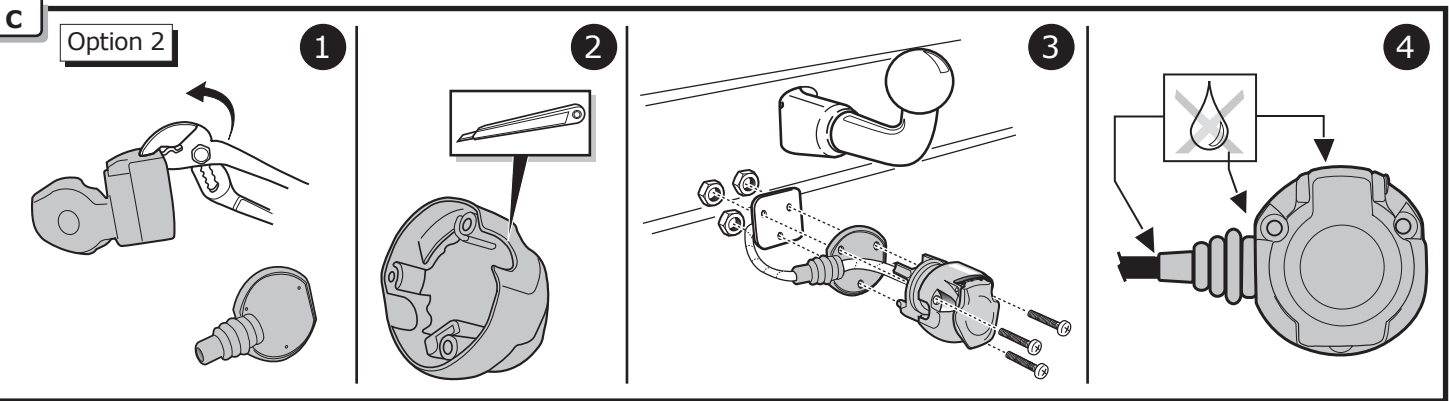
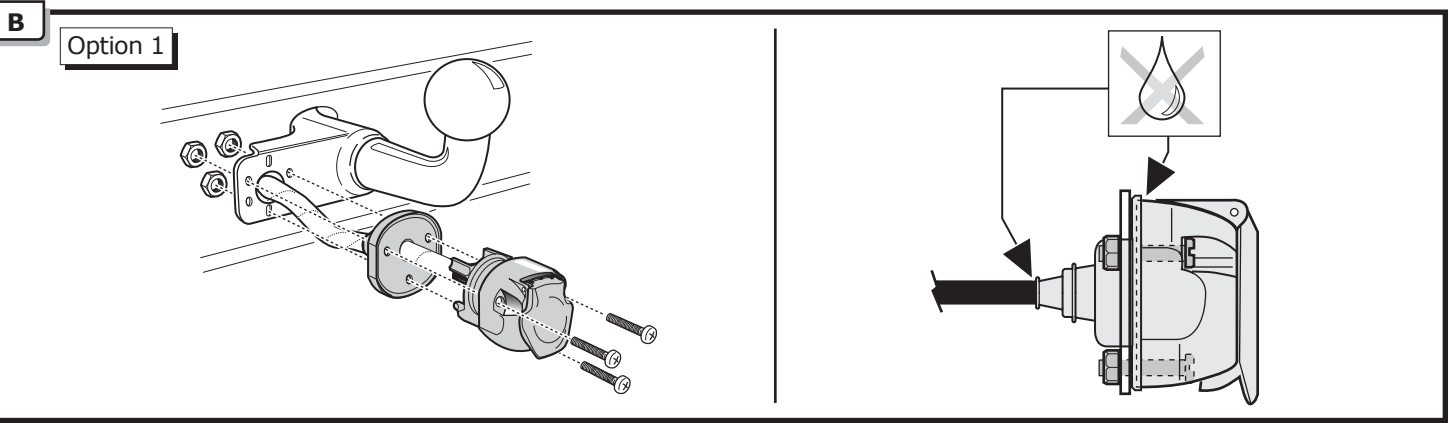
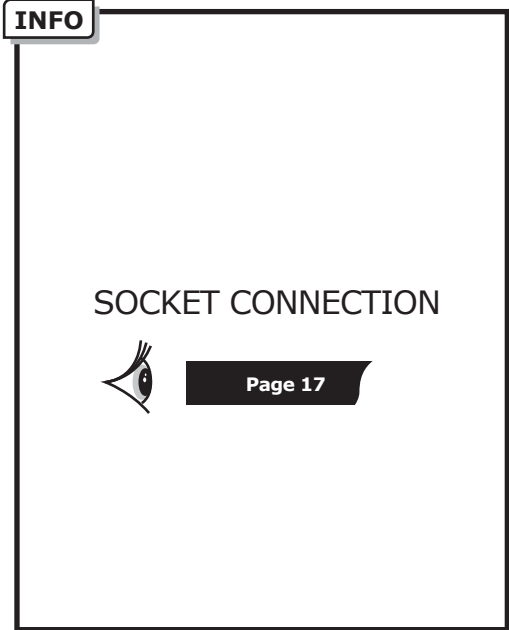
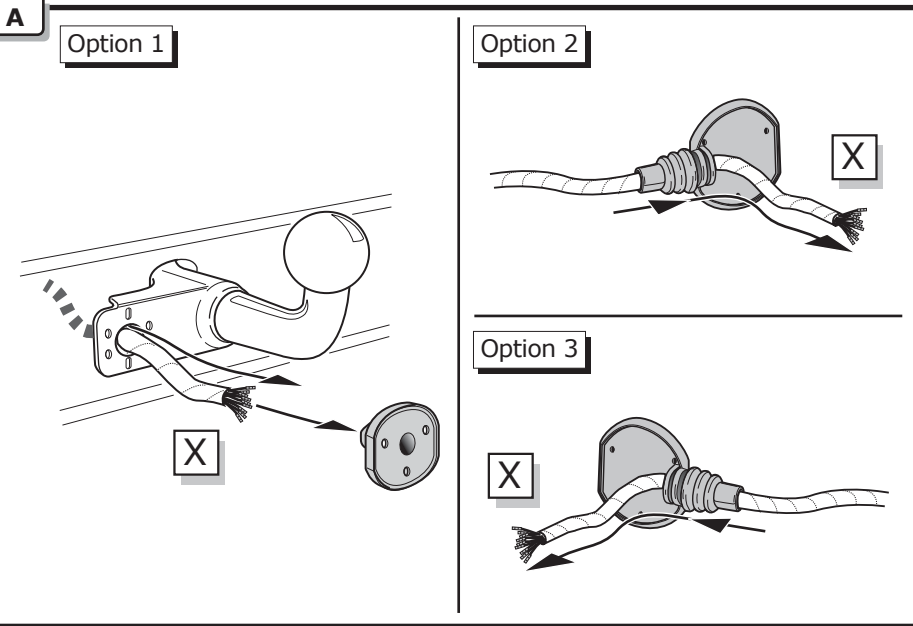

# C4 Picasso / C4 Spacetourer / 308 HB

9

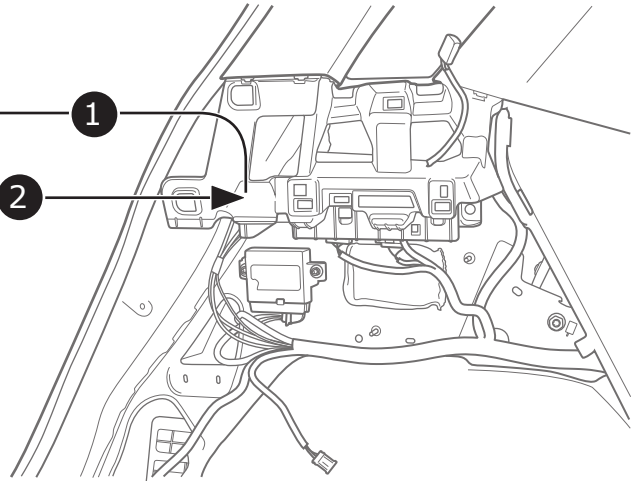
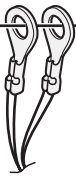
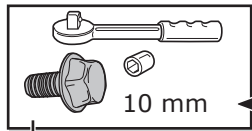
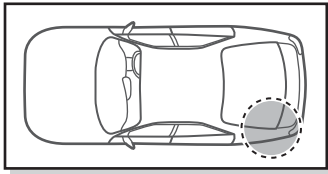

# 308 SW

10

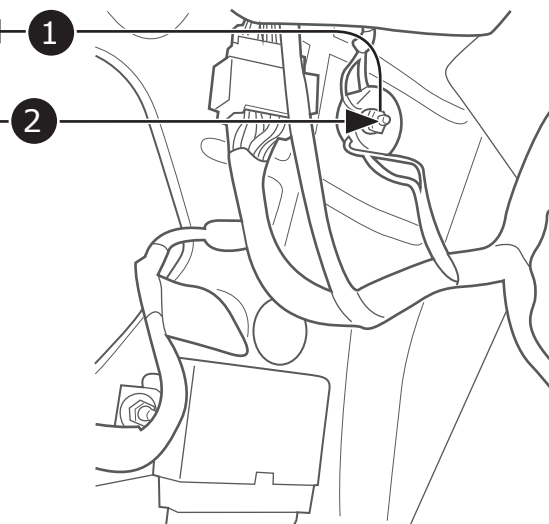
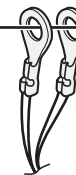
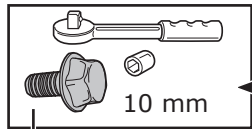
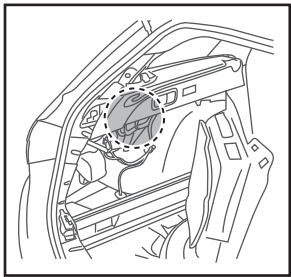

# All models

11

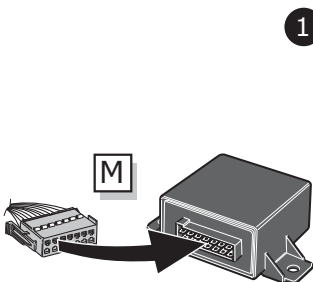

1

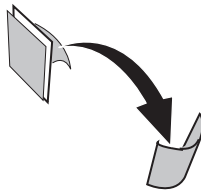
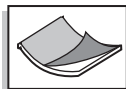

2

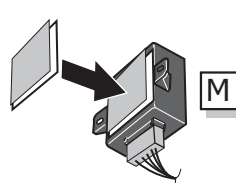

3

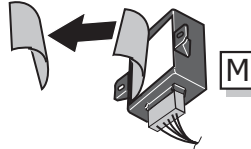

4

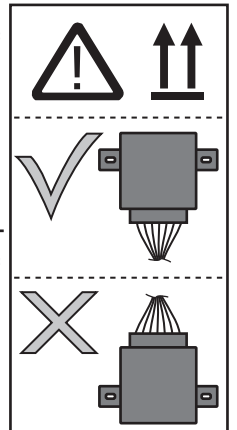



# C4 Picasso / C4 Spacetourer

12

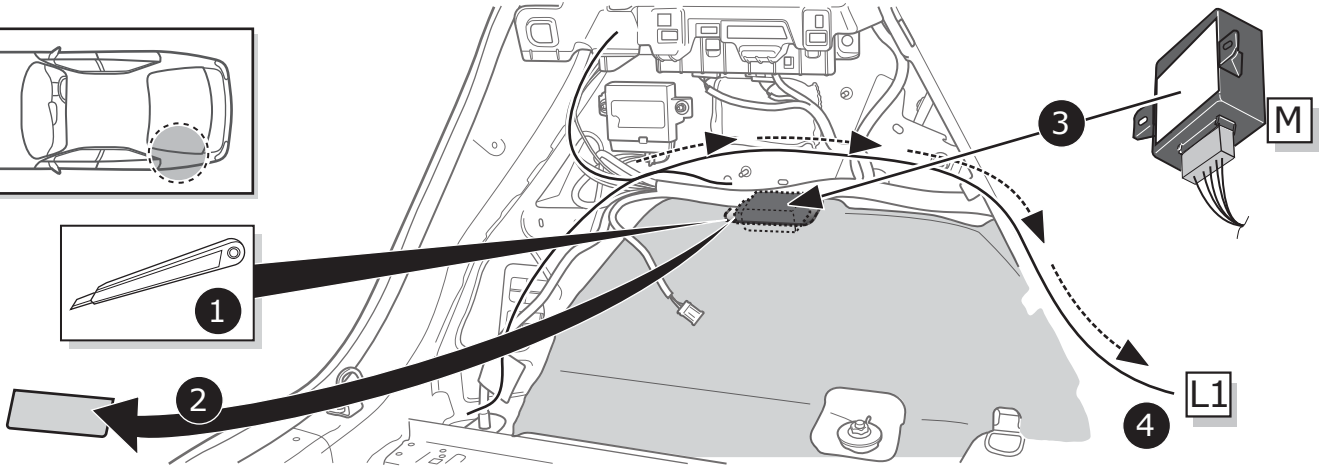
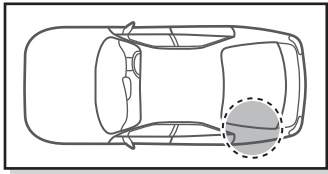

# 308 HB

13

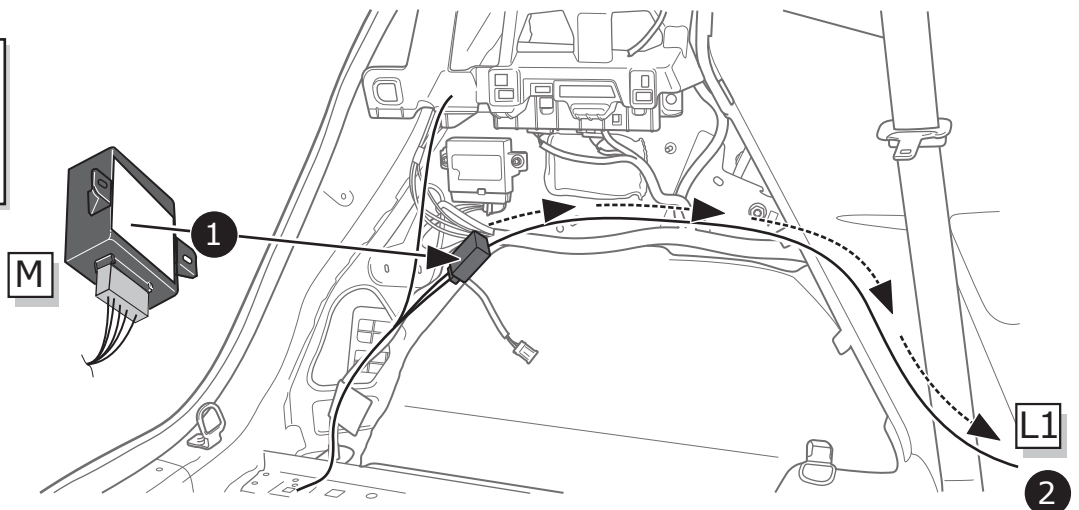
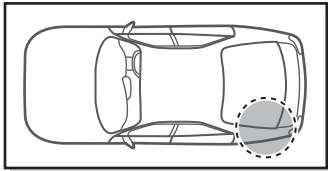

# 308 SW

14

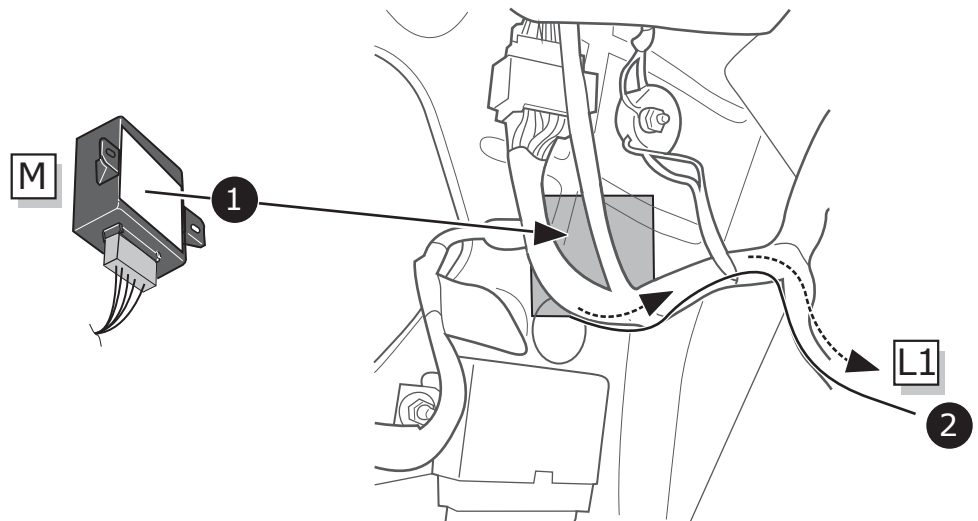
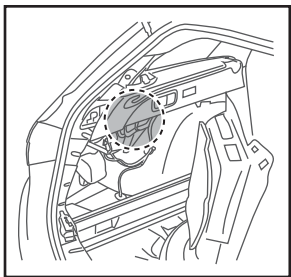

15

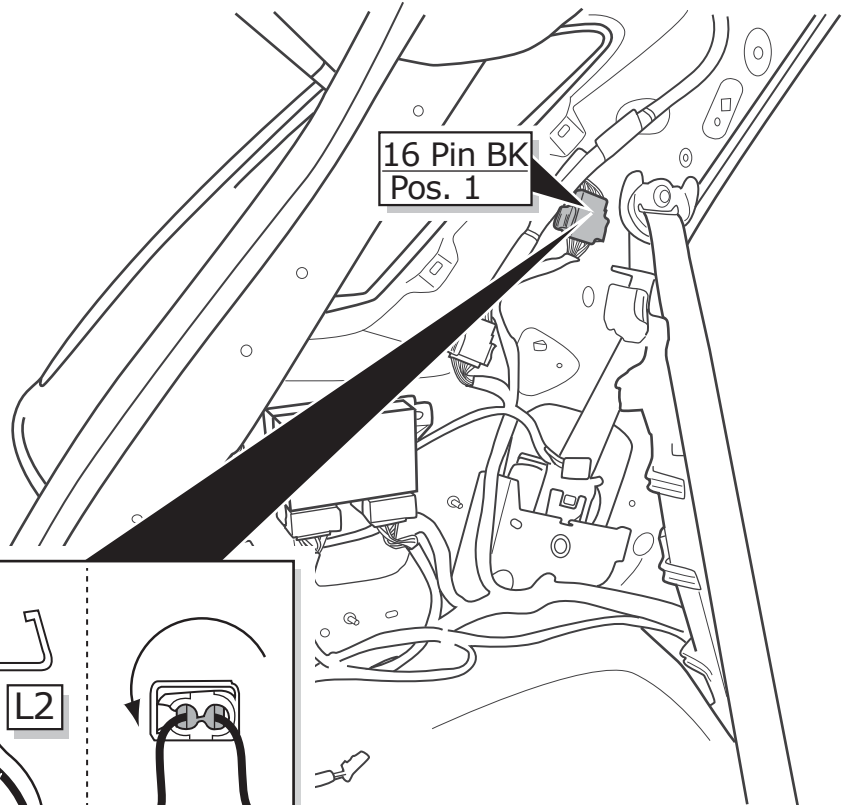
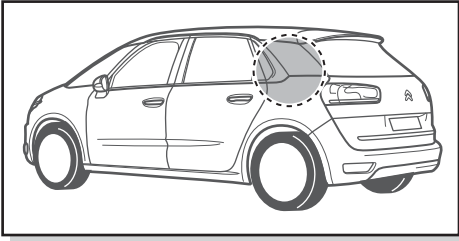

16 Pin BK  
Pos. 1

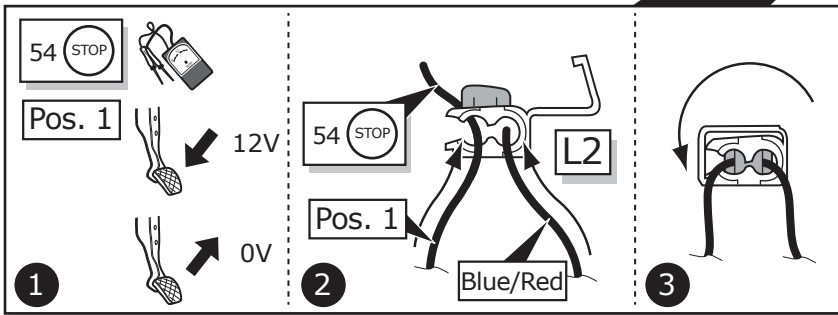

308 HB

16

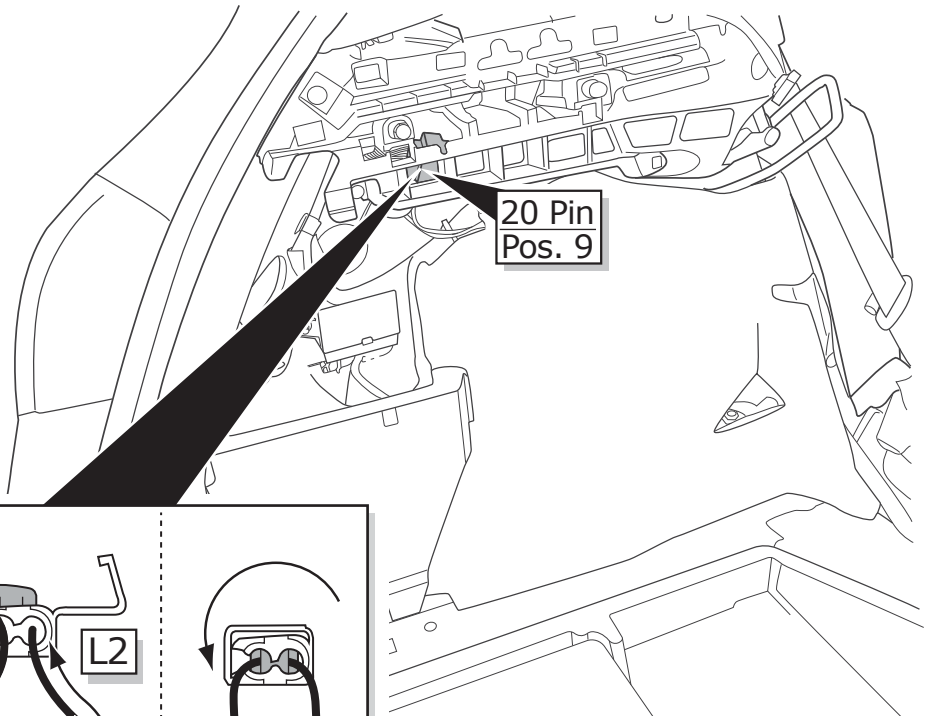
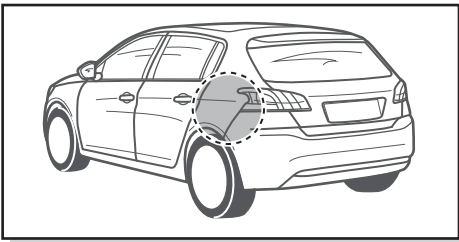

20 Pin  
Pos. 9

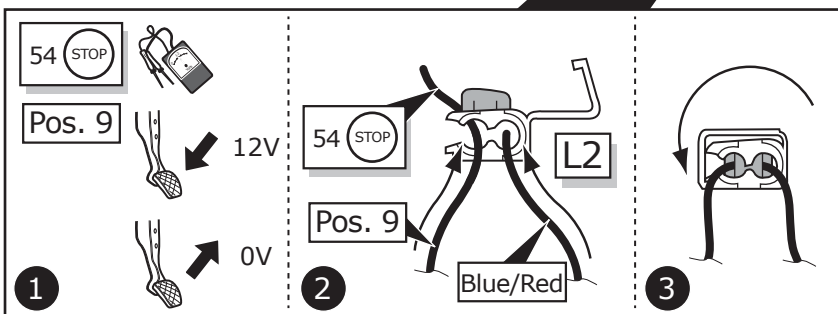

17

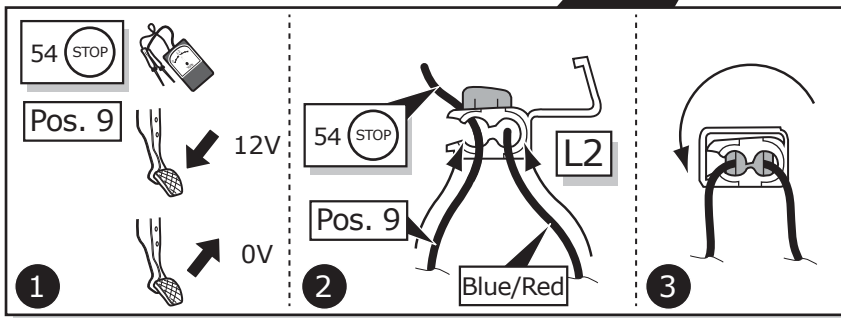
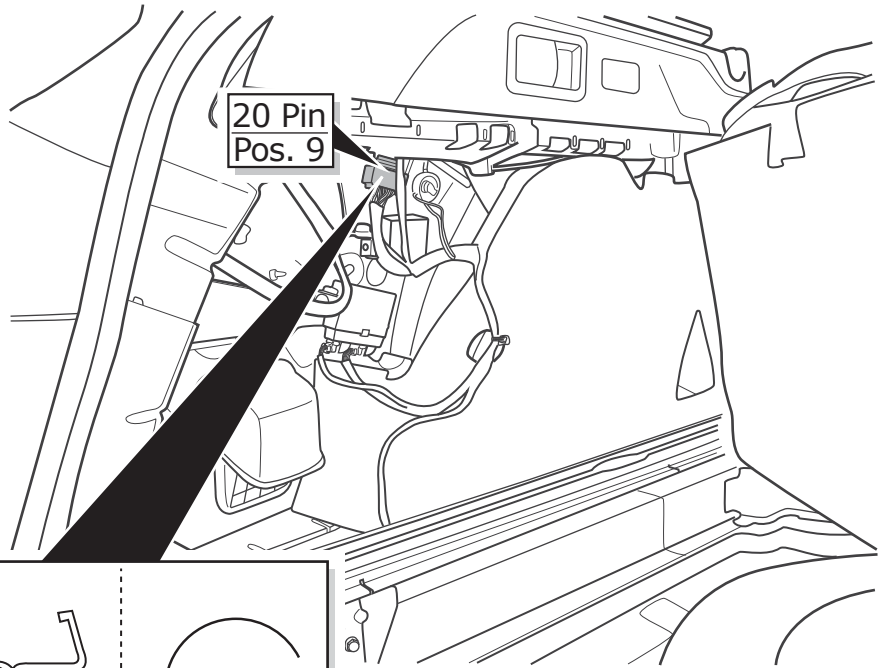
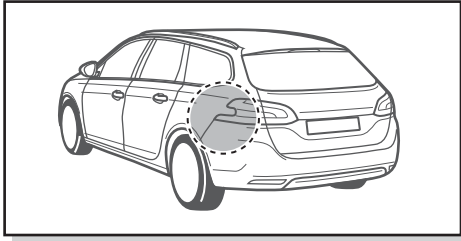

C4 Picasso / C4 Spacetourer

ROUTING

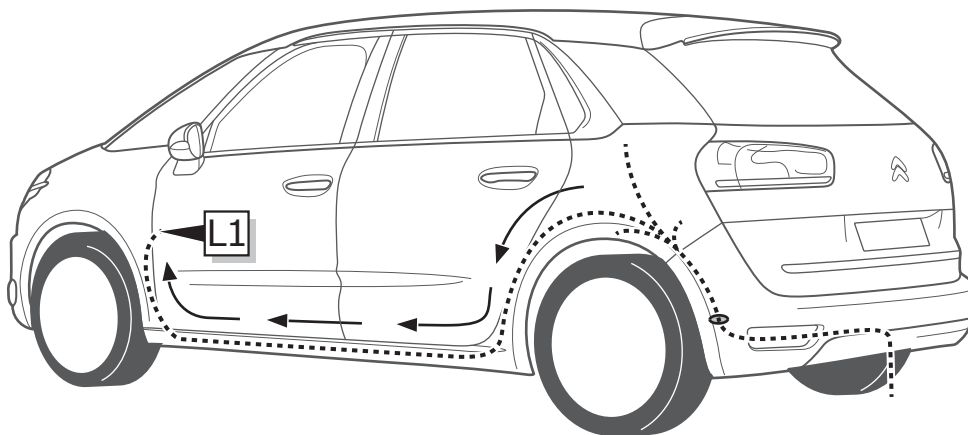

308 HB

ROUTING

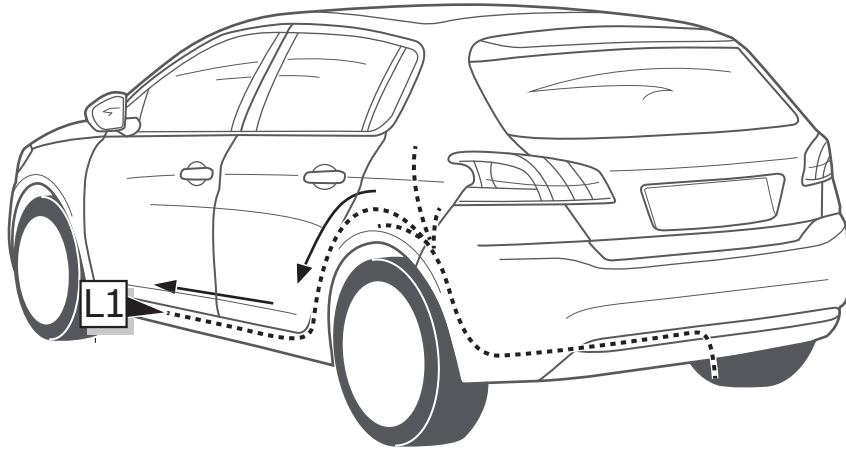

308 SW

ROUTING

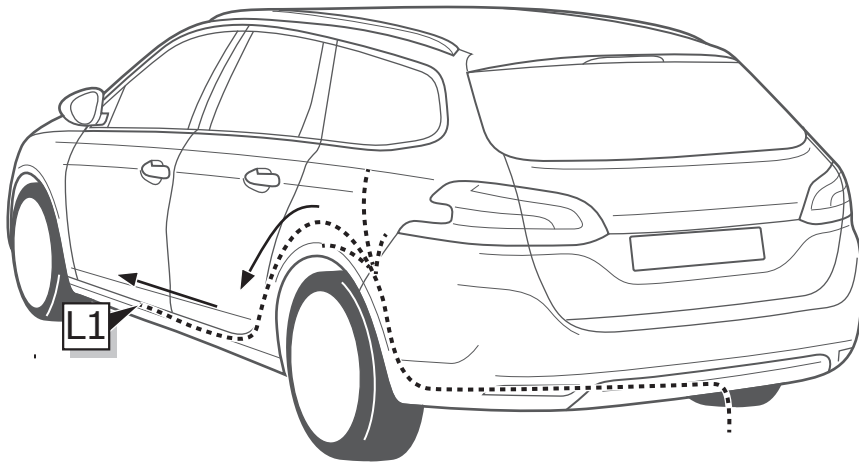

18

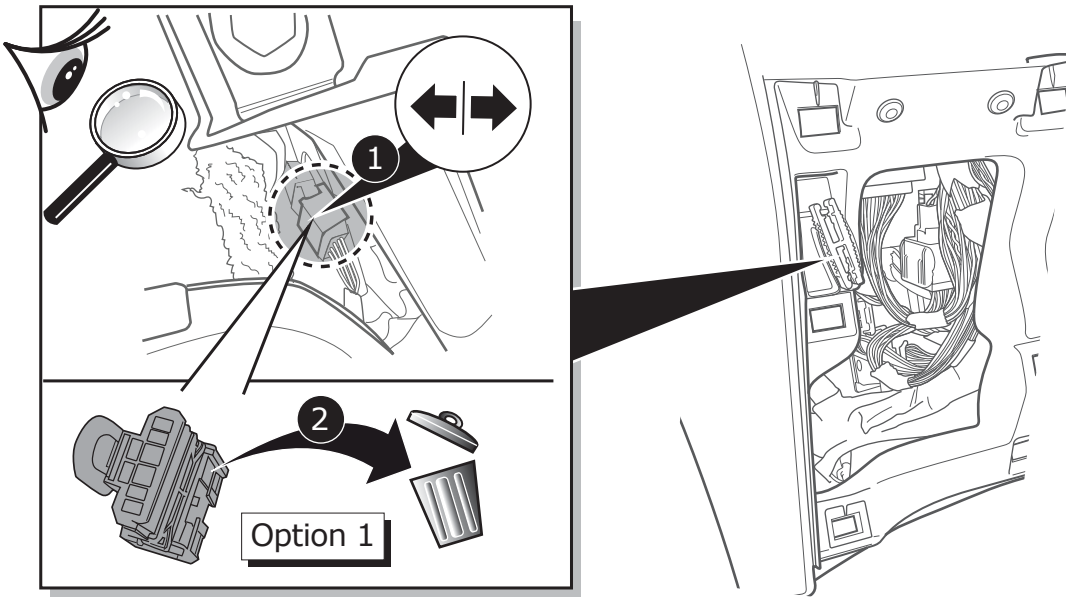

19

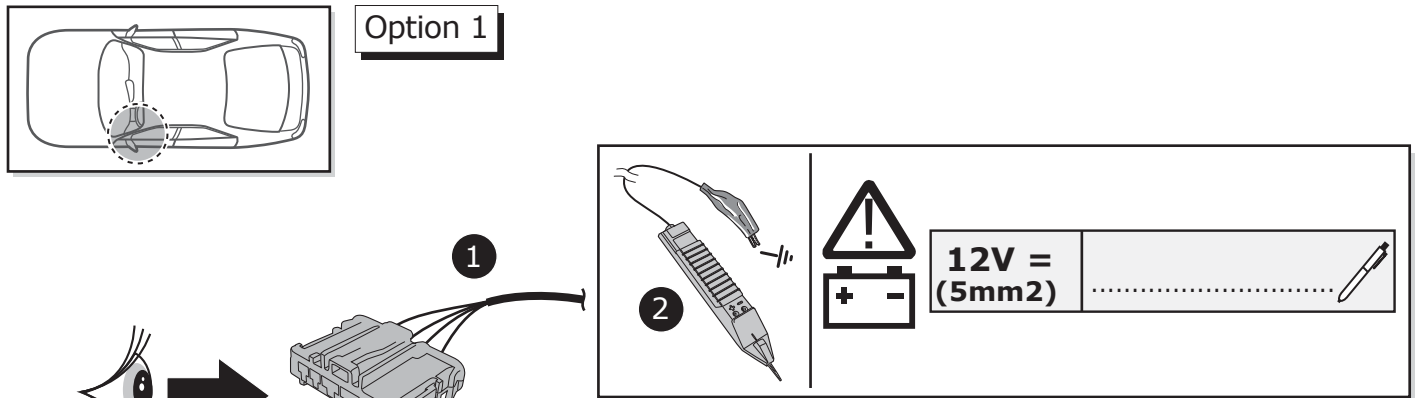

20

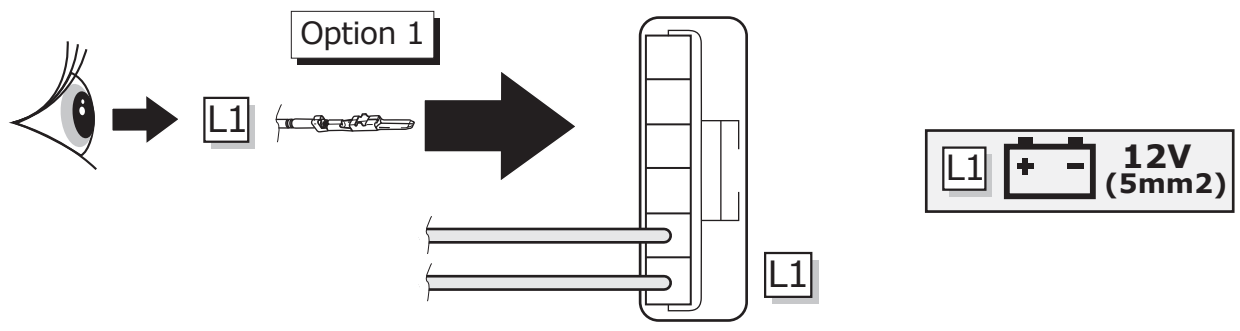

21

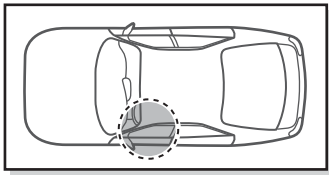

Option 1

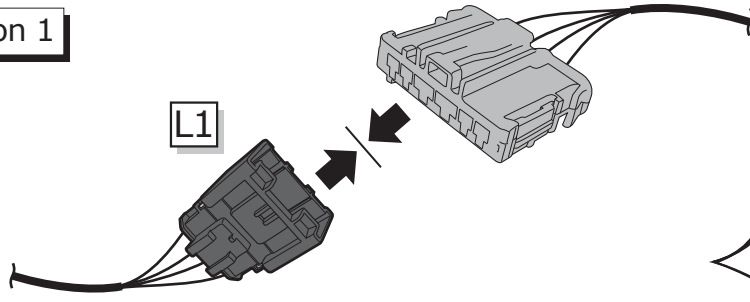

28

22

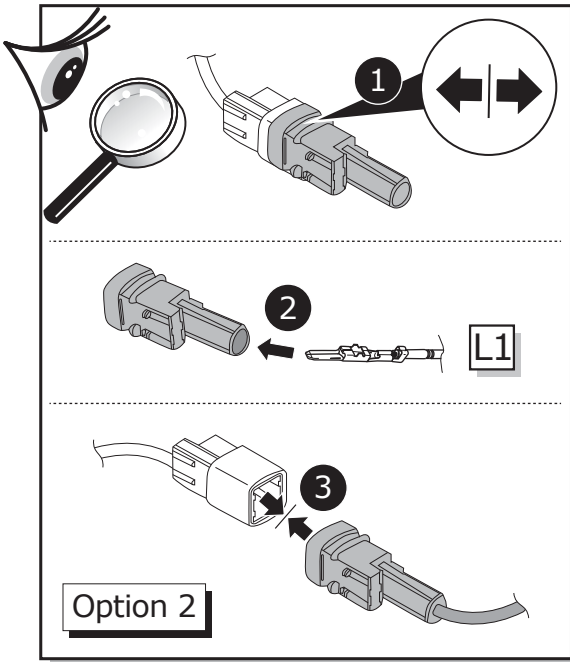

Option 2

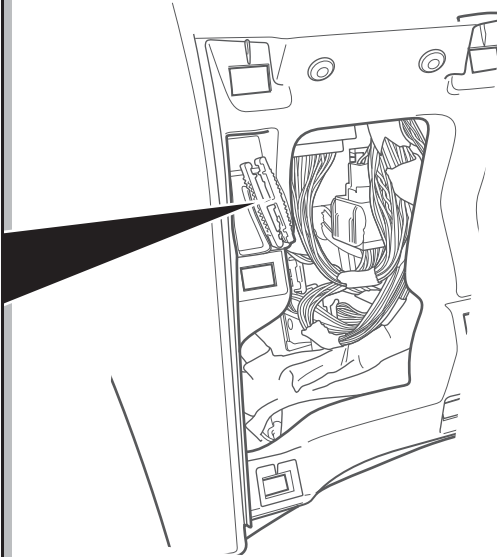

28

23

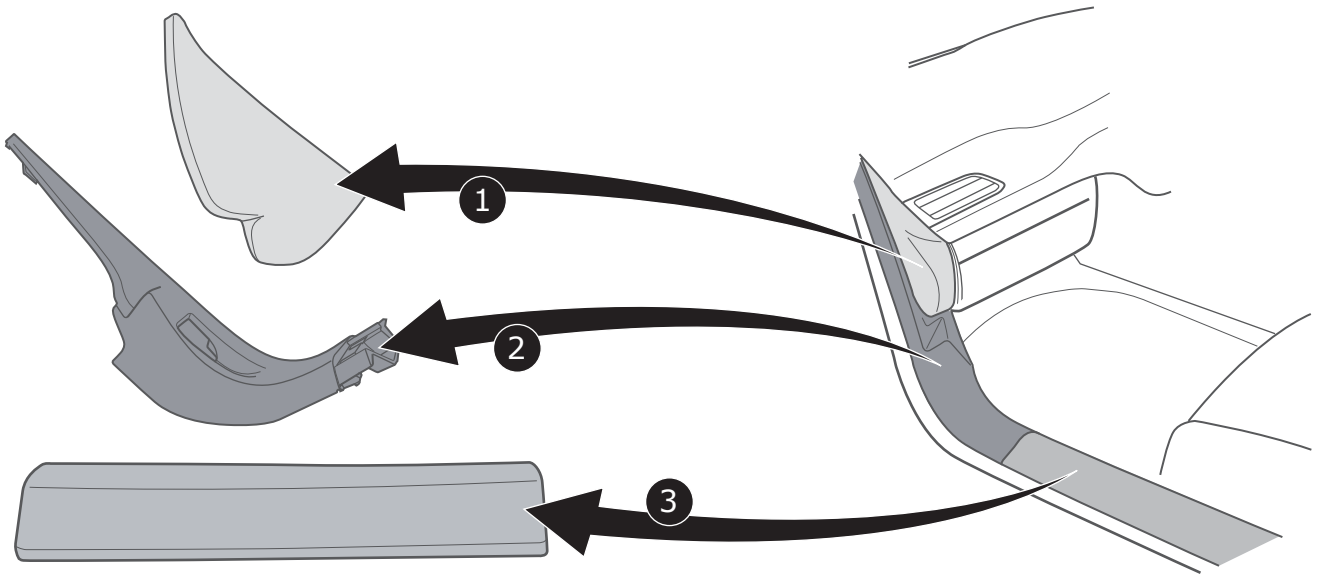

24

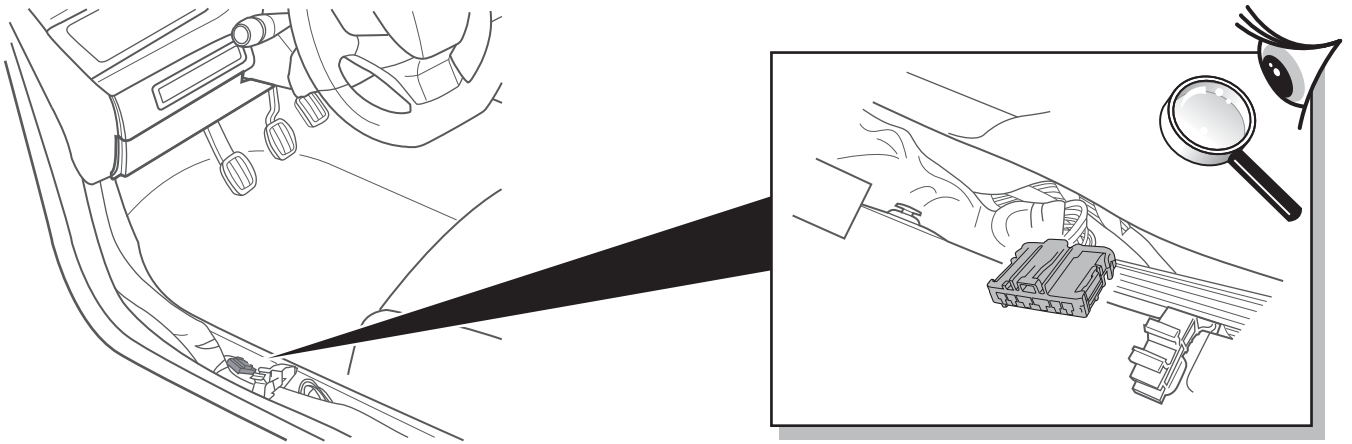

25

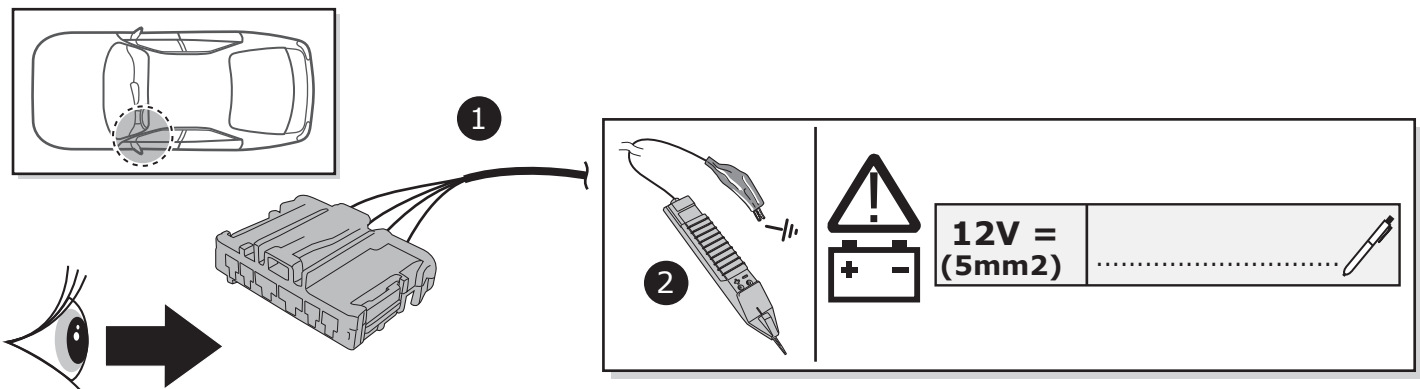

26

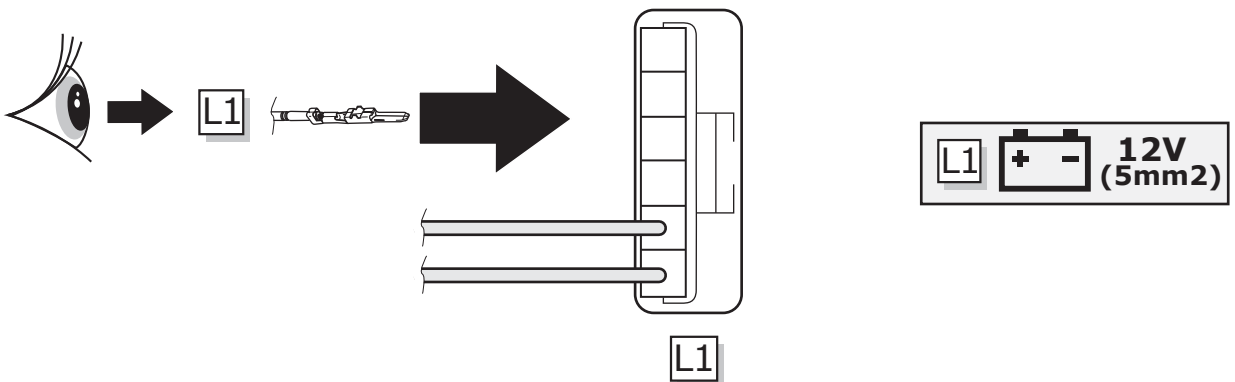

27

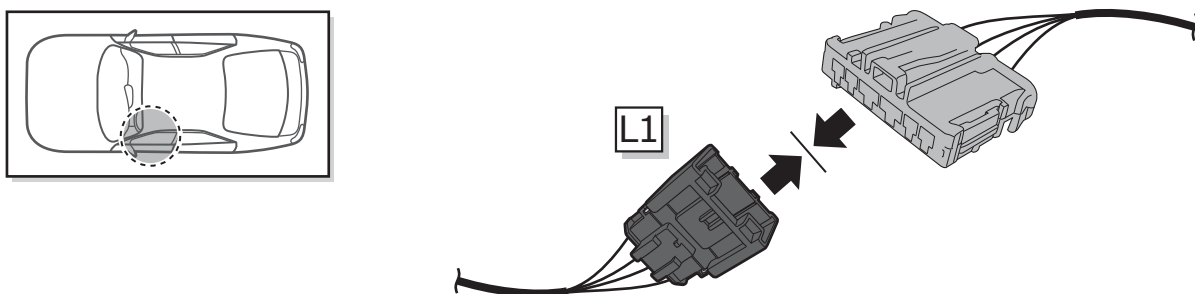

28

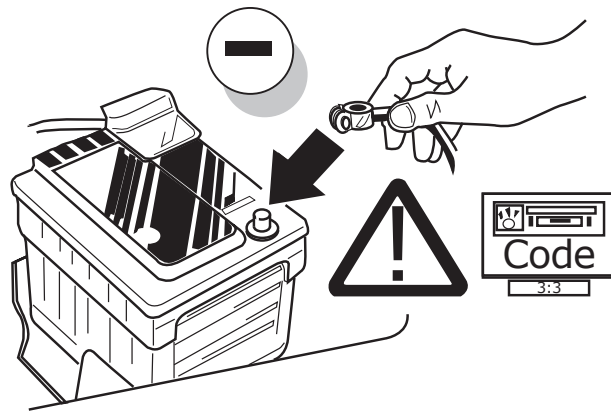

29

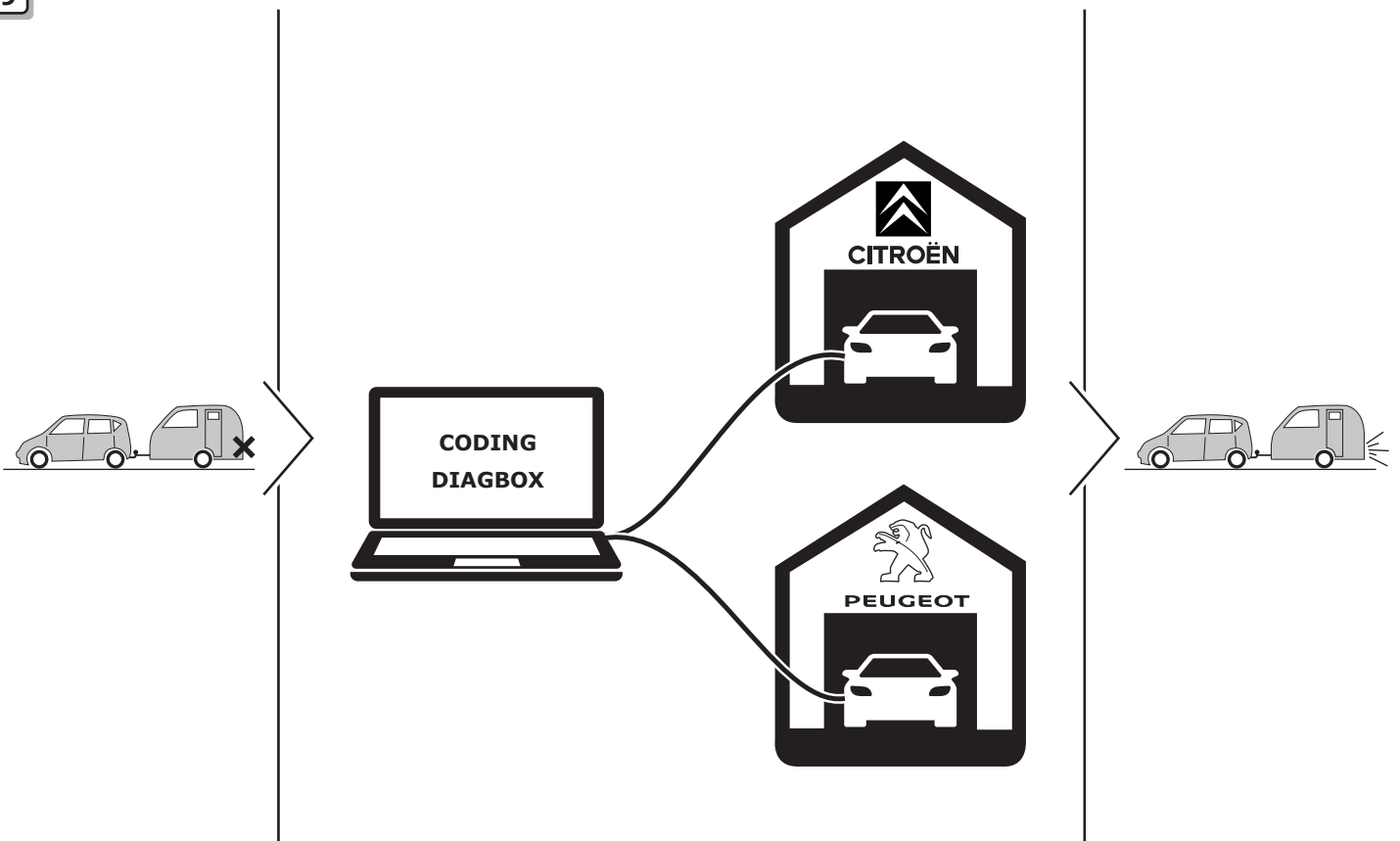

**The activation of the trailer functions has to be carried out using the CITROËN/PEUGEOT DIAGBOX as follows:**

- choose vehicle
- delivery
- equipment
- trailer control unit (BSR)
- installation of equipment



30

TEST ALL THE CIRCUITS WITH A TEST DEVICE WITH THE CORRECT POWER LOAD FOR EACH FUNCTION. A TEST DEVICE WITH LED'S CANNOT BE USED FOR THIS PURPOSE.

INFO

REINSTALL TRIM.

31

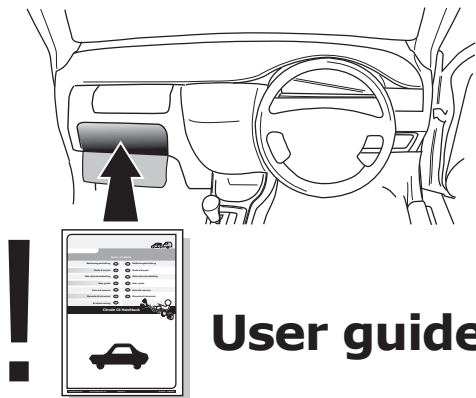

INFO

SOCKET CONNECTION

|               |        |      |       |       |       |                             |       |               |                 |                             |       |   |       |
|---------------|--------|------|-------|-------|-------|-----------------------------|-------|---------------|-----------------|-----------------------------|-------|---|-------|
| DIN/ISO 11446 |        |      |       |       |       |                             |       |               |                 |                             |       | — |       |
| Pmax          | 21W    | 21W  |       | 21W   | 52W   | 3x21W                       | 52W   | 21W           | 180W/15Amp      | 180W/15Amp                  |       |   |       |
| Colour        | Yellow | Blue | White | Green | Brown | Red<br>1,00 mm <sup>2</sup> | Black | Black/<br>Red | Brown/<br>White | Red<br>2,50 mm <sup>2</sup> | White | - | White |