

**Ford Transit Custom 11/2012 >>**

**Partnr.: FR-058-ZZU**

- Extension kit.
- We would expressly point out that assembly not carried out properly by a competent installer will result in cancellation of any right to damage compensation, in particular those arising by virtue of the product liability act.
- Contents of these kits and their fitting manuals are subject to alteration without notice, please ensure that these instructions are read and fully understood before commencing installation.
- In the event of functional problems, troubleshooting must be limited to about 0.5 hours, contact the ECS Helpline:  
[ukts@ecs-electronics.com](mailto:ukts@ecs-electronics.com) / 07440 202 052.



# Part list

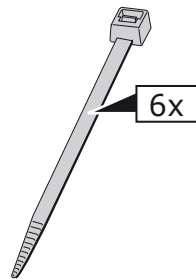
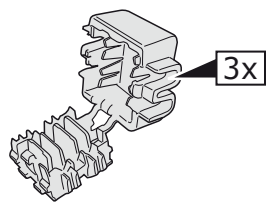
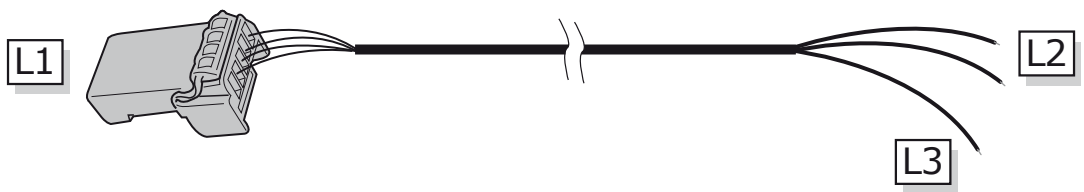
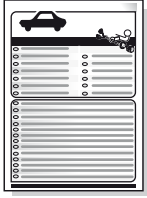
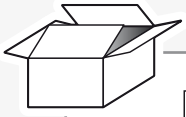

**ROUTING**

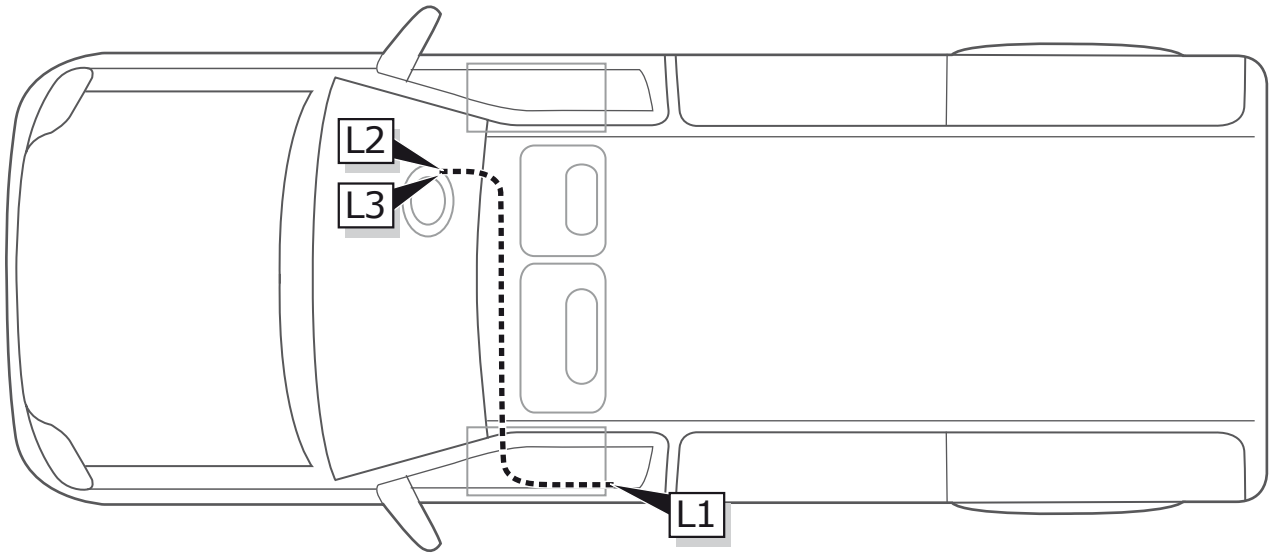

**1**

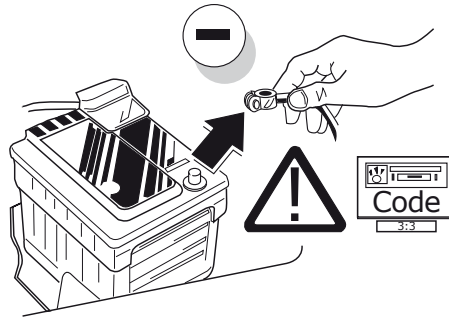

**2**

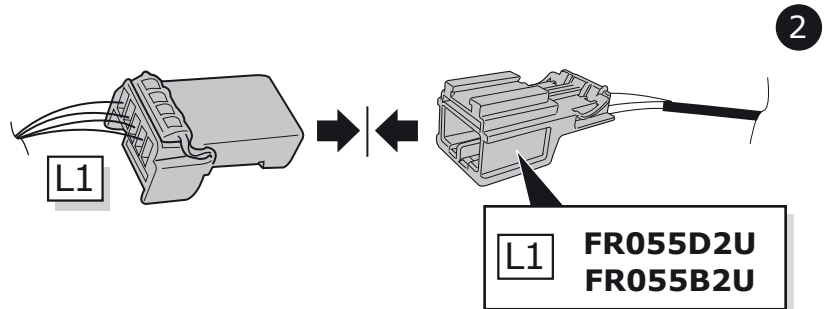
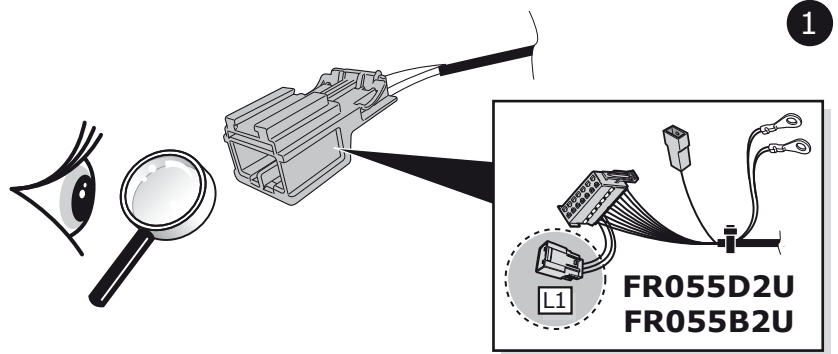
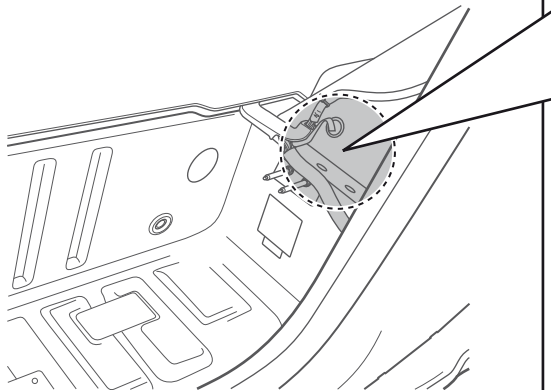
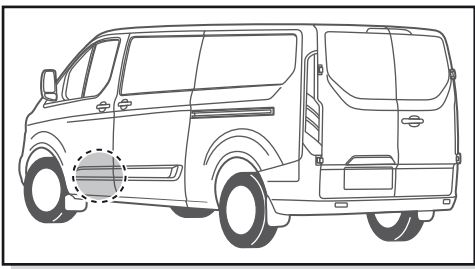

3

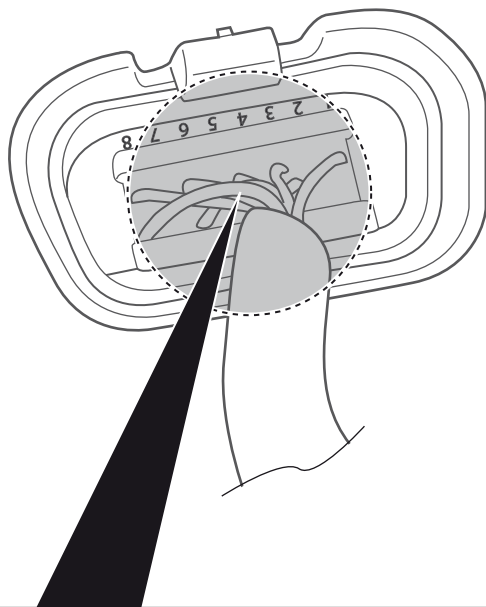
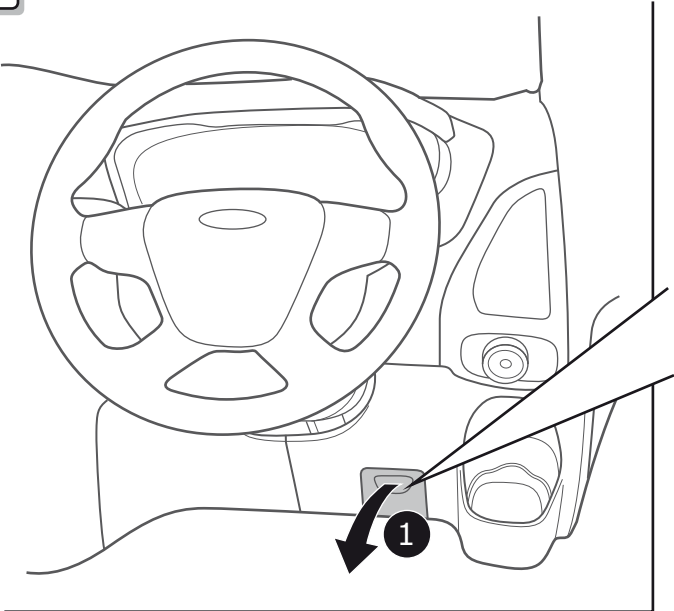

**CAN H**

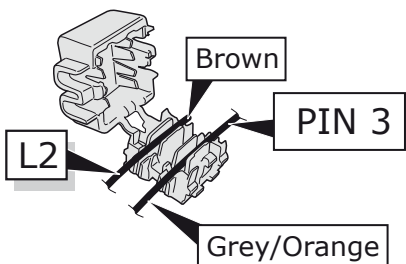

2

**CAN L**

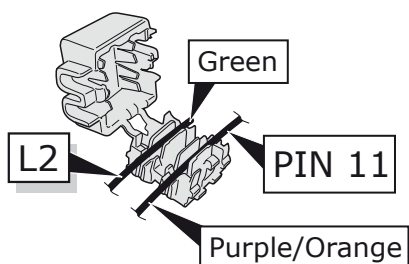

4

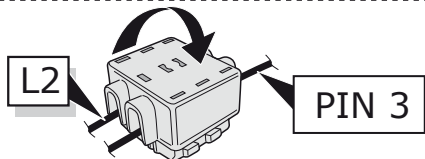

3

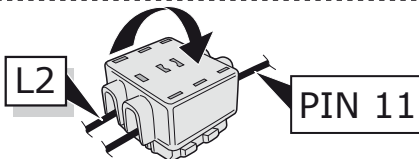

5

3

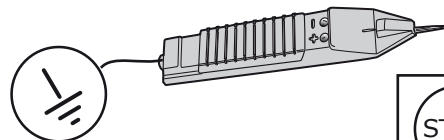
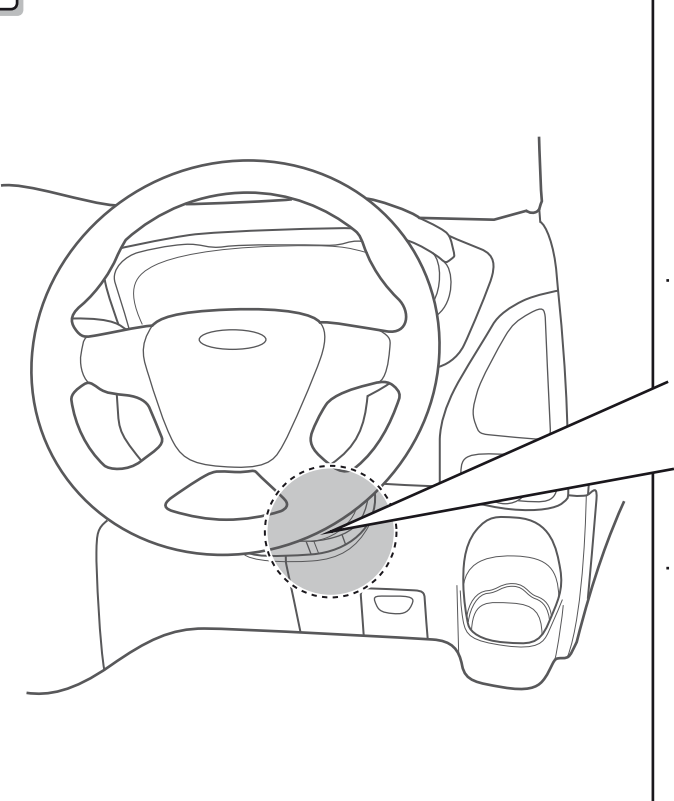

1

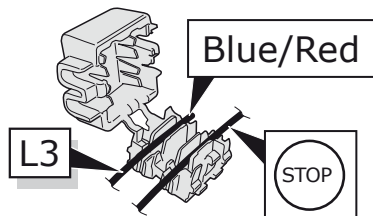

2

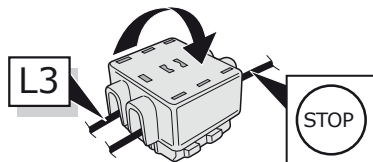

3

4

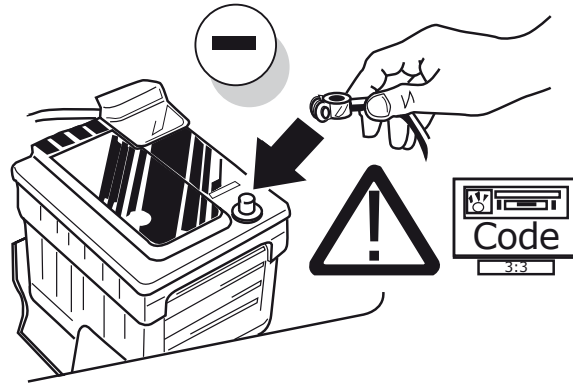

5



TEST ALL THE CIRCUITS WITH A TEST DEVICE WITH THE CORRECT POWER LOAD FOR EACH FUNCTION. A TEST DEVICE WITH LED'S CANNOT BE USED FOR THIS PURPOSE.

INFO

