

Mercedes Vito / Viano 08/2005-

Partnr.: MB-066-ZZU

- Extension kit.
- We would expressly point out that assembly not carried out properly by a competent installer will result in cancellation of any right to damage compensation, in particular those arising by virtue of the product liability act.
- Contents of these kits and their fitting manuals are subject to alteration without notice, please ensure that these instructions are read and fully understood before commencing installation.
- In the event of functional problems, troubleshooting must be limited to about 0.5 hours, contact the ECS Helpline:
t.skinner@ecs-electronics.com / 07440 202 052.



Part list

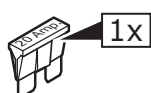
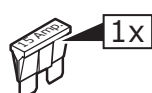
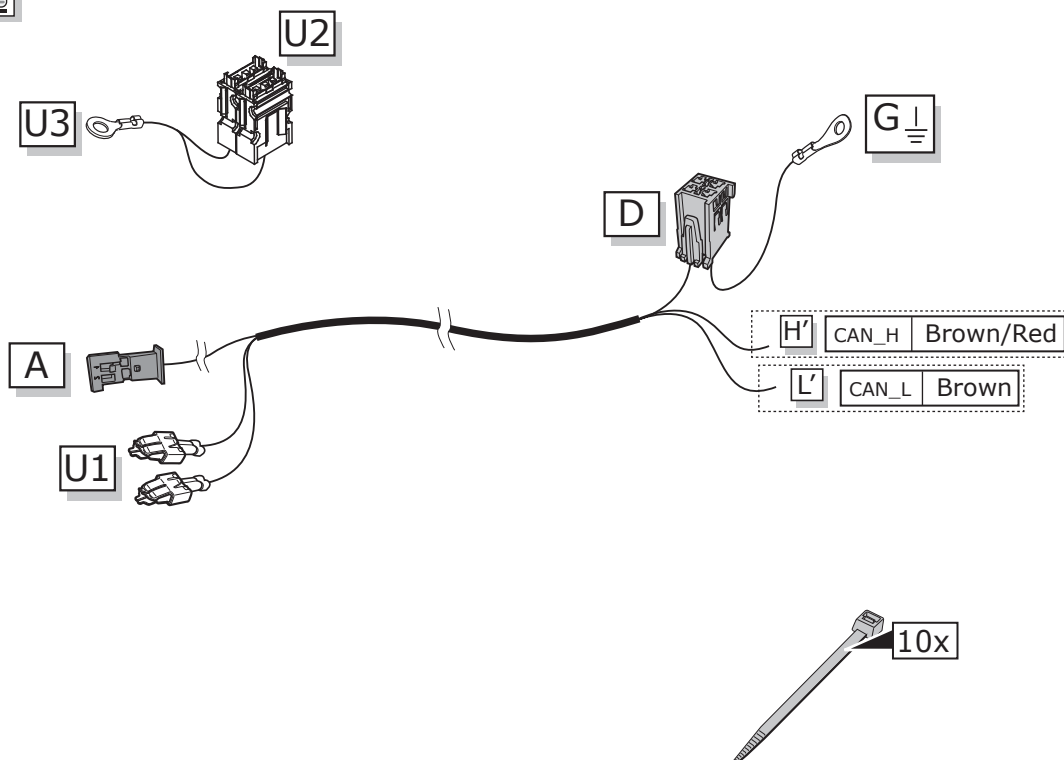
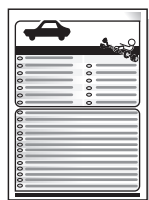

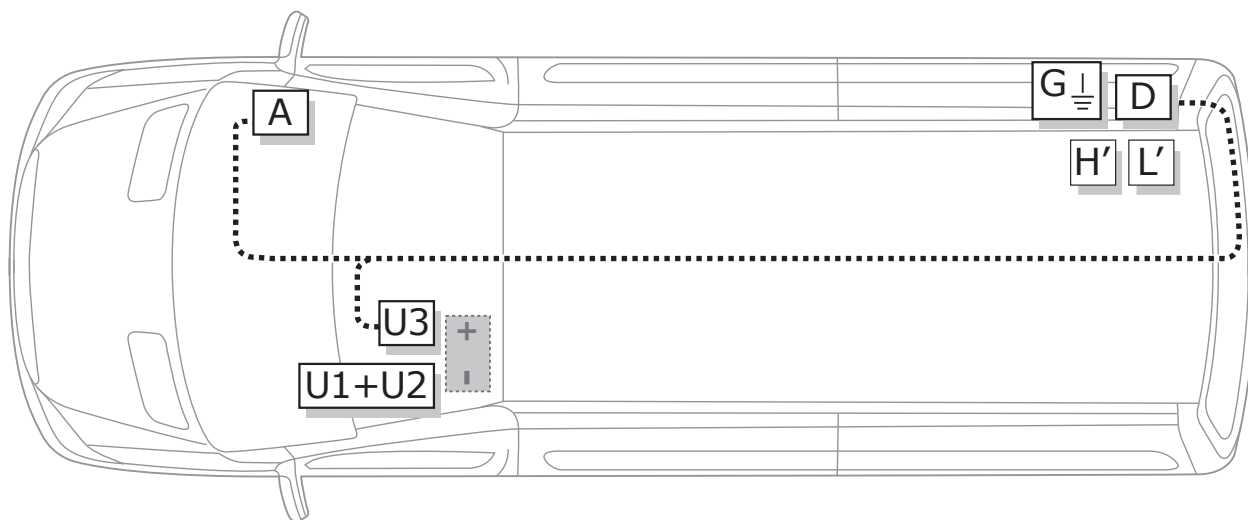

1

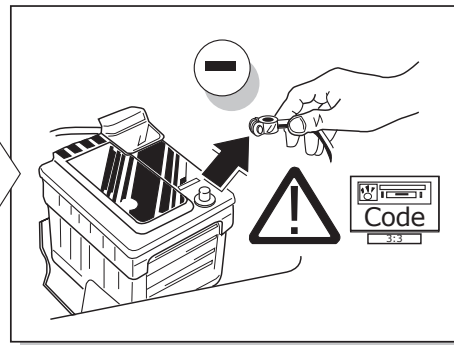
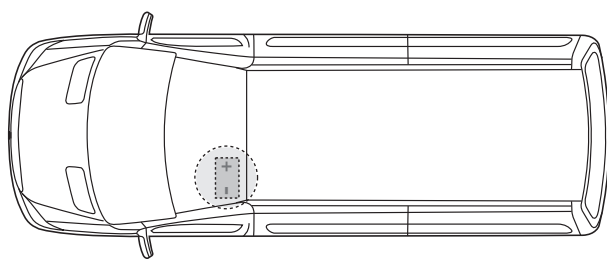

2

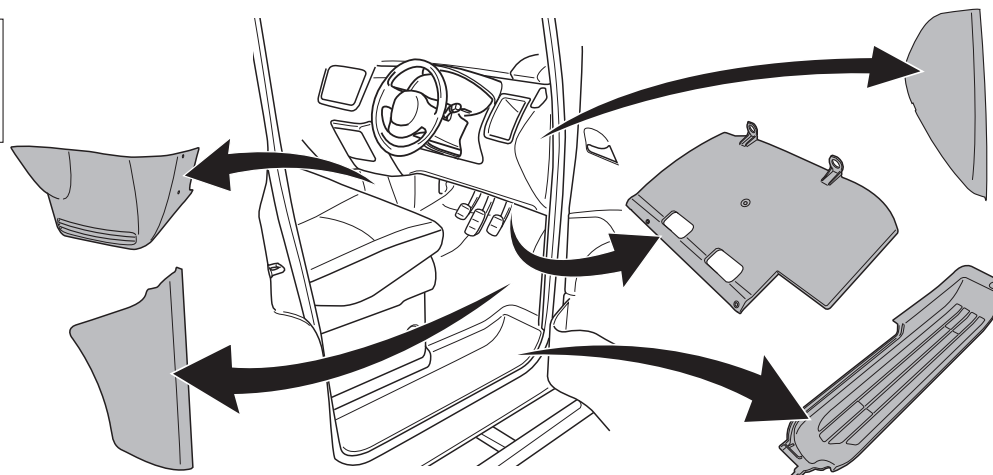
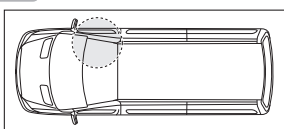

3

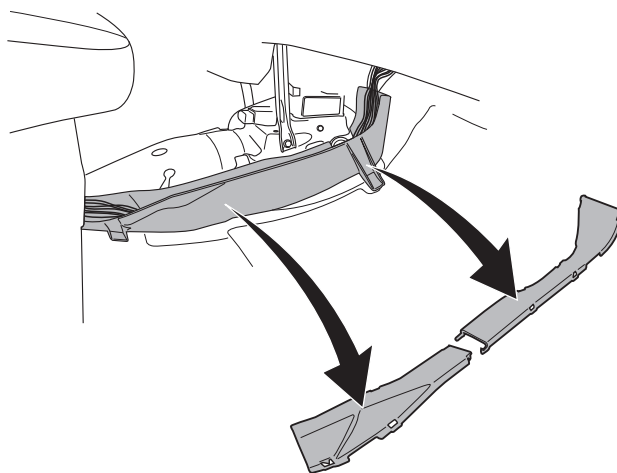
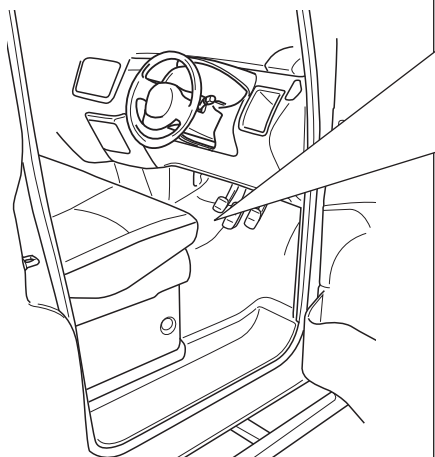
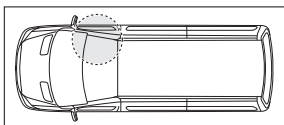

4

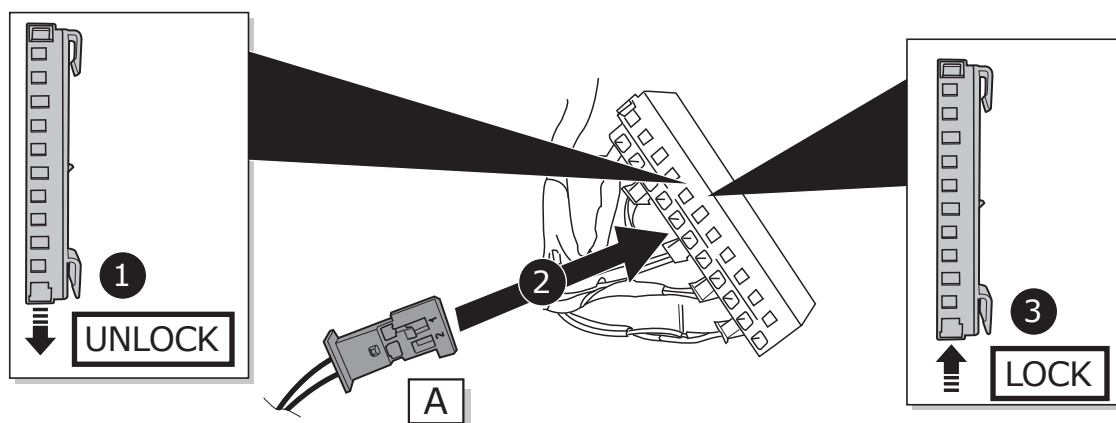
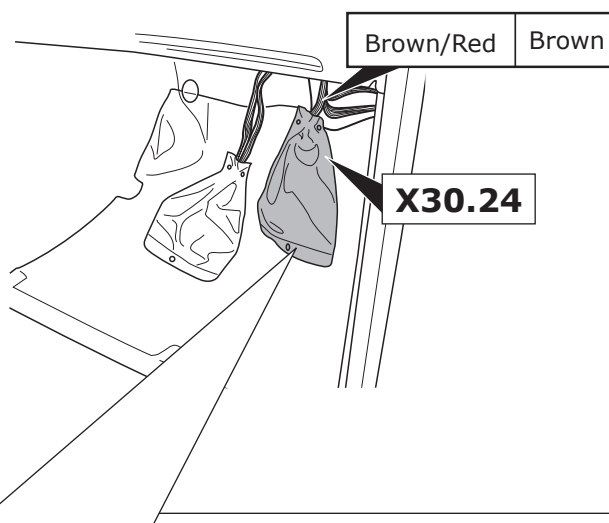
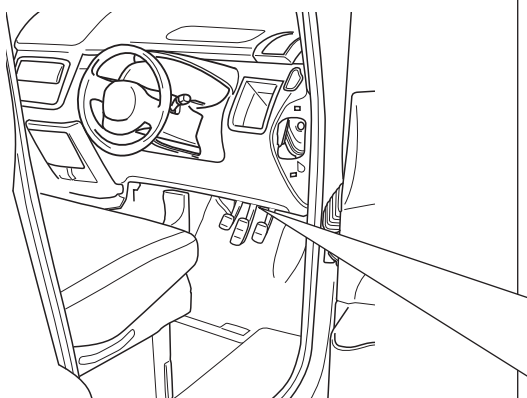
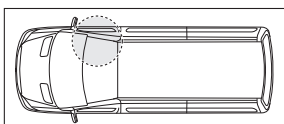

5

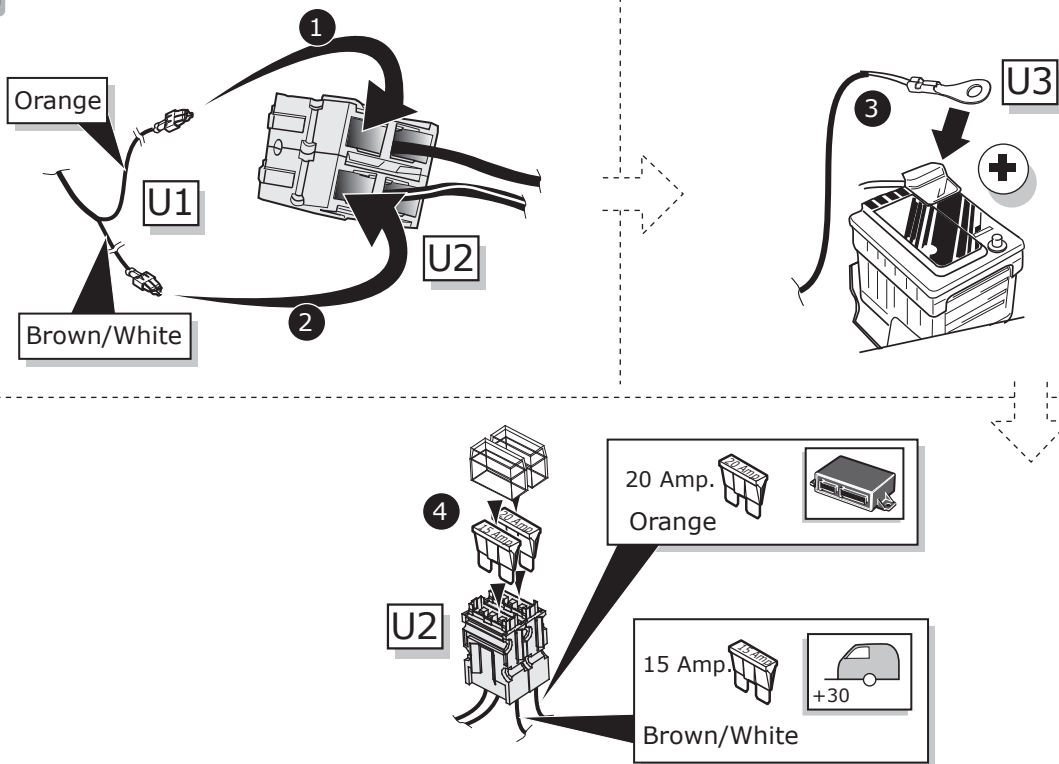

6

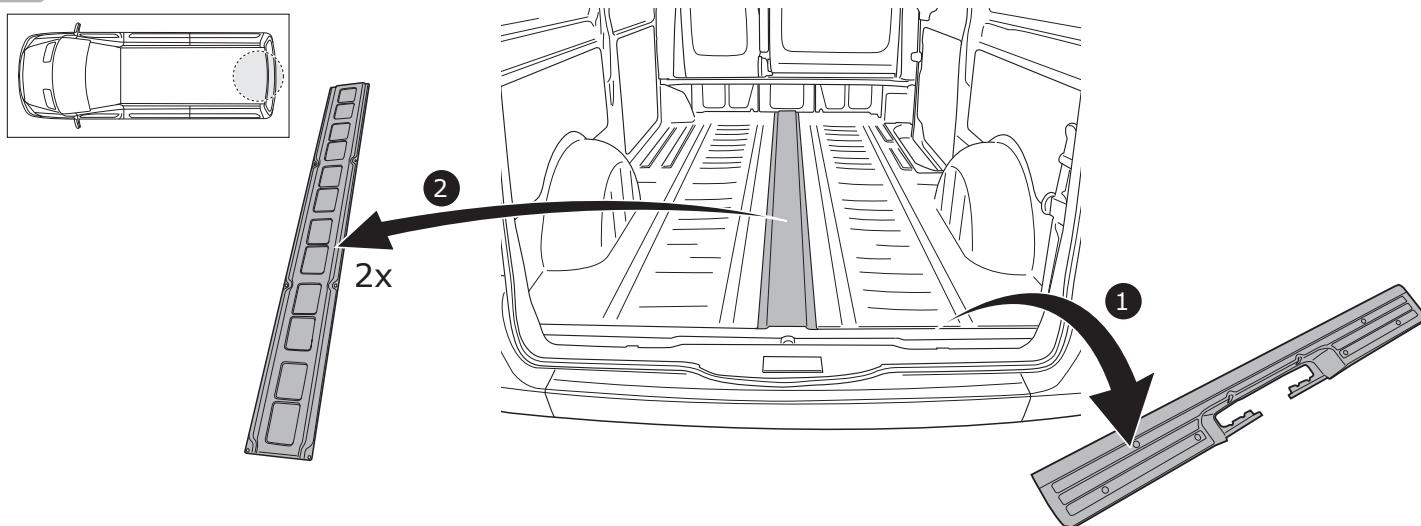

7

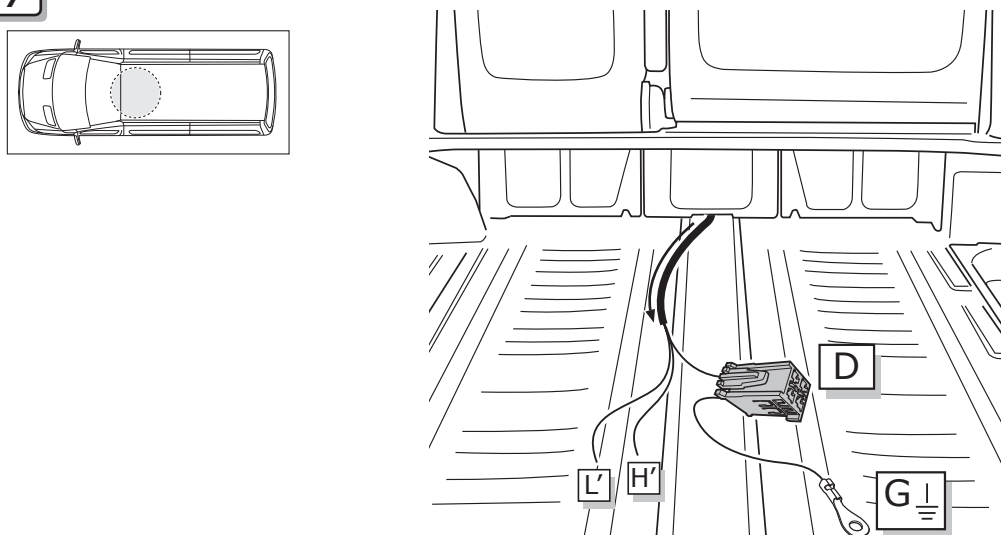

8

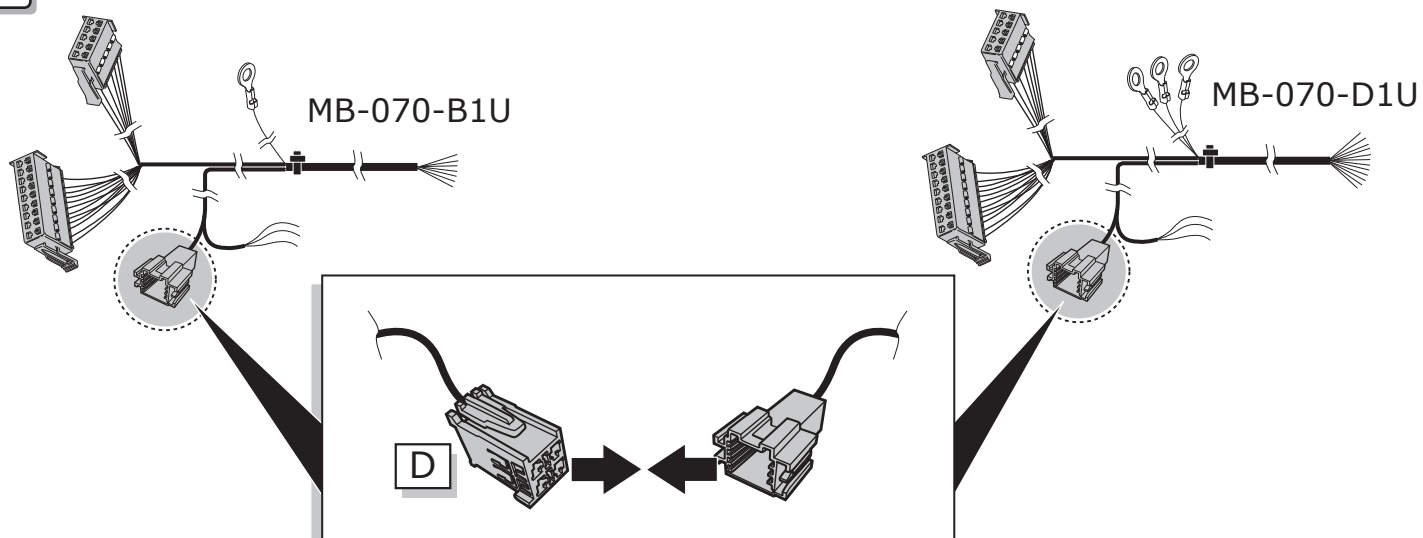

9

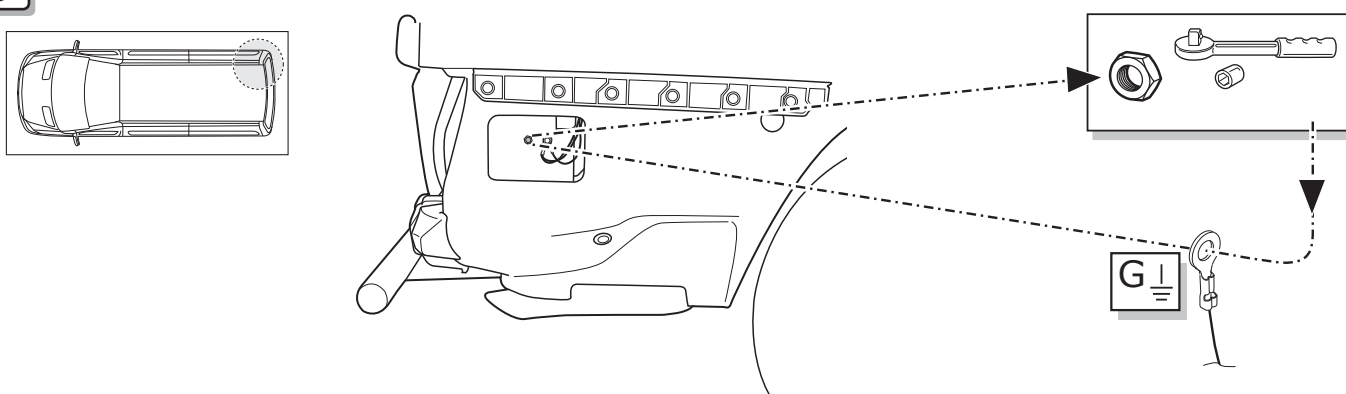

10

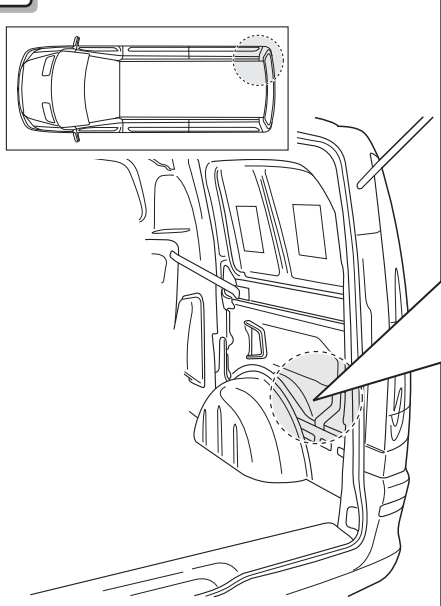

MB-070-B1U / MB-070-D1U



T

STOP

Blue/Red

N.B.: To solder and isolate carefully!



1

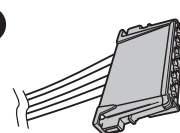

Pos.5

STOP

!

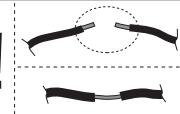

X

V

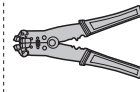

2

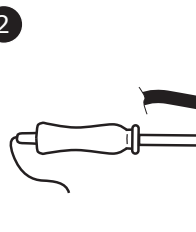

Pos.5

STOP

T

3



11

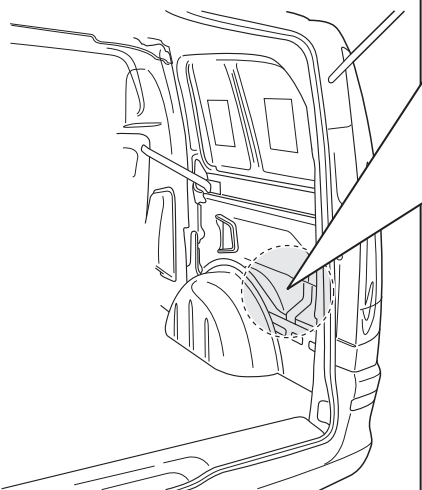
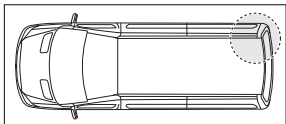

N.B.: To solder and isolate carefully!



MB-070-B1U / MB-070-D1U

CAN_H Brown/Red

H

L

Brown CAN_L

1

CAN_H Brown/Red

MB-066-ZZU

H'

H

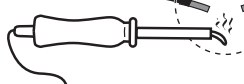

CAN_H Brown/Red

MB-070-B1U / MB-070-D1U

2



1

CAN_L Brown

MB-066-ZZU

L'

L

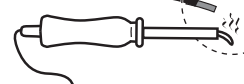

CAN_L Brown

MB-070-B1U / MB-070-D1U

2



12

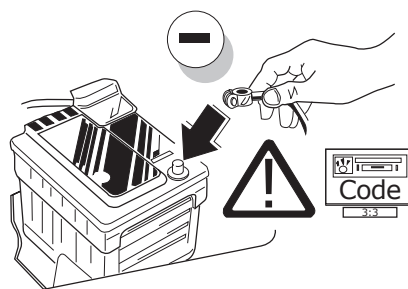

13



TEST ALL THE CIRCUITS WITH A TEST DEVICE WITH THE CORRECT POWER LOAD FOR EACH FUNCTION. A TEST DEVICE WITH LED'S CANNOT BE USED FOR THIS PURPOSE.

REINSTALL TRIM.

