

**Nissan X-trail 10/2007-
Nissan Qashqai 2007-
Nissan Qashqai+2 2008-**

Partnr.: NI-041-BHU

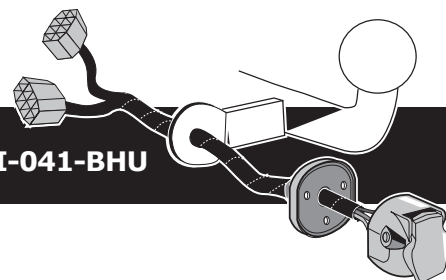

- Fitting instructions electric wiring kit tow bar with 12-N socket up to DIN/ISO Norm 1724.
- We would expressly point out that assembly not carried out properly by a competent installer will result in cancellation of any right to damage compensation, in particular those arising by virtue of the product liability act.
- Contents of these kits and their fitting manuals are subject to alteration without notice, please ensure that these instructions are read and fully understood before commencing installation.
- Do not overload circuits; the maximum loads per connection are detailed in this manual.
- Attention! Before Installation, please read this manual carefully and inform your customer to consult the vehicle owners manual to check for any vehicle modifications required before towing.
- In the event of functional problems, troubleshooting must be limited to about 0.5 hours, contact the technical support:
t.skinner@ecs-electronics.com / 07440 202 052.



Part list

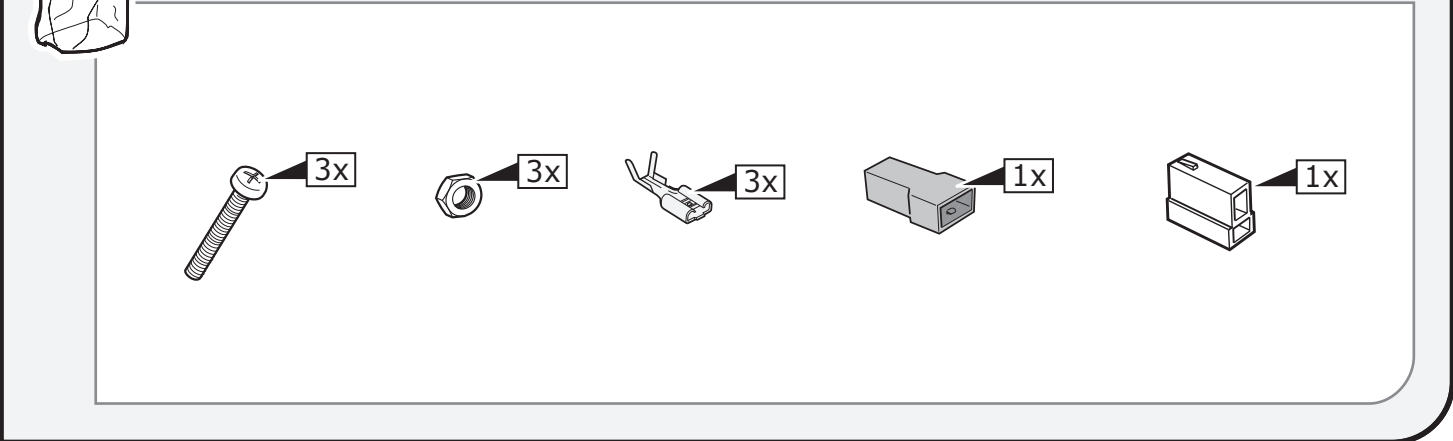

ROUTING

X-trail

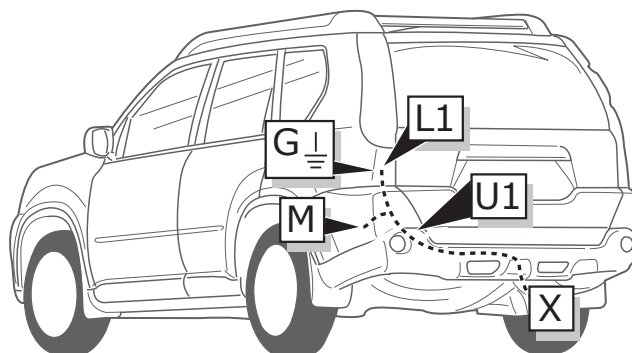

Qashqai & Qashqai+2

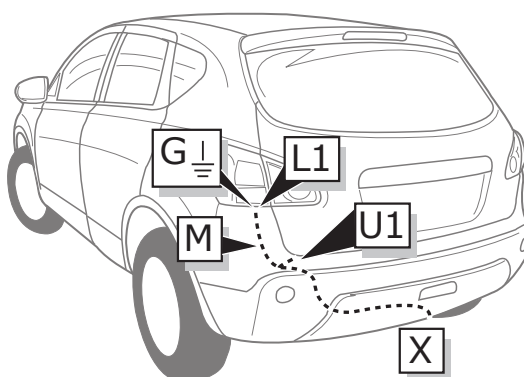

1

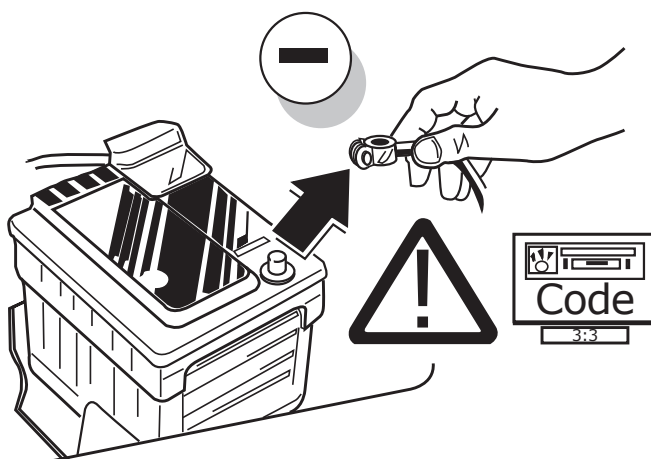

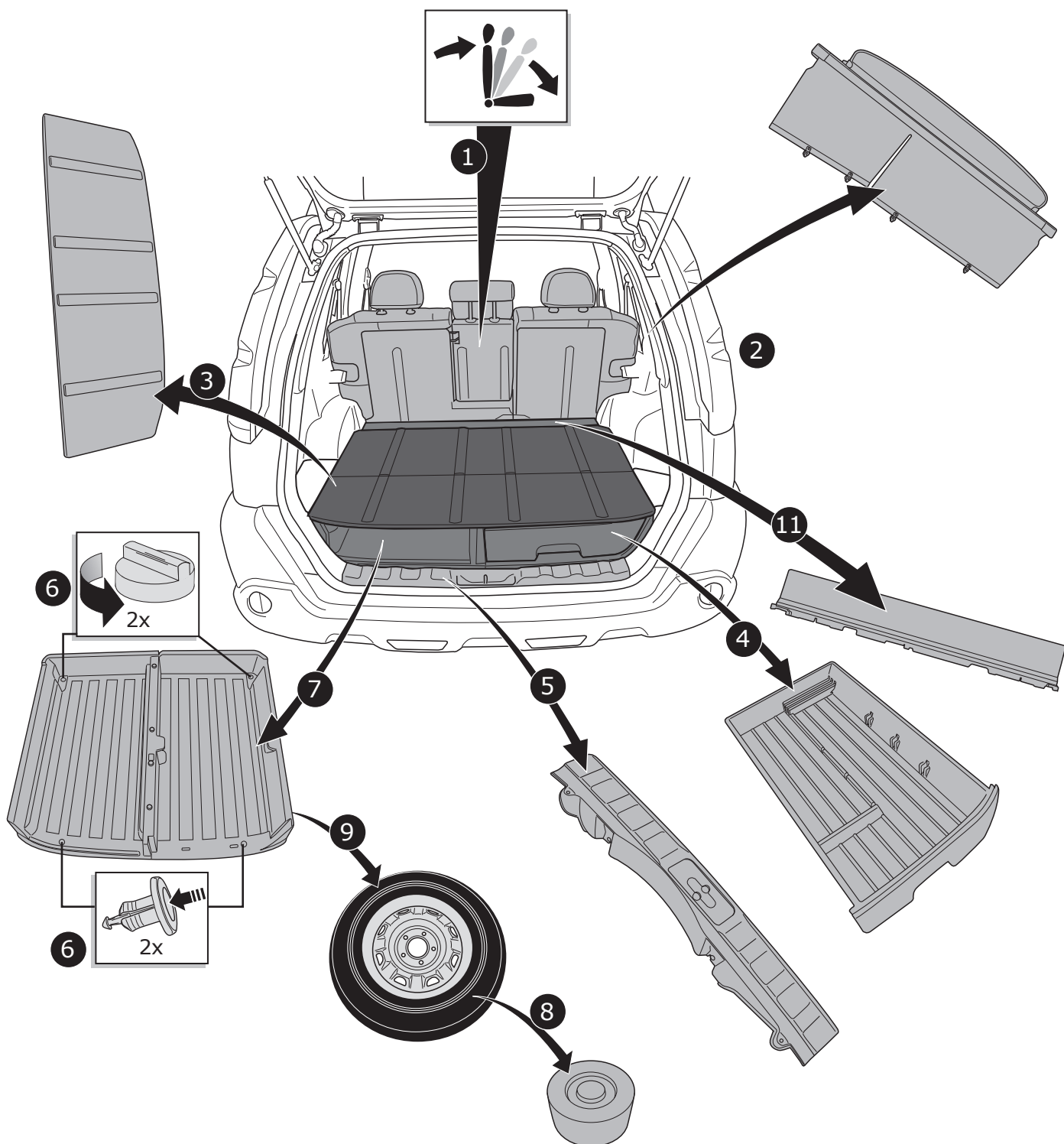

X-trail

3

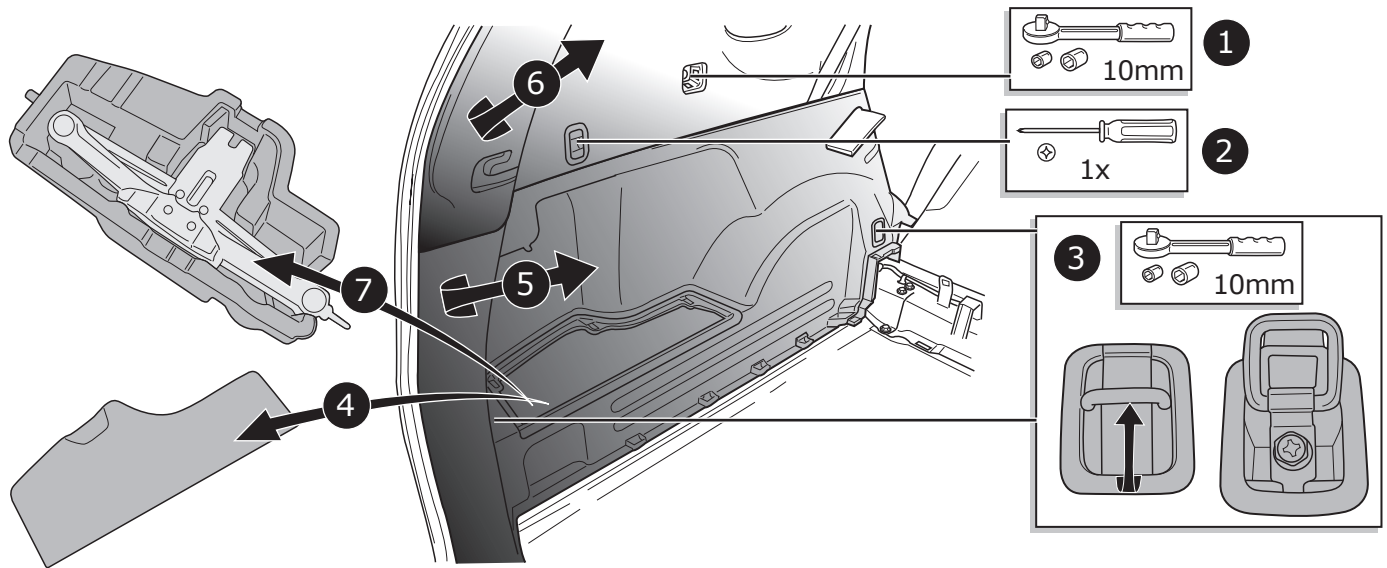

Qashqai

4

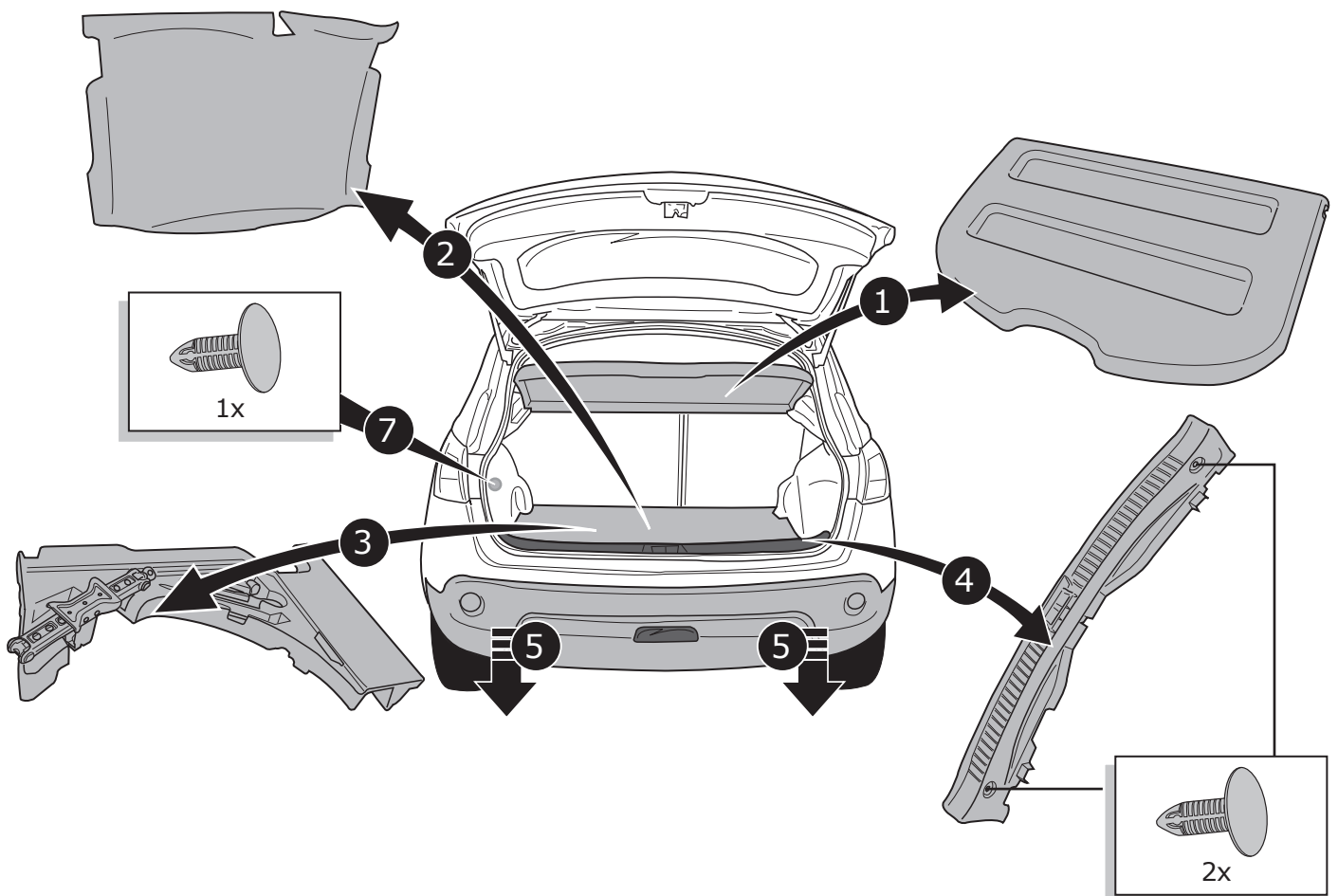

Qashqai+2

5

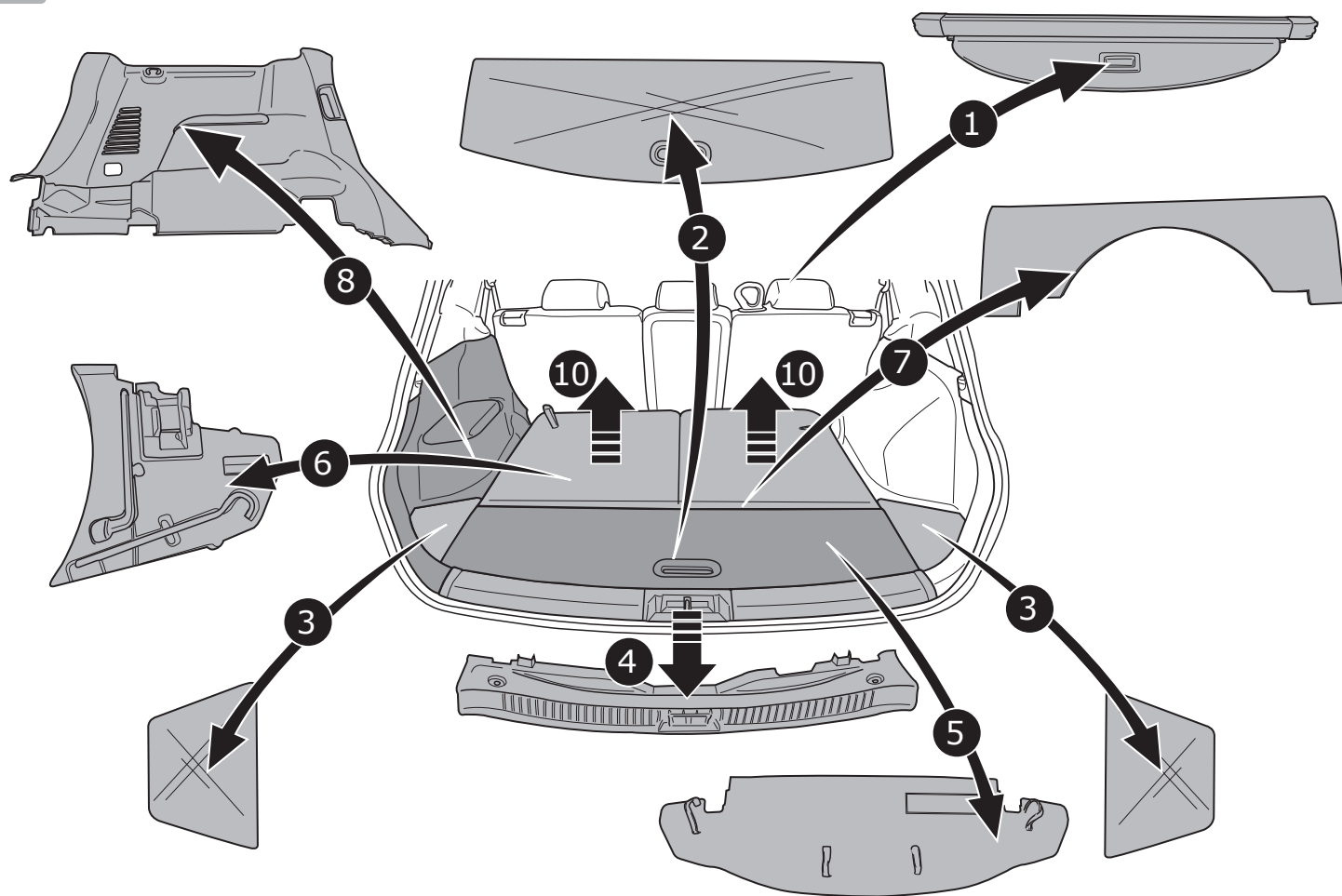

X-trail

6

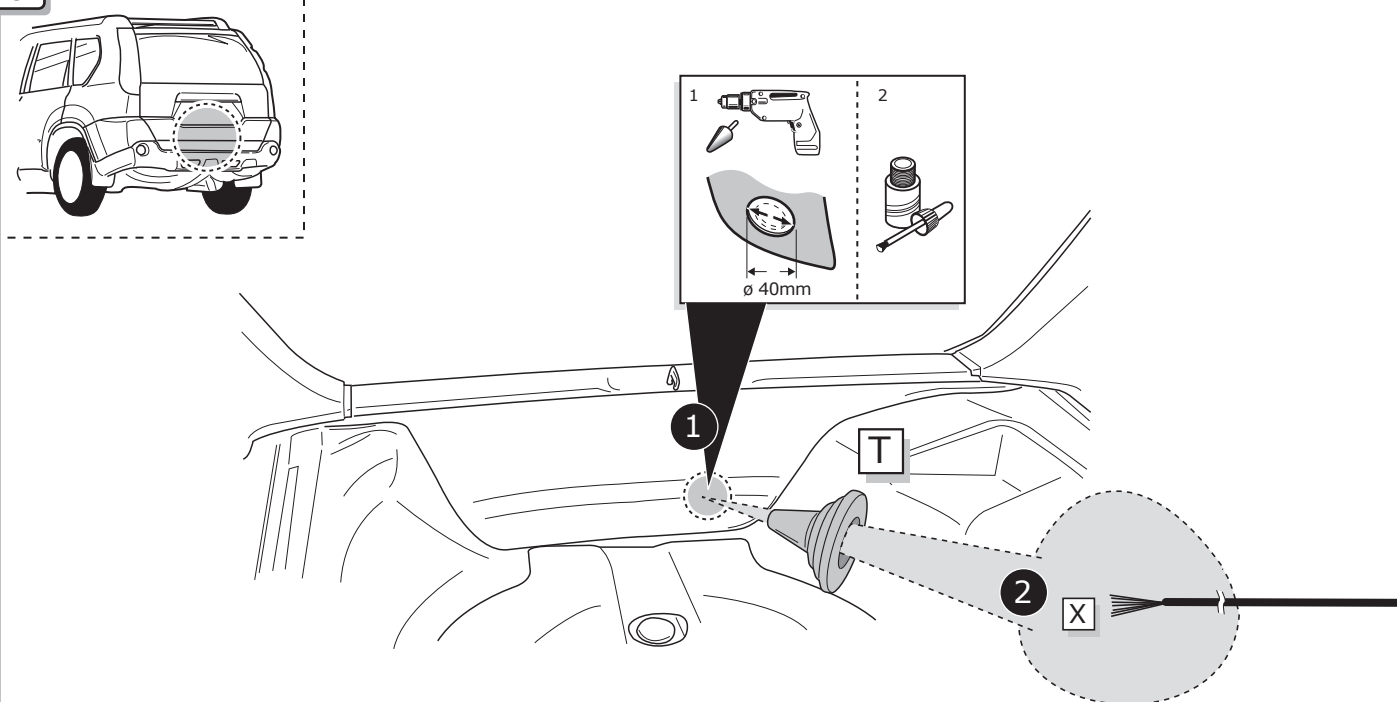

Qashqai & Qashqai+2

7

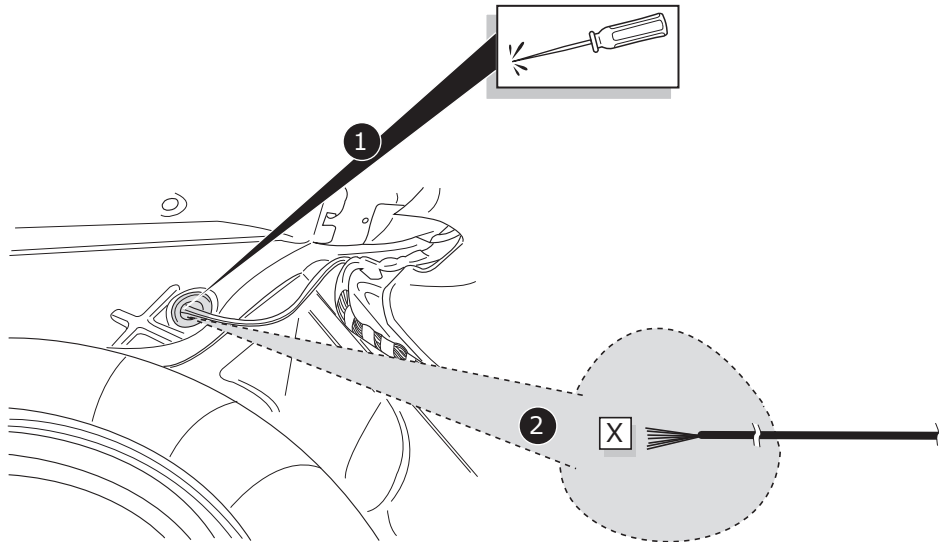
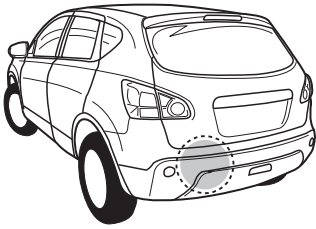

X-trail & Qashqai & Qashqai+2

A

Option 1

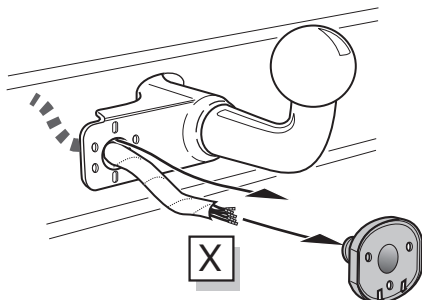

Option 2

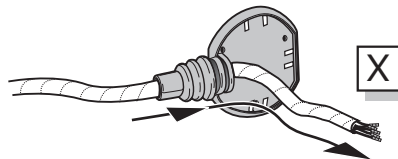

Option 3

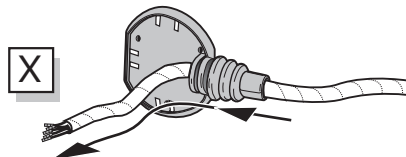

INFO

SOCKET CONNECTION



Pag. 12

B

Option 1

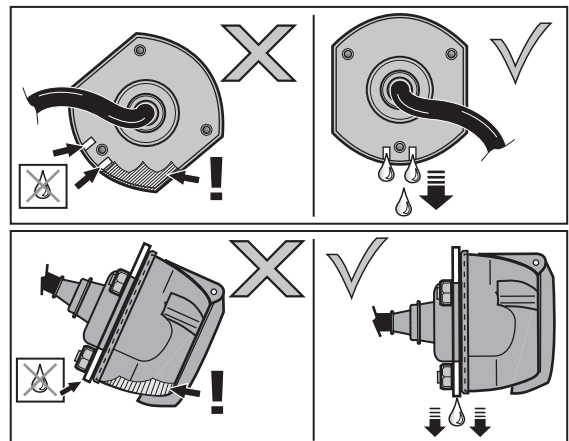
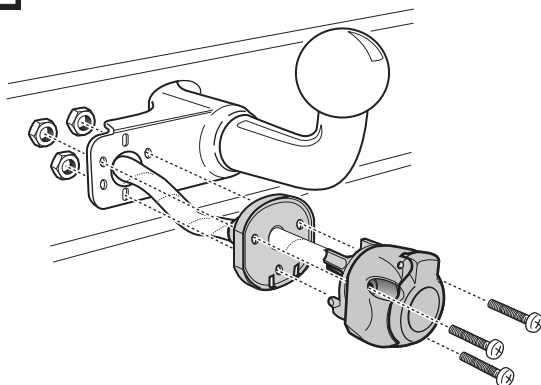

X-trail & Qashqai & Qashqai+2

C

Option 2

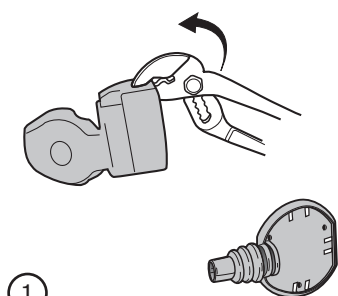

②

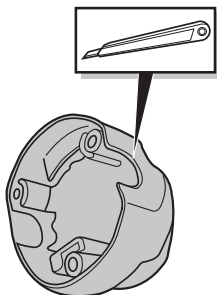

③

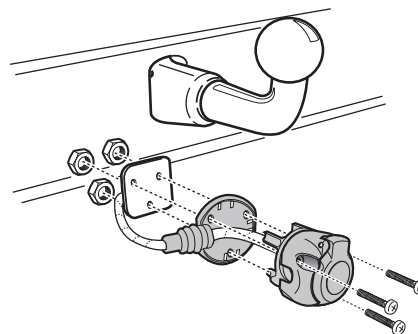

D

Option 3

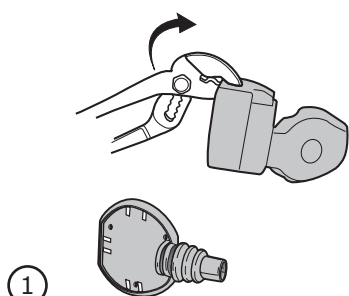

②

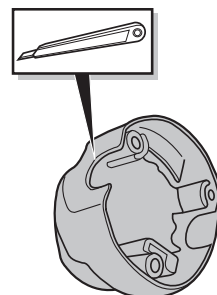

③

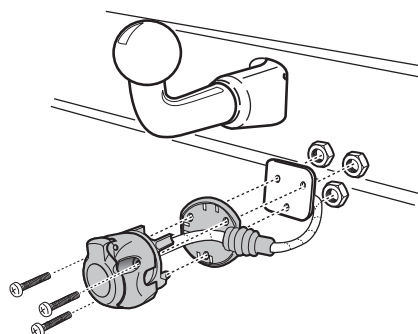

X-trail

8

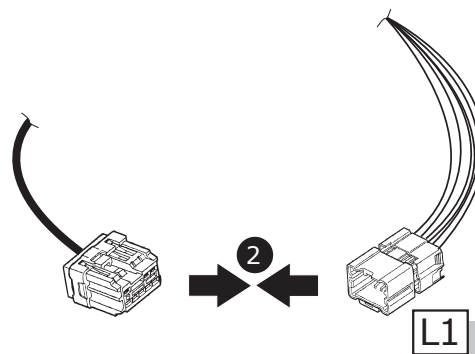
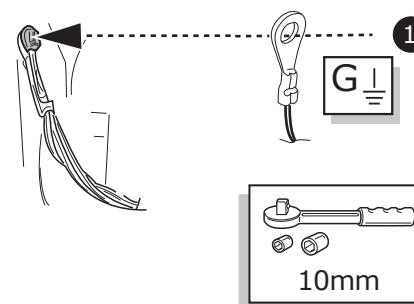
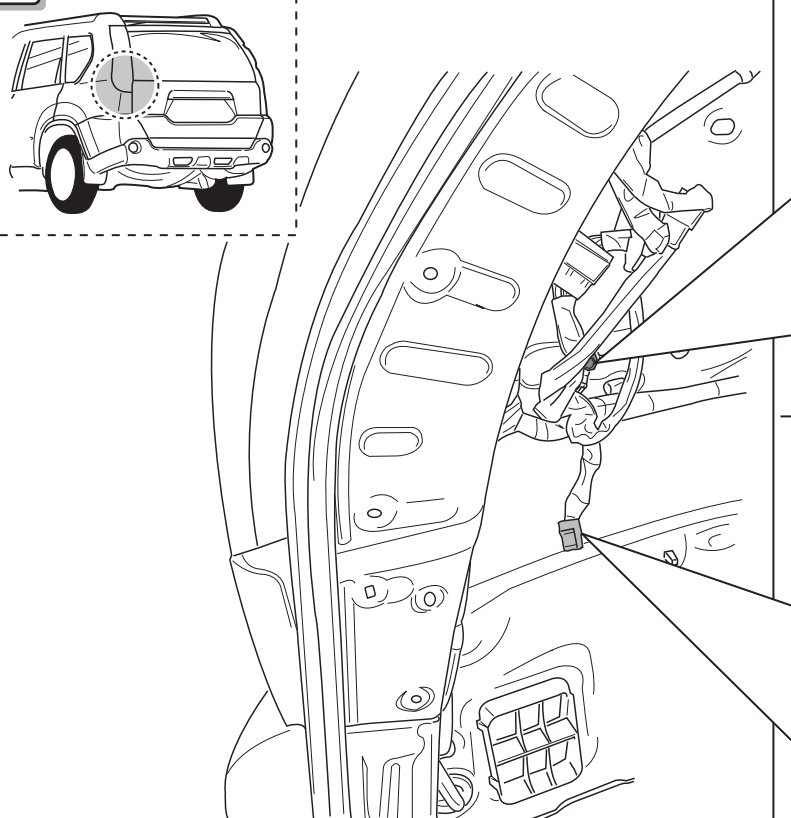

9

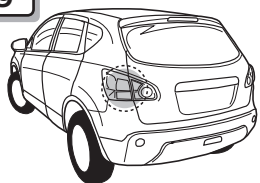

1 Qashqai & Qashqai+2

2 Qashqai

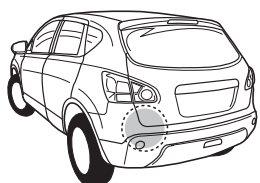
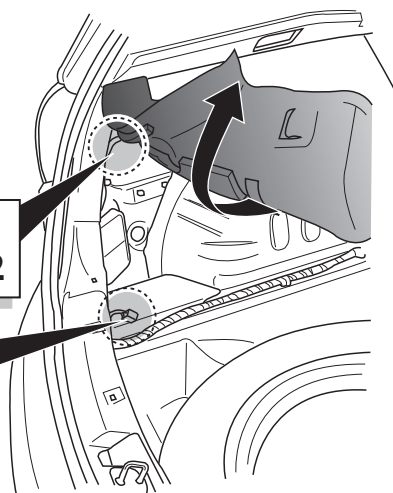
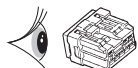

2 Qashqai+2

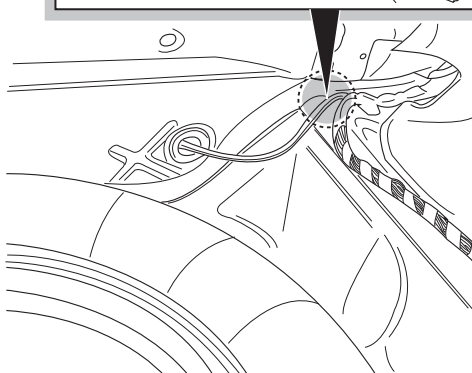
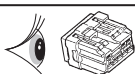

Qashqai & Qashqai+2

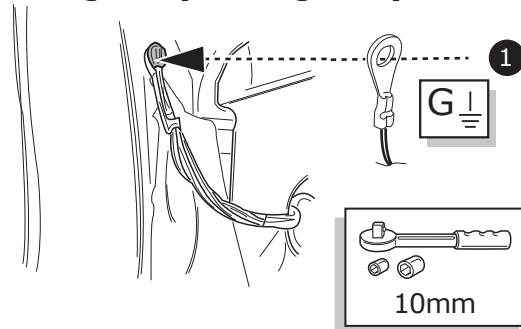

Qashqai & Qashqai+2

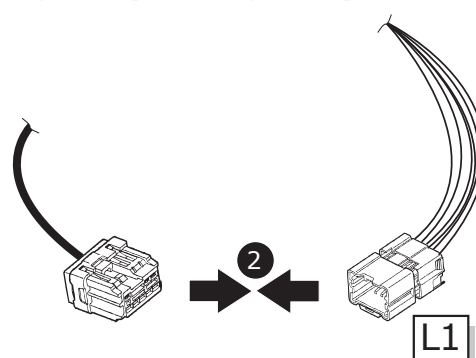

X-trail

10

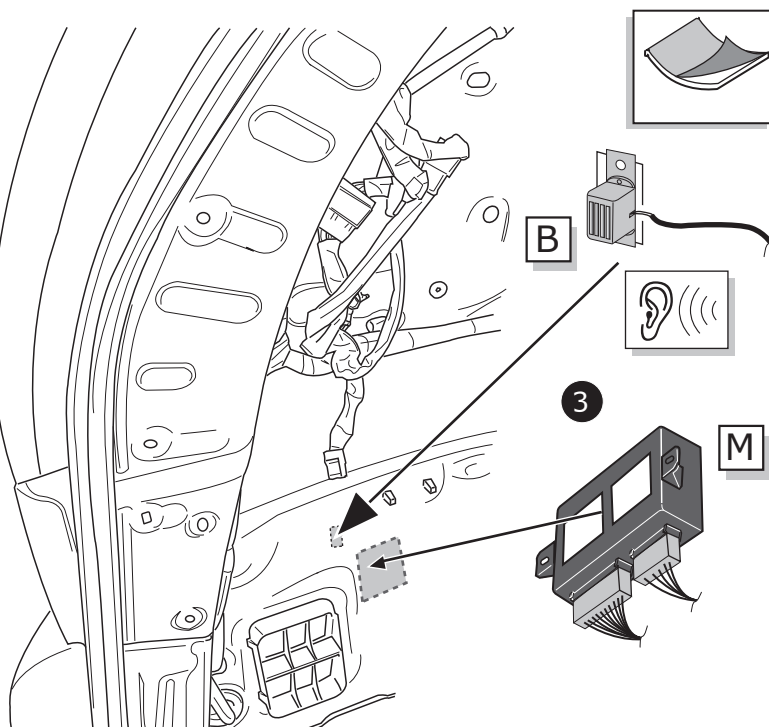
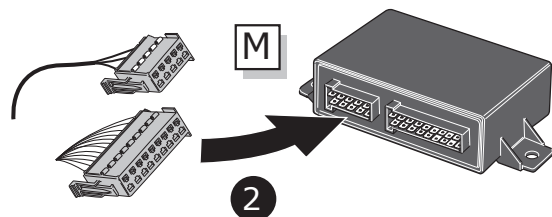
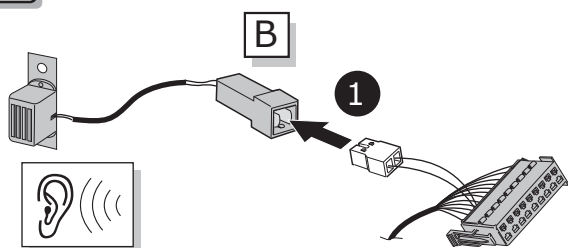

11

X-trail

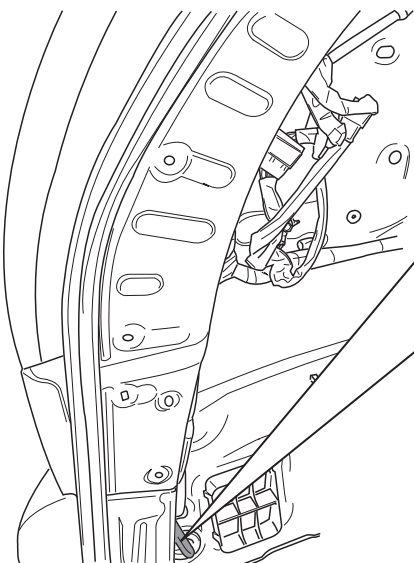

1



X-trail	Qashqai
Orange	Yellow

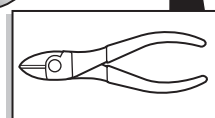

2

Qashqai & Qashqai+2

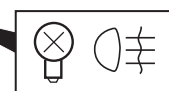
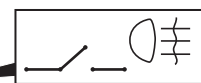
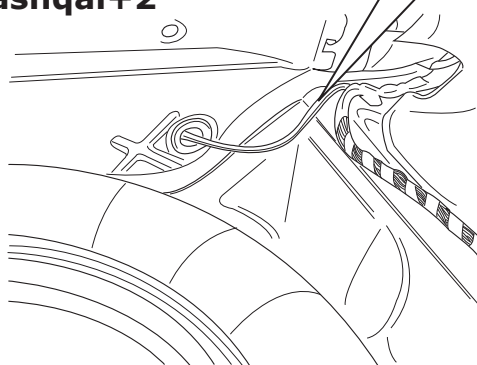

3

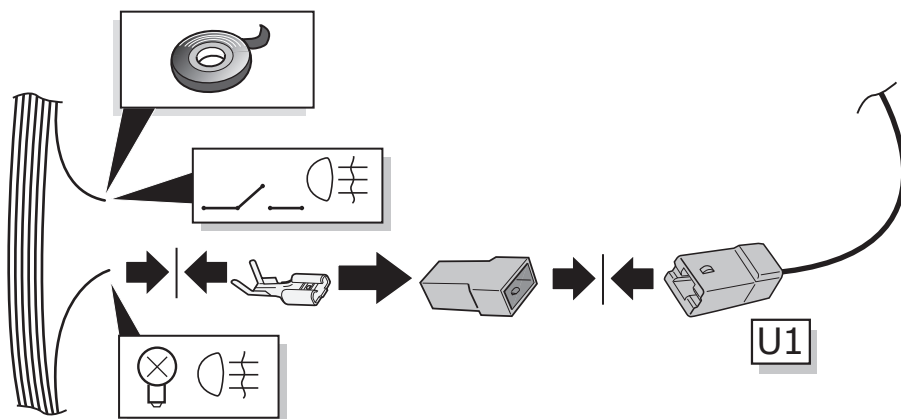

Qashqai & Qashqai+2

12

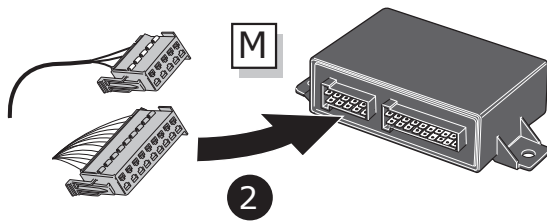
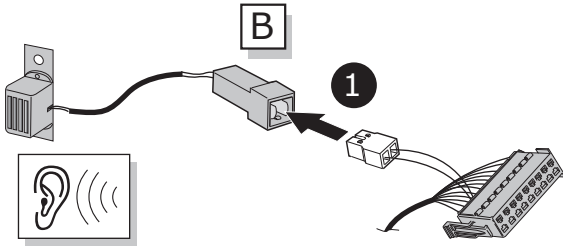

Qashqai

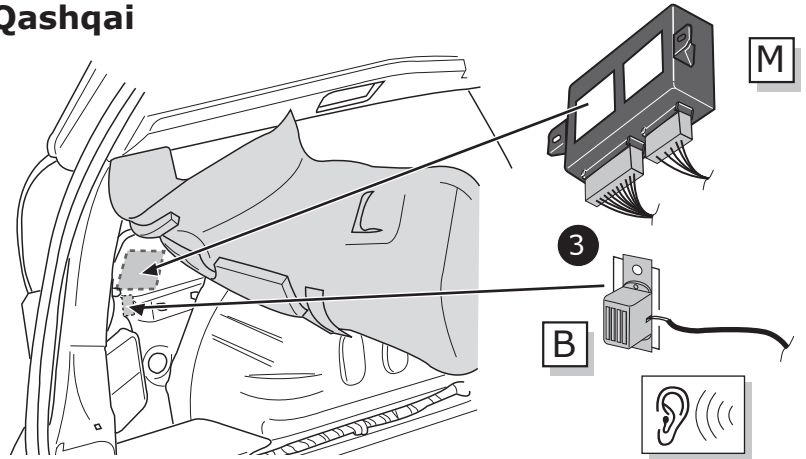

Qashqai+2

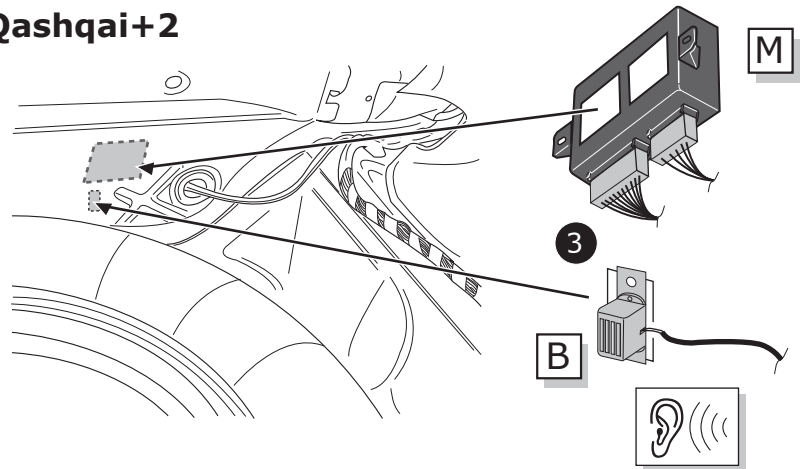

X-trail & Qashqai & Qashqai+2

13

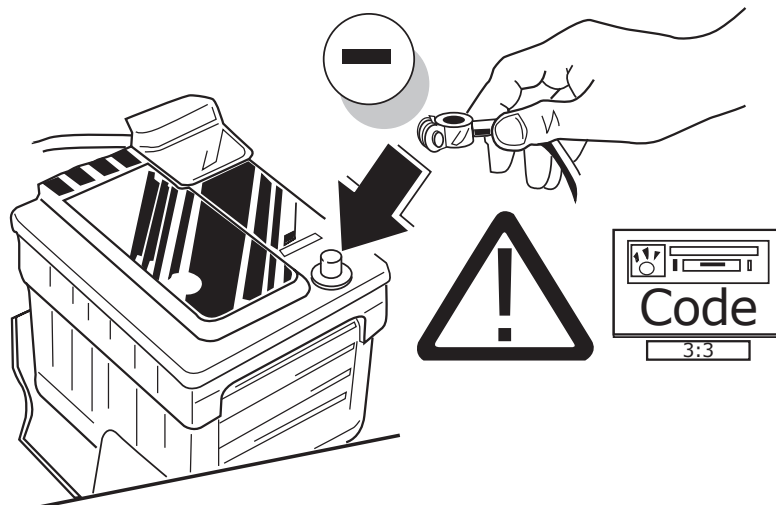

TEST ALL THE CIRCUITS WITH A TEST DEVICE WITH THE CORRECT POWER LOAD FOR EACH FUNCTION. A TEST DEVICE WITH LED'S CANNOT BE USED FOR THIS PURPOSE.

INFO

REINSTALL TRIM.

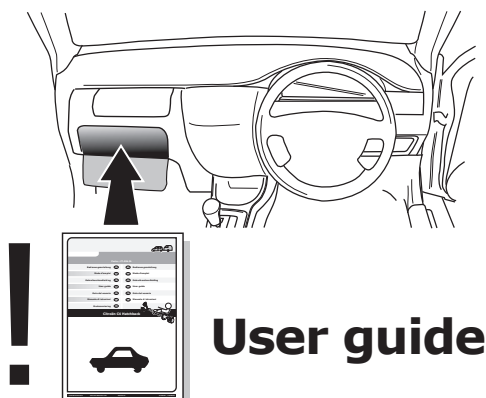

User guide



Products & Service

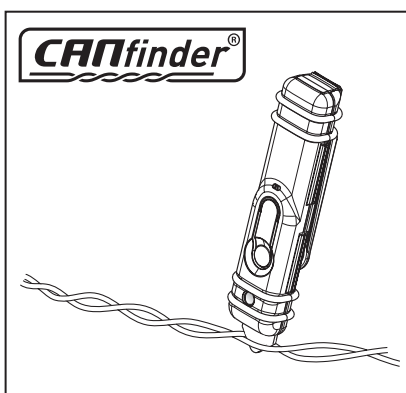

http://www.ecs-electronics.nl/NL/catalogus/test_gereedschap



INFO

SOCKET CONNECTION

DIN/ISO 1724							
	1/L	2	3/31	4/R	5/58-R	6/54	7/58-L
Pmax	21W	2x21W		21W	52W	3x21W	52W
Colour	Yellow	Blue	White	Green	Brown	Red	Black

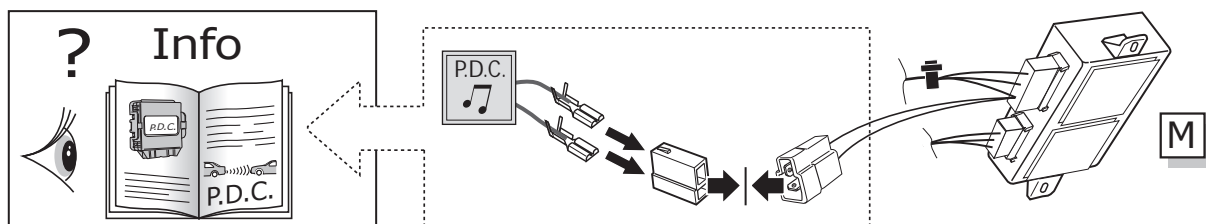
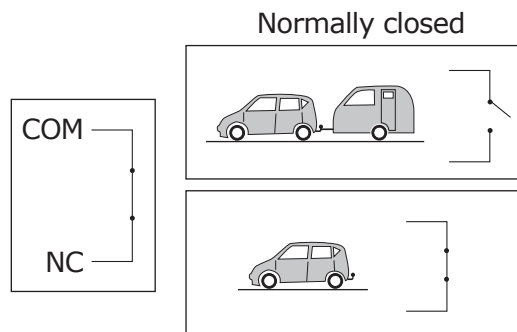
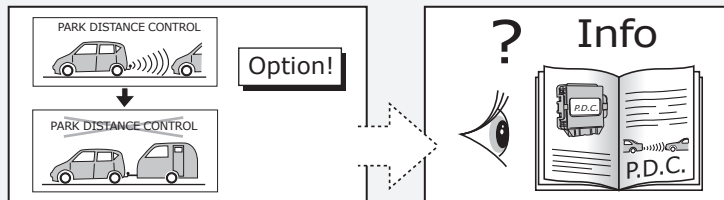

UN-243-YZ Reverse lamp pre-wire extension

⚠ MAX = 21W

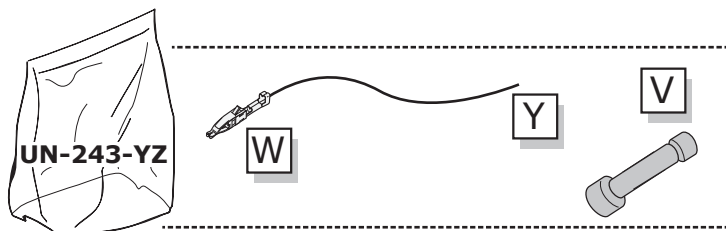

A

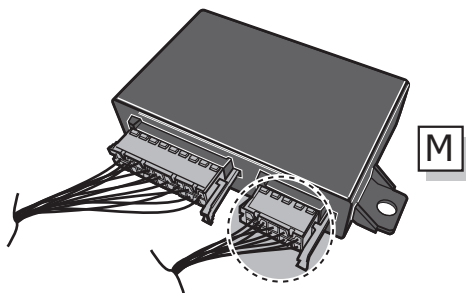

1

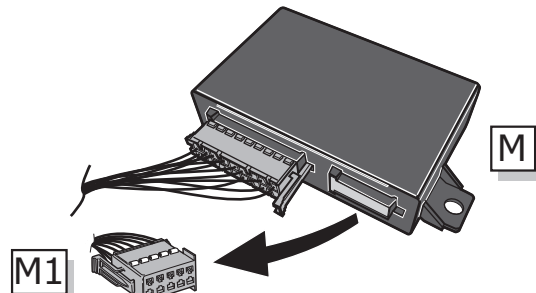

2

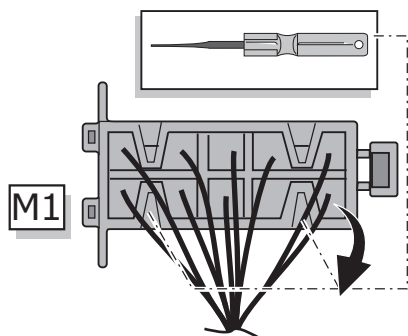

3

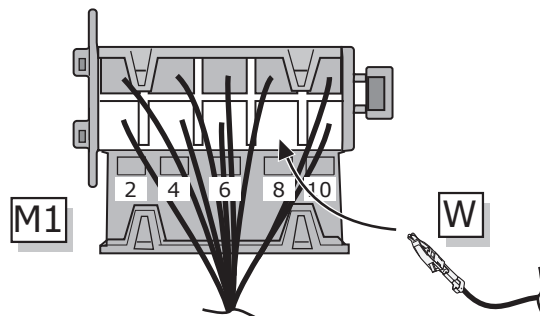

4

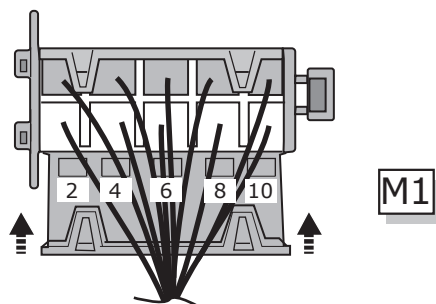

5

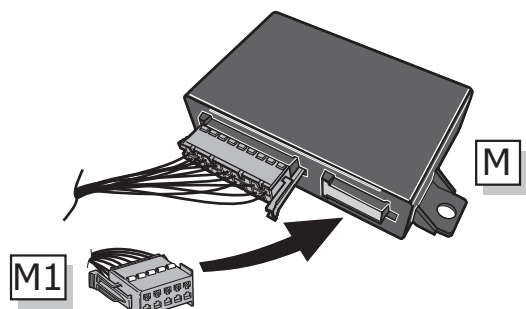

B

⚠ MAX = 21W

