

**Nissan Qashqai (J11) 01/2014>>
Nissan X-Trail (T32) 05/2014 >> 08/2022**

Partnr.: NI-115-BHU

- Fitting instructions electric wiring kit tow bar with 12-N socket up to DIN/ISO Norm 1724.
- We would expressly point out that assembly not carried out properly by a competent installer will result in cancellation of any right to damage compensation, in particular those arising by virtue of the product liability act.
- Contents of these kits and their fitting manuals are subject to alteration without notice, please ensure that these instructions are read and fully understood before commencing installation.
- Do not overload circuits; the maximum loads per connection are detailed in this manual.
- Attention! Before Installation, please read this manual carefully and inform your customer to consult the vehicle owners manual to check for any vehicle modifications required before towing.
- In the event of functional problems, troubleshooting must be limited to about 0.5 hours, contact the technical support:
ukts@ecs-electronics.com / 07440 202 052.



Part list

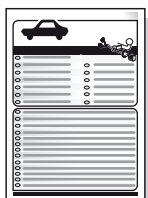
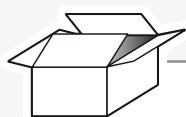

M



L1

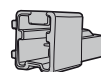

G



L2

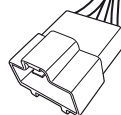

X

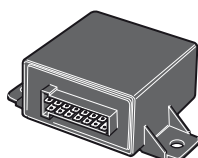

M

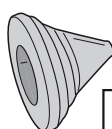

T

X

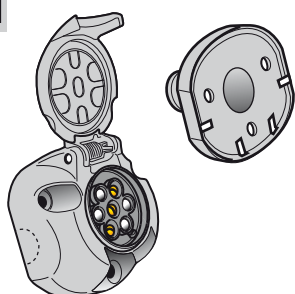

1x

3x

3x

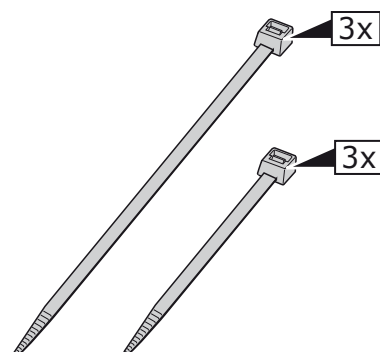

3x



3x



1x

20 Amp.

Qashqai

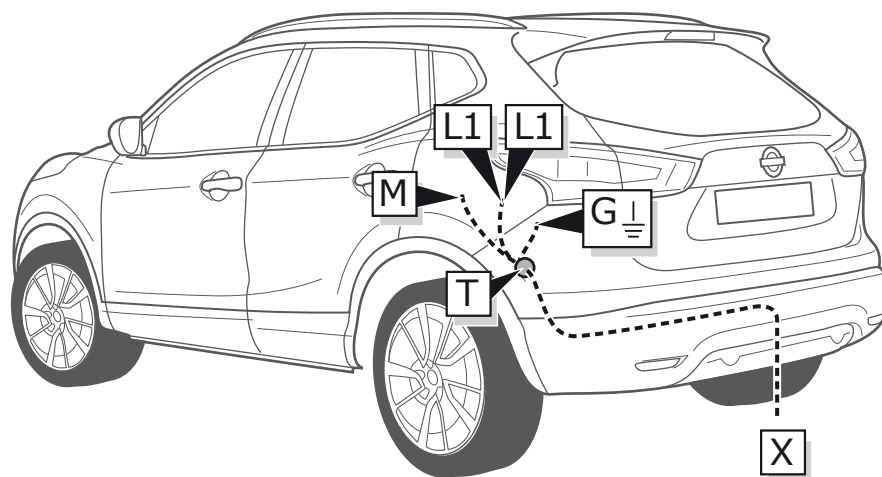

X-Trail

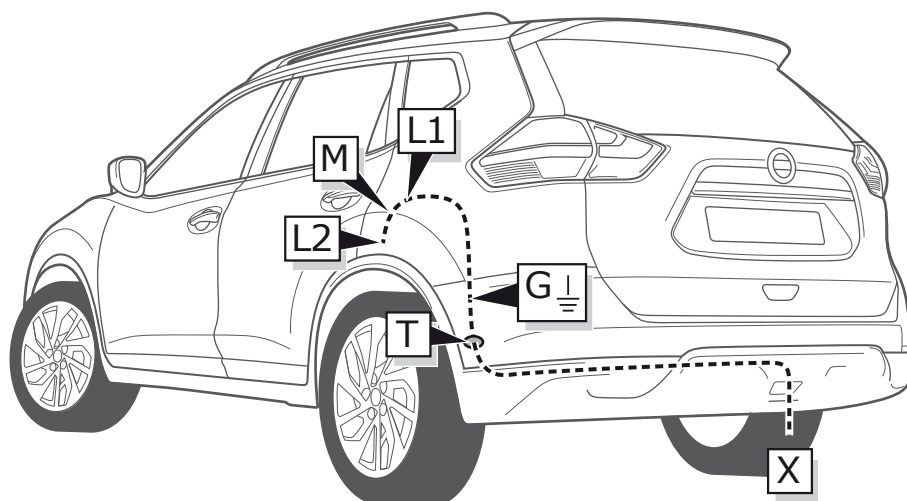

1

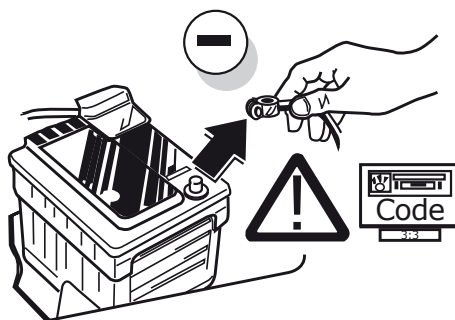

2

Qashqai

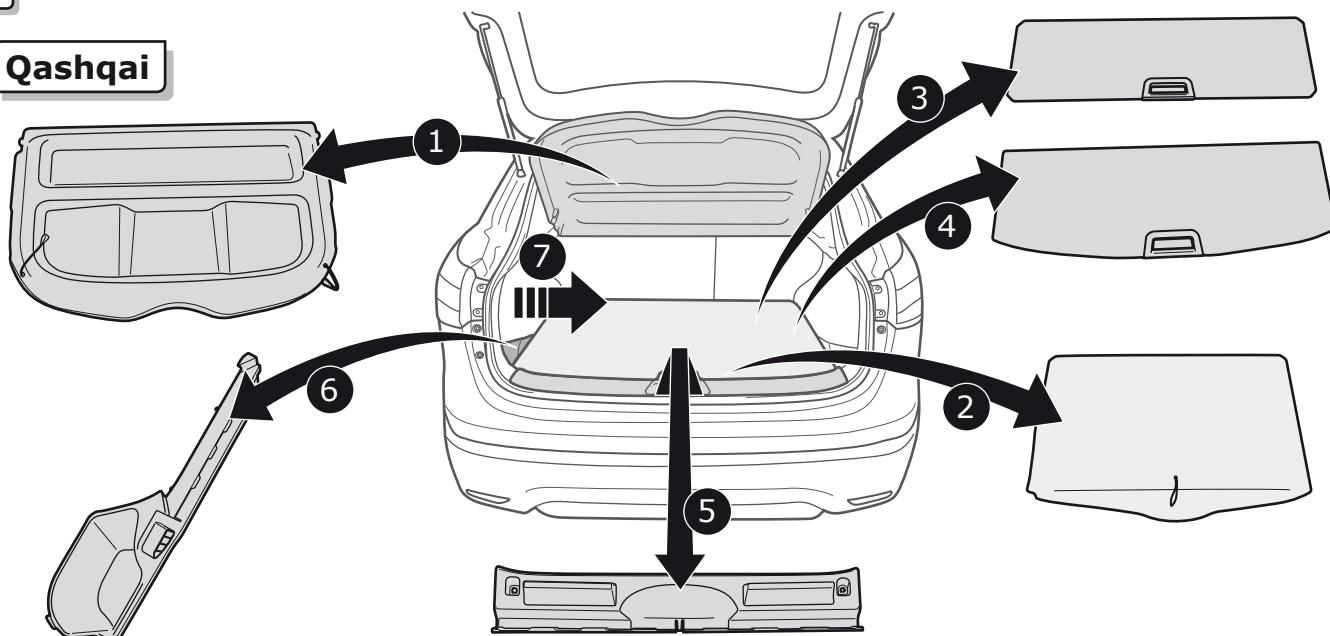

3

Qashqai

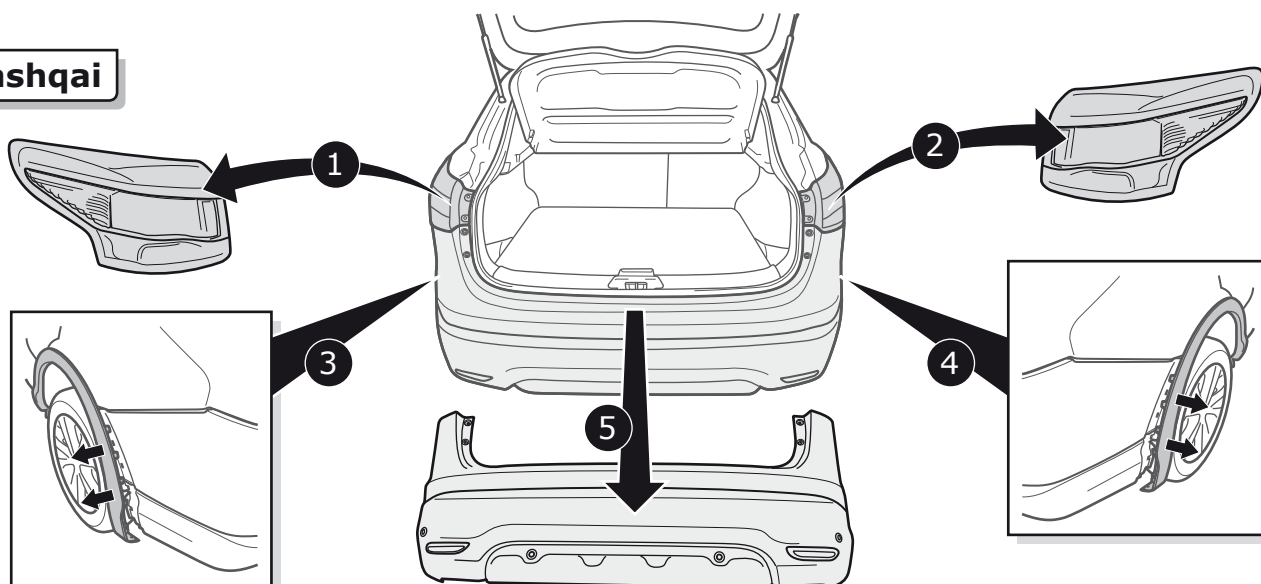

4

Qashqai

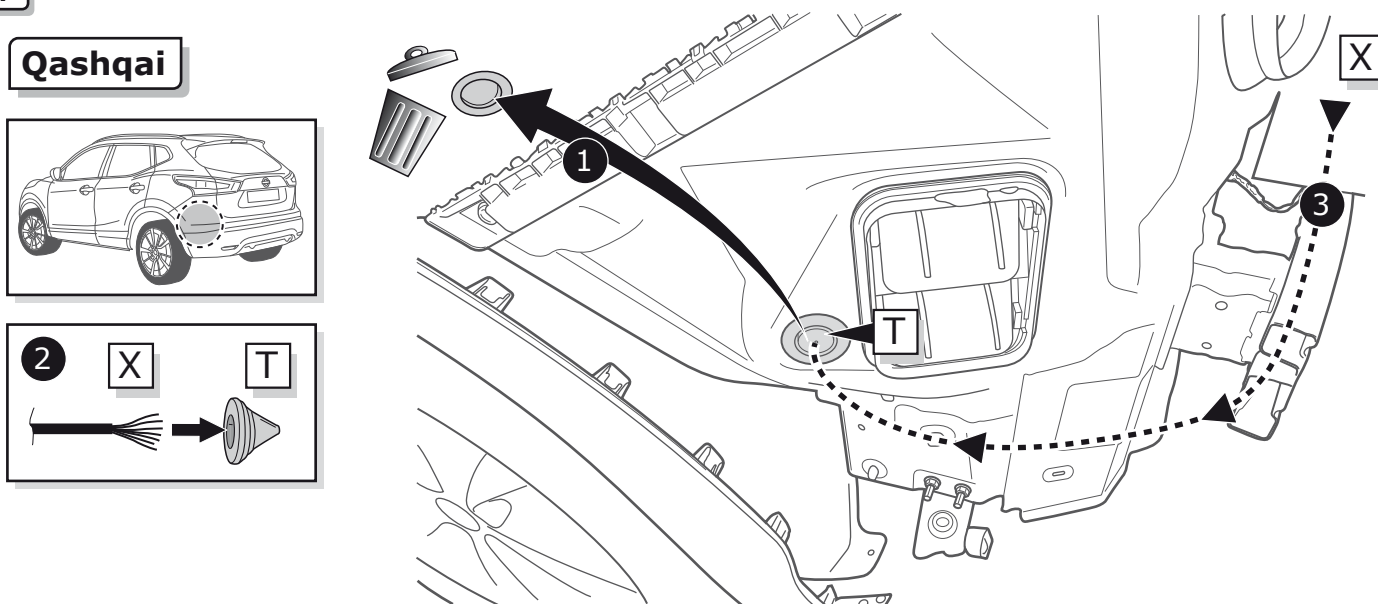

X-Trail 5 seats

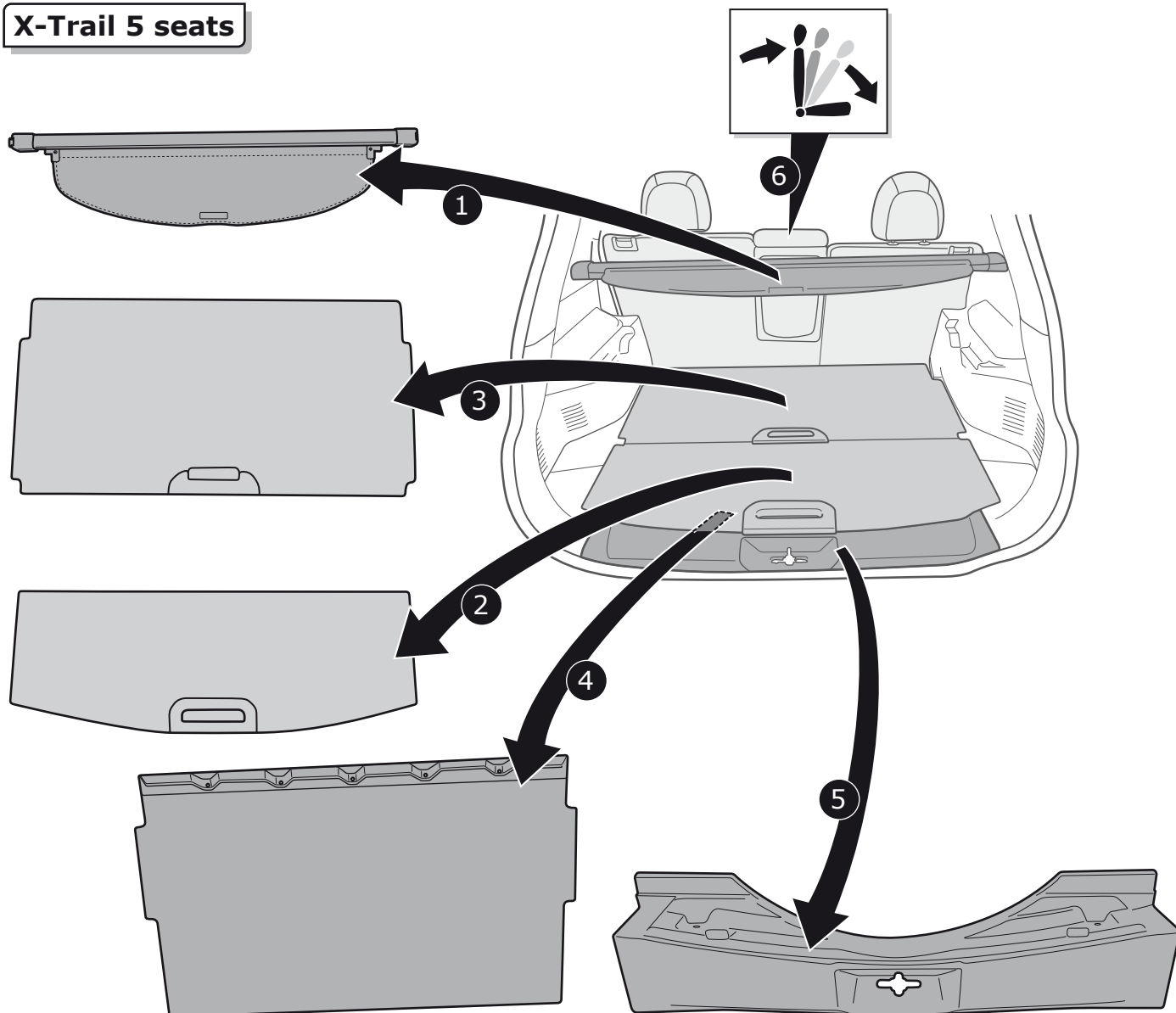

X-Trail 5 seats

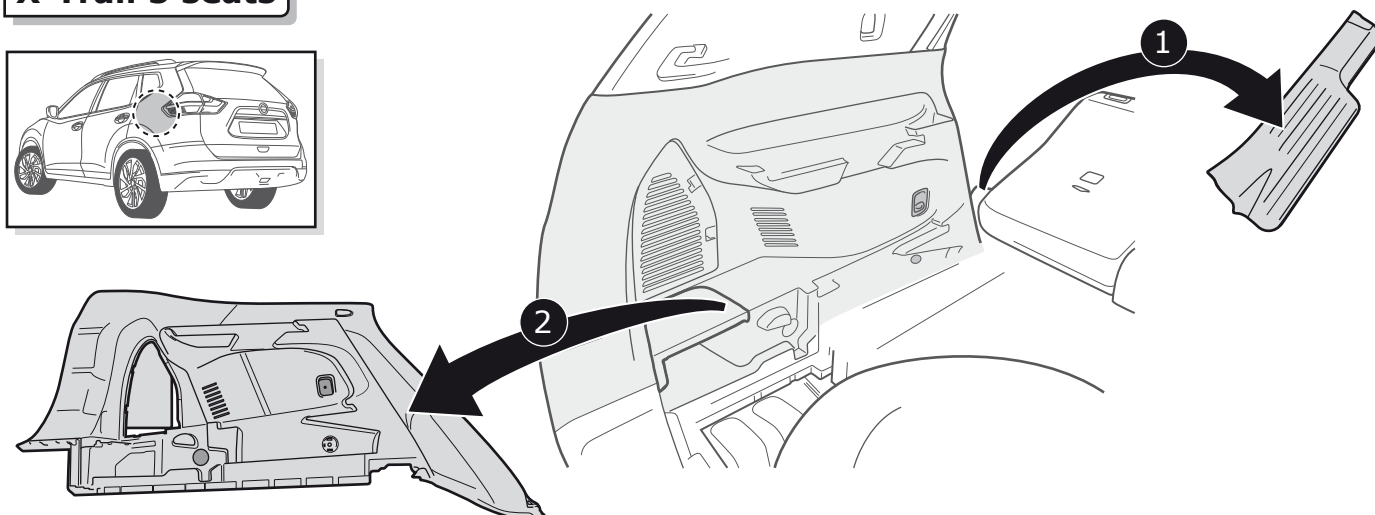

7

X-Trail 7 seats

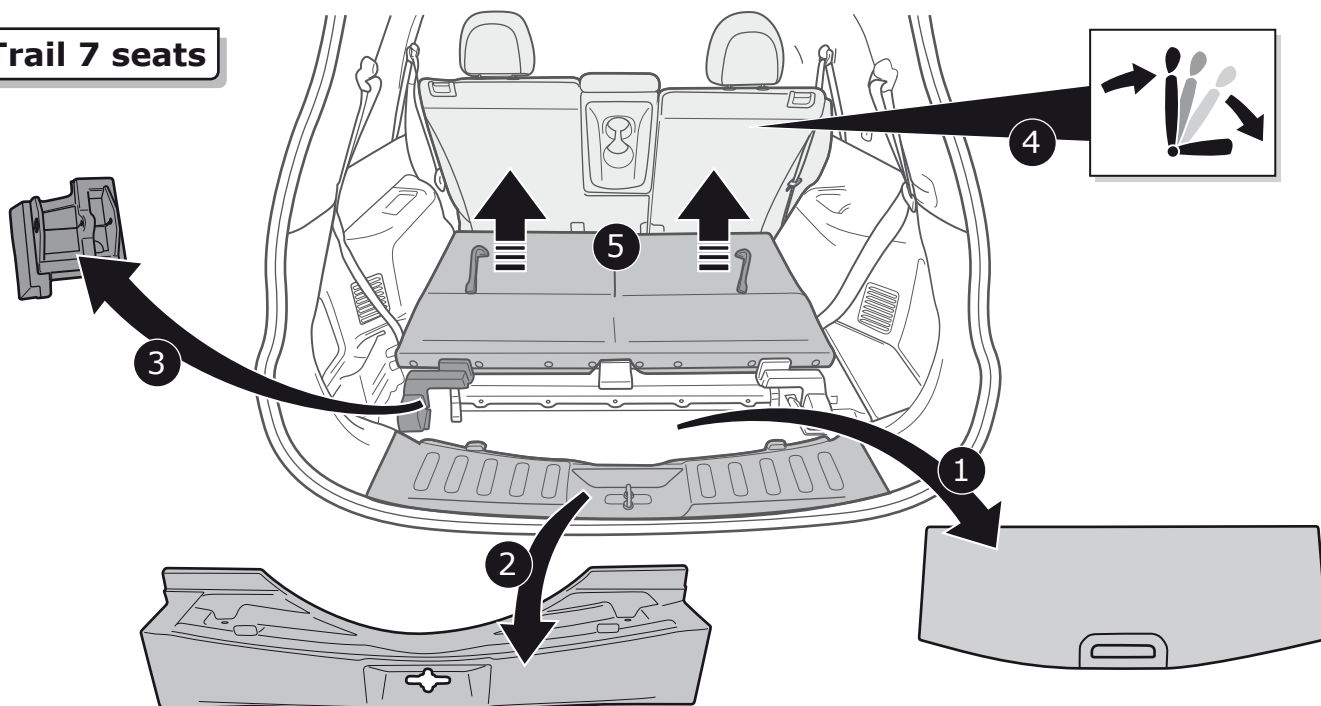

8

X-Trail 7 seats

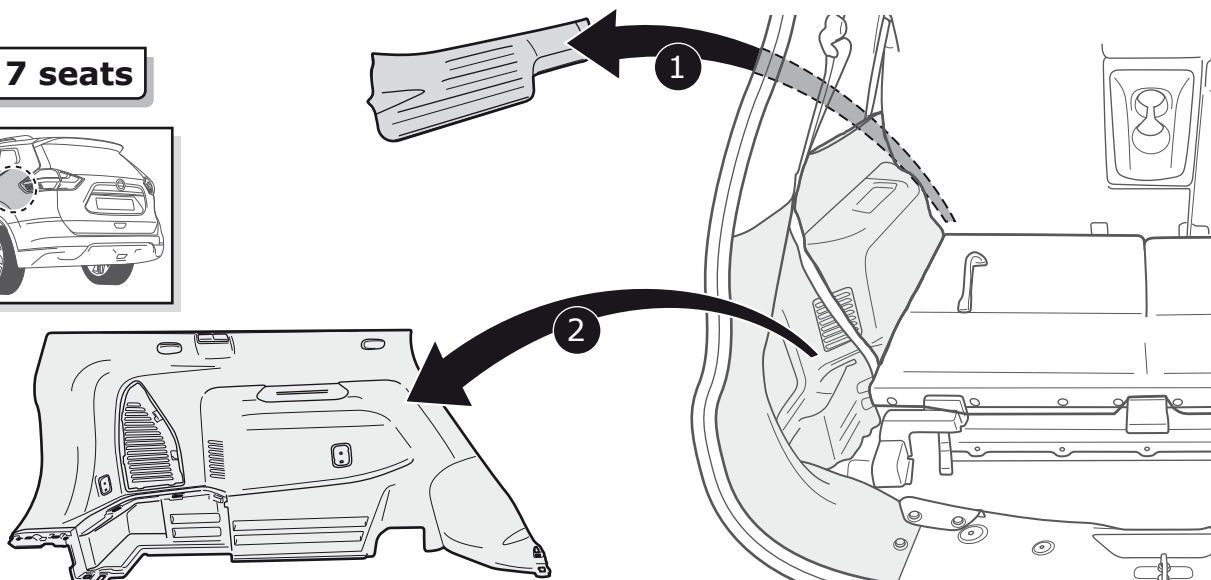
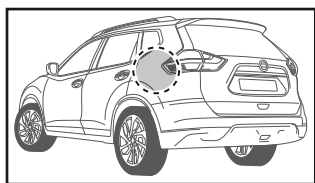

9

X-Trail

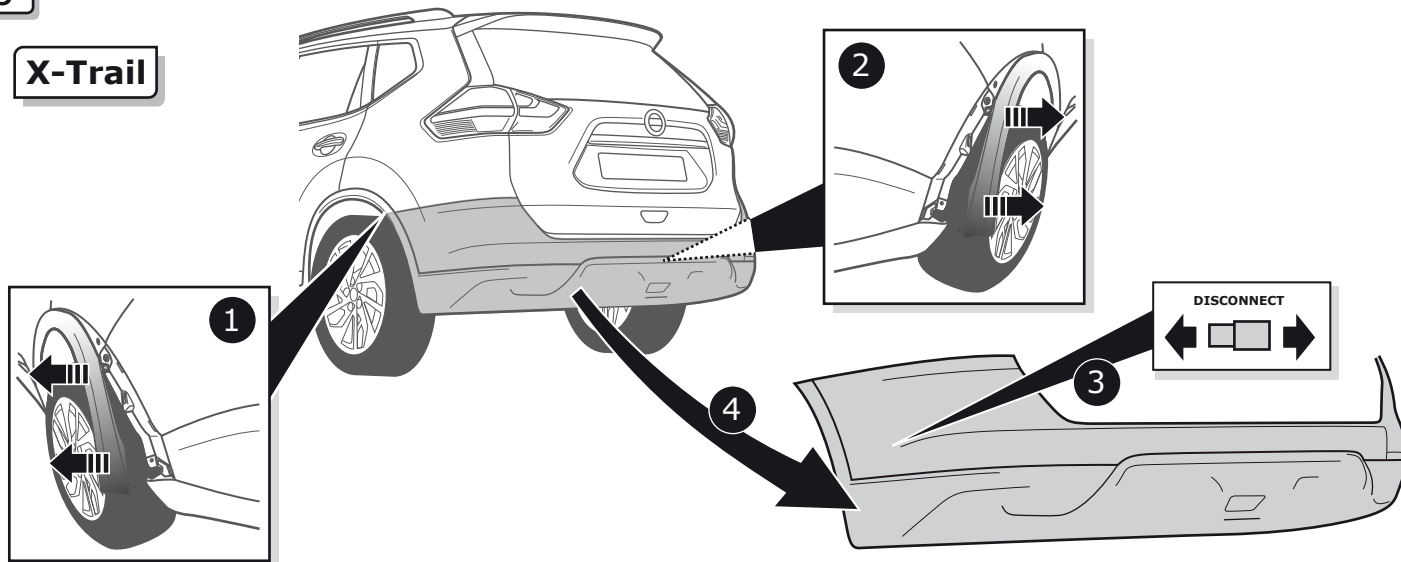

X-Trail

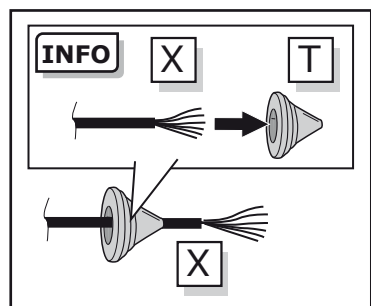

2

1

4

2x

T

X

3

A

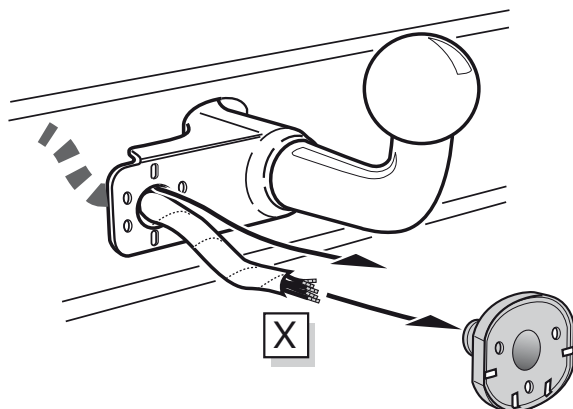

INFO

SOCKET CONNECTION



Page 12

B

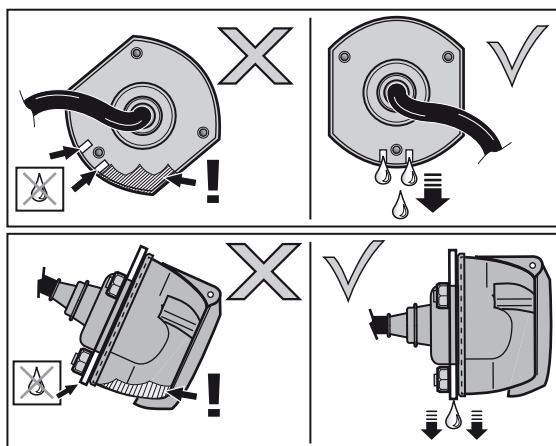
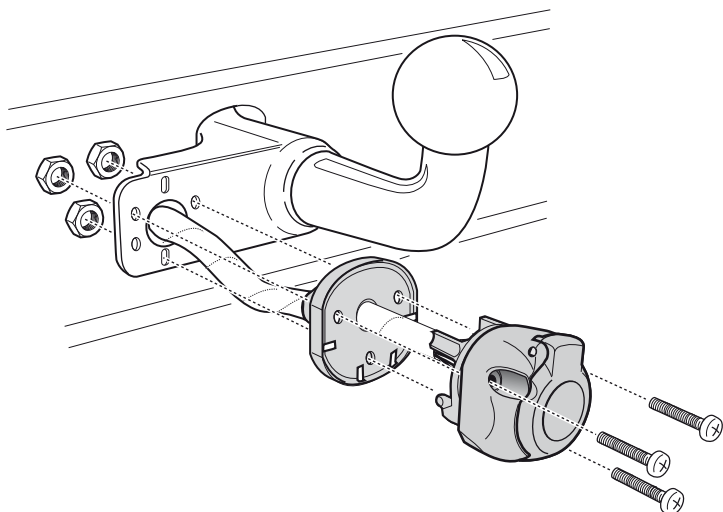

11

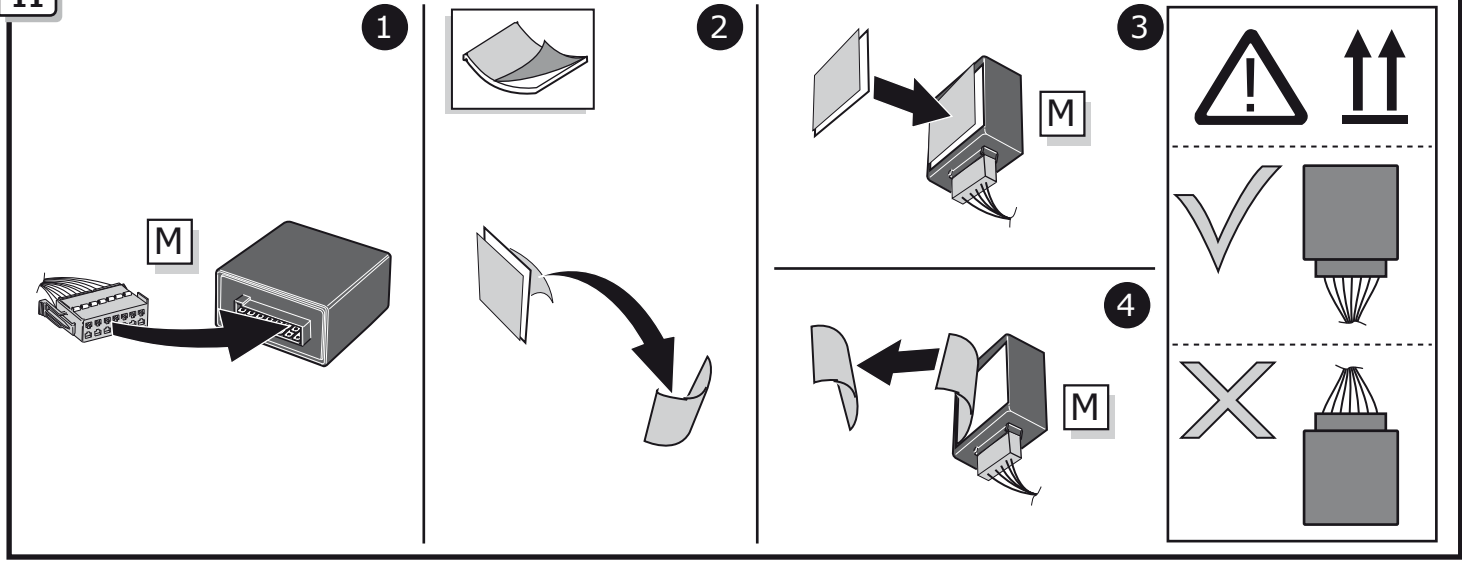

12

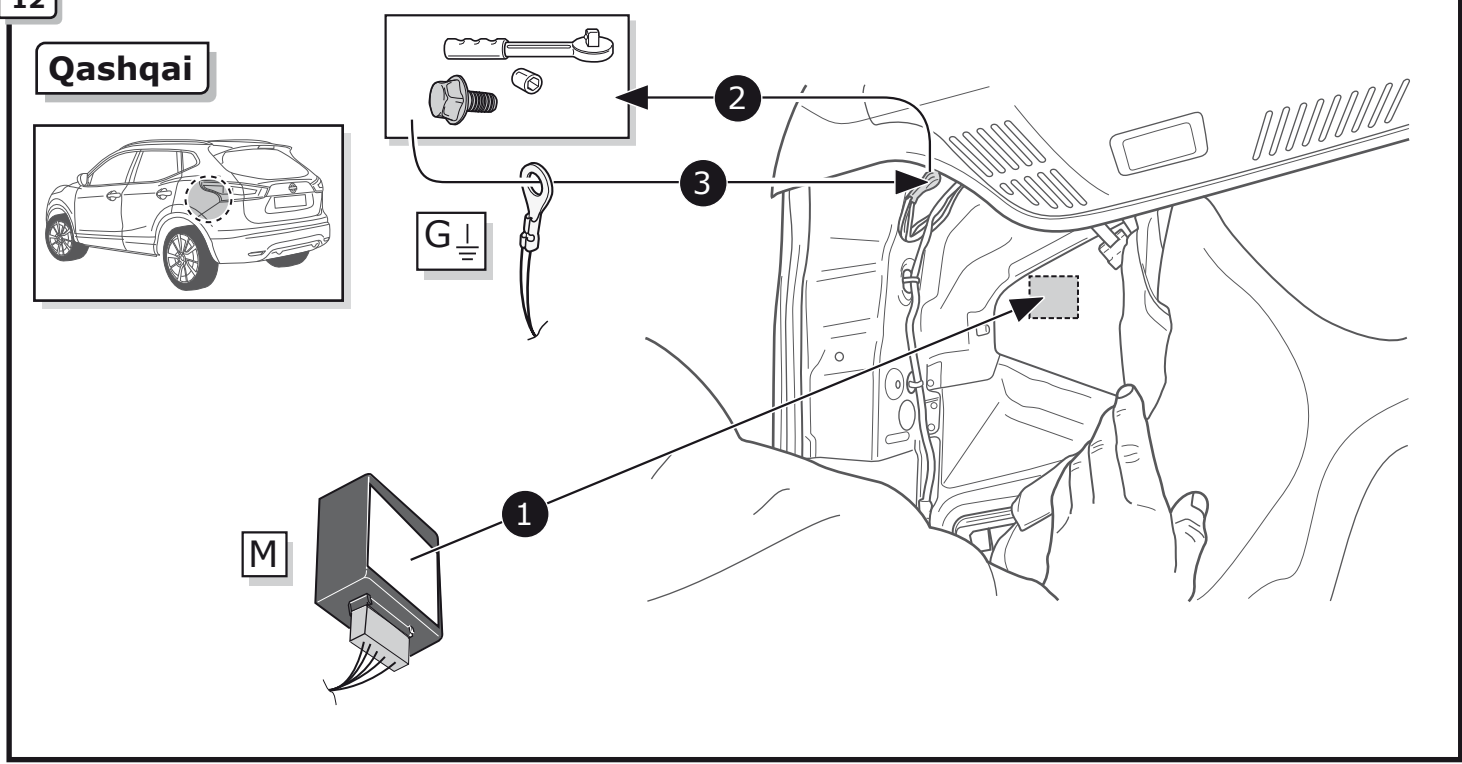

13

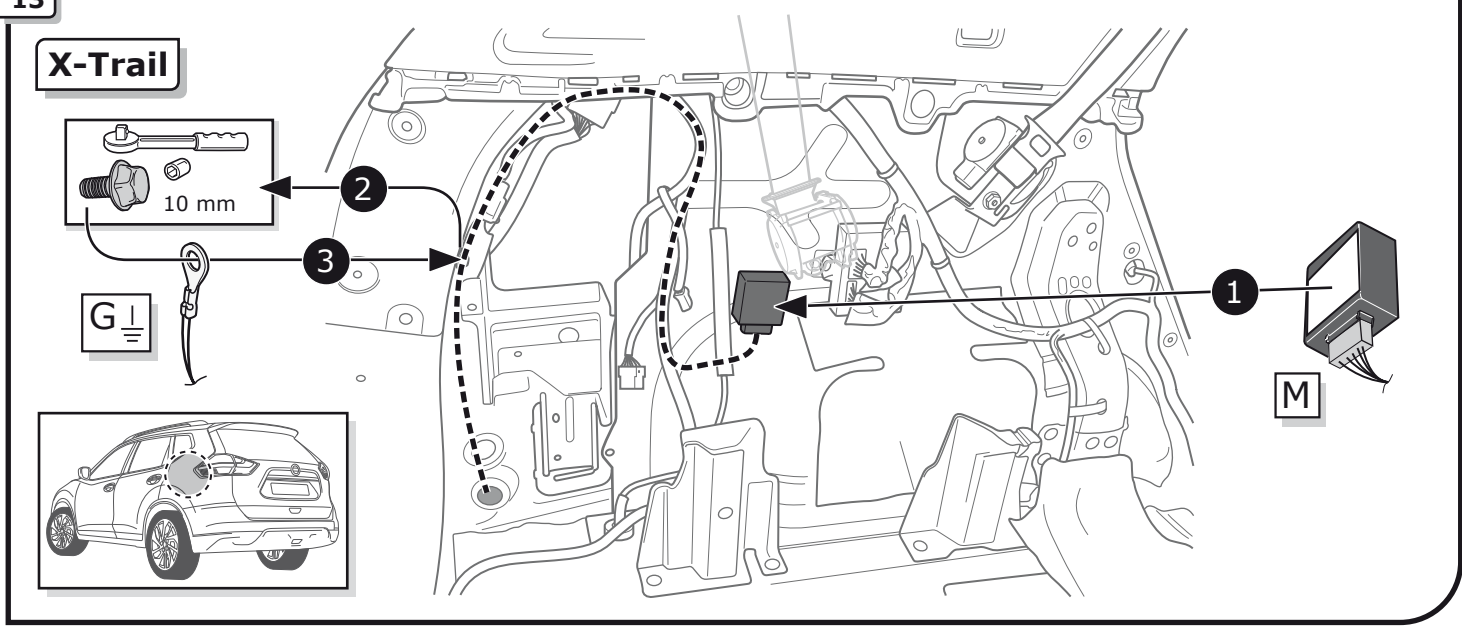

14

Qashqai

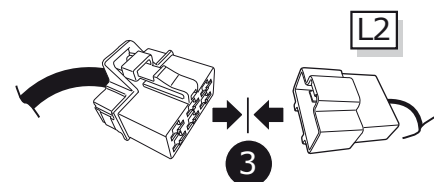
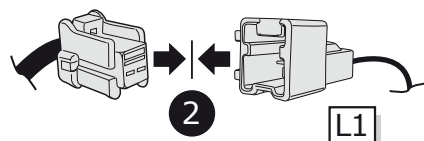
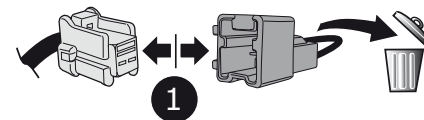
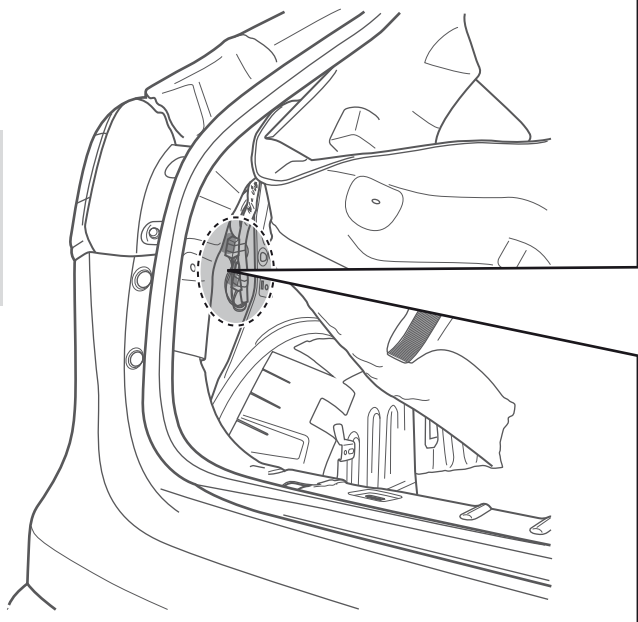
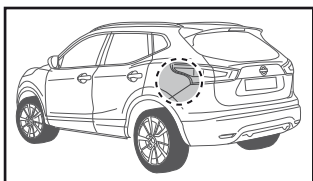

15

X-Trail

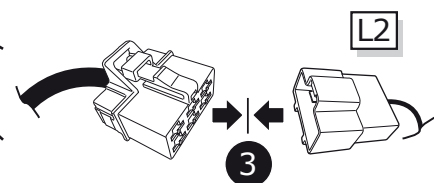
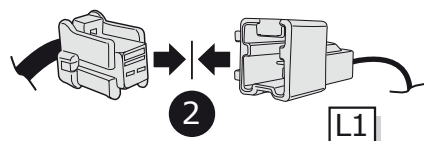
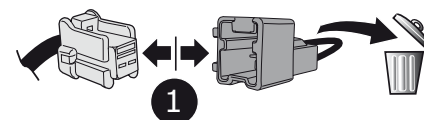
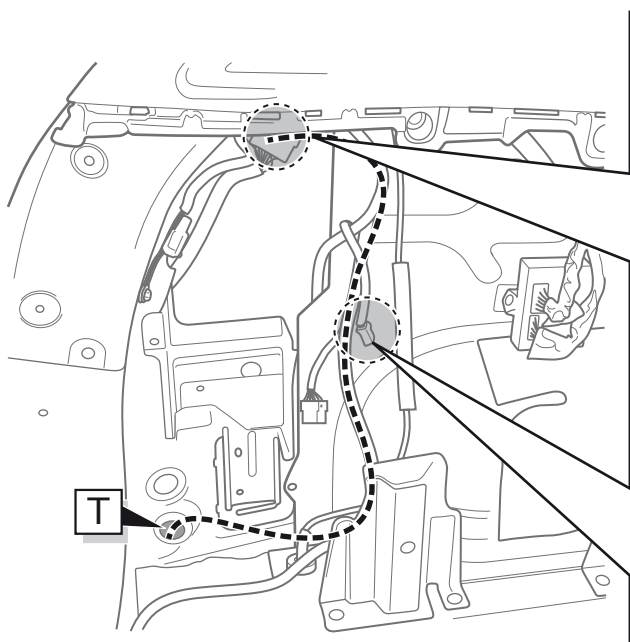
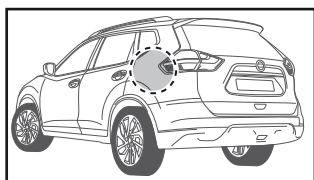

16

Qashqai

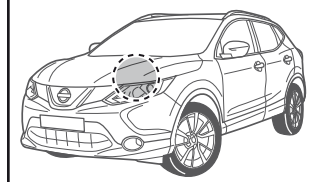

X-Trail

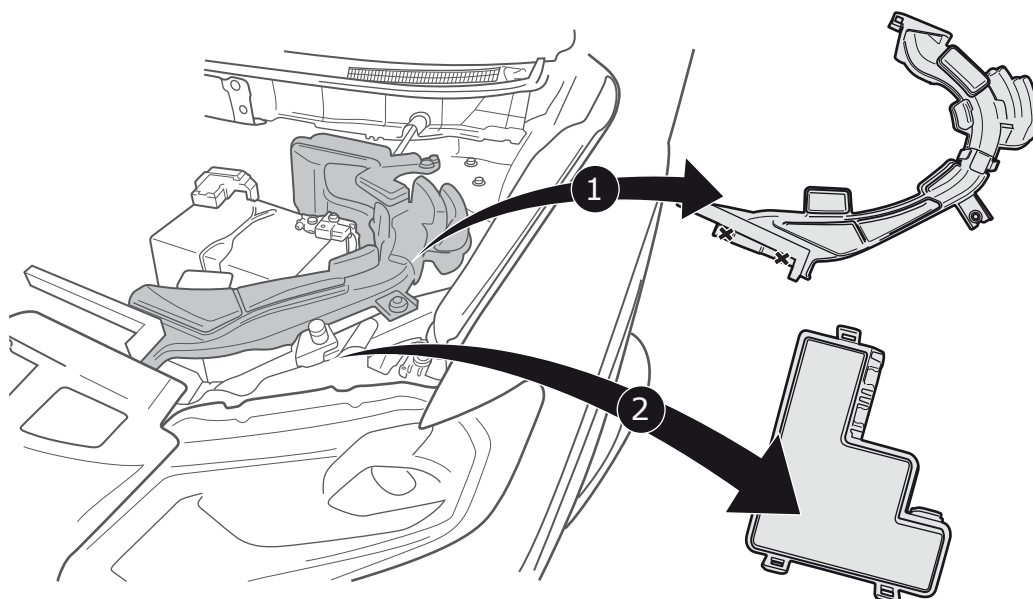

17

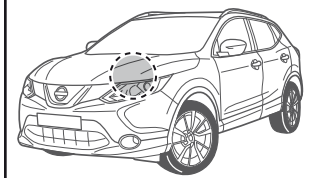
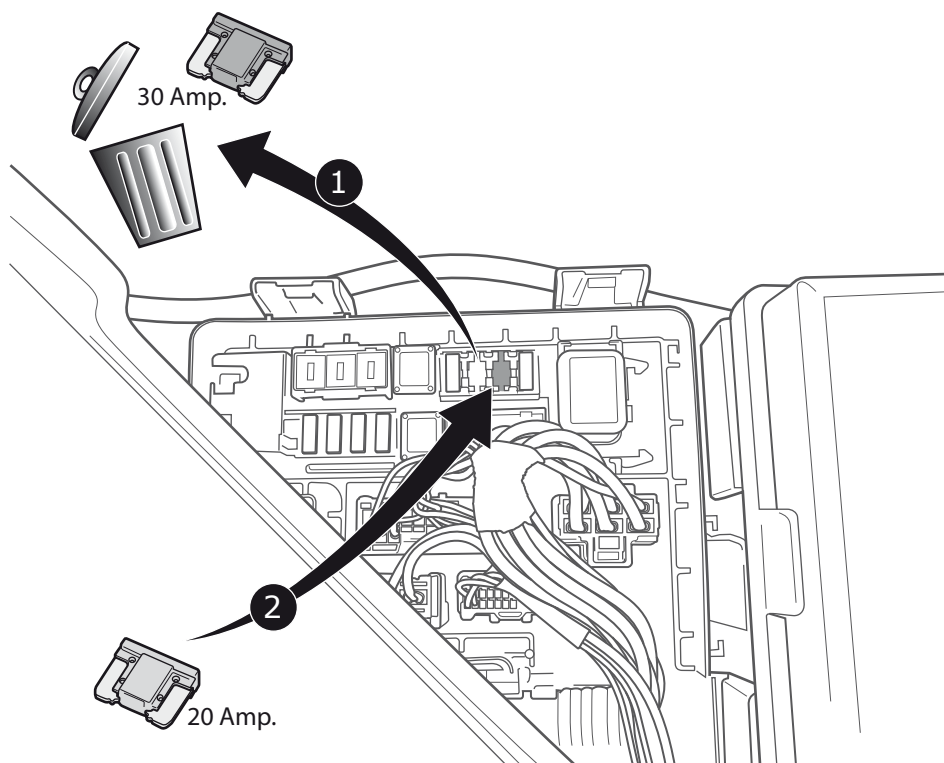
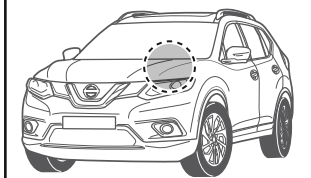
Qashqai**X-Trail**

18

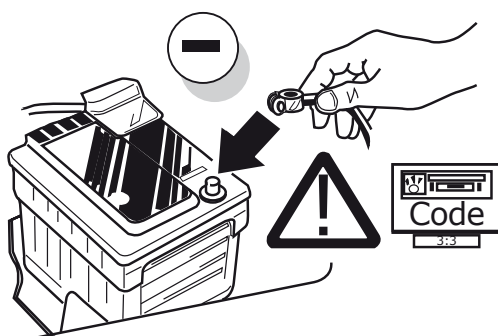
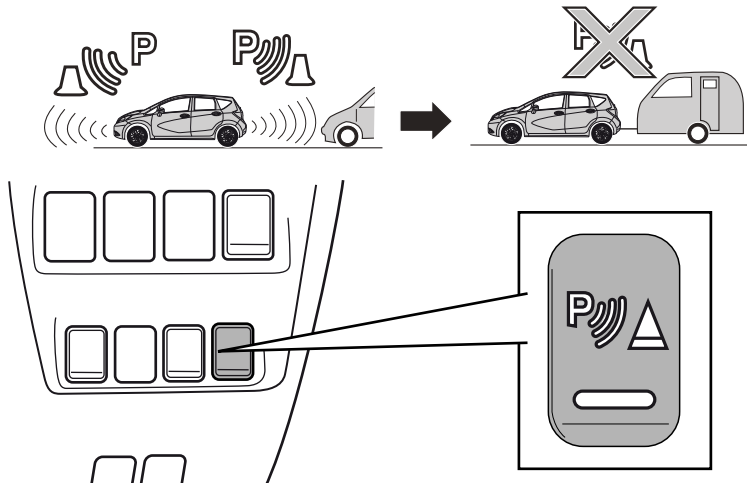
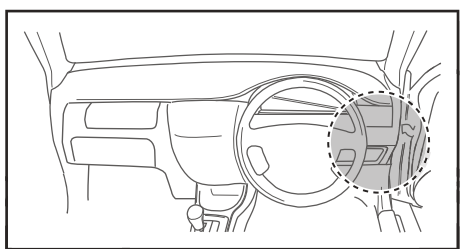
**Option 1**

Option 2

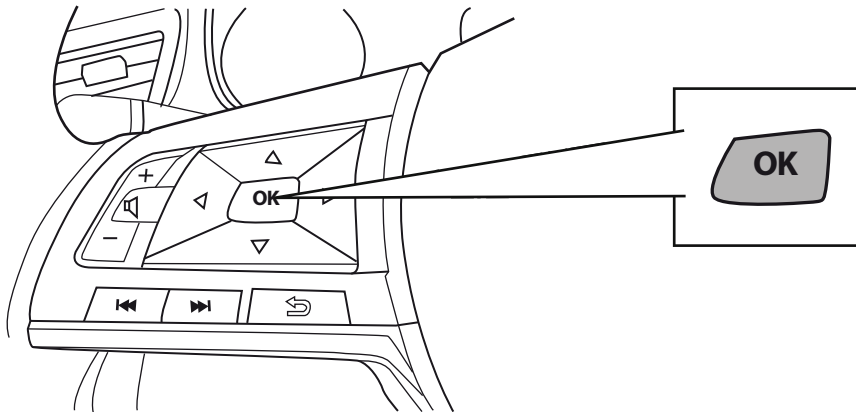
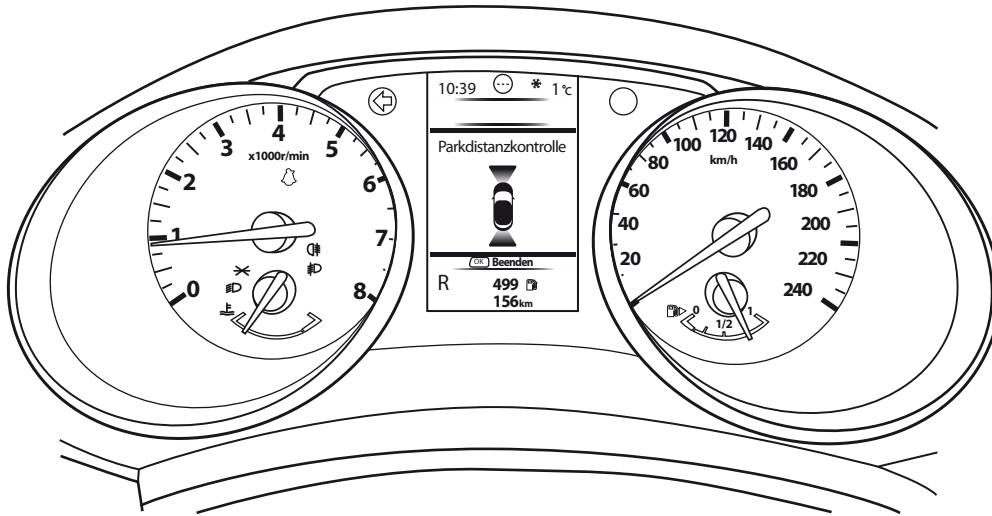
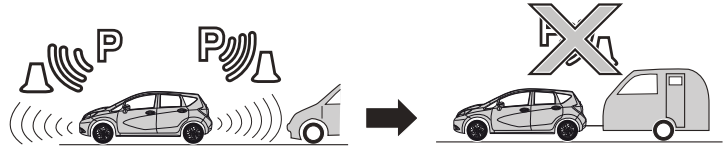

Option 3

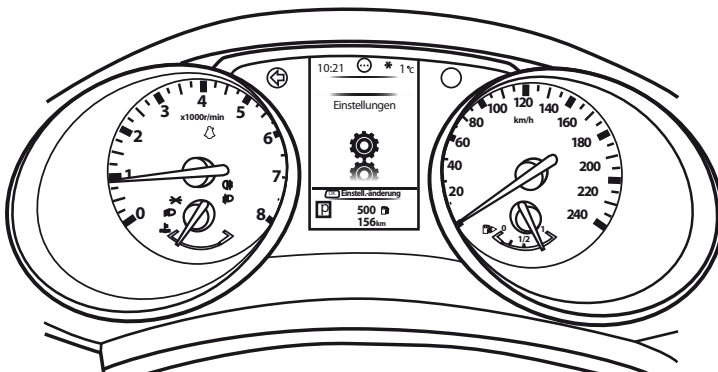
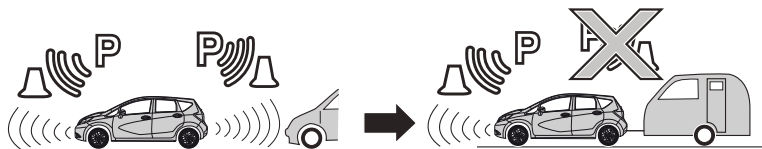

Einstellungen/
 settings
 ↓
 Fahrerassistenz/
 driver assistance
 ↓
 Parkhilfe/
 parking assistant
 ↓
 Sensor Heck ausschalten/
 disable rear-sensor ✓

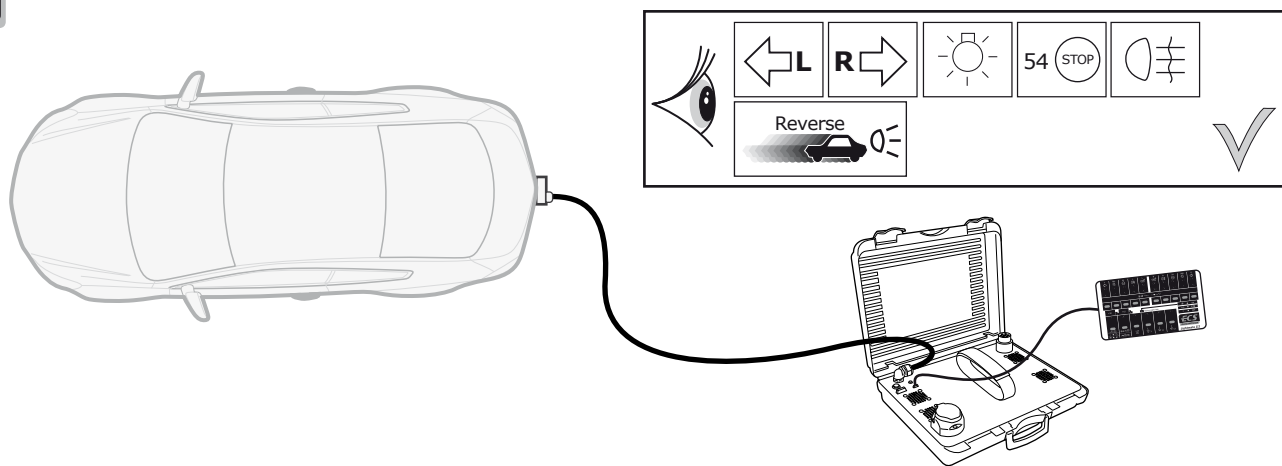

INFO

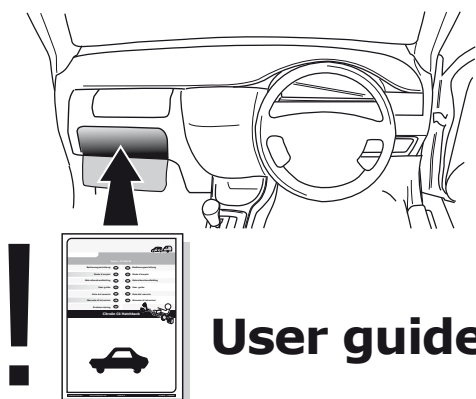
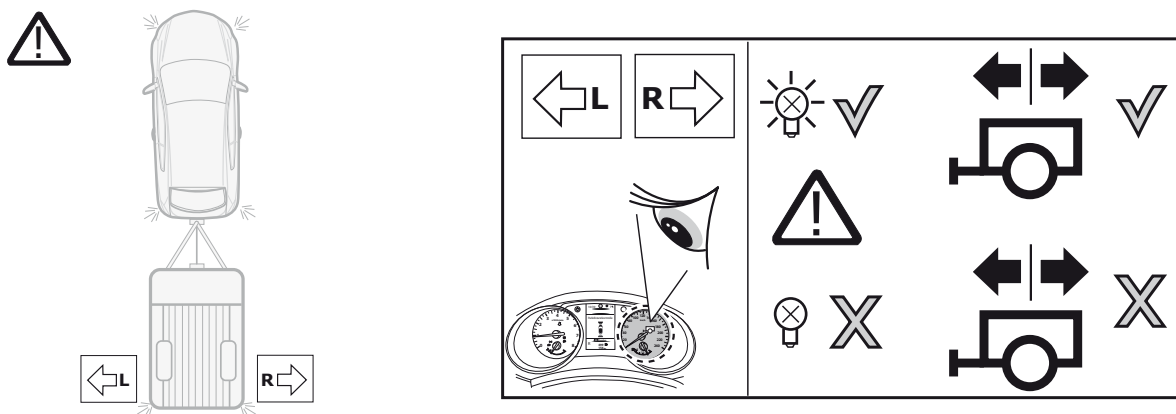

INFO

SOCKET CONNECTION

DIN/ISO 1724	←	Car Horn	1-7	→	Light	STOP	Light
	1/L	2	3/31	4/R	5/58-R	6/54	7/58-L
Pmax	21W	2x21W		21W	52W	3x21W	52W
Colour	Yellow	Blue	White	Green	Brown	Red	Black