

**Nissan Qashqai (J11) 01/2014 >>
Nissan X-Trail (T32) 05/2014 >> 08/2022**

Partnr.: NI-115-DHU

- Fitting instructions electric wiring kit tow bar with 13-P socket up to DIN/ISO Norm 11446.
- We would expressly point out that assembly not carried out properly by a competent installer will result in cancellation of any right to damage compensation, in particular those arising by virtue of the product liability act.
- Contents of these kits and their fitting manuals are subject to alteration without notice, please ensure that these instructions are read and fully understood before commencing installation.
- Do not overload circuits; the maximum loads per connection are detailed in this manual.
- Attention! Before Installation, please read this manual carefully and inform your customer to consult the vehicle owners manual to check for any vehicle modifications required before towing.
- In the event of functional problems, troubleshooting must be limited to about 0.5 hours, contact the technical support:
ukts@ecs-electronics.com / 07440 202 052.



Part list

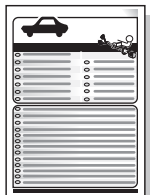

M

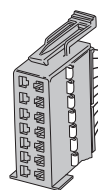

L1

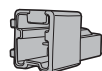

G

OPTION
+30/+15

L2

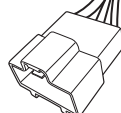

*

X

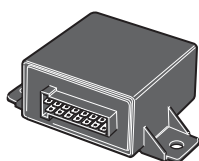

M

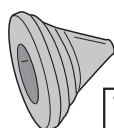

T

X

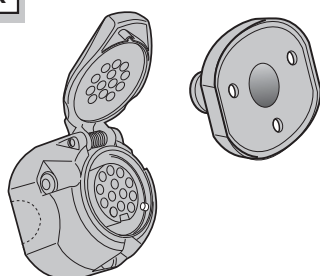

1x



3x

3x

* OPTION
+30/+15

preparation for



Brown/White

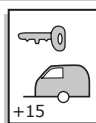

Red



3x



3x

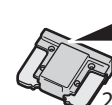

1x

20 Amp.

Qashqai

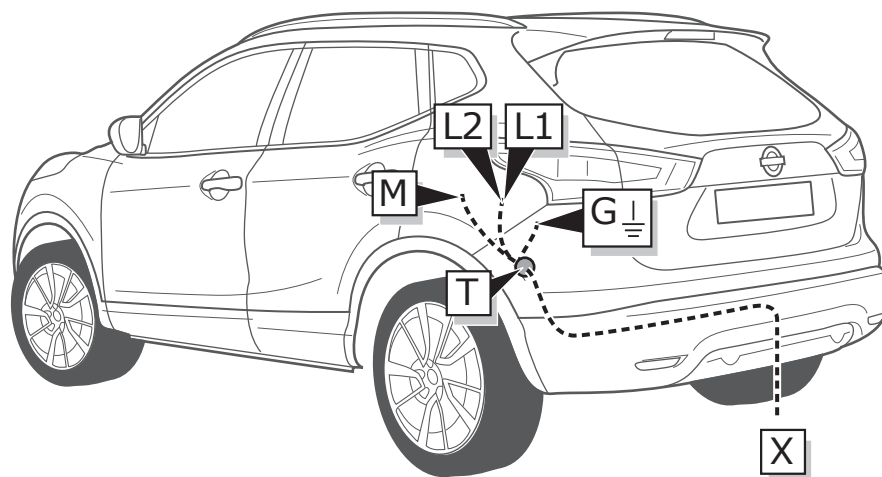

X-Trail

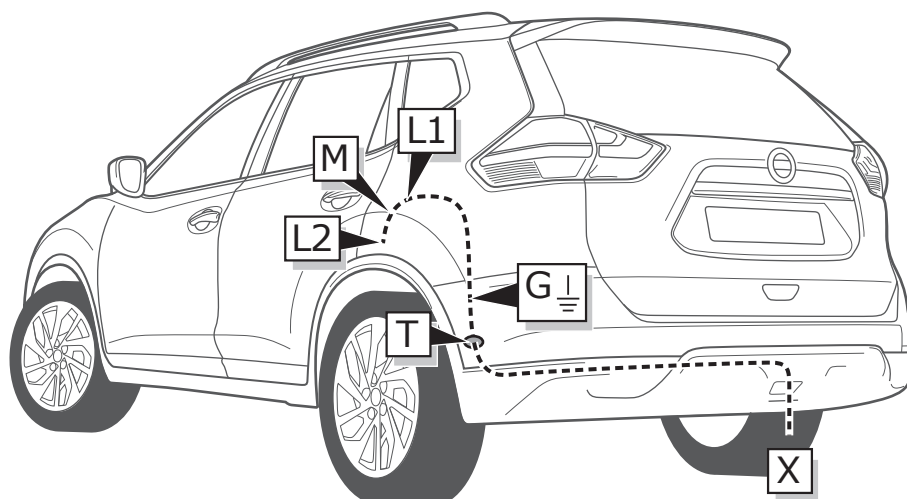

1

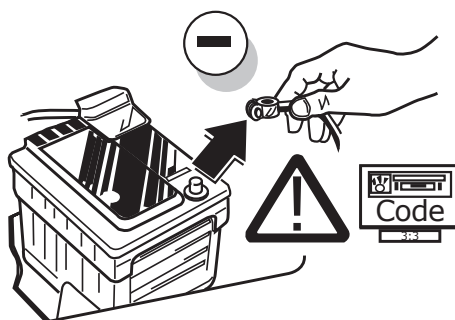

2

Qashqai

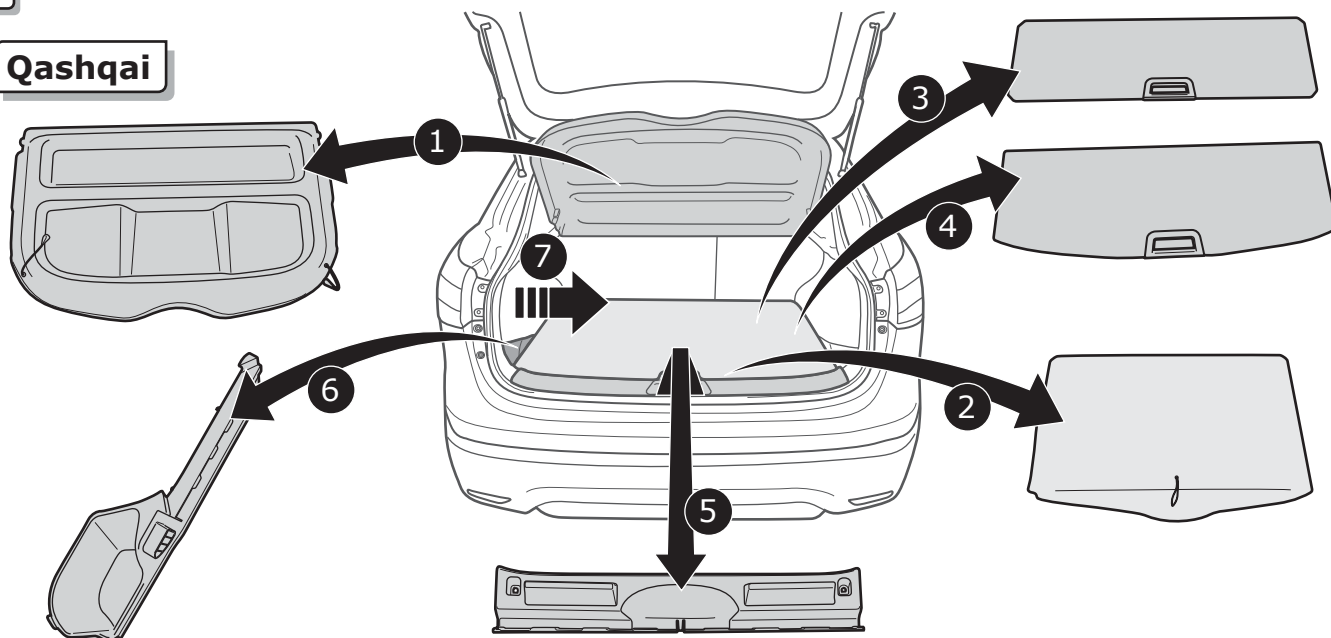

3

Qashqai

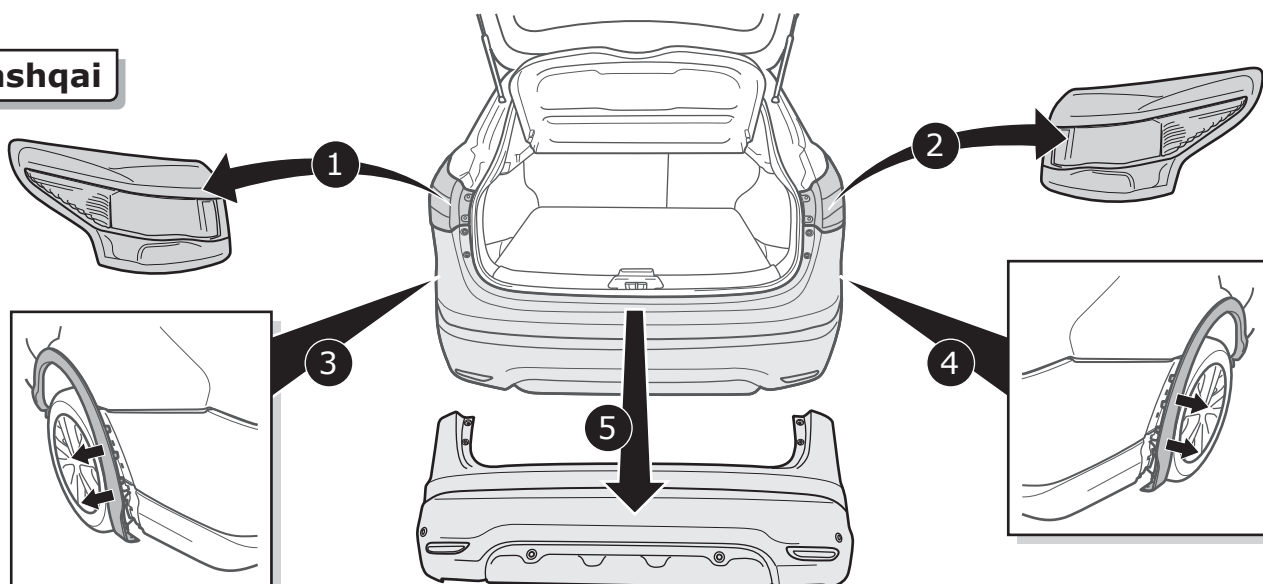

4

Qashqai

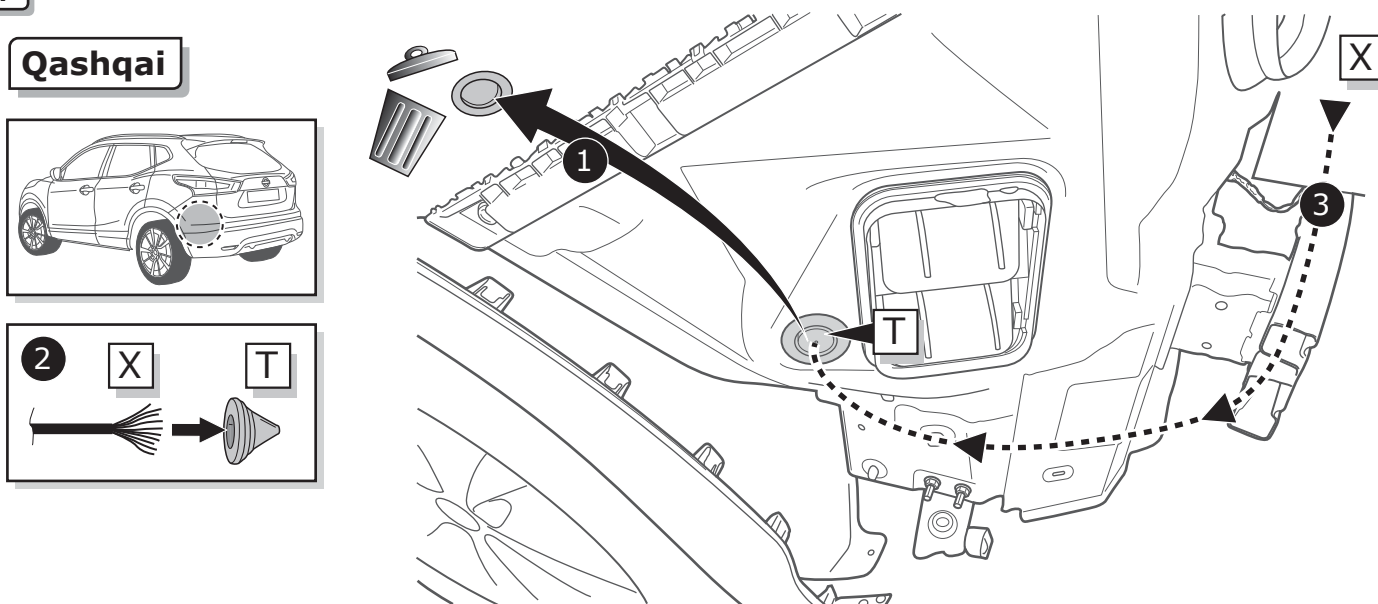

X-Trail 5 seats

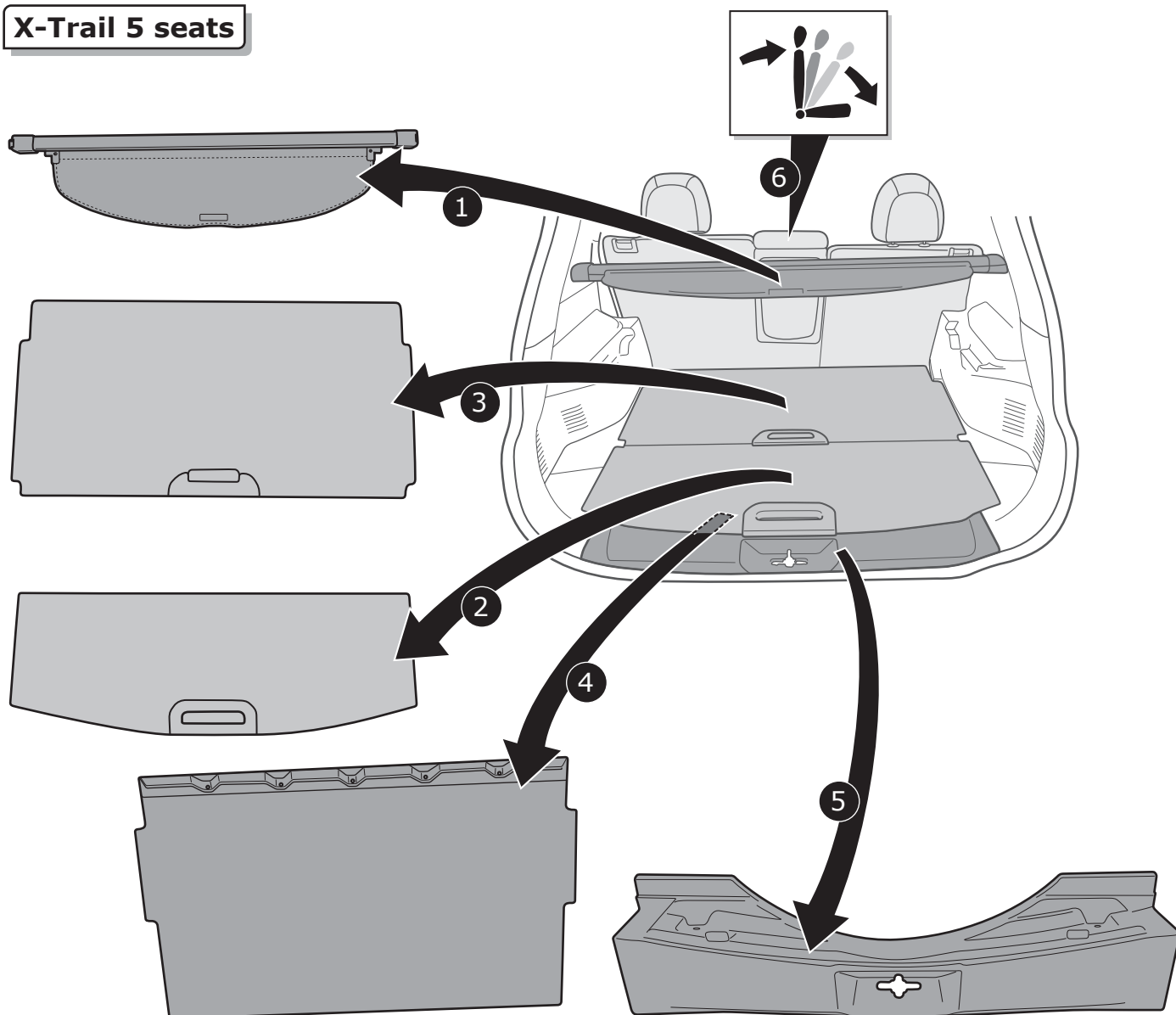

X-Trail 5 seats

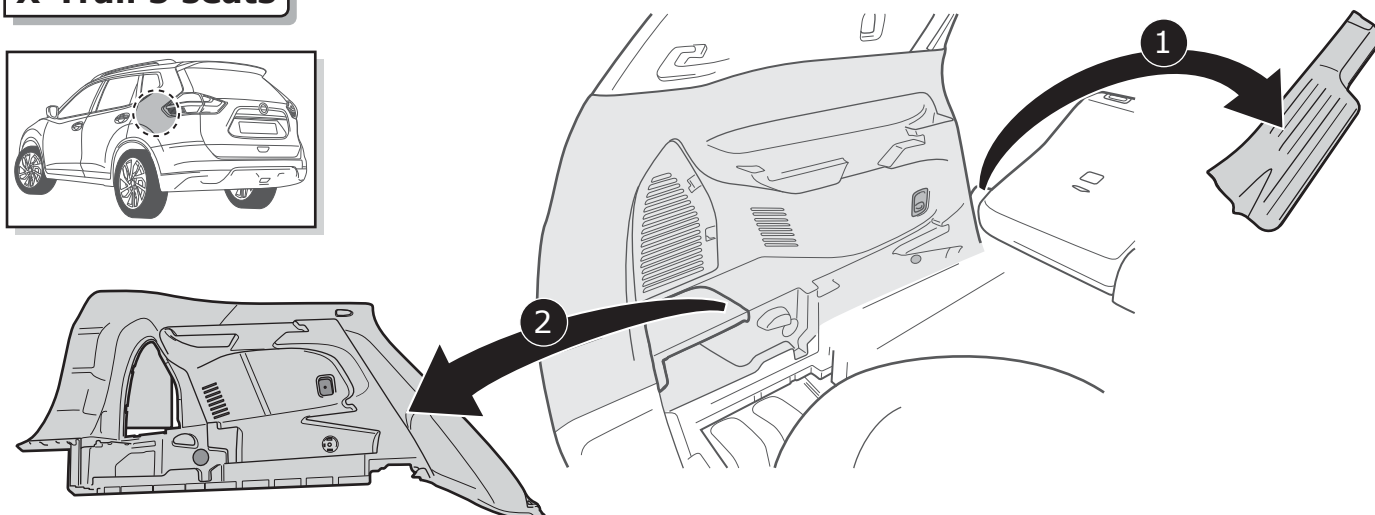

7

X-Trail 7 seats

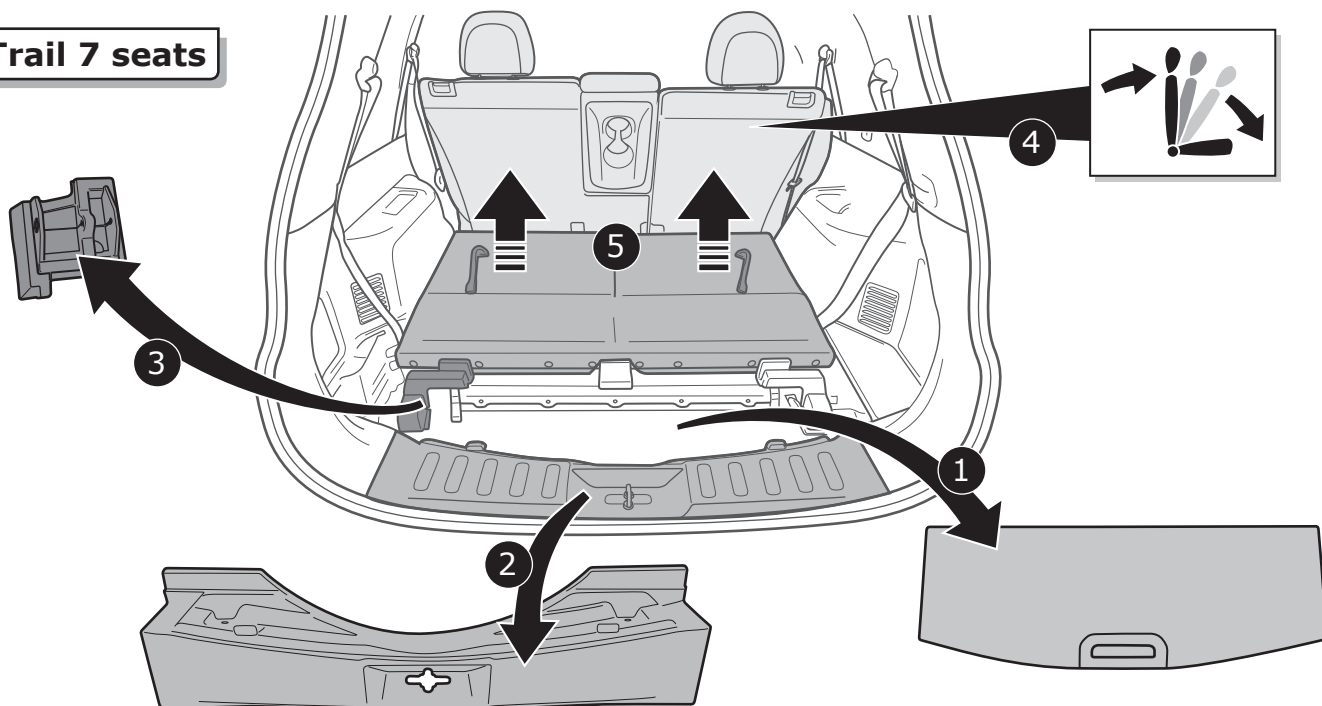

8

X-Trail 7 seats

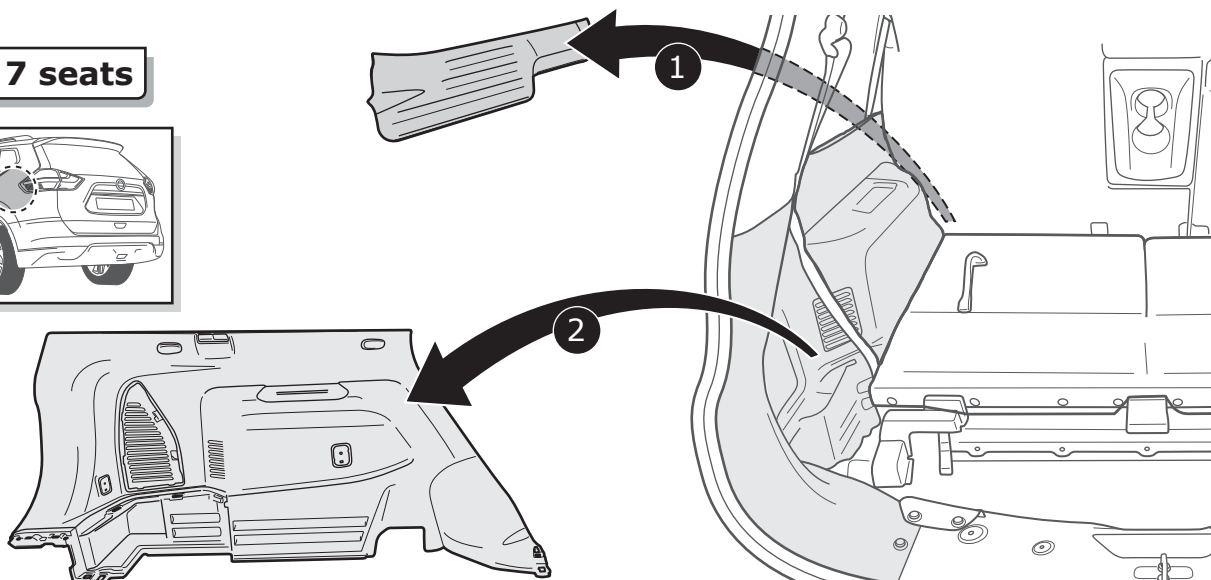
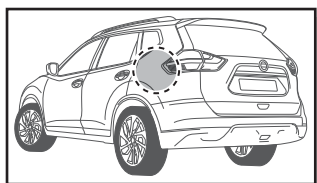

9

X-Trail

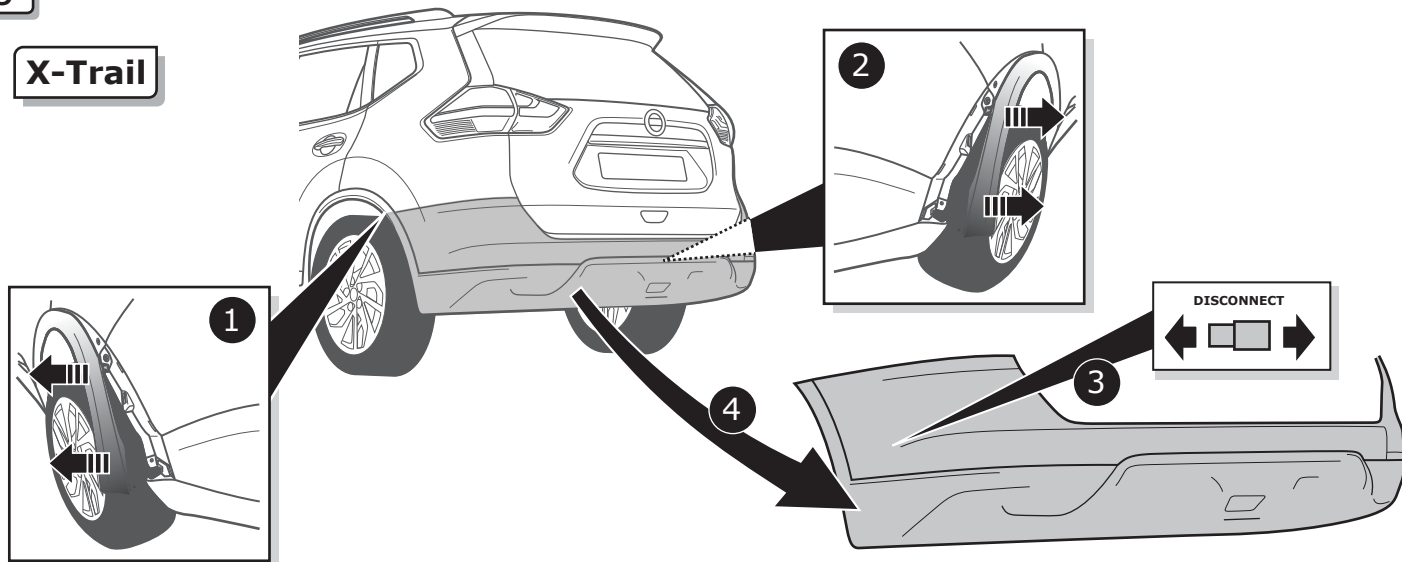

X-Trail

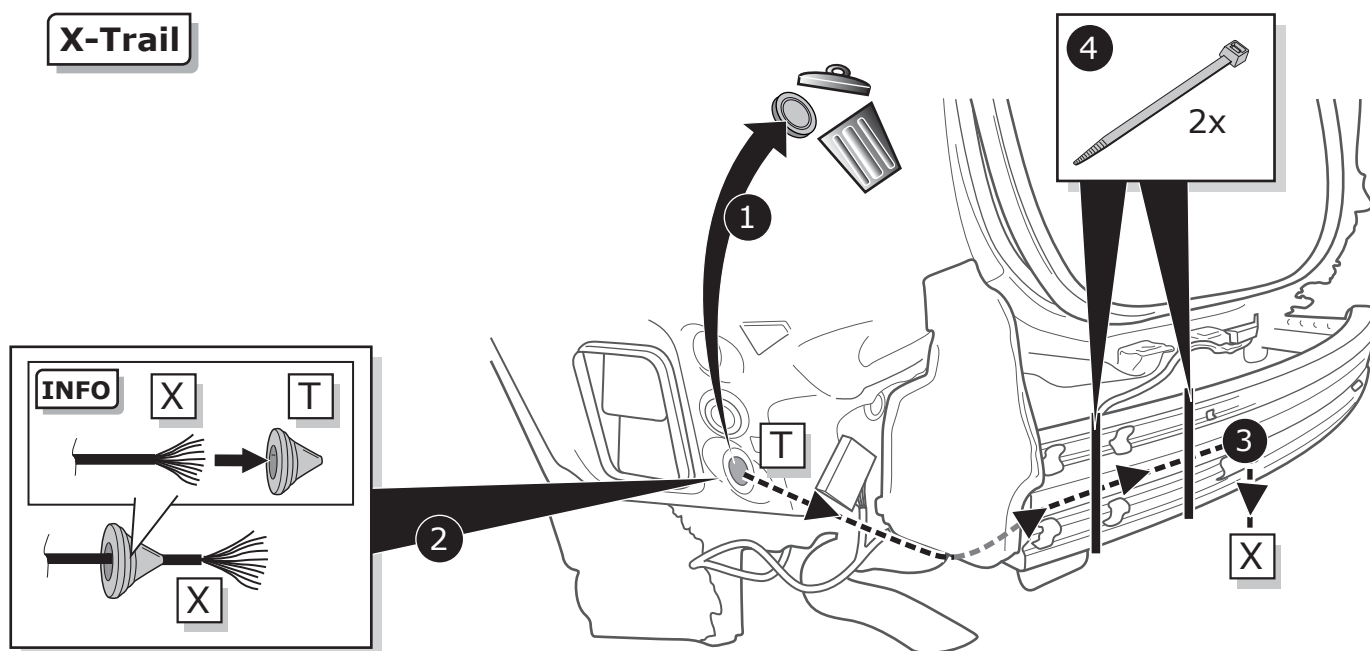

A

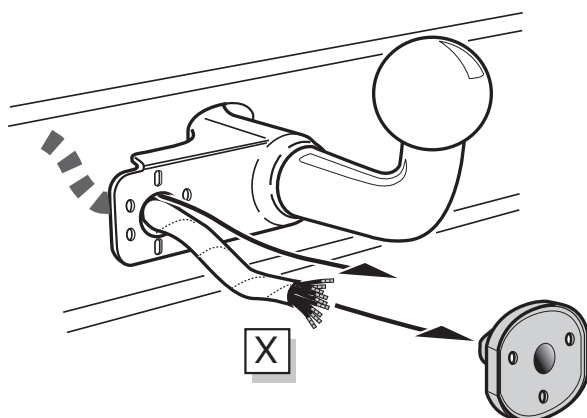

INFO

SOCKET CONNECTION



Page 12

B

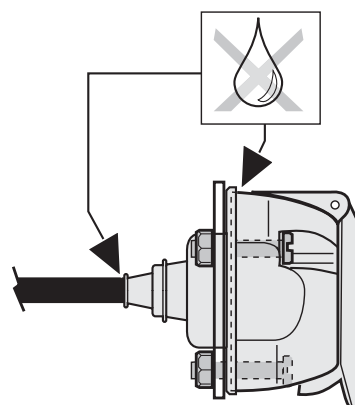
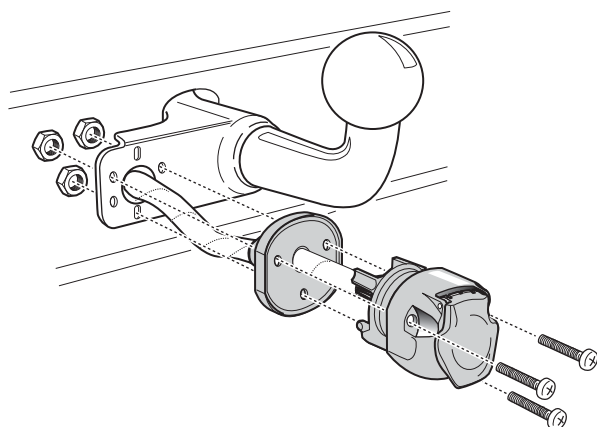

11

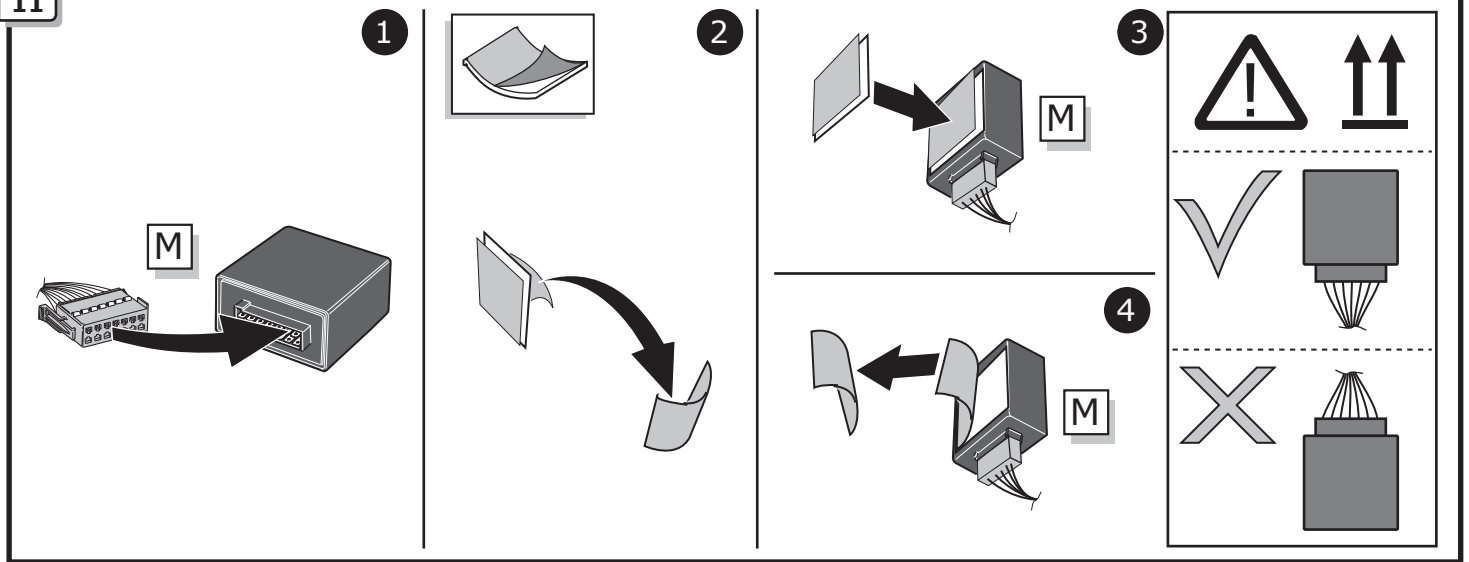

12

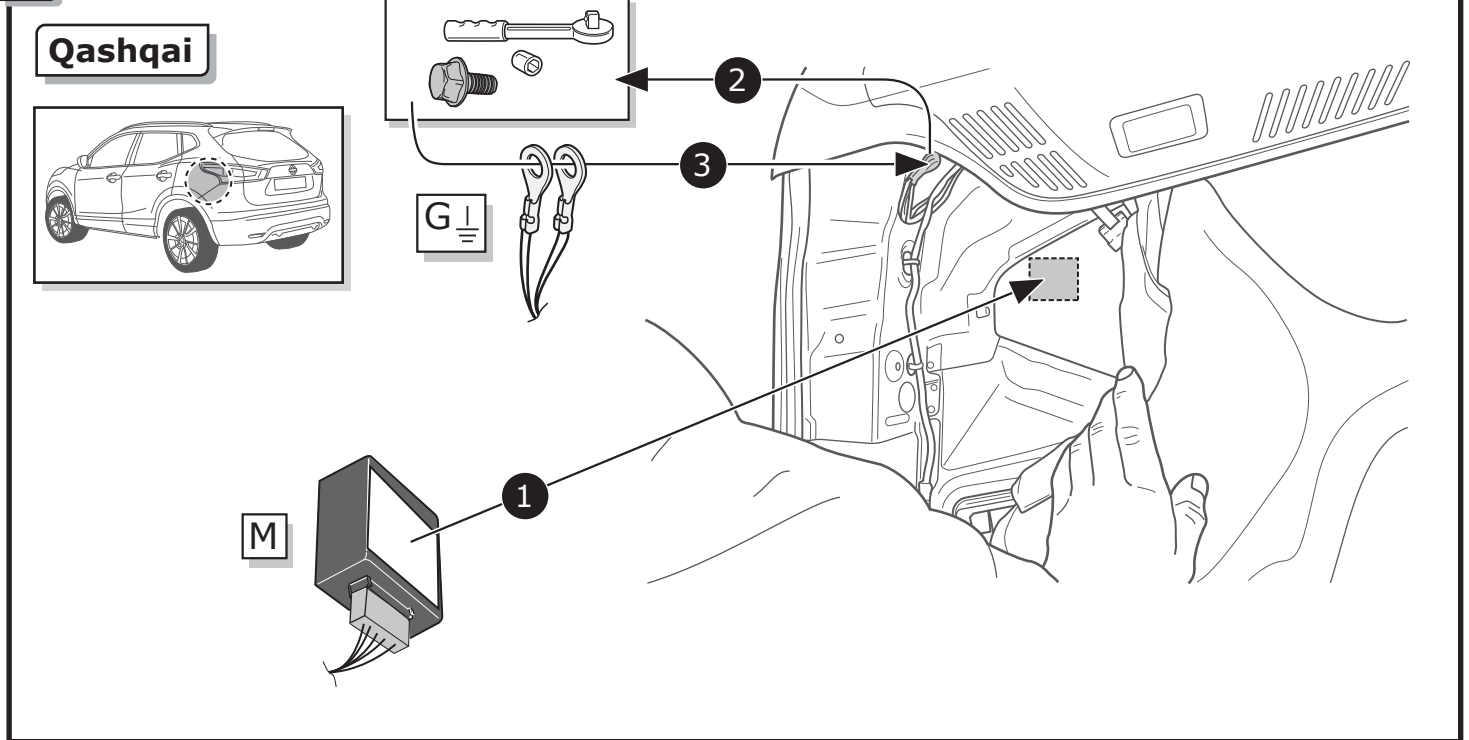

13

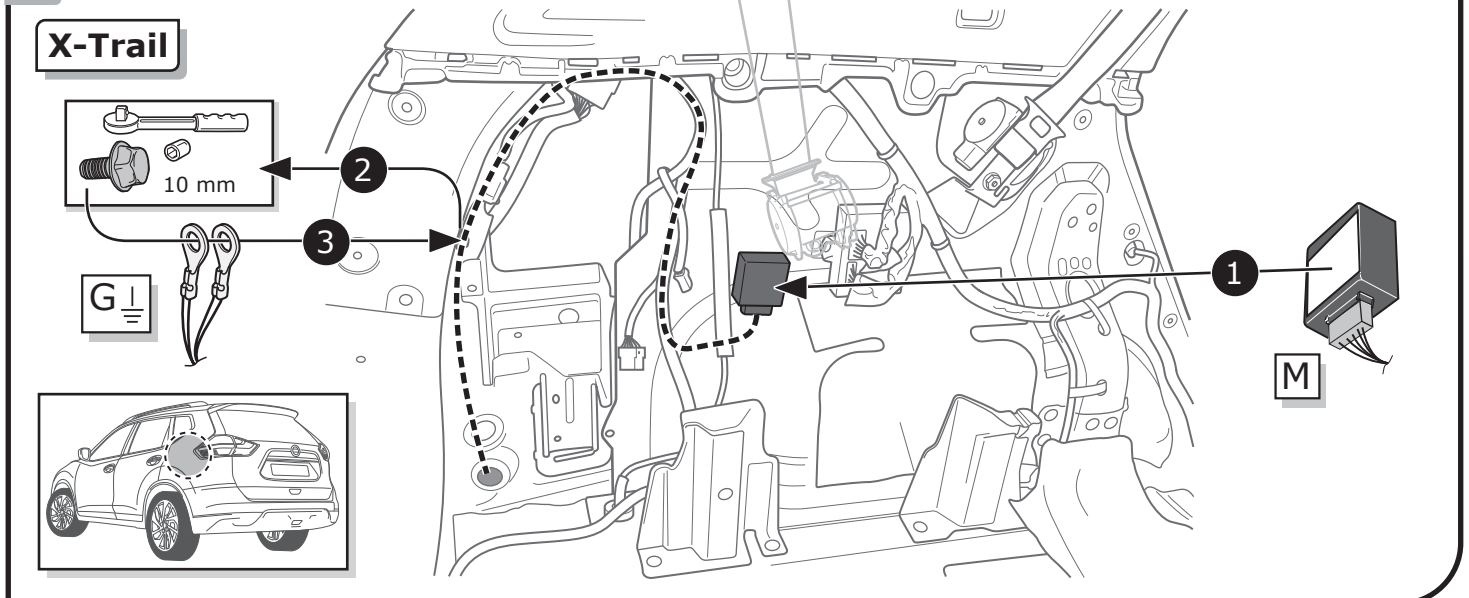

14

Qashqai

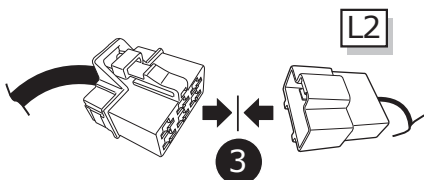
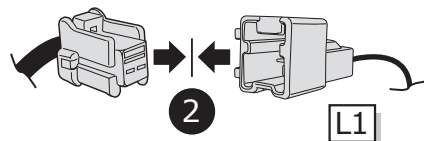
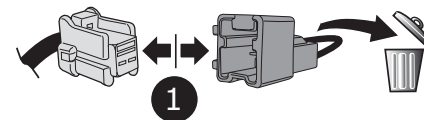
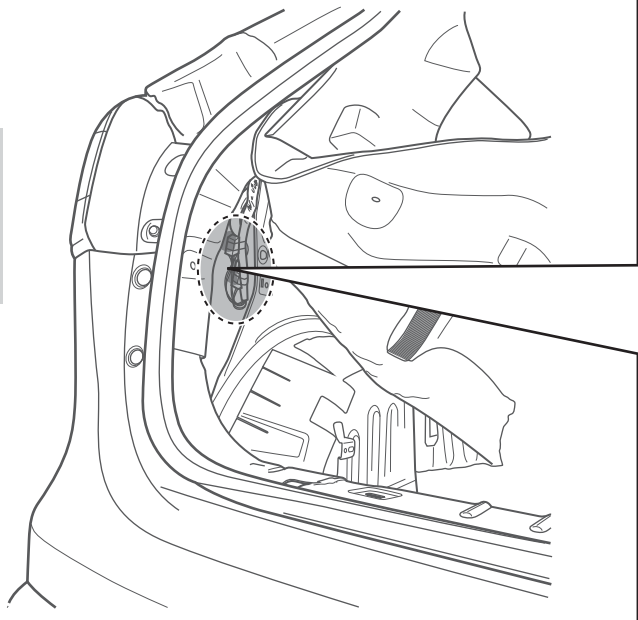
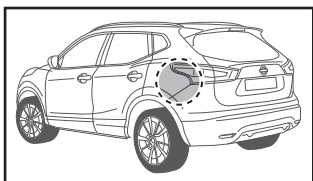

15

X-Trail

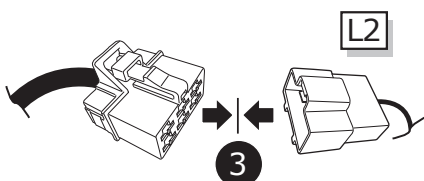
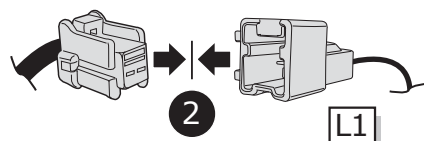
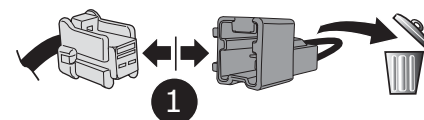
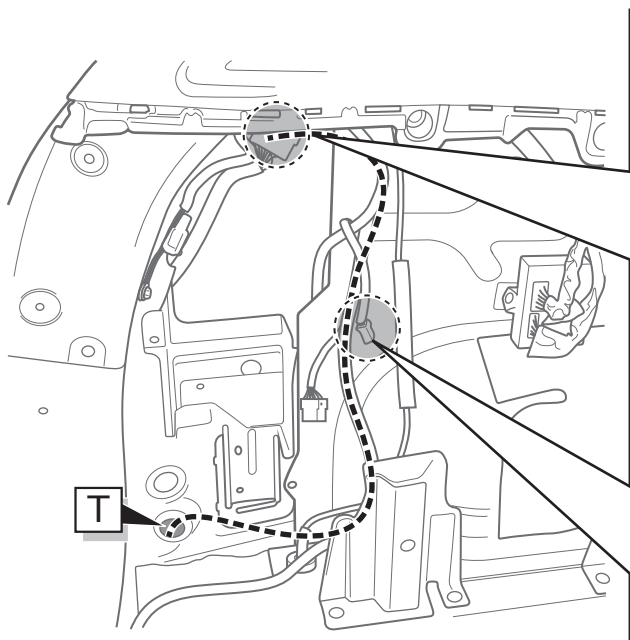
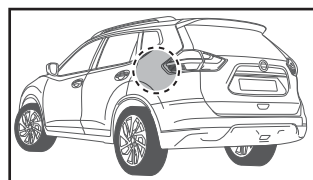

16

Qashqai

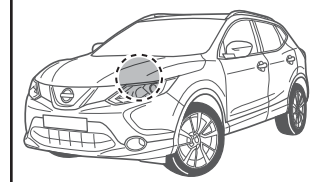

X-Trail

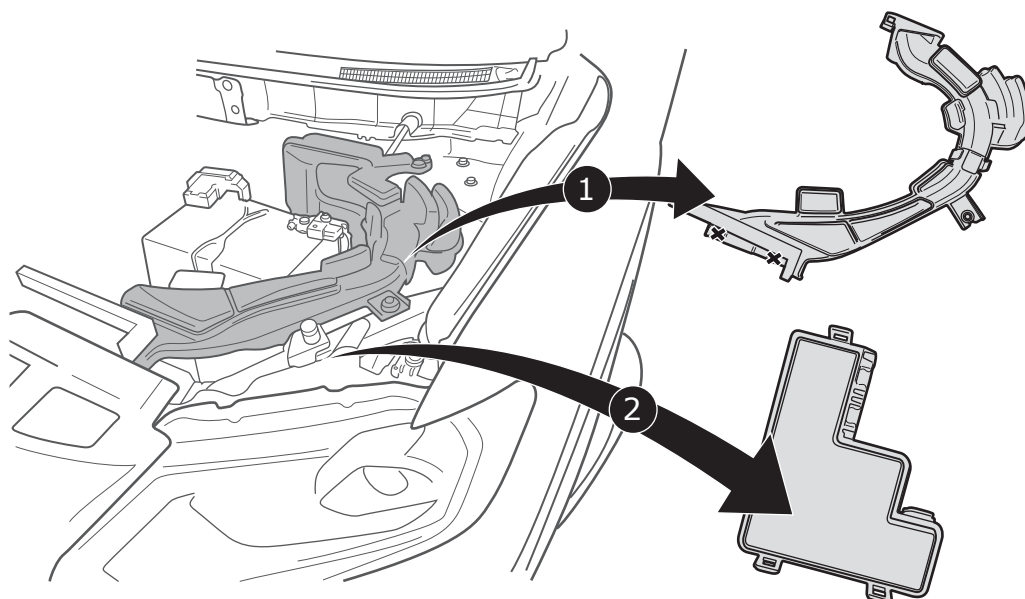
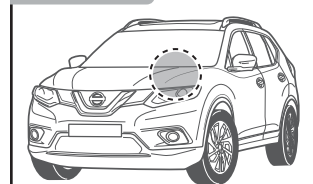

17

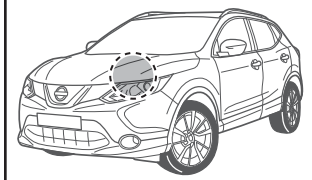
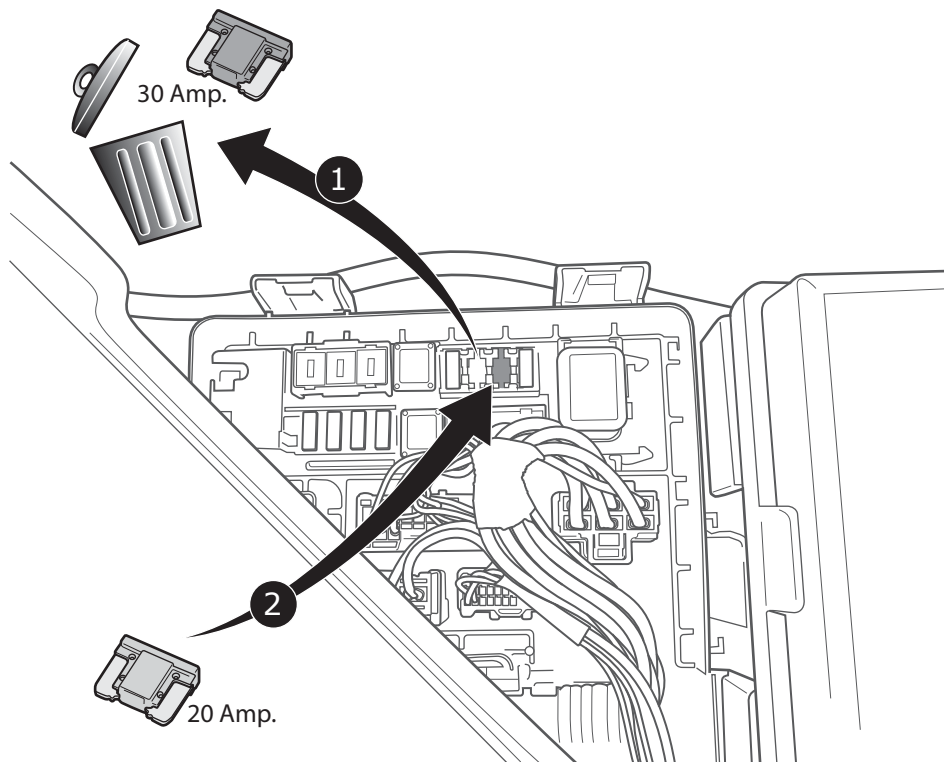
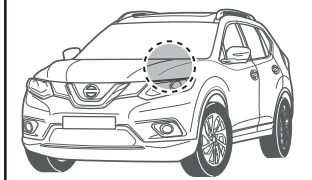
Qashqai**X-Trail**

18

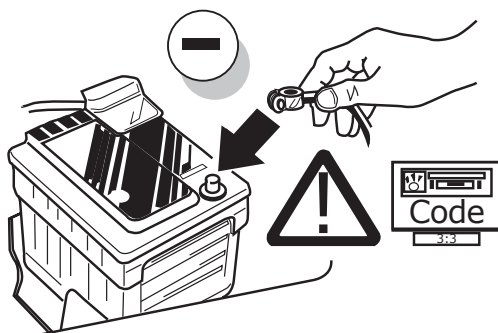

19

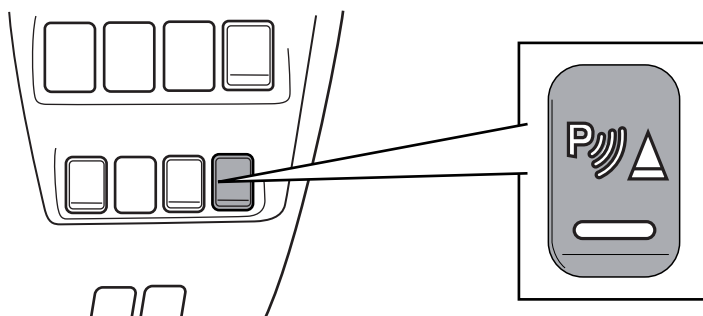
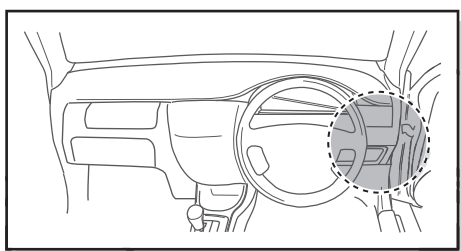
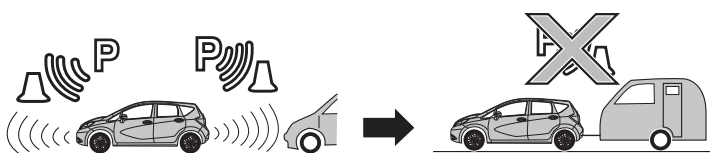
Option 1

Option 2

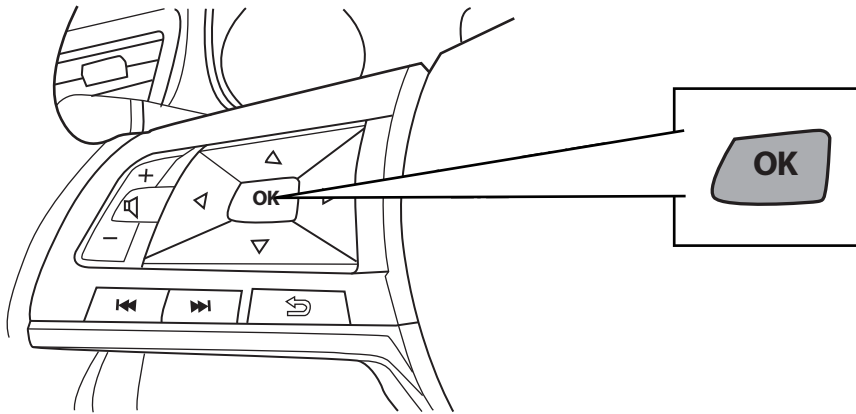
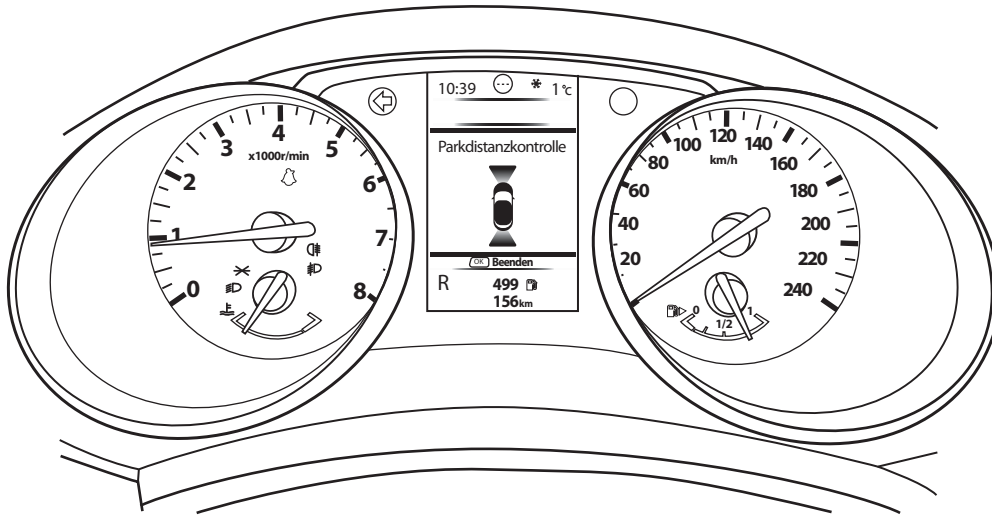
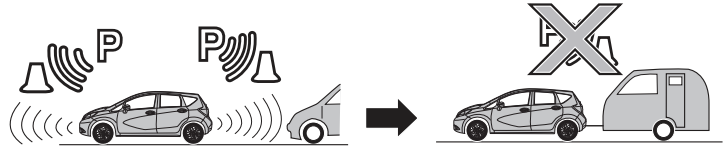

Option 3

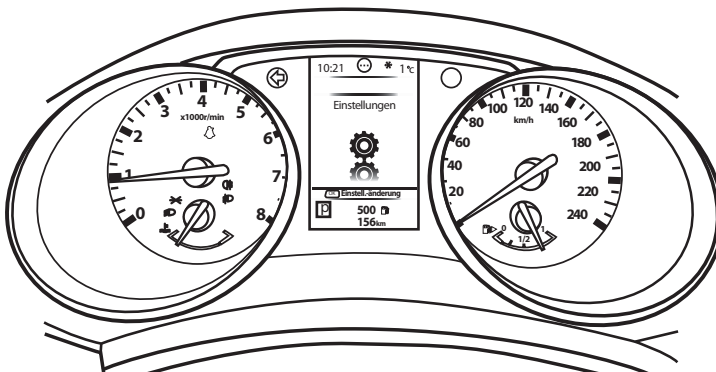
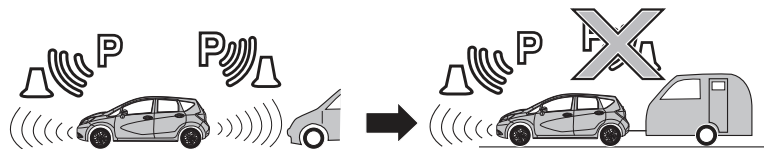

Einstellungen/
settings
↓
Fahrerassistenz/
driver assistance
↓
Parkhilfe/
parking assistant
↓
Sensor Heck ausschalten/
disable rear-sensor ✓

22

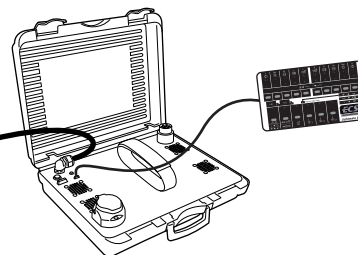
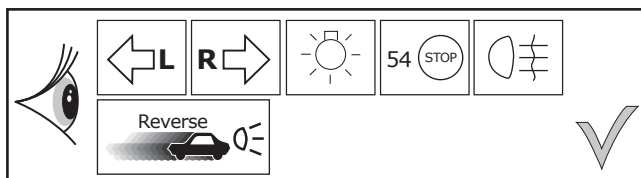
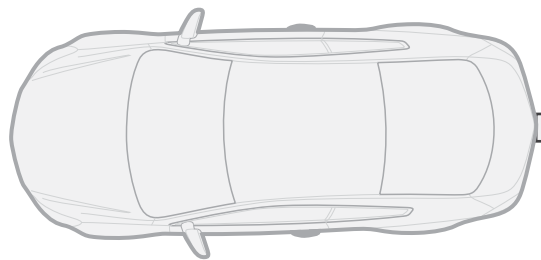

INFO

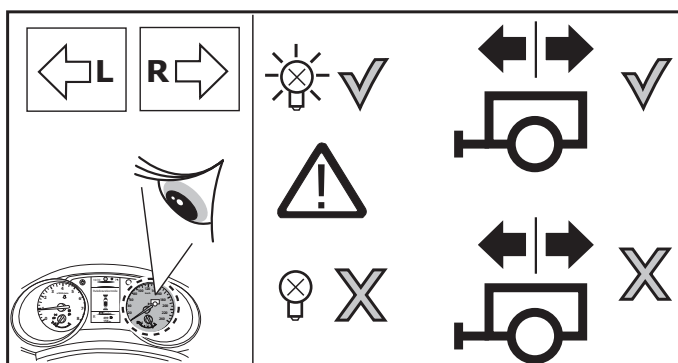
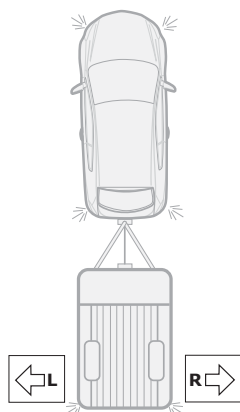

23

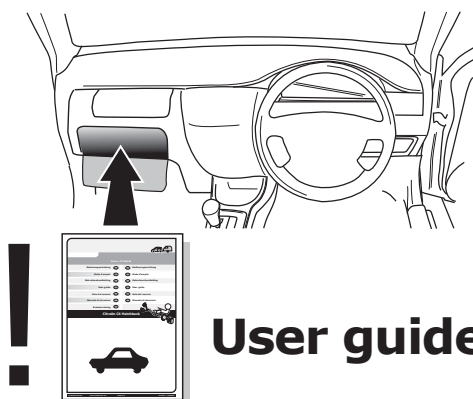

INFO

SOCKET CONNECTION

DIN/ISO 11446	1/L	2	3/31	4/R	5/58-R	6/54	7/58-L	8	9	10	11	12	13
Pmax	21W	2x21W		21W	52W	3x21W	52W	2x21W	180W/15Amp	180W/15Amp			
Colour	Yellow	Blue	White	Green	Brown	Red 1,00 mm ²	Black	Black/ Red	Brown/ White	Red 2,50 mm ²	White	-	White