

Seat Cupra Born	11/2021 >>
Skoda Enyaq iV	04/2021 >>
Volkswagen ID.Buzz	10/2022 >>
Volkswagen ID.3	07/2020 >>
Volkswagen ID.4	03/2021 >>
Volkswagen ID.5	05/2022 >>

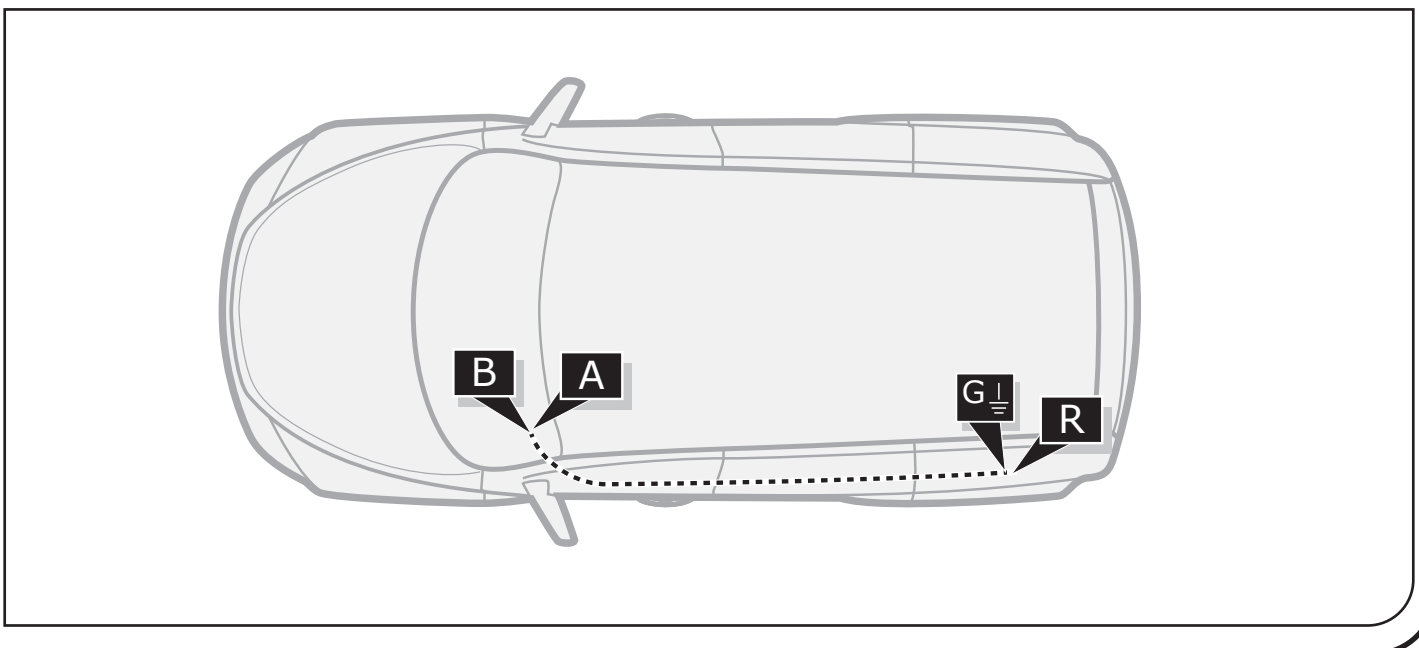

## Rear Foglamp cut-off MEB for multiple VAG vehicles

Part No: UN-269-ZZU

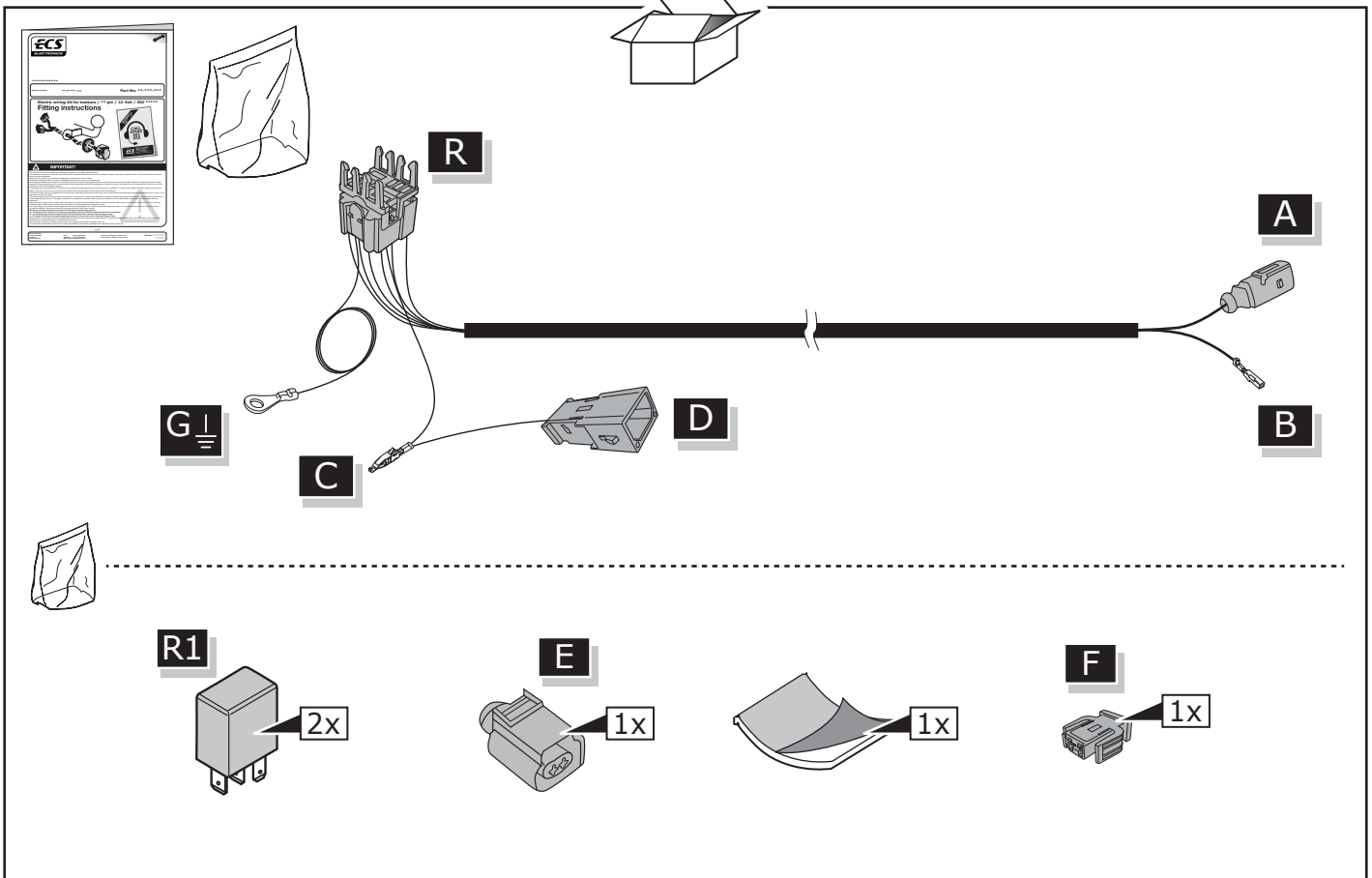

## SYMBOL EXPLANATION

	Left (58-L) respectively Right (58-R) tail light
54	Stop light (54) / high mounted, third stop light (54)
	Turn signal indicator left
	Turn signal indicator right
	Rear fog light(s)
	Reversing light(s)
	Permanent power supply / 13pin socket, chamber 9
	Charging wire for trailer battery / 13pin socket, chamber 10
	Trailer / trailer recognition
<b>B+ /30</b>	Permanent current power supply
	Ground or Earth (31)
	Ground connection battery terminal lug
	Positive connection battery terminal lug

	Cigarette lighter / accessory socket
	Loudspeaker / buzzer
	Park Distance Control
	Switch / source of function
	Connect together
	Disconnect
	Look at / See further information
	Look carefully at selected area
	Present / Occupied / OK
	Not present / Not occupied / Not OK
	Acoustic indication
	Attention / important advice
	Fuse / fuse capacity 20 Ampère

## TOOLS

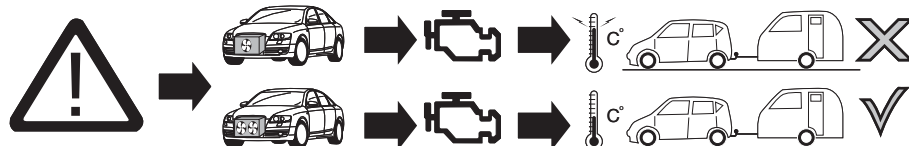
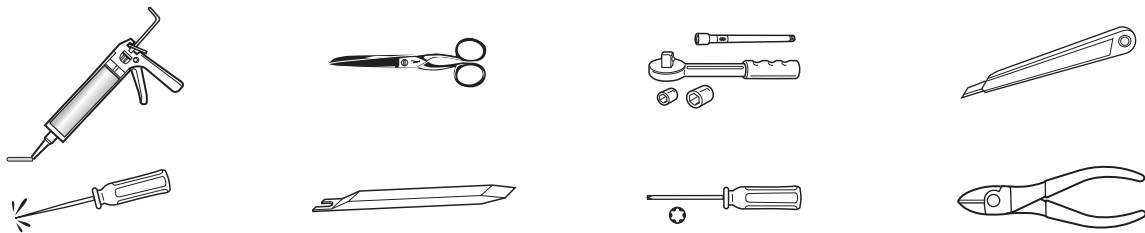

### ATTENTION!

The vehicle's cooling capacity may have to be increased when retrofitting a trailer coupling!  
You must observe the manufacturer's instructions!!

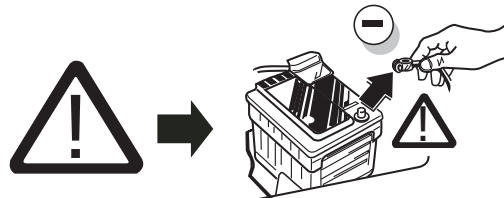

Note: It may be necessary to check if this vehicle has a stored radio code before disconnecting the battery!



### ATTENTION!

In order to avoid mal-functions and damage to the vehicle's electrical system the earth terminal **must be disconnected** from the vehicle's battery **before starting work!**

Both the trailer module and the vehicle's control unit for the electrical system can be damaged during work on the data bus connections if the battery is not disconnected!

1

Please pay attention to the manufacturer's instructions when disconnecting and reconnecting the vehicle's battery!

**ID.3**

**ID.Buzz**

**Cupra Born**

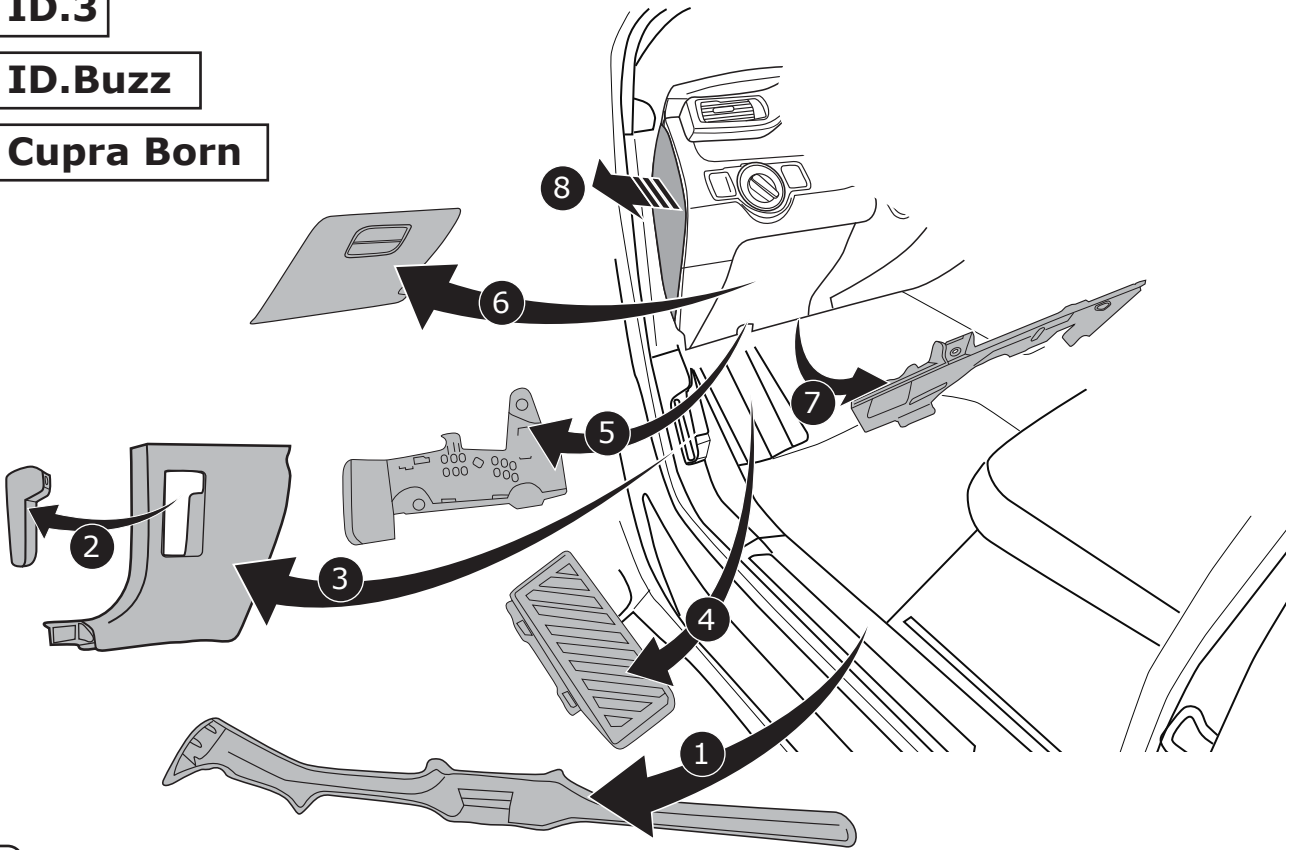

2

**ID.4**

**ID.5**

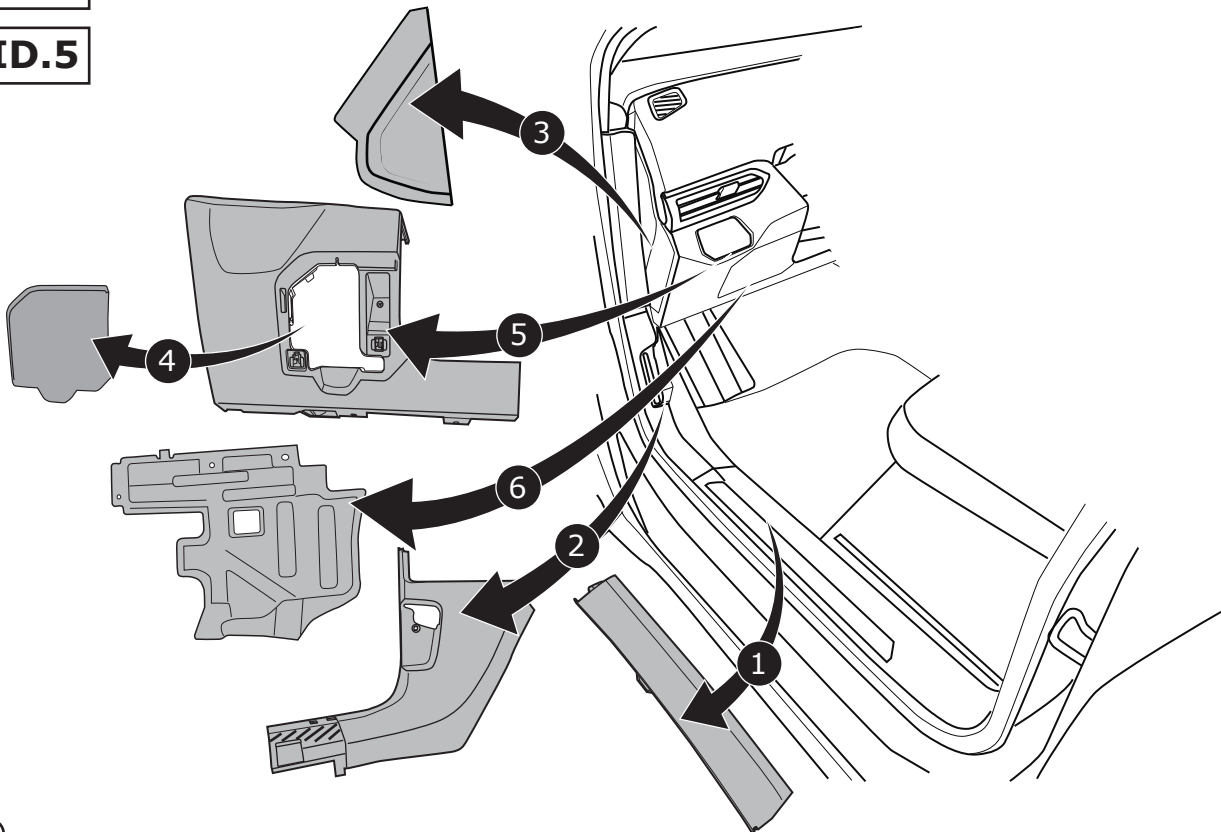

3

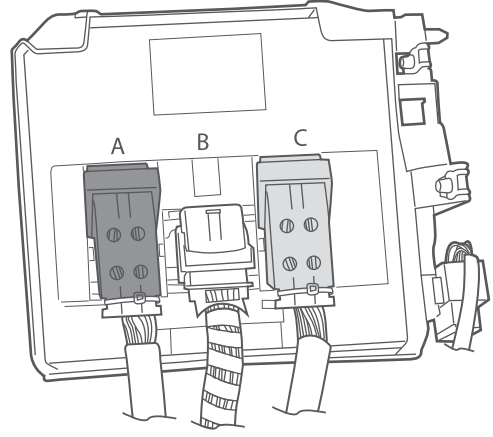
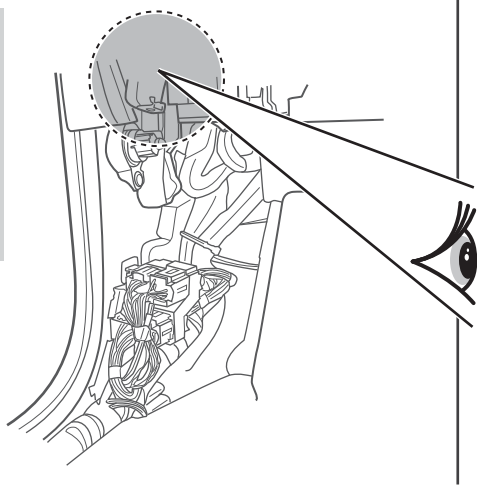
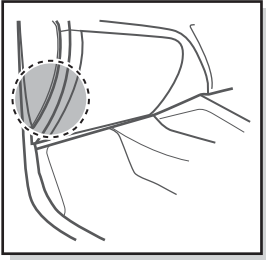

4

### Body Control Module

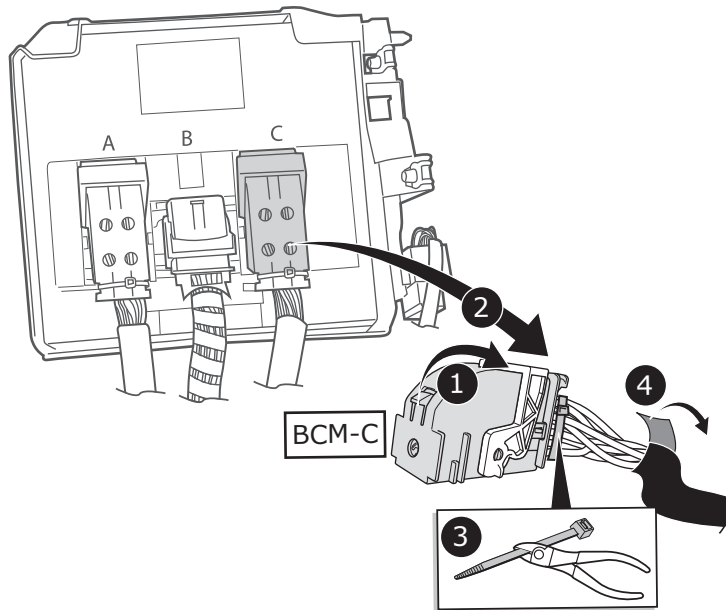

5

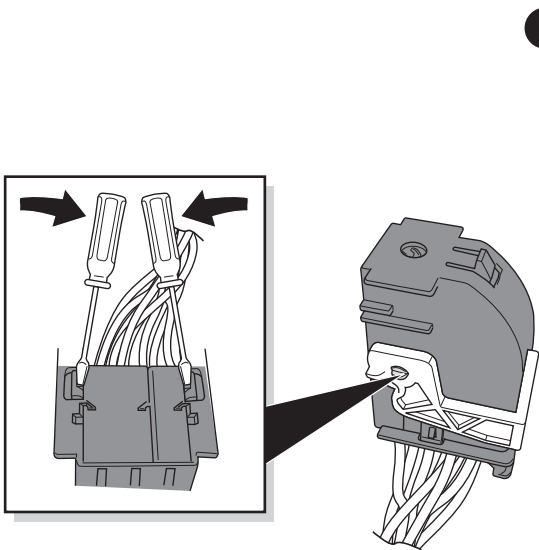

6

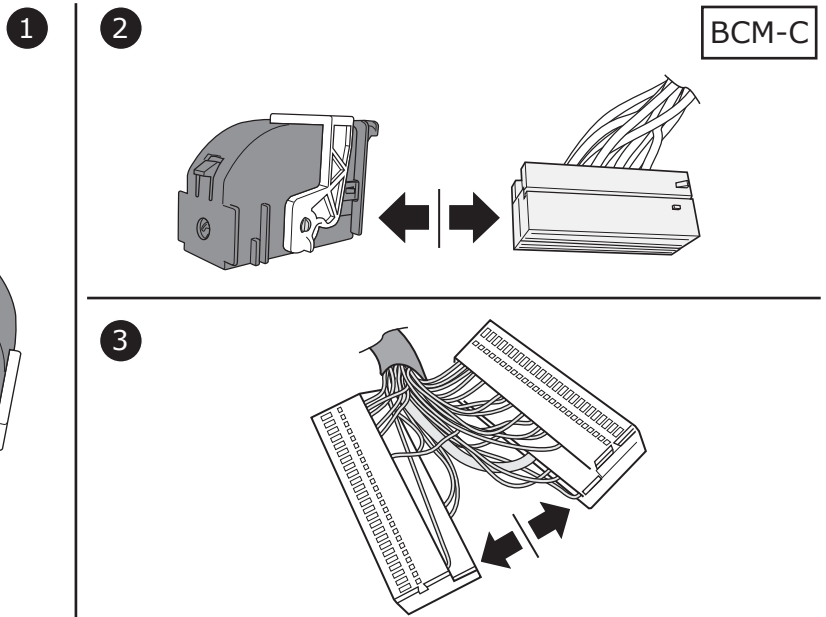

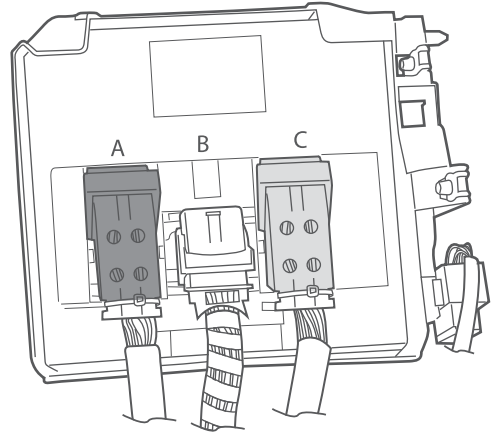
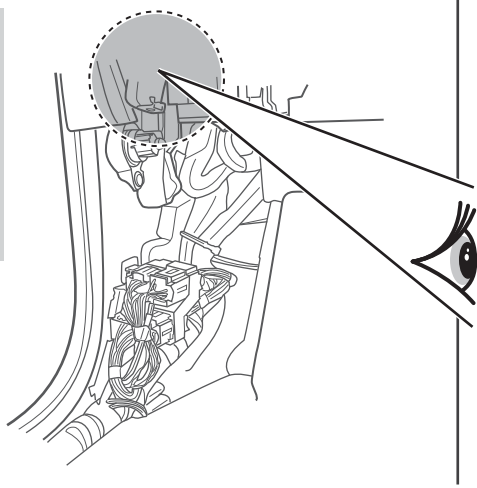
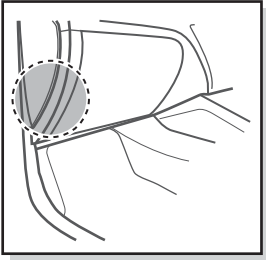

7

### Body Control Module

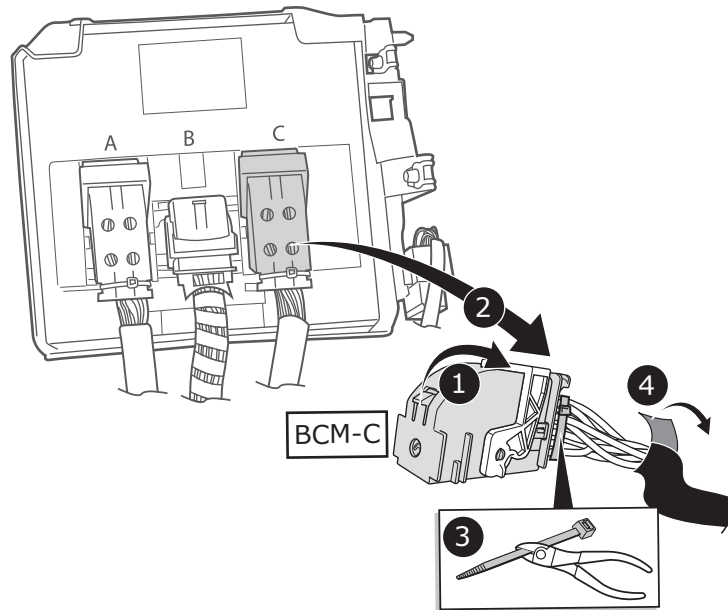

8

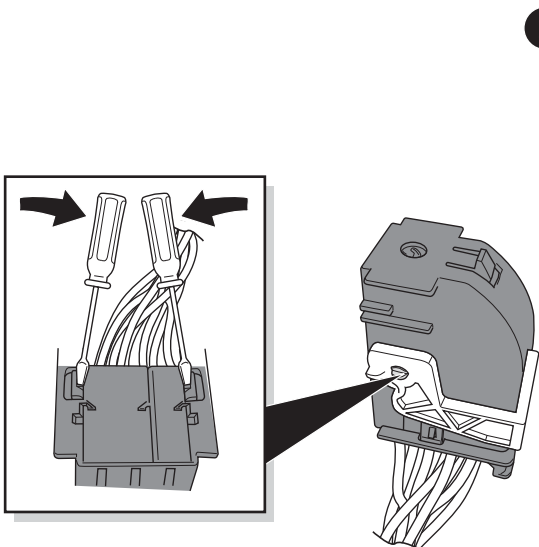

1

2

BCM-C

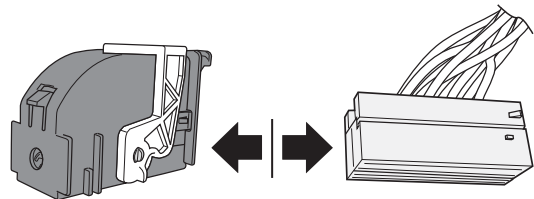

3

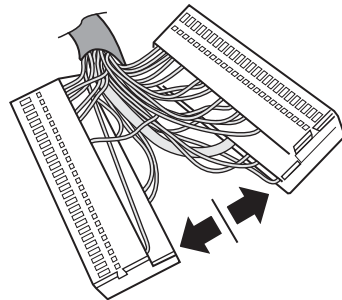

9

BCM-C

ID.3

ID.4

ID.5

ENYAQ IV

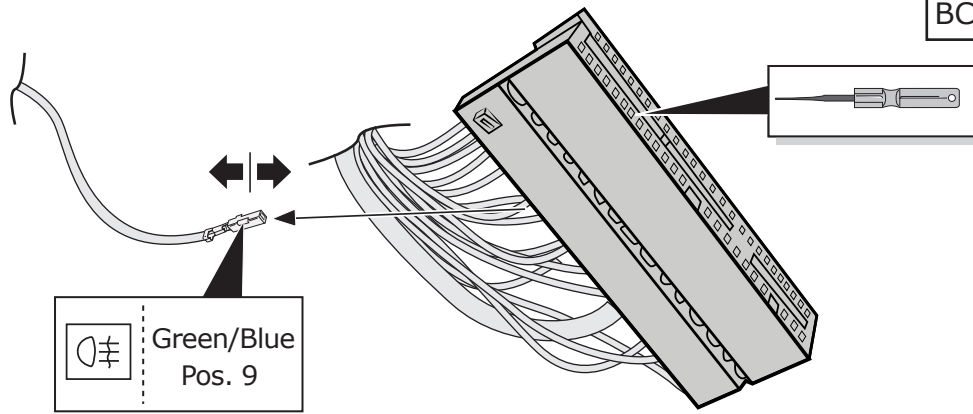

10

BCM-C

ID.3

ID.4

ID.5

ENYAQ IV

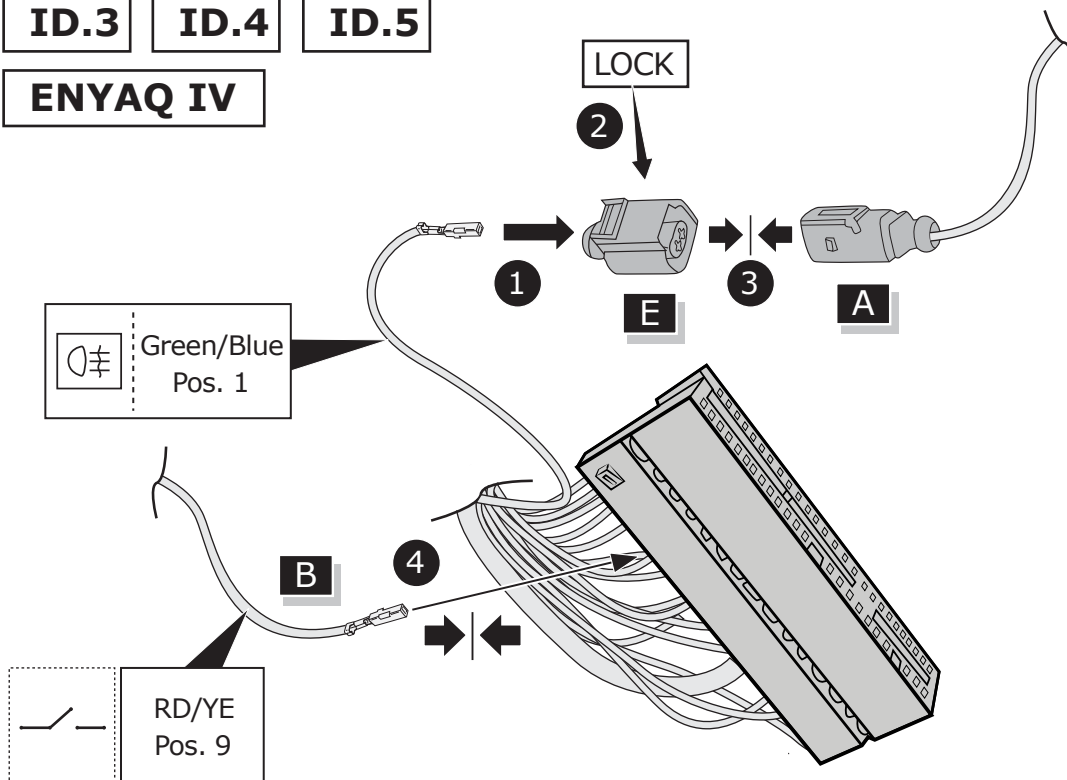

11

BCM-C

Cupra Born

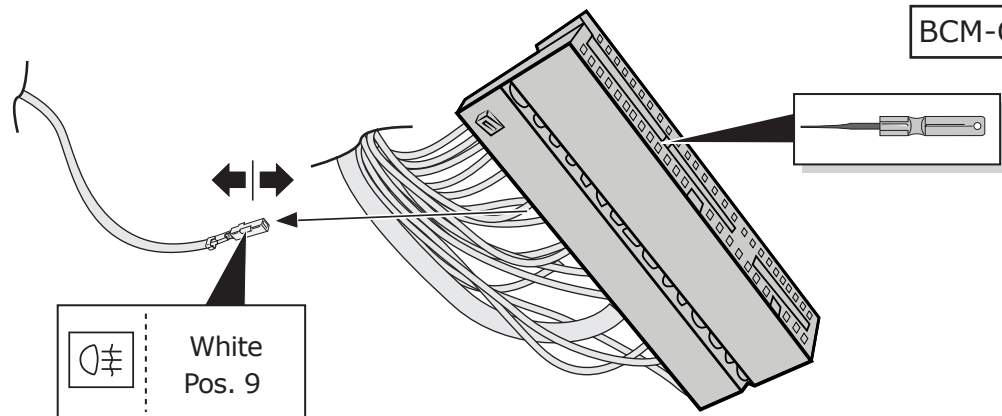

12

# Cupra Born

BCM-C

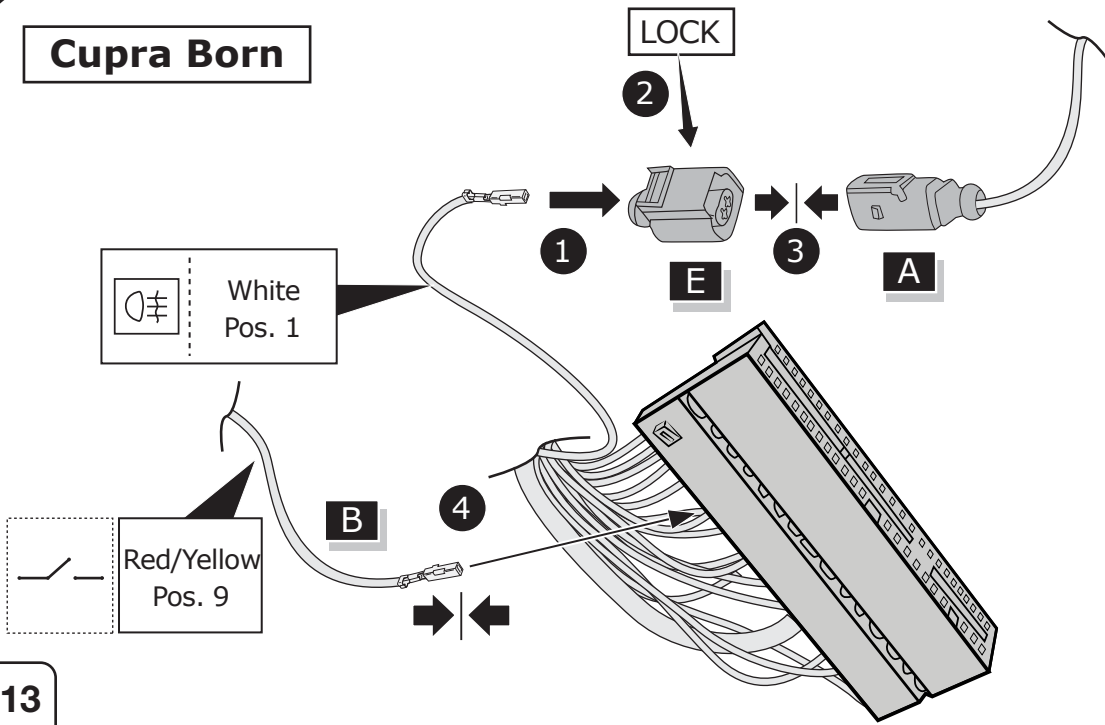

13

# ID.Buzz

BCM-C

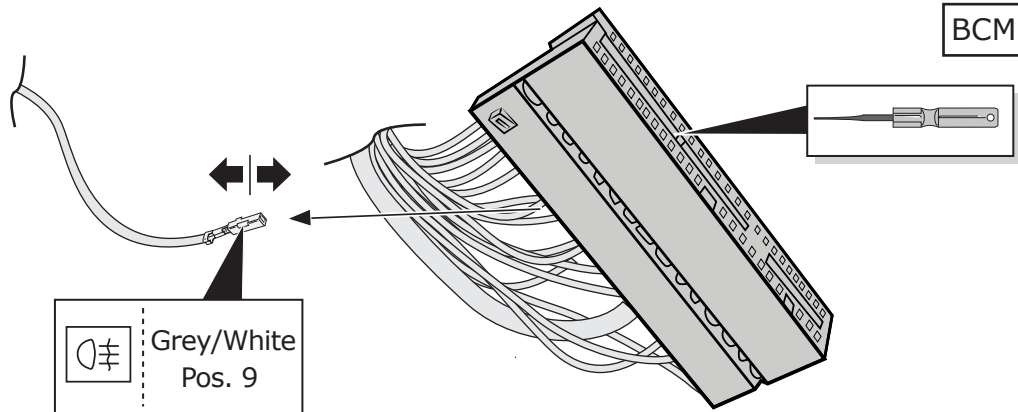

14

# ID.Buzz

BCM-C

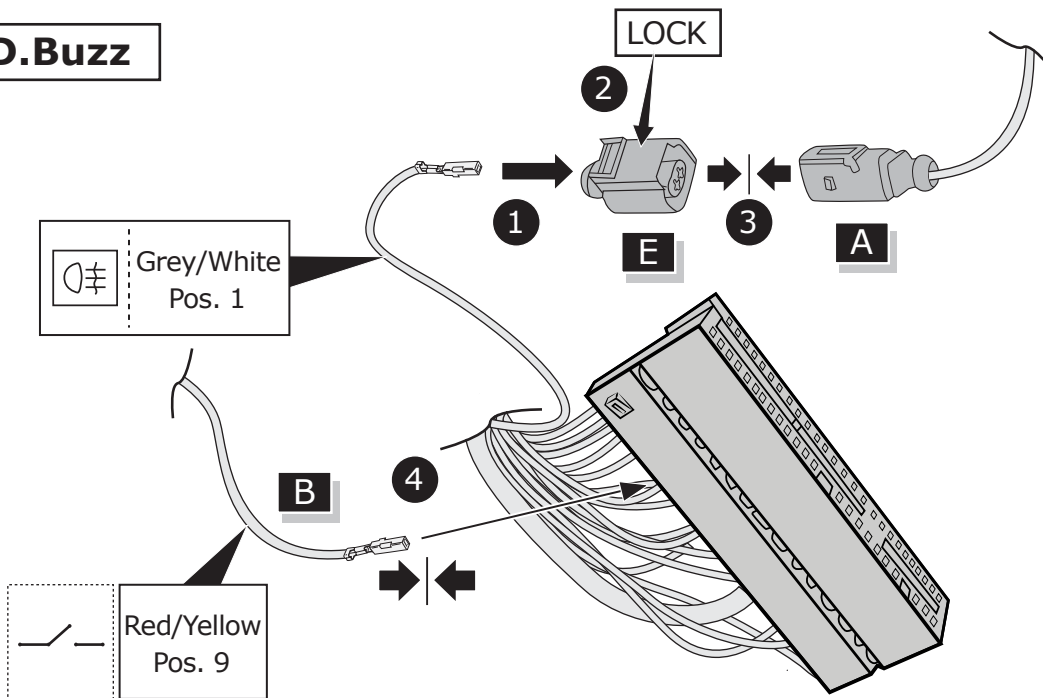

15



1

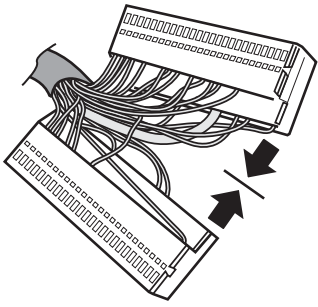

2

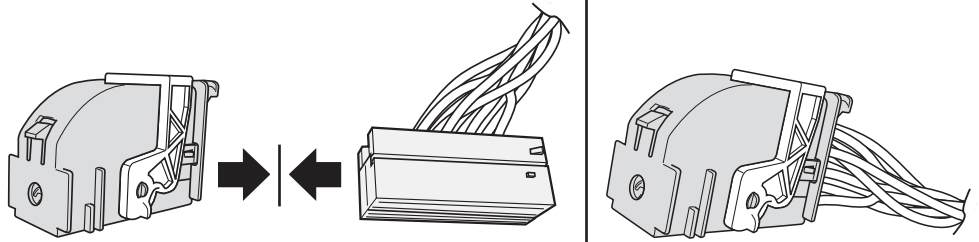

BCM-C

16

### Body Control Module

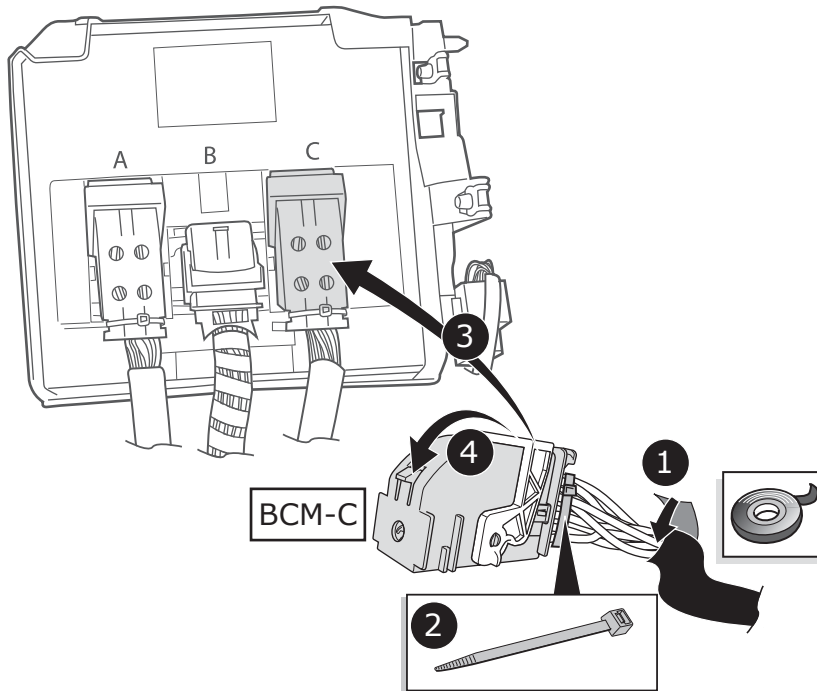

17

### Trailer Module

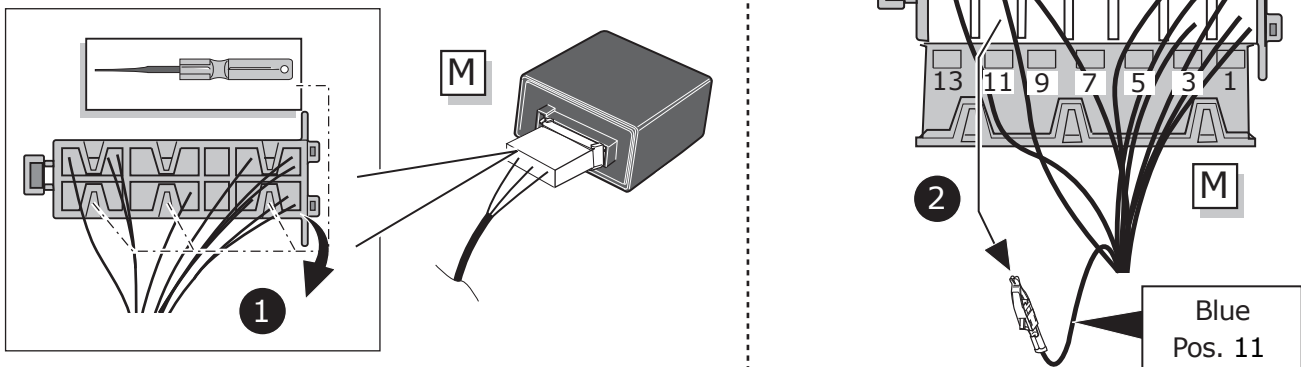

18



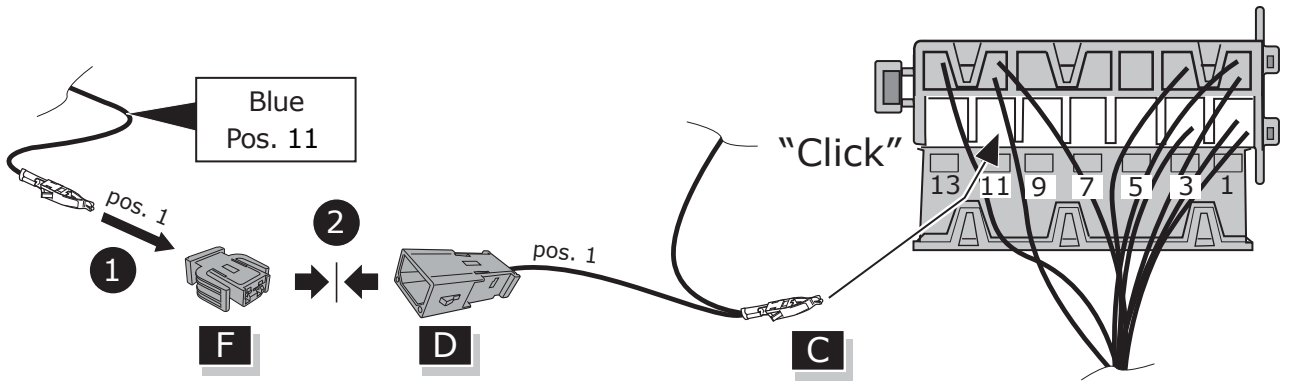

19

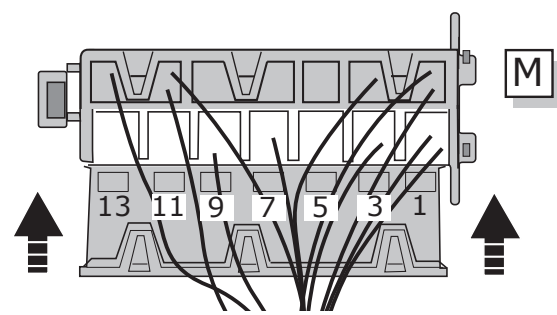

20

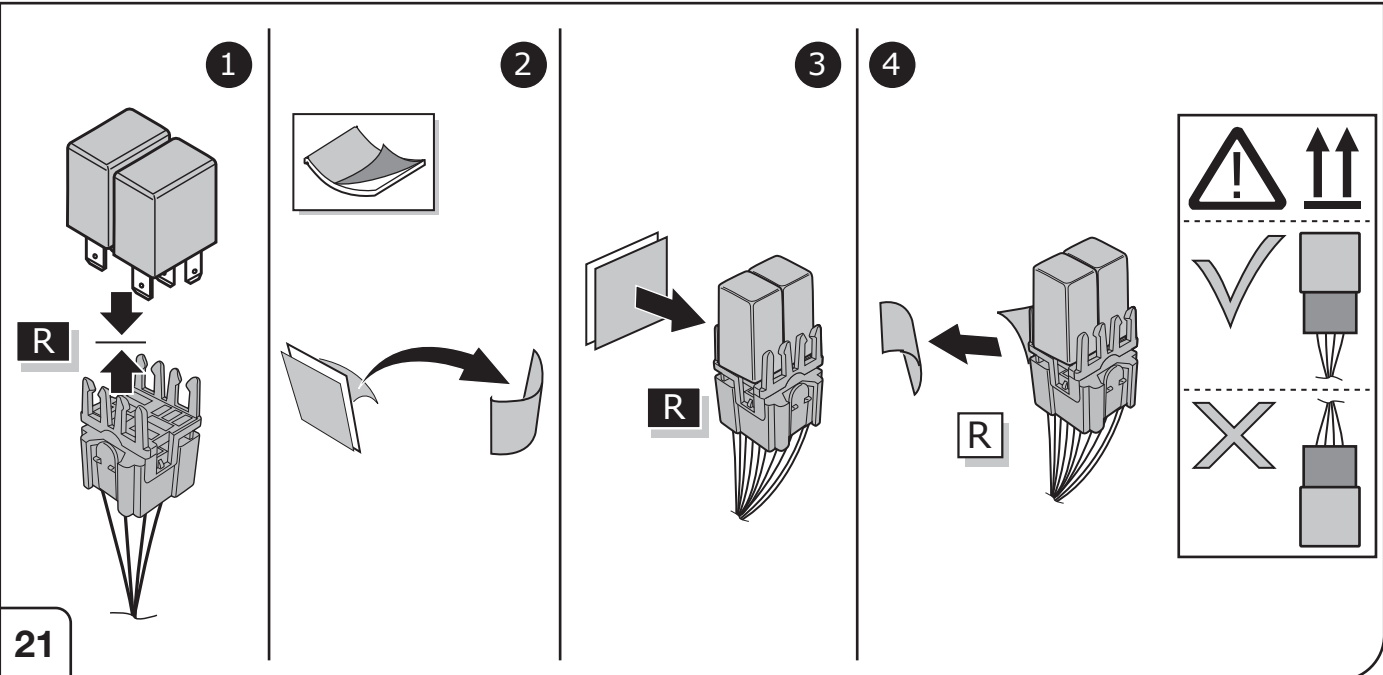

21

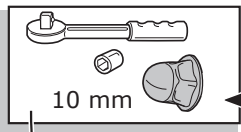
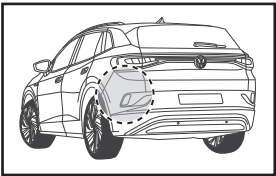

2

3

1

4

M

22

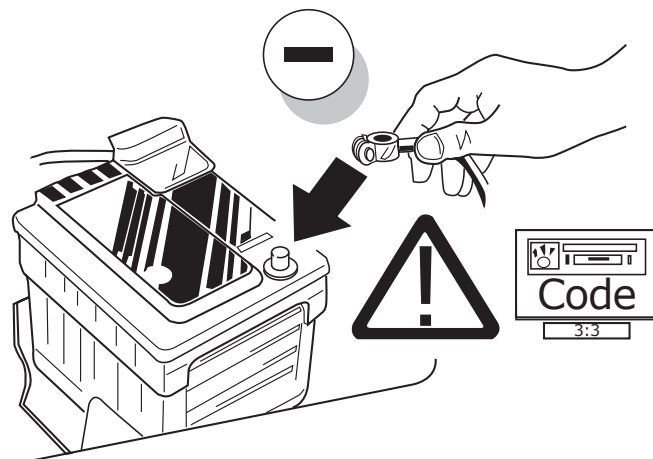

23

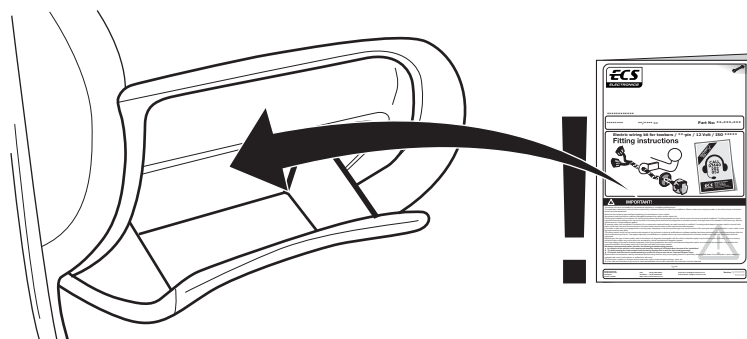

24