

**Volkswagen Passat Sedan 2005- /2013-  
Volkswagen Passat Variant 2005- /2013-  
Volkswagen Passat Variant Alltrack 2012-  
Volkswagen Passat CC 2008-  
Volkswagen CC 2013-**

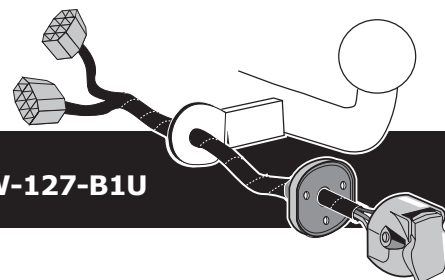



**Partnr.: VW-127-B1U**

- Fitting instructions electric wiring kit tow bar with 12-N socket up to DIN/ISO Norm 1724.
- We would expressly point out that assembly not carried out properly by a competent installer will result in cancellation of any right to damage compensation, in particular those arising by virtue of the product liability act.
- Contents of these kits and their fitting manuals are subject to alteration without notice, please ensure that these instructions are read and fully understood before commencing installation.
- Do not overload circuits; the maximum loads per connection are detailed in this manual.
- Attention! Before Installation, please read this manual carefully and inform your customer to consult the vehicle owners manual to check for any vehicle modifications required before towing.
- In the event of functional problems, troubleshooting must be limited to about 0.5 hours, contact the technical support:  
[ukts@ecs-electronics.com](mailto:ukts@ecs-electronics.com) / 07440 202 052.

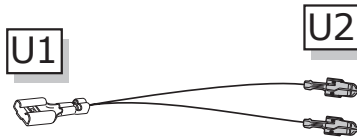
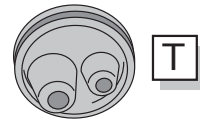
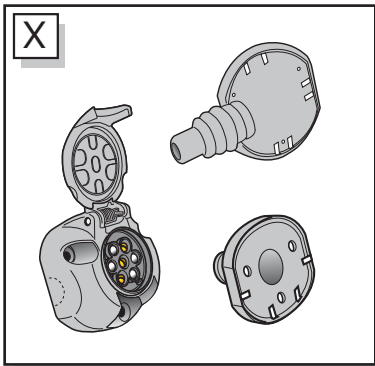
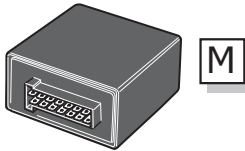
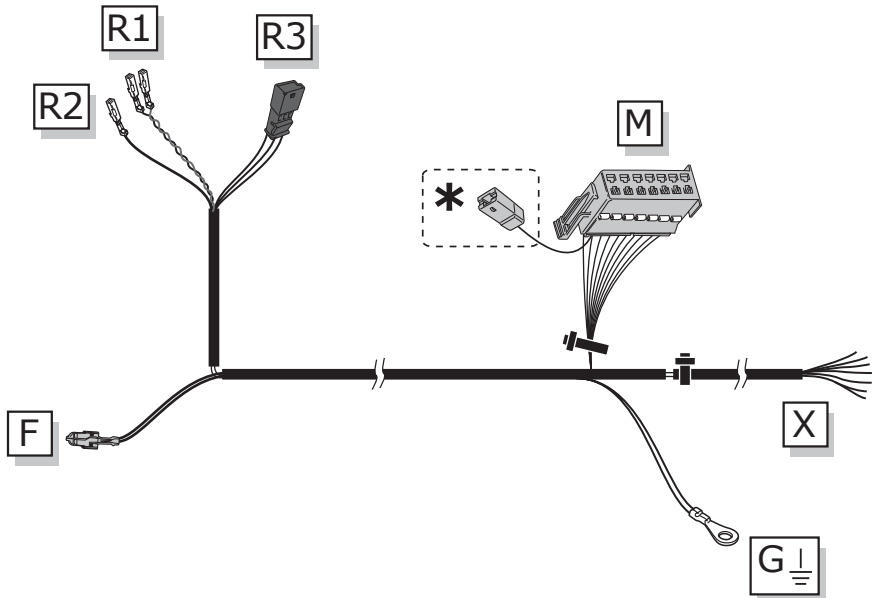
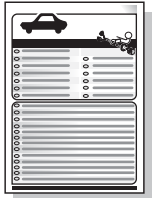
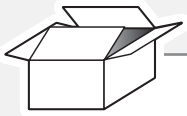

# Part list



\* Reverse signal preparation  
 → **Page 16**

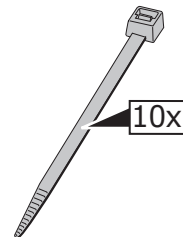
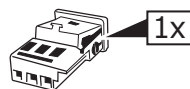
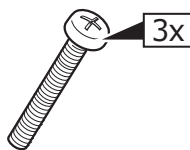
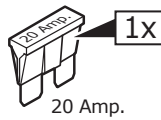
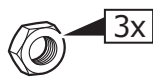

ROUTING

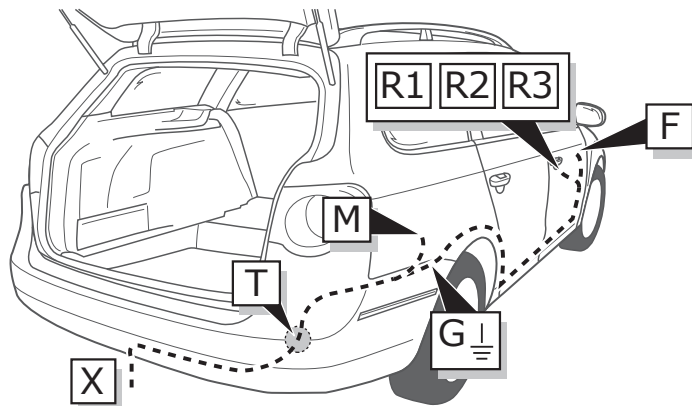
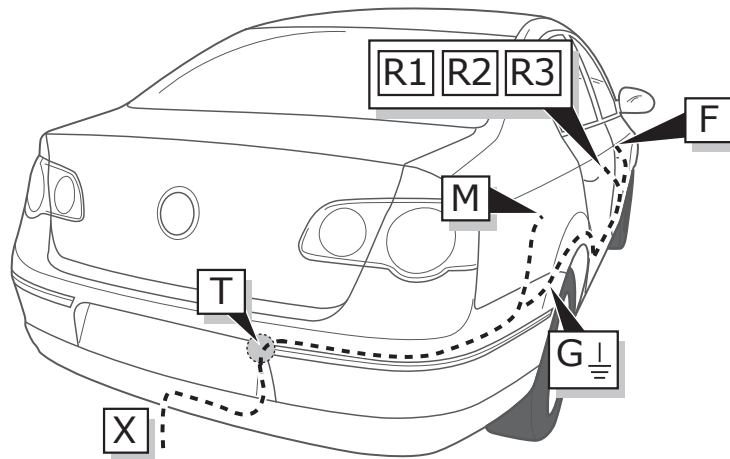
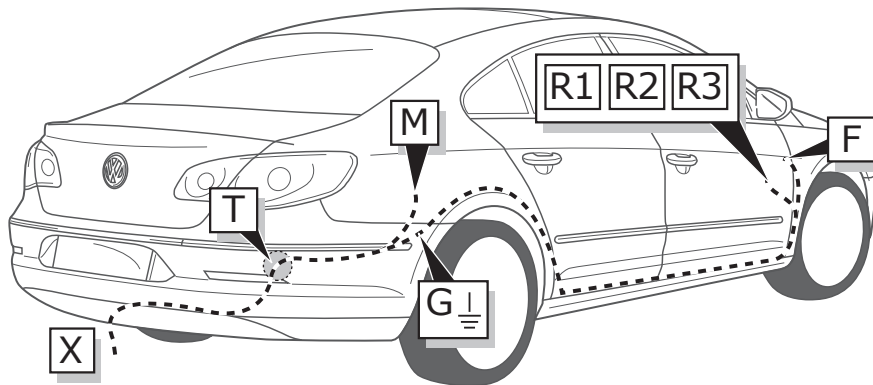

# SEDAN / VARIANT / CC

1

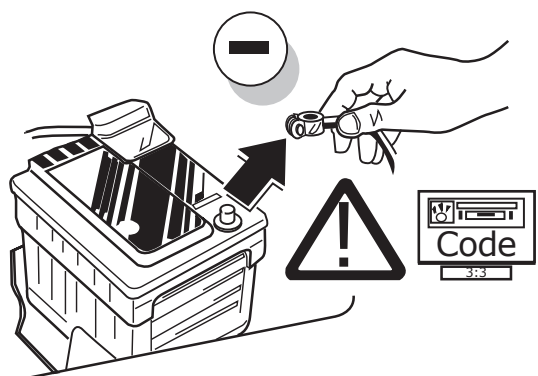

# SEDAN 2005-2010 - CC

2

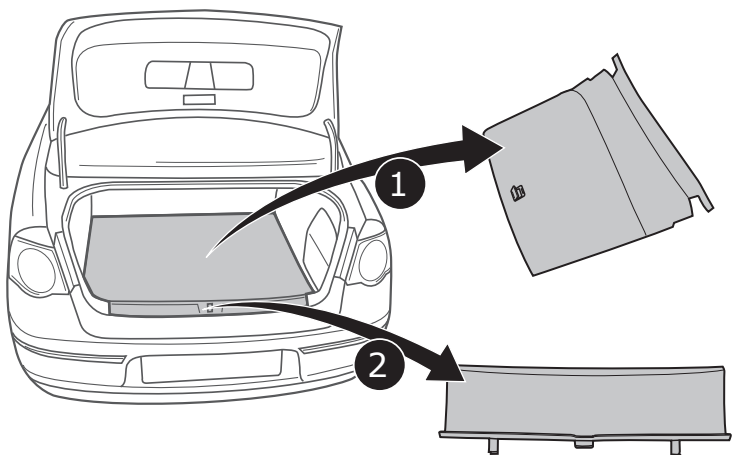

# SEDAN 2005-2010

3

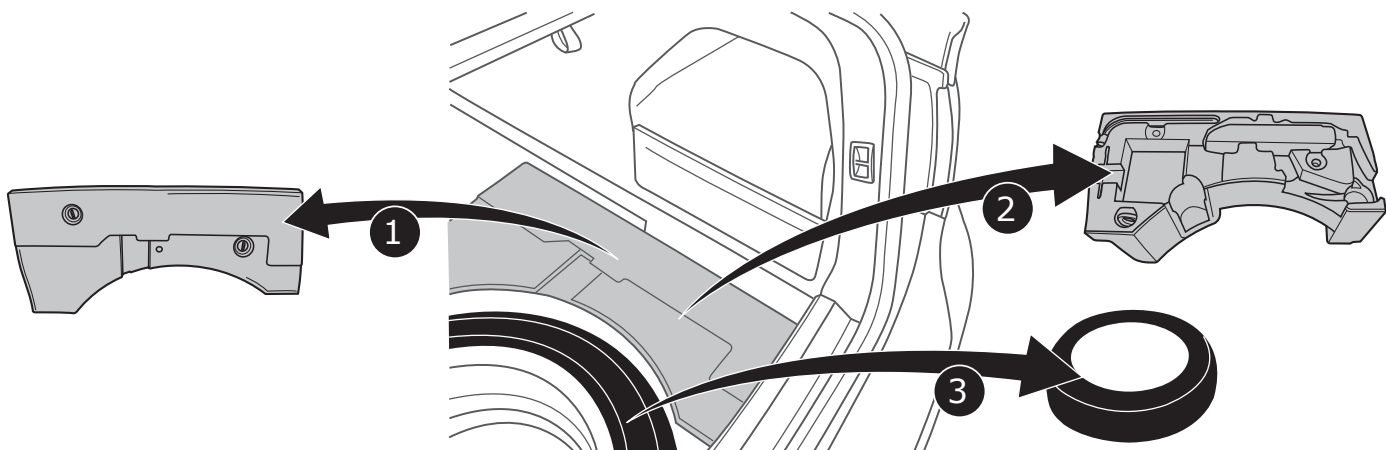

4

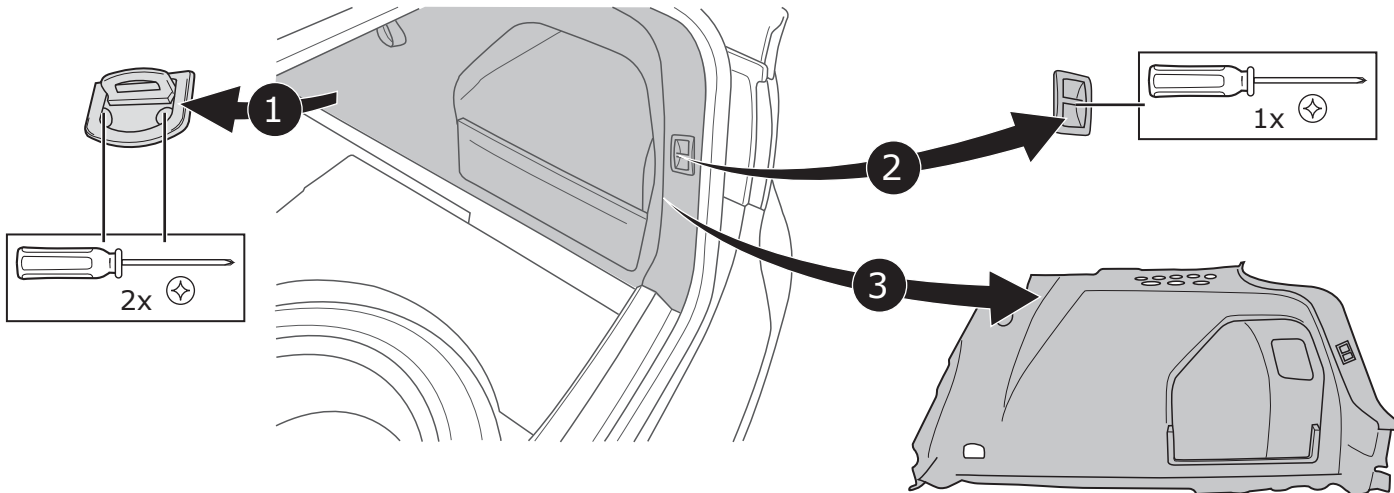

# VARIANT

5

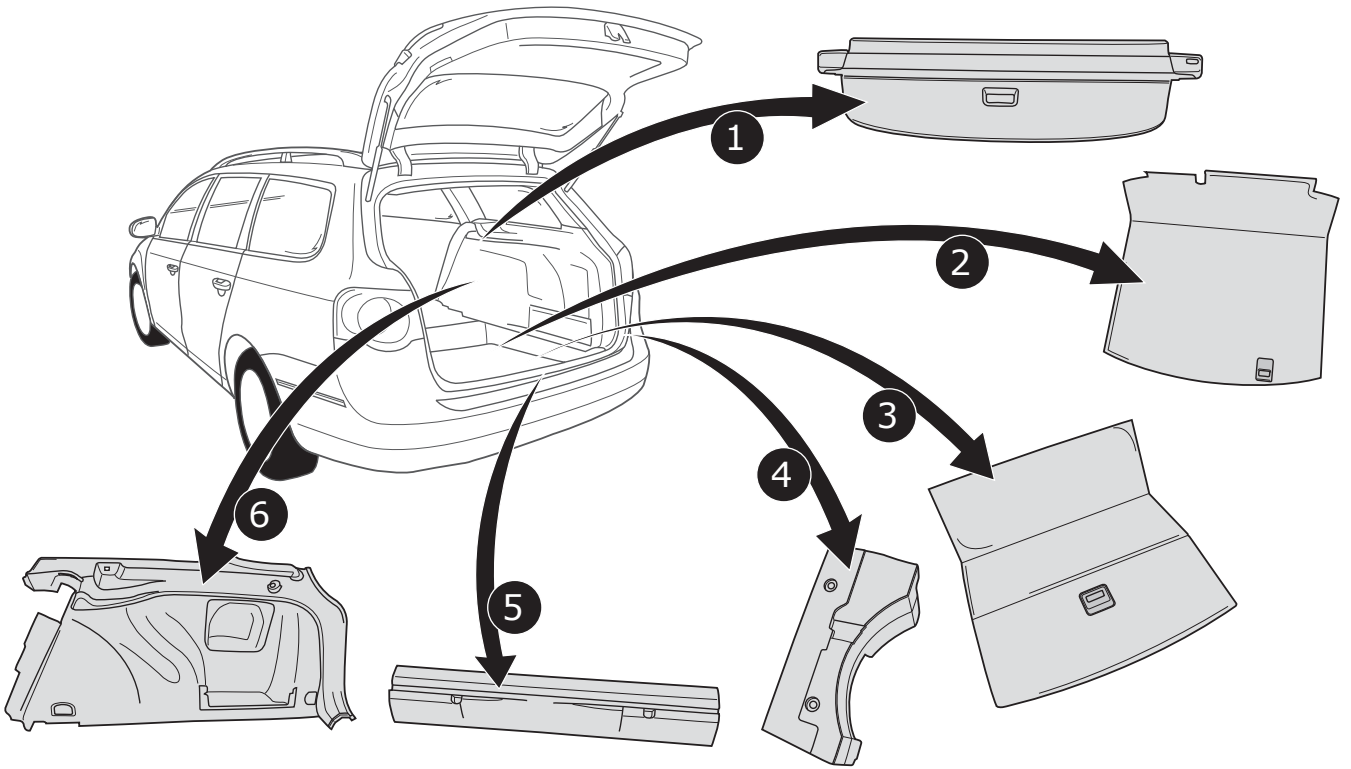

# CC / SEDAN 2011 ->

6

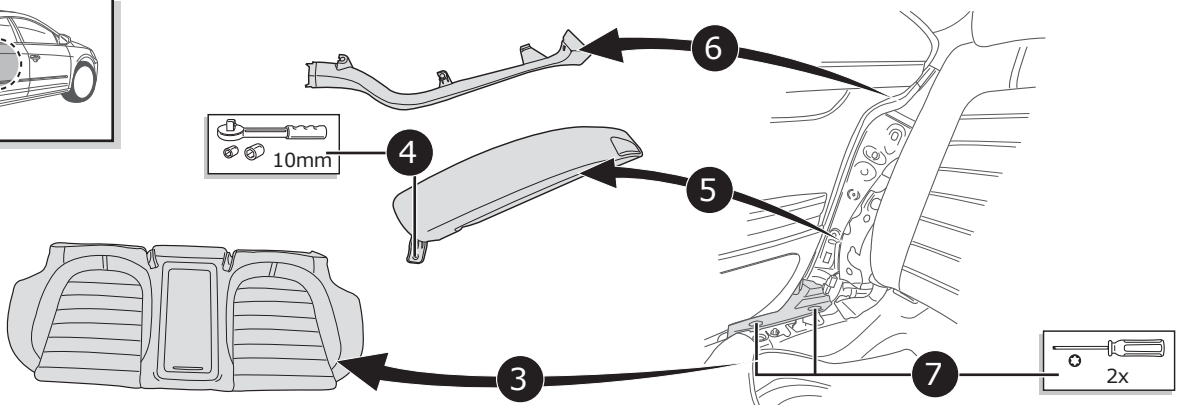
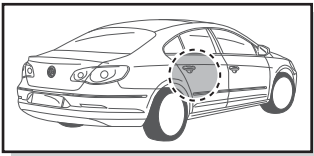
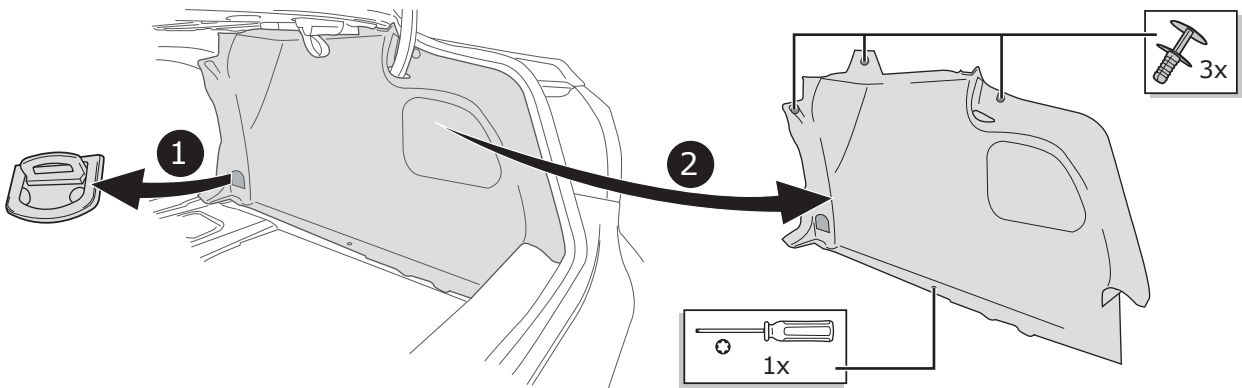

# SEDAN

7

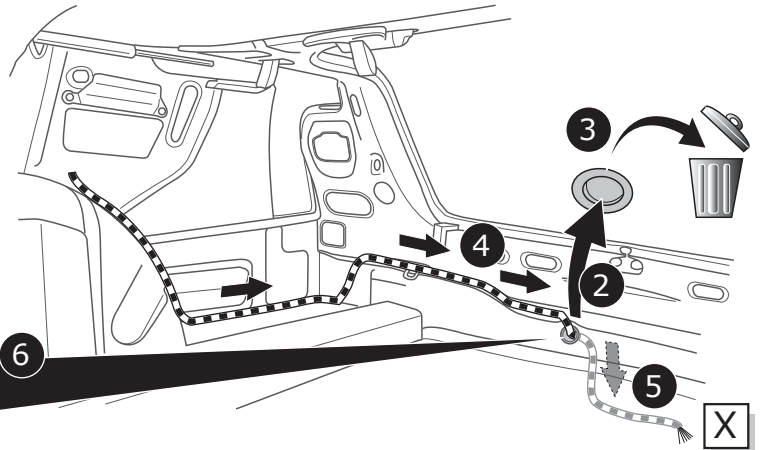
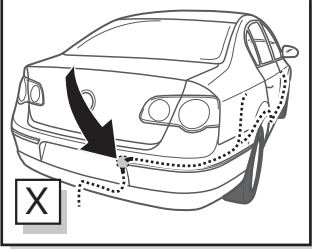
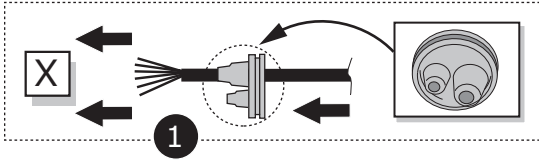

# VARIANT

8

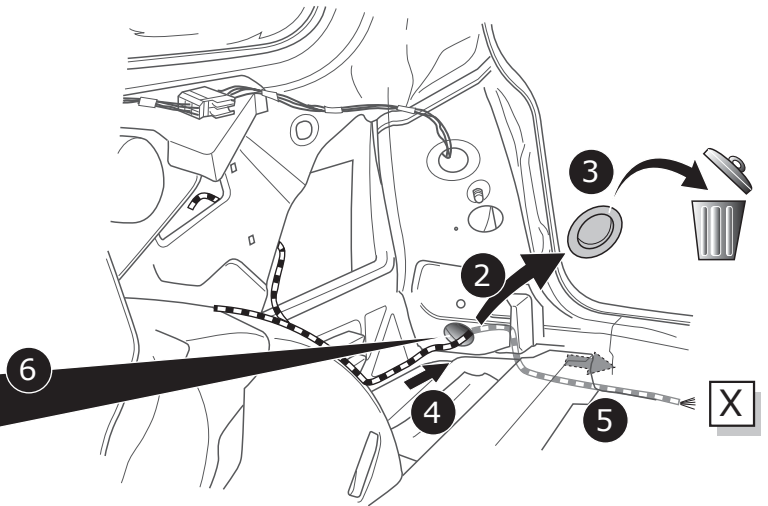
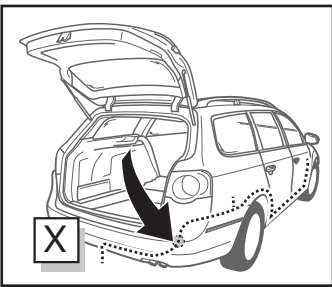
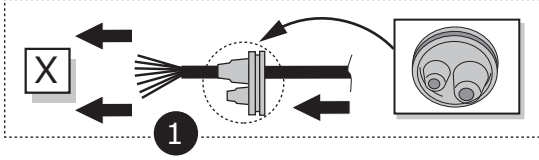

# CC

9

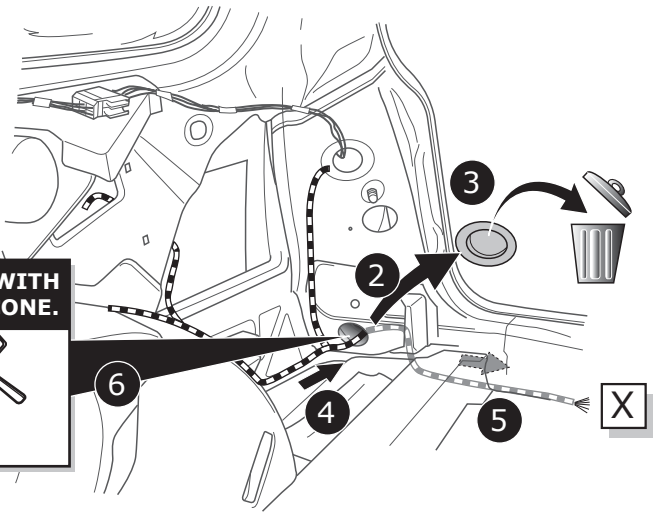
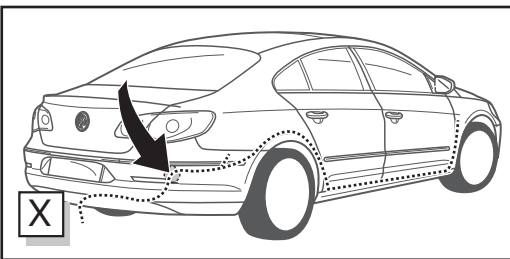
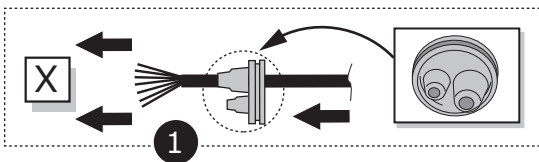

A

Option 1

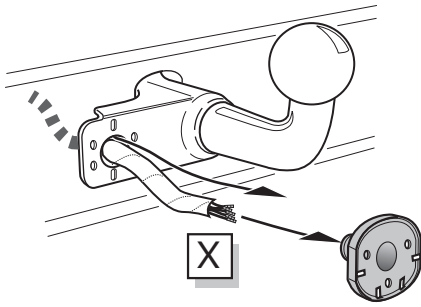

Option 2

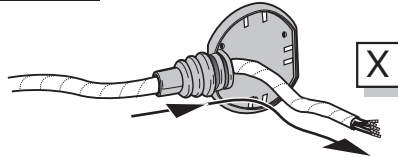

Option 3

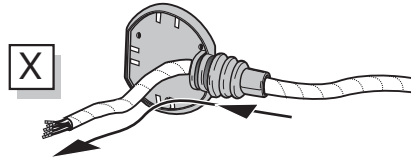

INFO

SOCKET CONNECTION



Page 15

B

Option 1

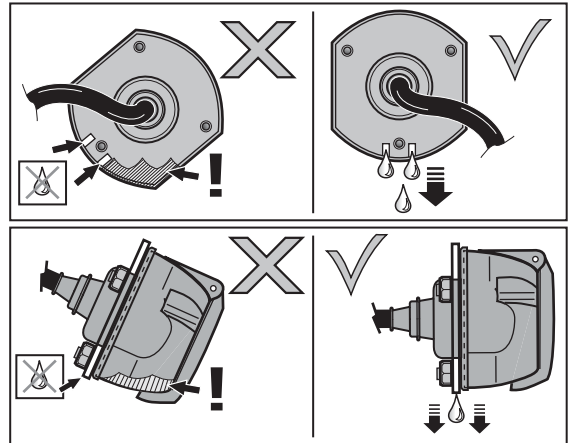
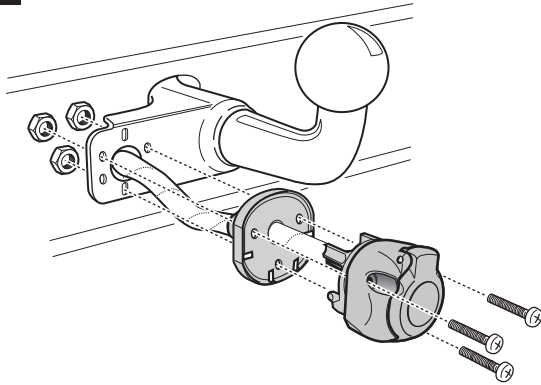

C

Option 2

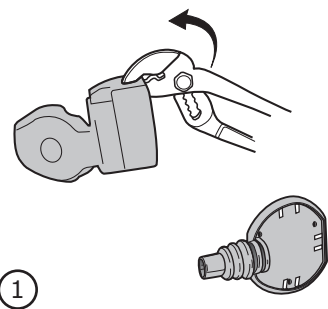

1

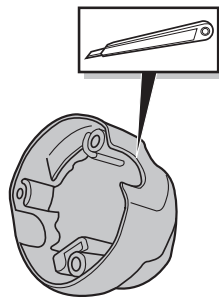

2

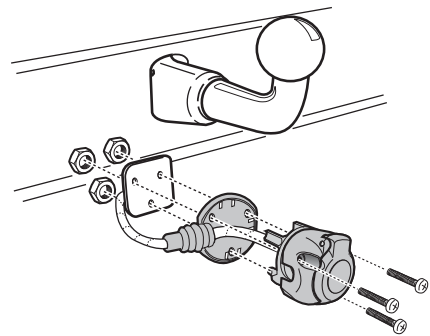

3

D

Option 3

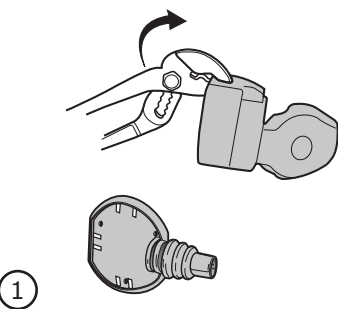

1

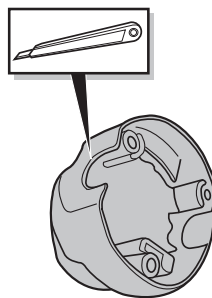

2

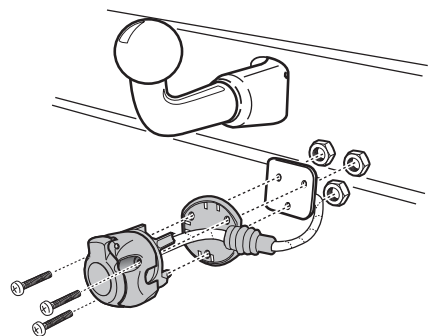

3

SEDAN 2005-2010 / CC

10

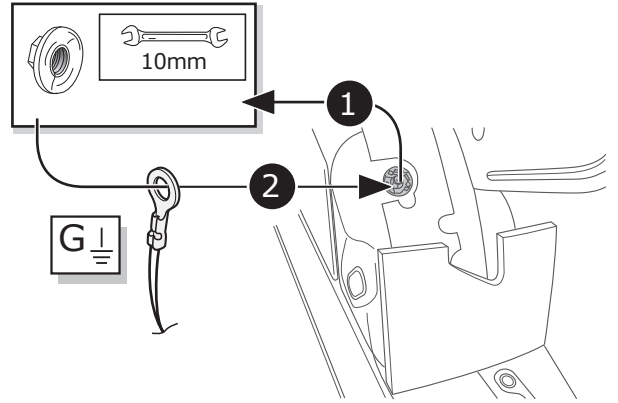
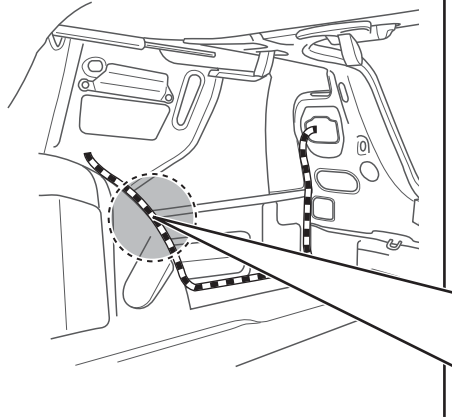
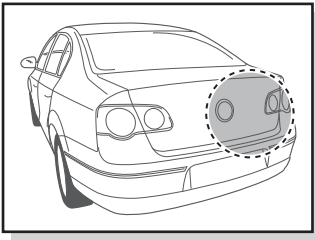

VARIANT / SEDAN 2011->

11

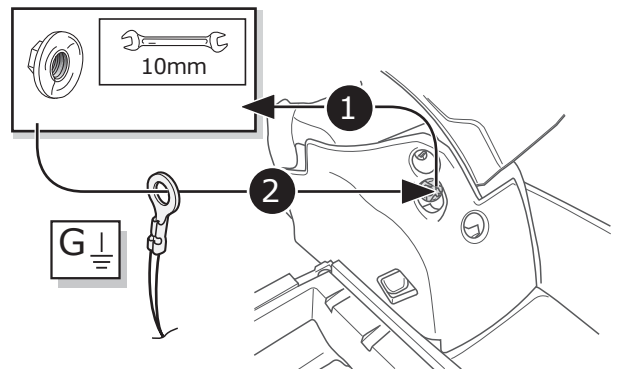
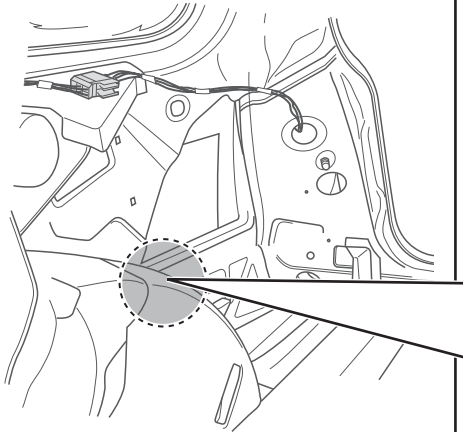
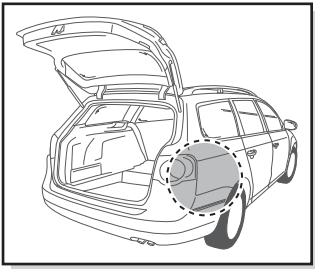

SEDAN / VARIANT / CC

12

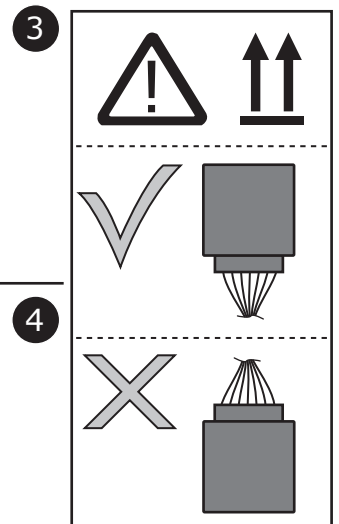
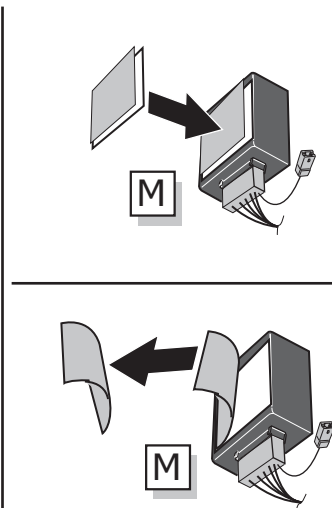
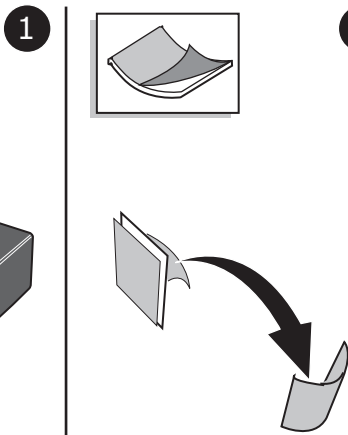
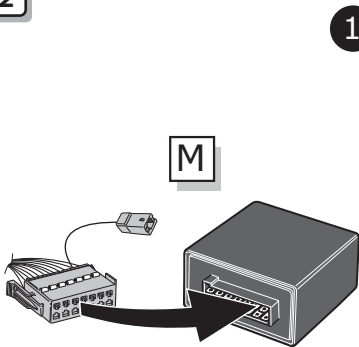



# SEDAN / CC

13

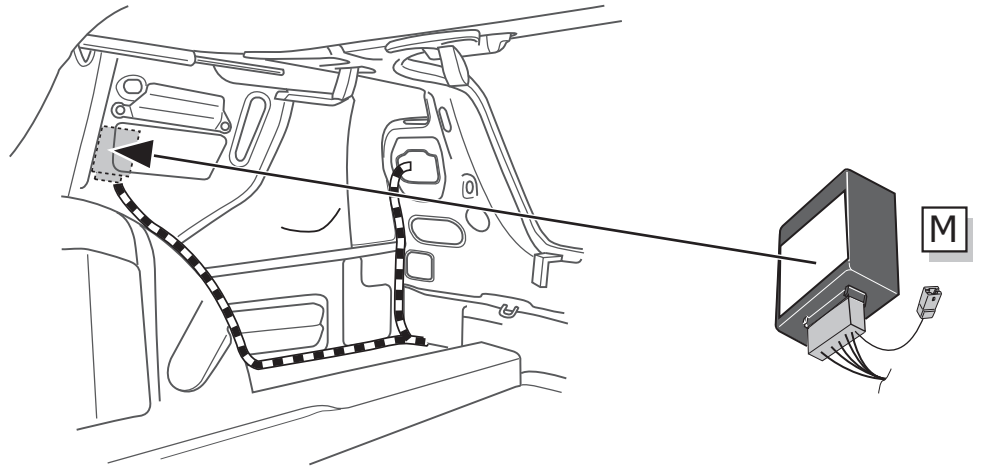
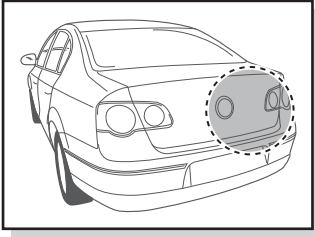

# VARIANT

14

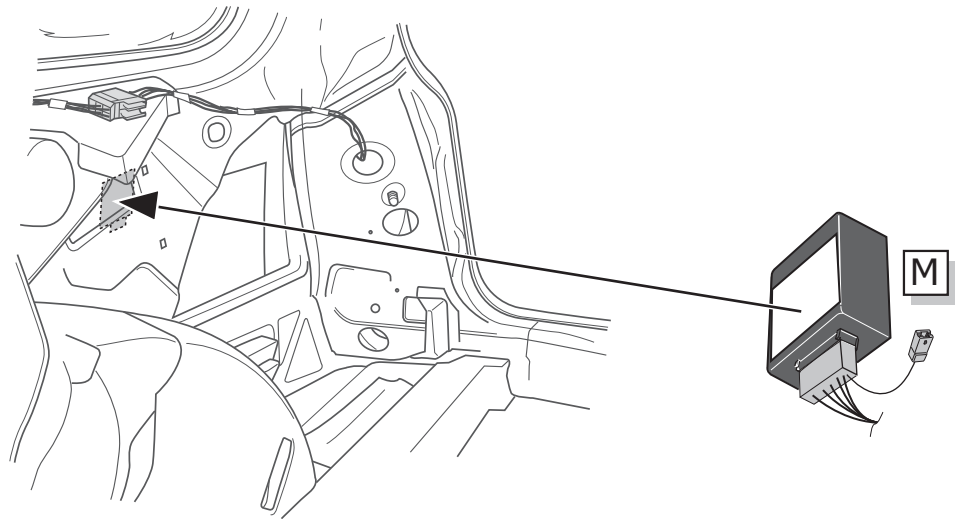
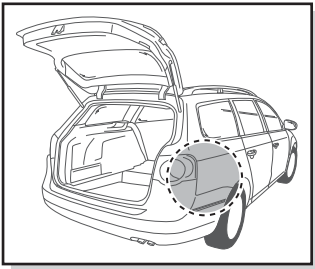

# SEDAN / VARIANT / CC

15

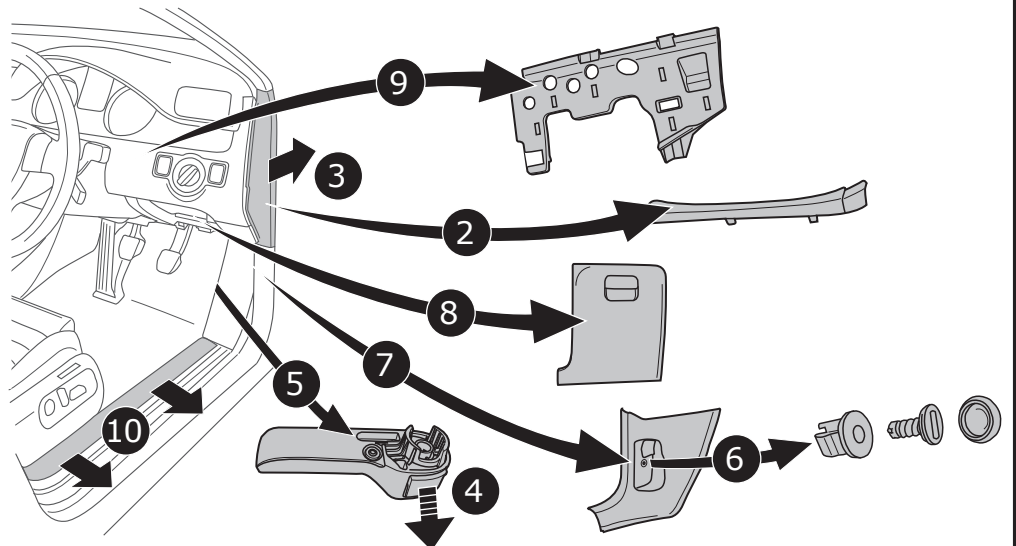
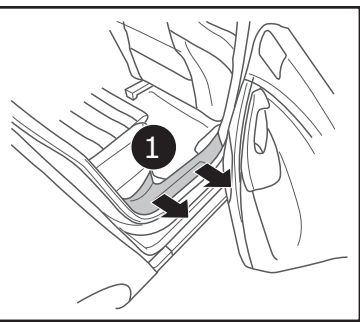

16

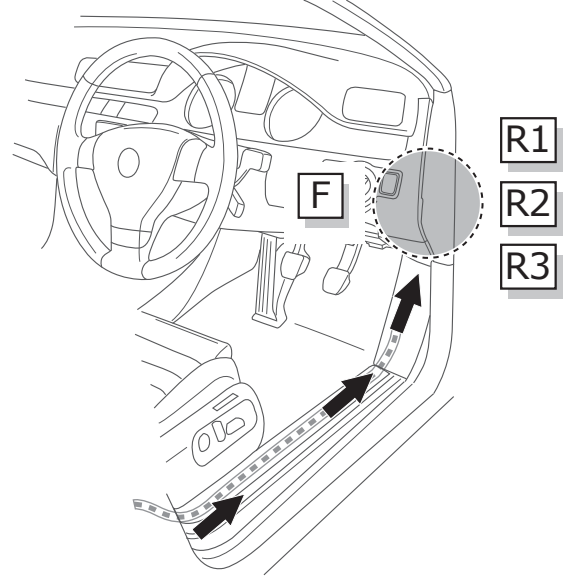
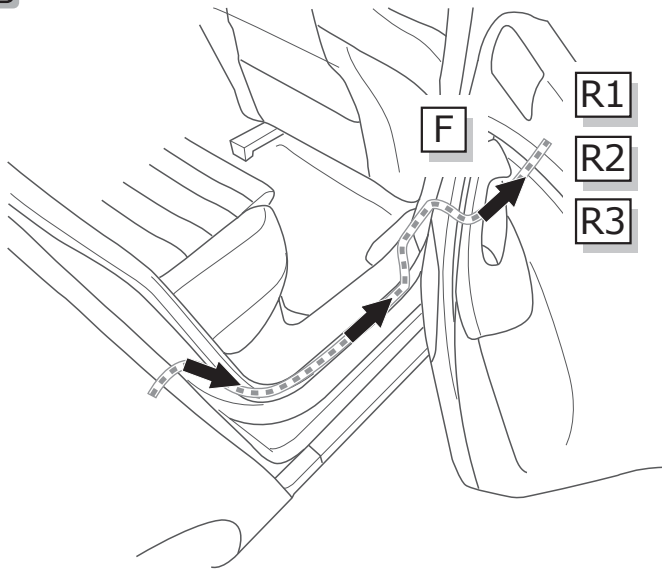

17

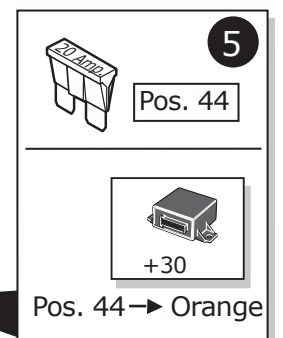
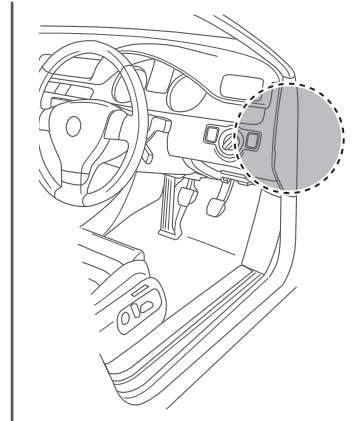
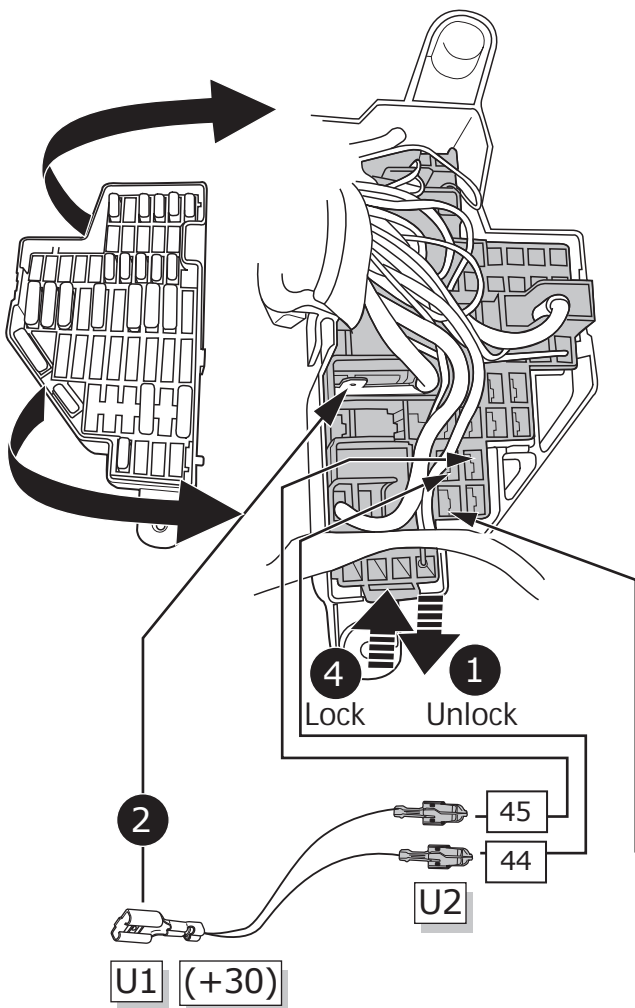

18

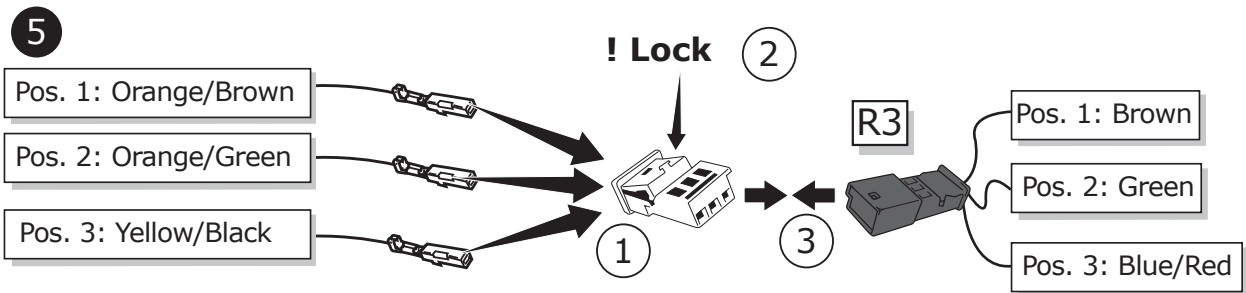
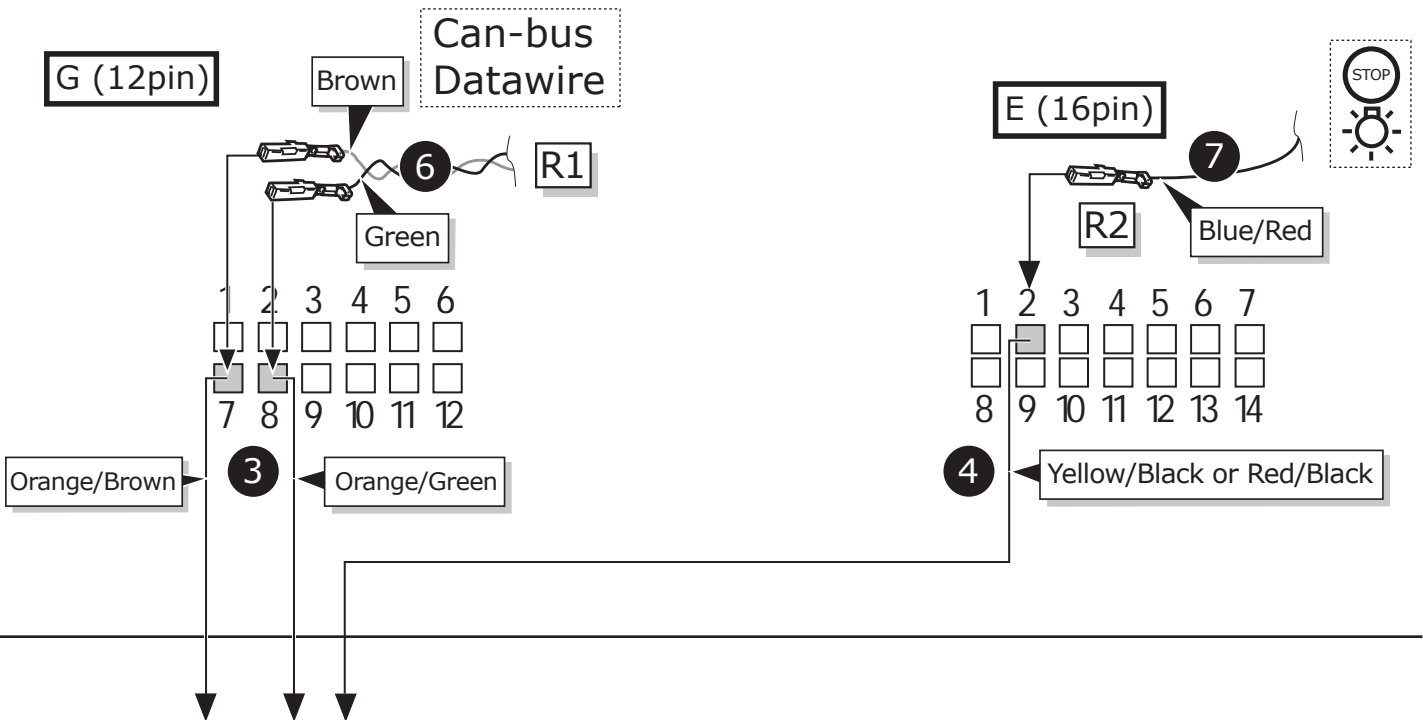
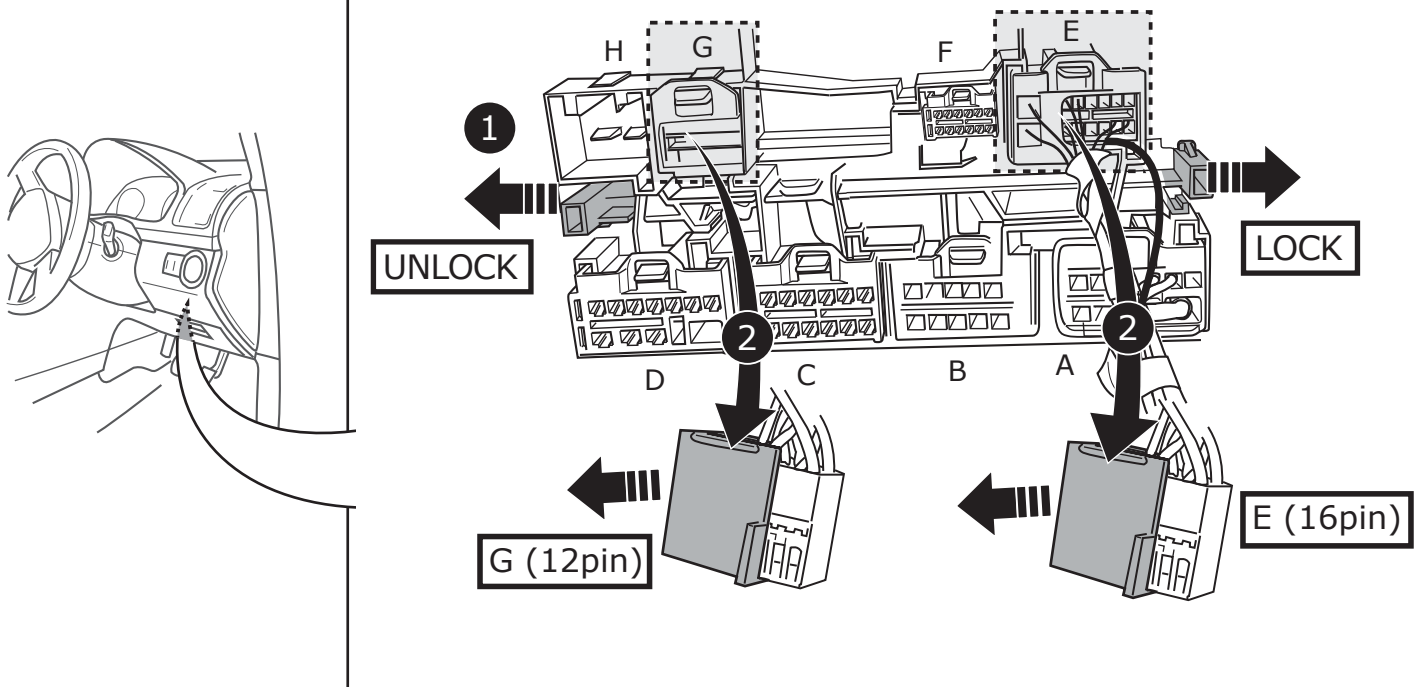

19

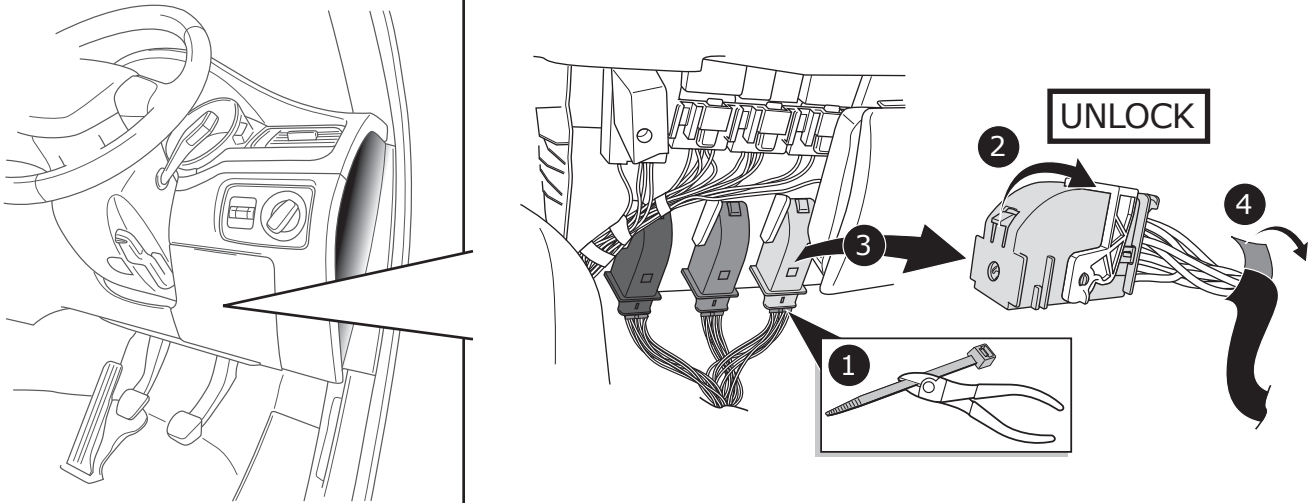

20

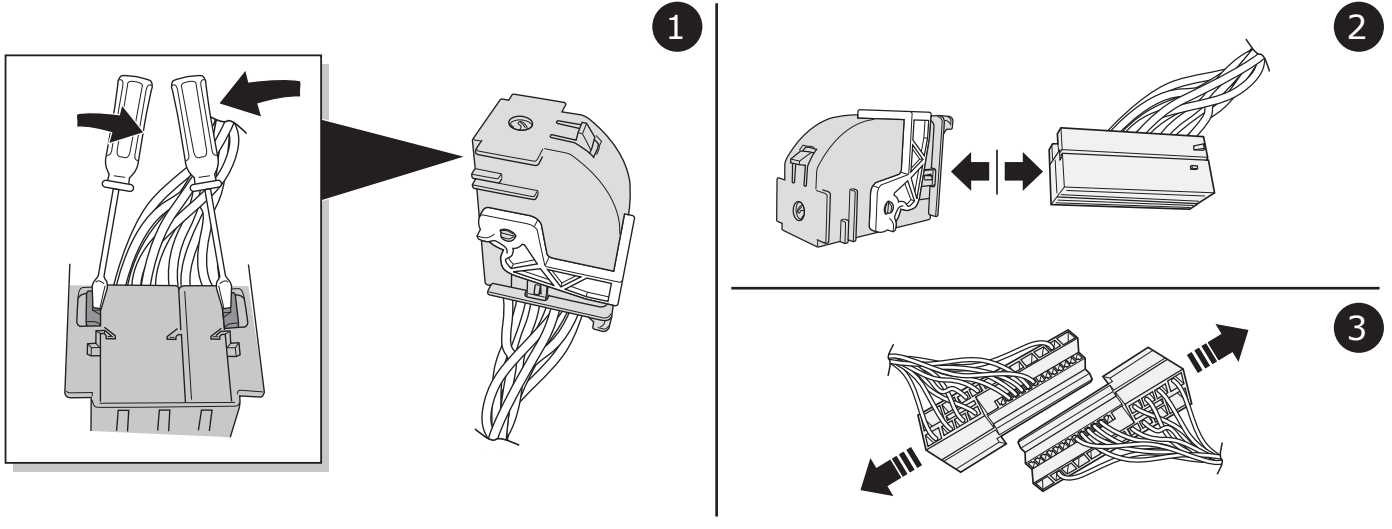

21

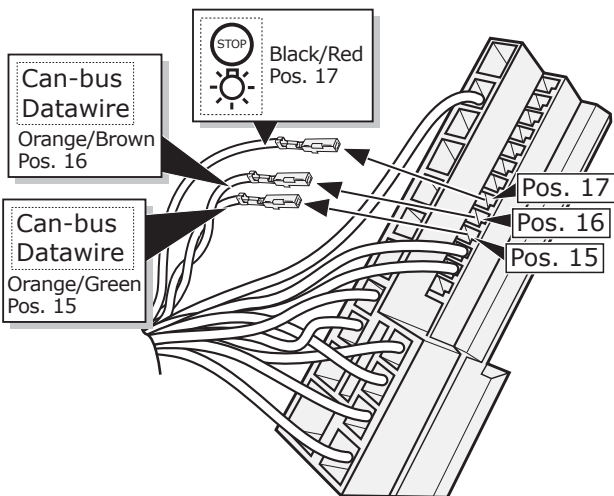

22

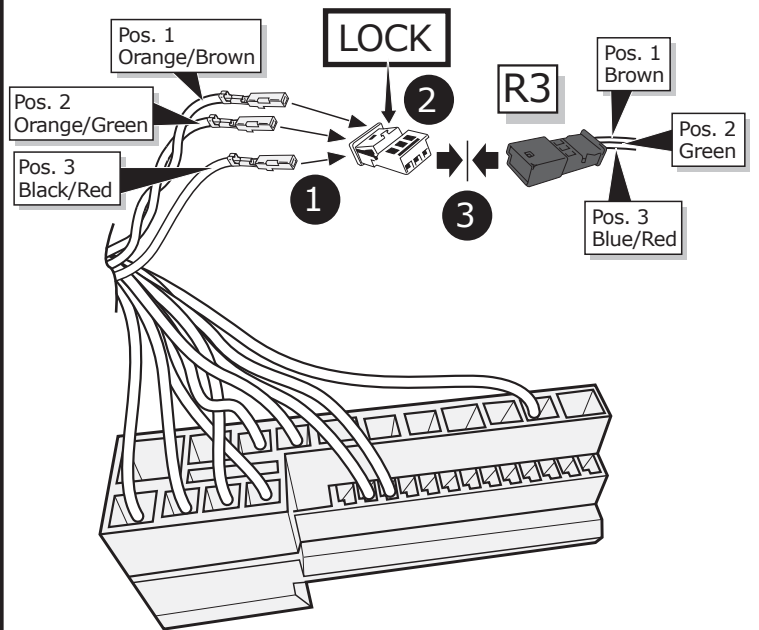

23

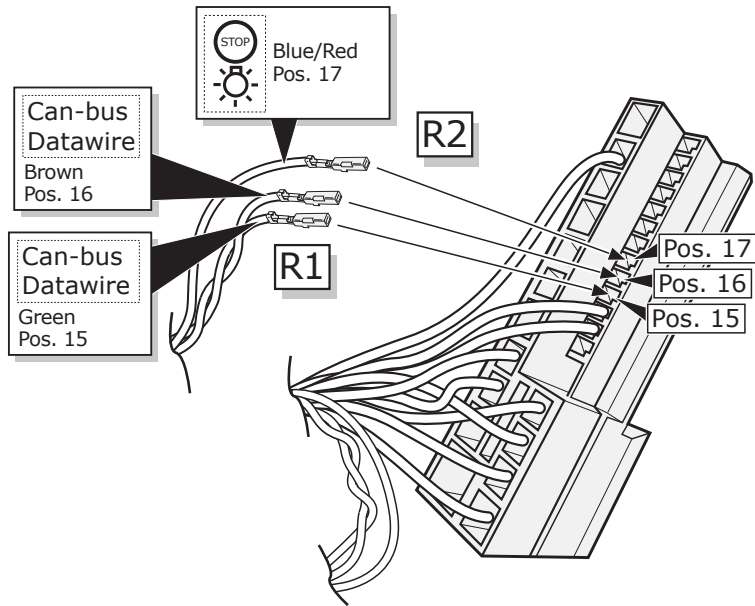

24

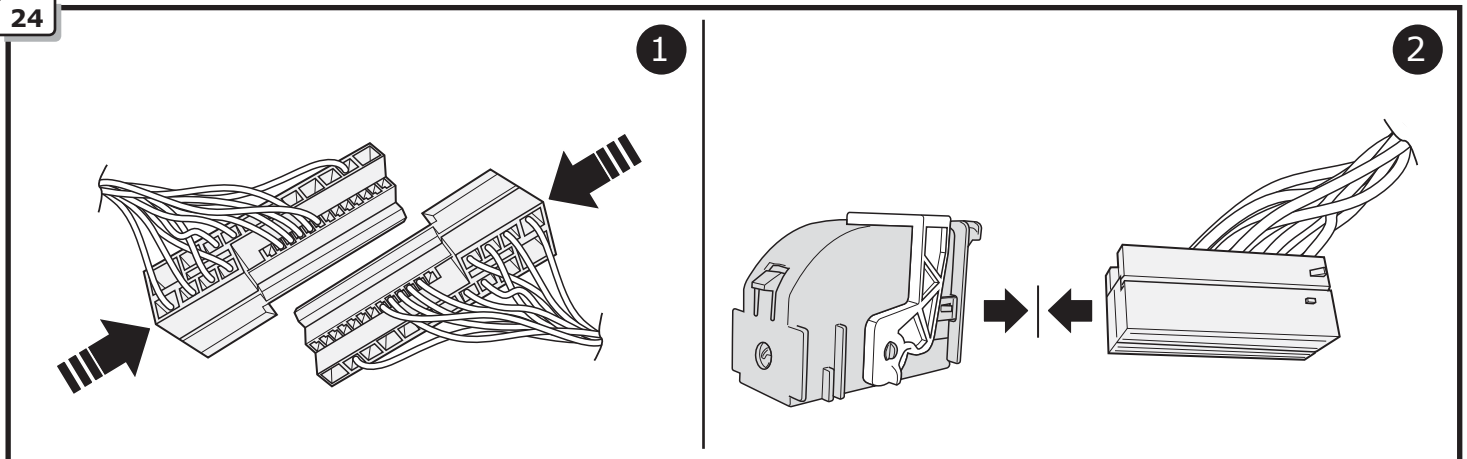

25

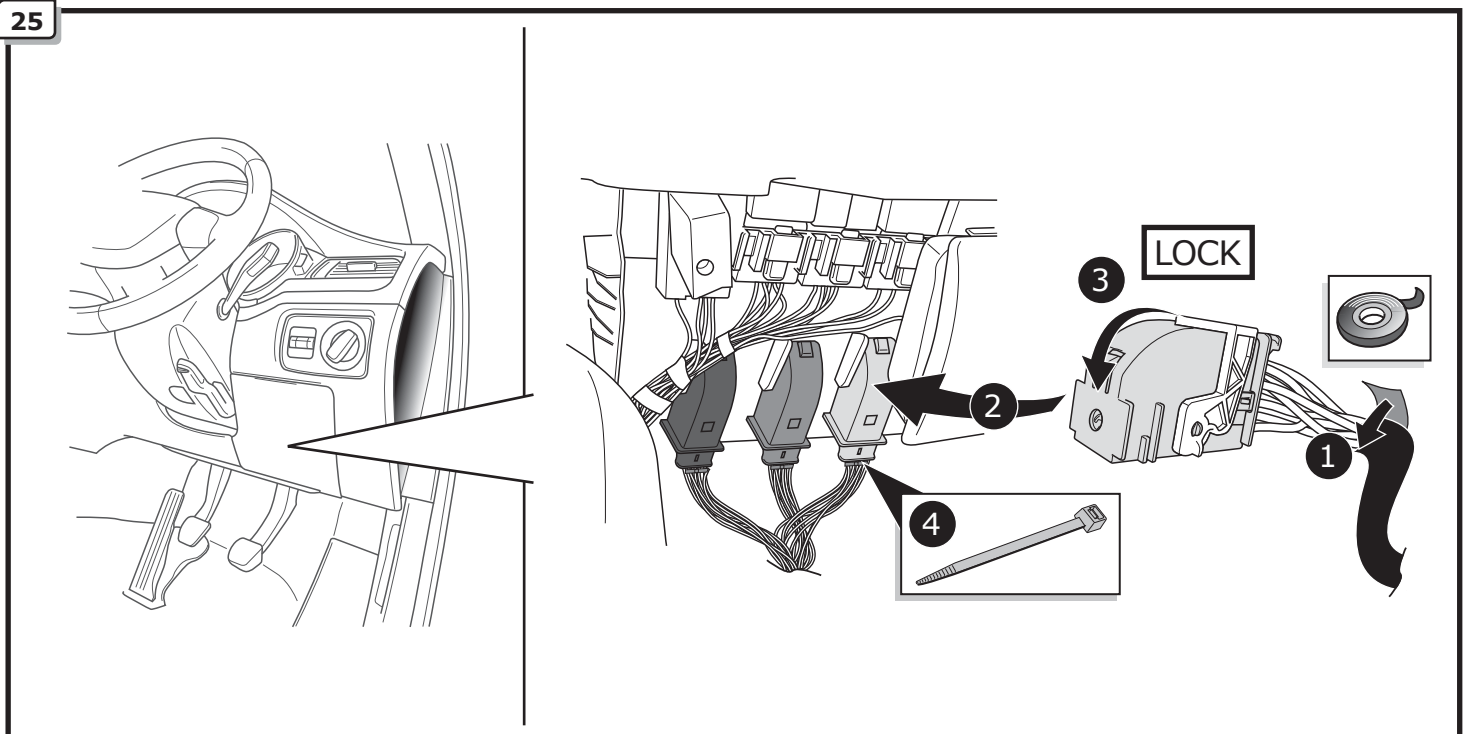

26



A VAG Service Tester must be used to code the vehicle's Gateway with the additional function for the towing hitch at the dealer.

27

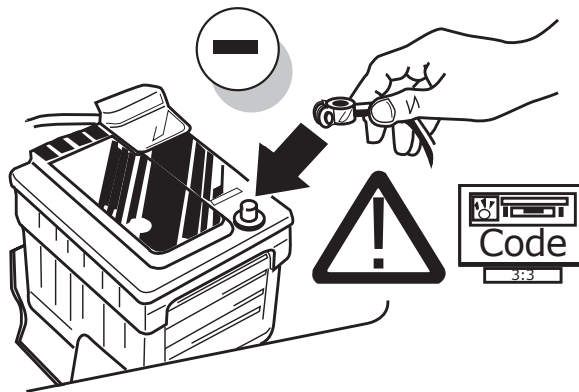

28

**!** WARNING! IT MUST BE ENSURED THAT ALL THE REQUIREMENTS OF THE VEHICLE MANUFACTURER FOR CHANGES TO AND RETRO-FITTING ON THE VEHICLE AND/OR COOLING SYSTEM FOR THE OPERATION WITH A TRAILER ARE CARRIED OUT.

■ SUBJECT TO CHANGE.

29

**!** TEST ALL THE CIRCUITS WITH A TEST DEVICE WITH THE CORRECT POWER LOAD FOR EACH FUNCTION. A TEST DEVICE WITH LED'S CANNOT BE USED FOR THIS PURPOSE.

**INFO**

REINSTALL TRIM.

**30**

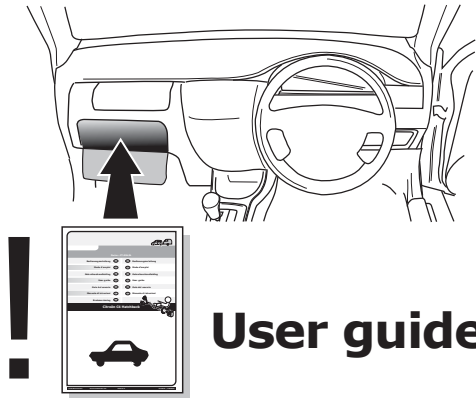

**INFO**

SOCKET CONNECTION

DIN/ISO 1724			1-7				
	1/L	2	3/31	4/R	5/58-R	6/54	7/58-L
Pmax	21W	21W		21W	42W	3x21W	42W
Colour	Black/White	Blue	Brown	Black/Green	Grey/Red	Black/Red	Grey/Black

# Reverse signal preparation

A

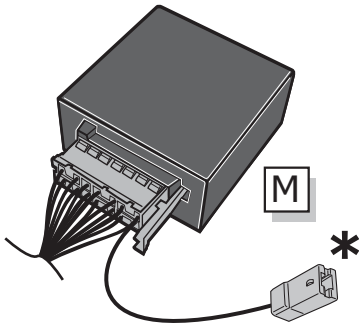

1

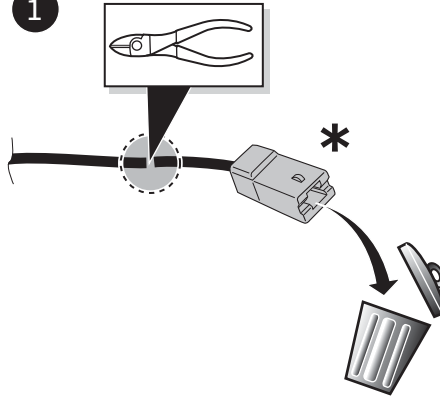

2

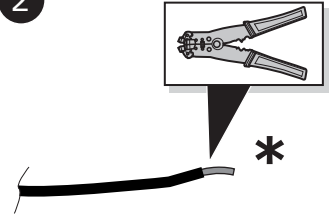

B

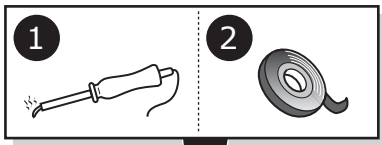

⚠ MAX = 21W

