

VW Golf VII 5G Limo 10/2012 - 04/2014
VW Golf VII 5G Variant 08/2013 - 04/2014

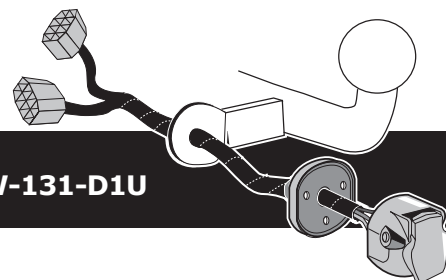

Only for models with towbar preparation

Partnr.: VW-131-D1U

- Fitting instructions electric wiring kit tow bar with 13-P socket up to DIN/ISO Norm 11446.
- We would expressly point out that assembly not carried out properly by a competent installer will result in cancellation of any right to damage compensation, in particular those arising by virtue of the product liability act.
- Contents of these kits and their fitting manuals are subject to alteration without notice, please ensure that these instructions are read and fully understood before commencing installation.
- Do not overload circuits; the maximum loads per connection are detailed in this manual.
- Attention! Before Installation, please read this manual carefully and inform your customer to consult the vehicle owners manual to check for any vehicle modifications required before towing.
- In the event of functional problems, troubleshooting must be limited to about 0.5 hours, contact the technical support:
ukts@ecs-electronics.com / 07440 202 052.



Part list

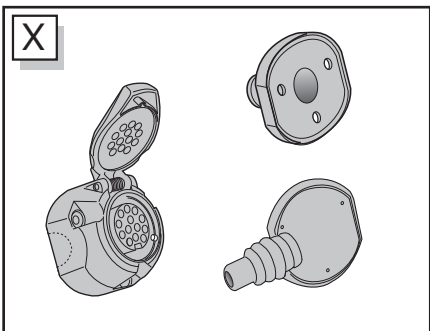
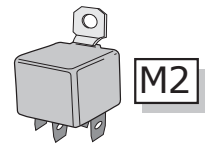
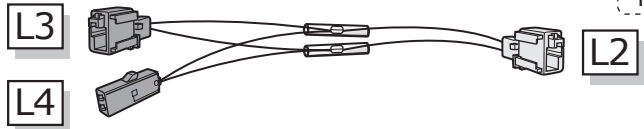
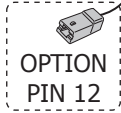
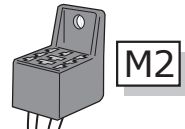
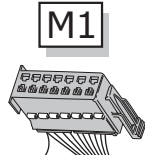
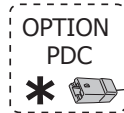
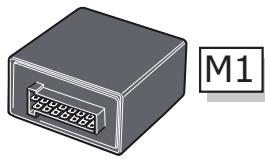
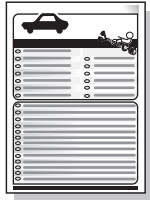
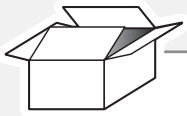

Option P.D.C. *

PARK DISTANCE CONTROL

↓

PARK DISTANCE CONTROL

For not OEM P.D.C. System use the: VW-083-ZZ

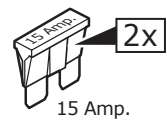
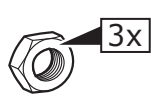
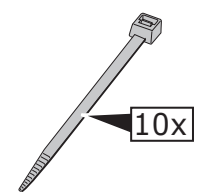
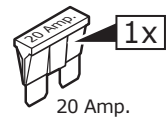
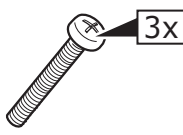
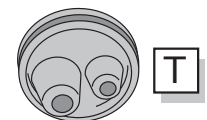

1

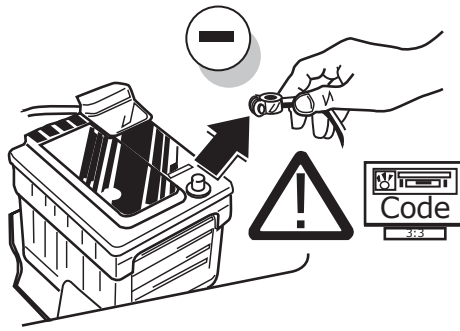

ROUTING

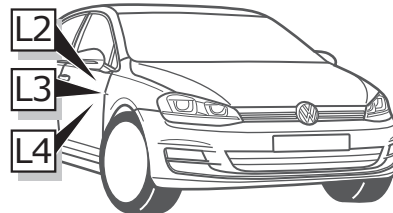
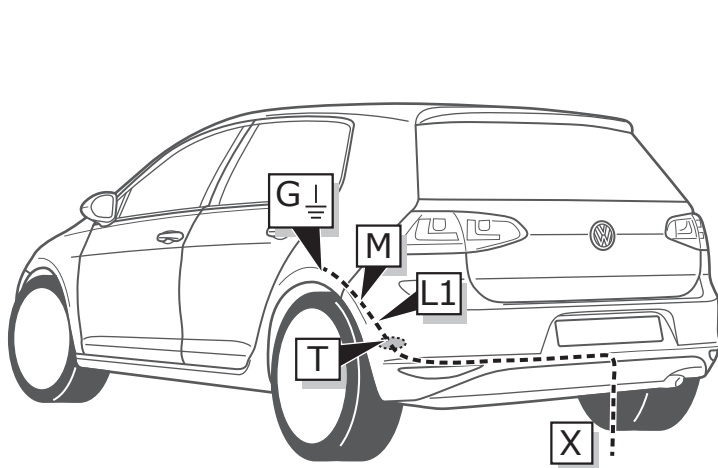

VW Golf VII 5G Limo



Page 3	→	2	-	11
Page 10	→	21	-	28

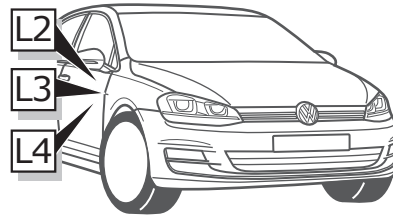
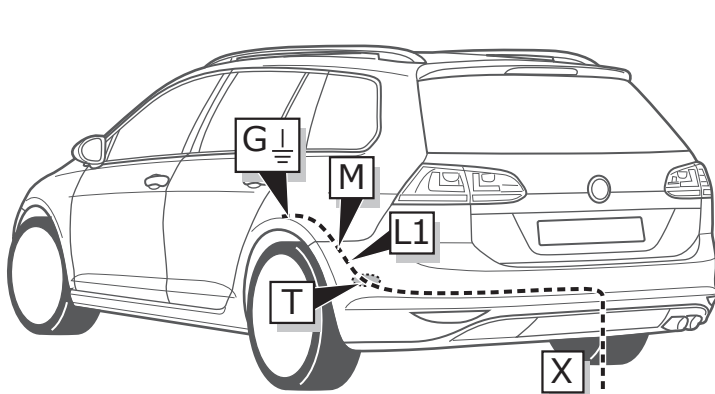

VW Golf VII 5G Variant



Page 7	→	12	-	28
--------	---	----	---	----

2

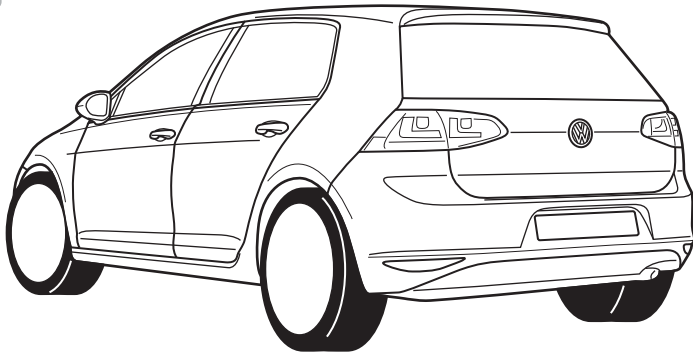

VW Golf VII 5G Limo



Page 3	→	2	-	11
Page 10	→	21	-	28

3

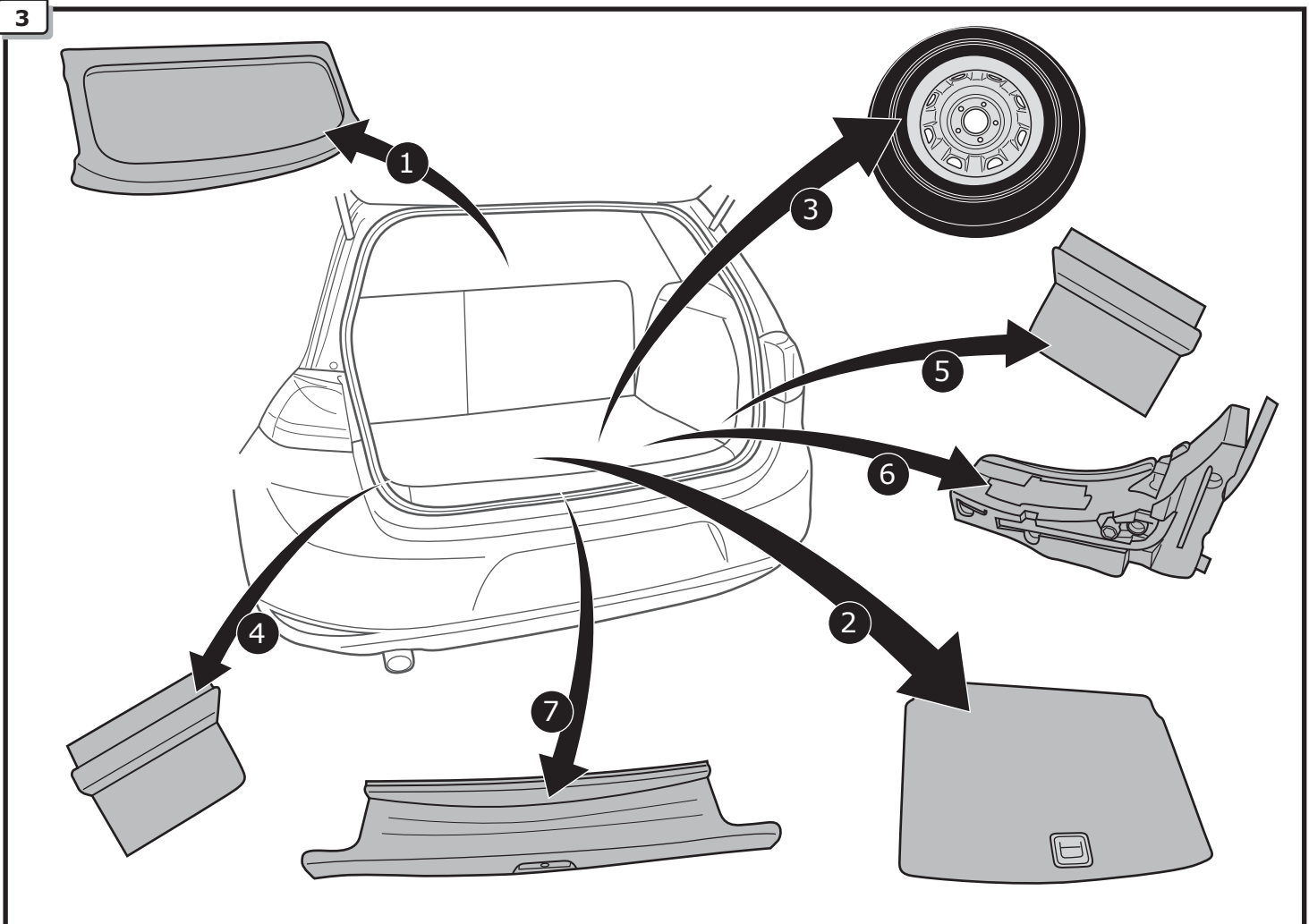

4

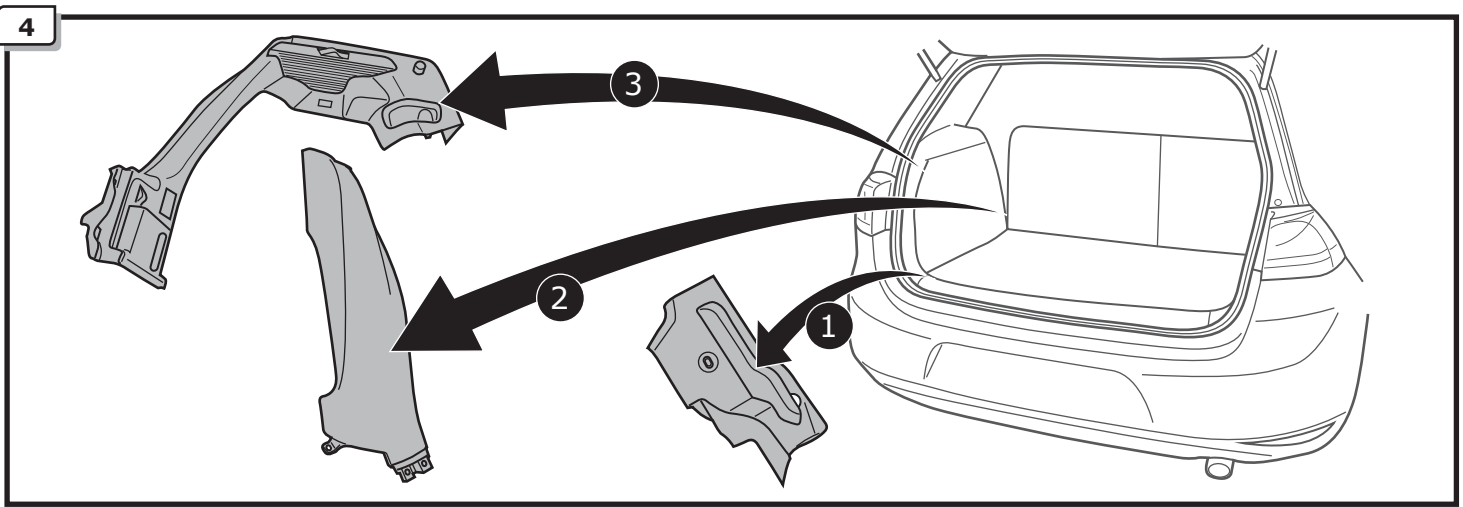

5

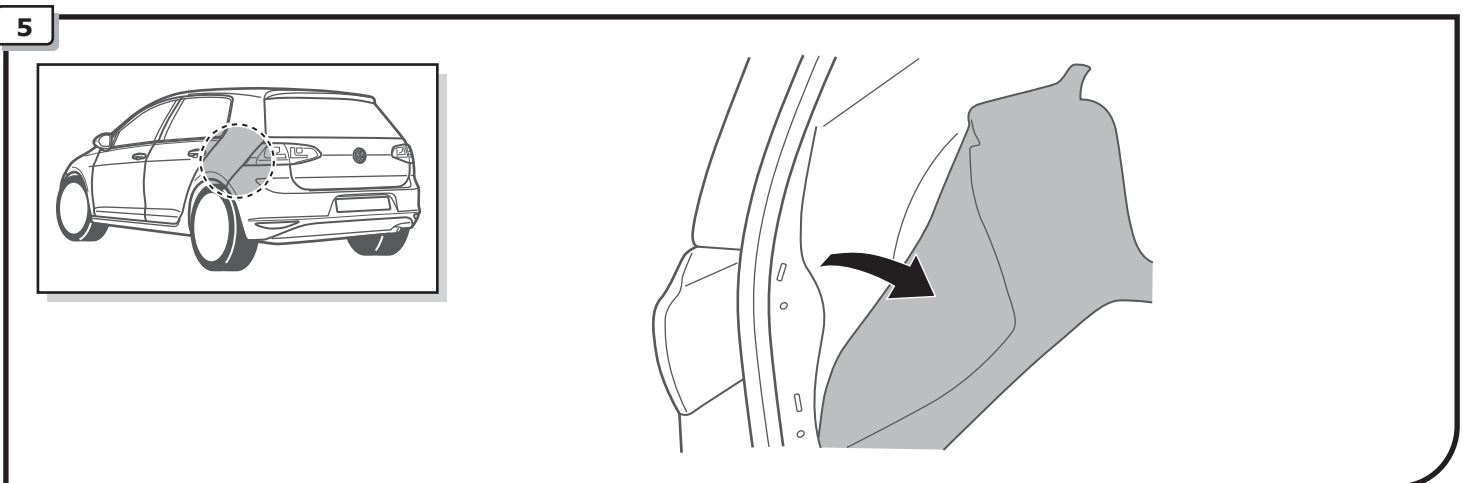

6

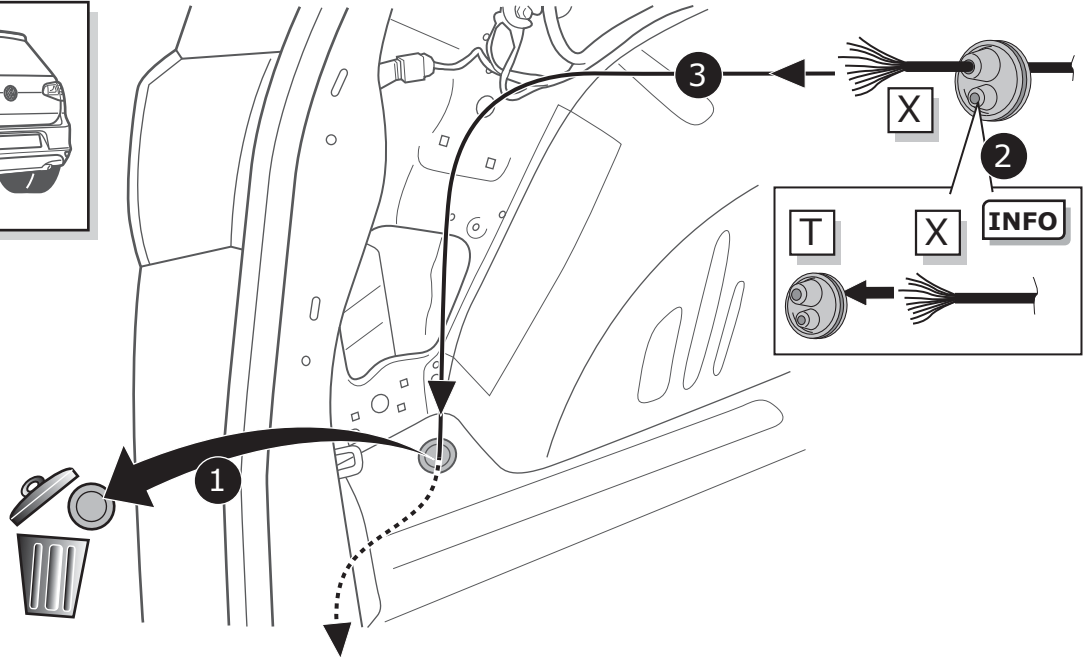
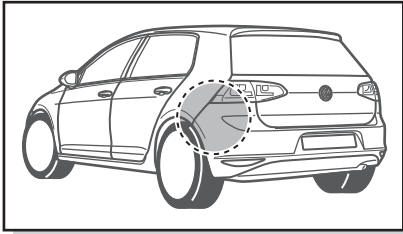

7

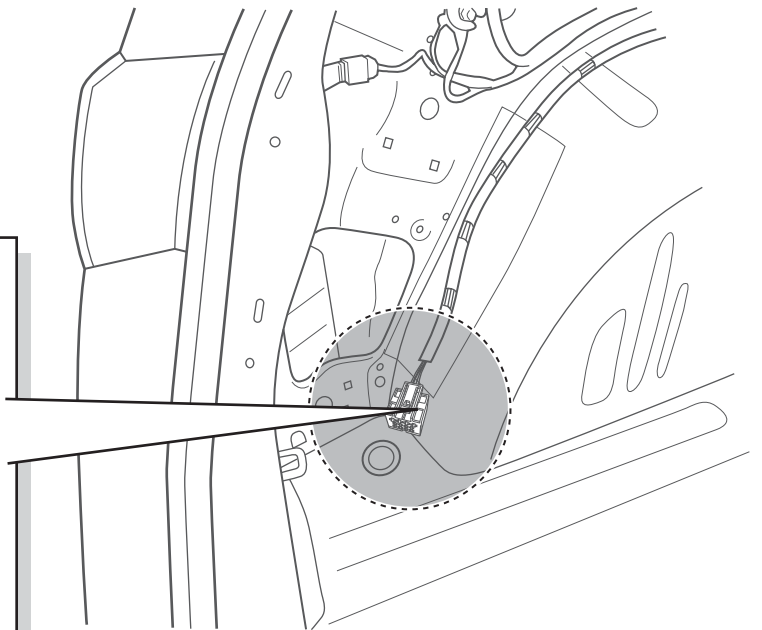
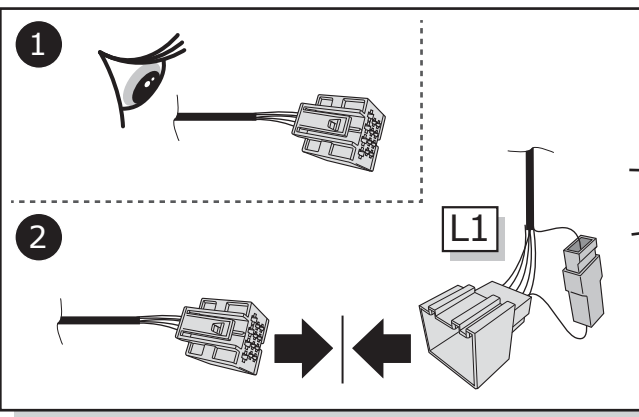
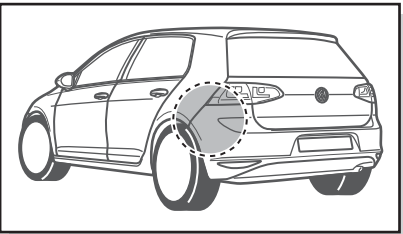

8

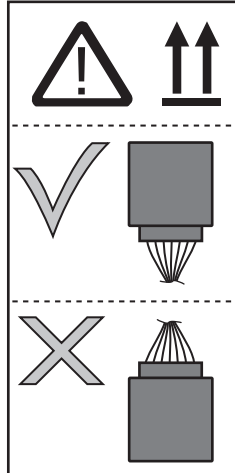
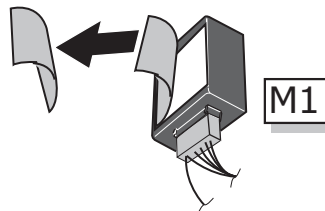
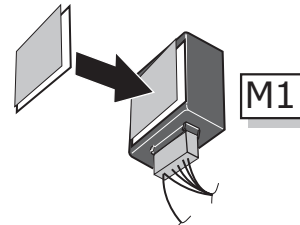
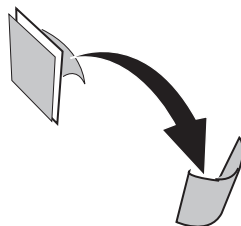
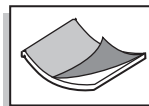
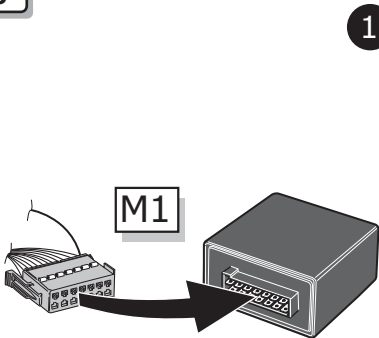

9

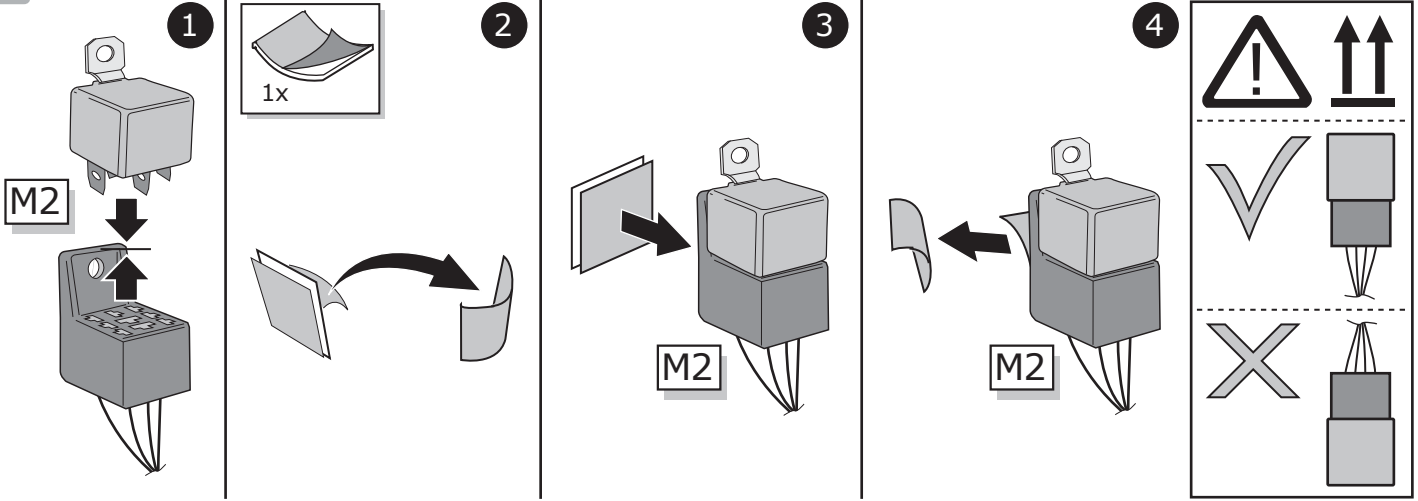

10

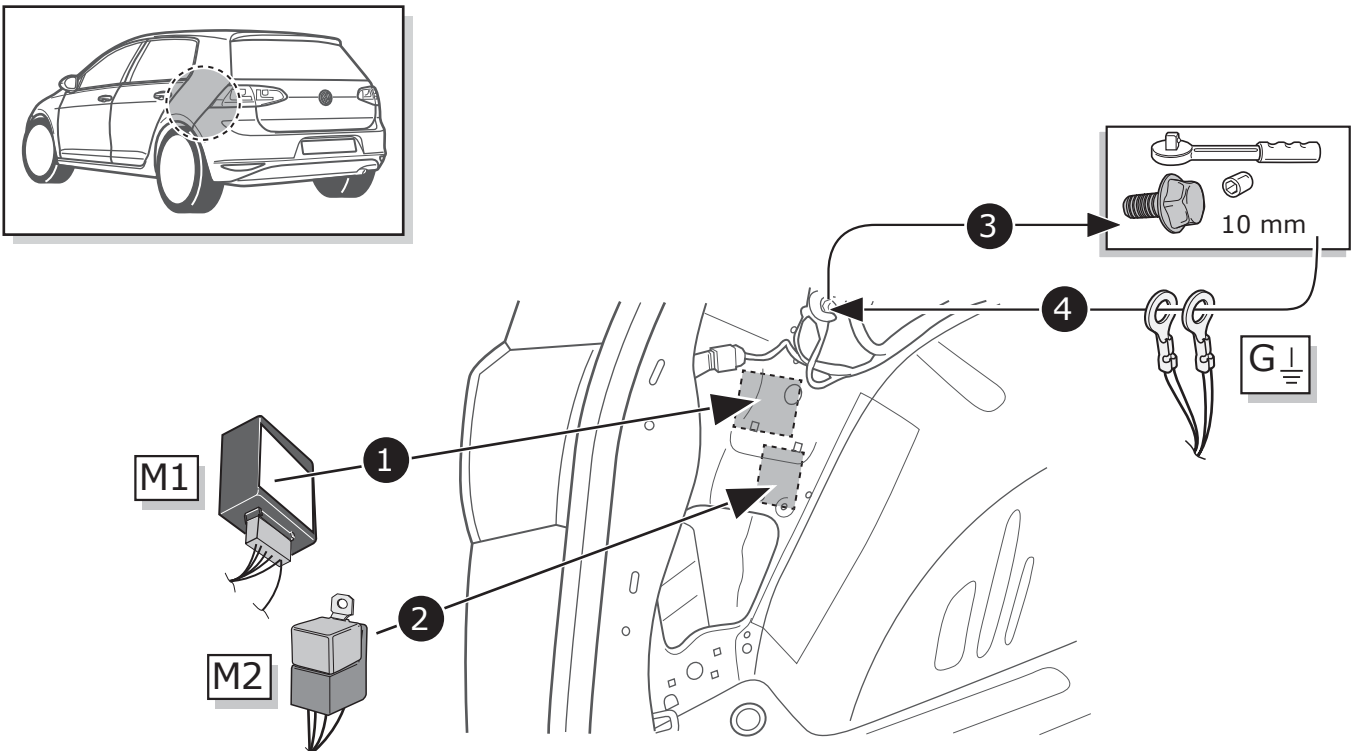

11



12

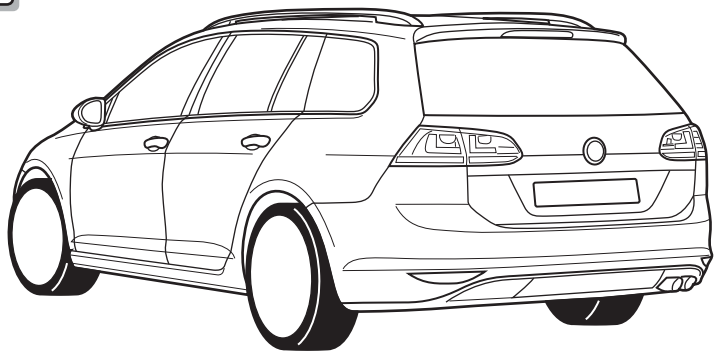

VW Golf VII 5G Variant

Page 7 → 12 - 28

13

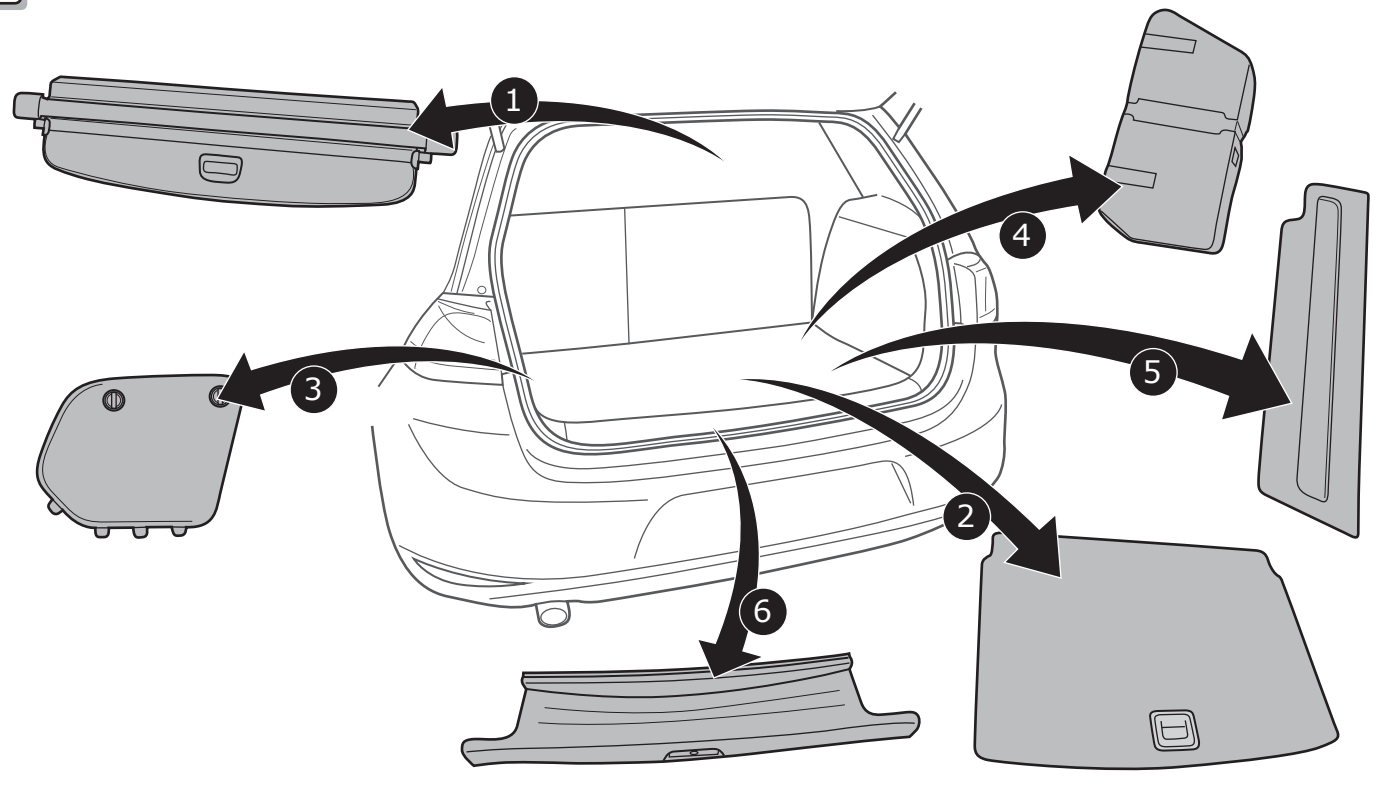

14

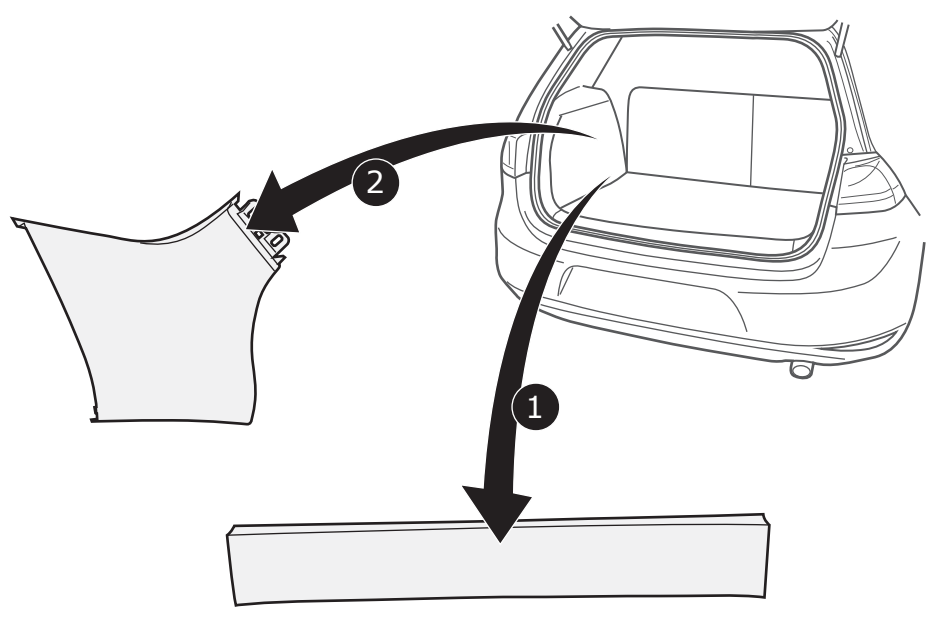

15

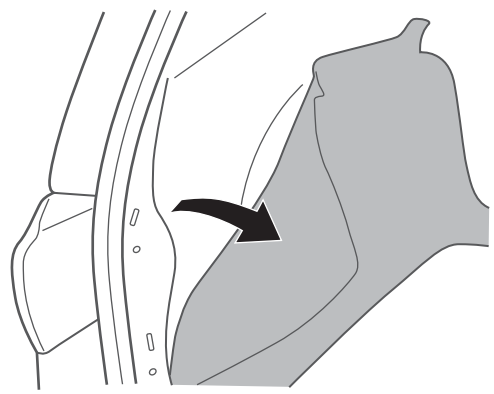
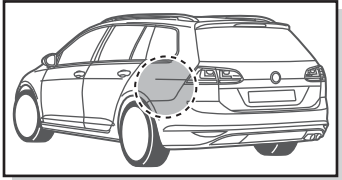

16

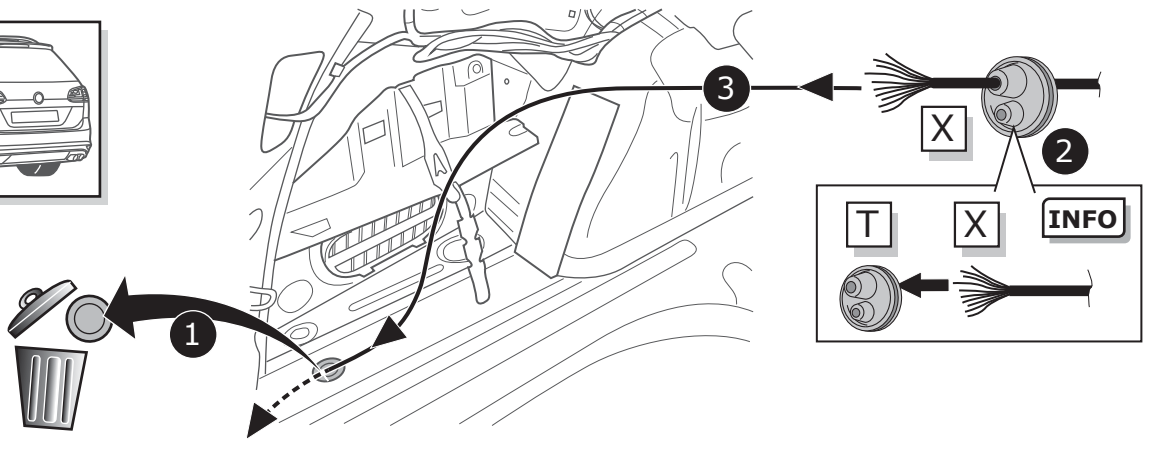
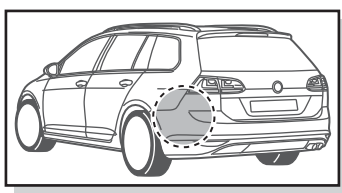

17

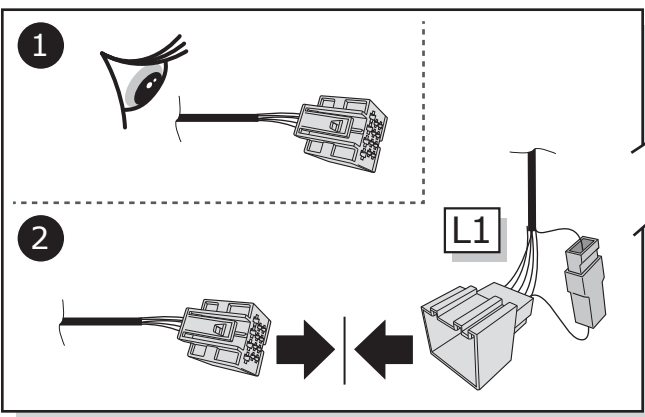
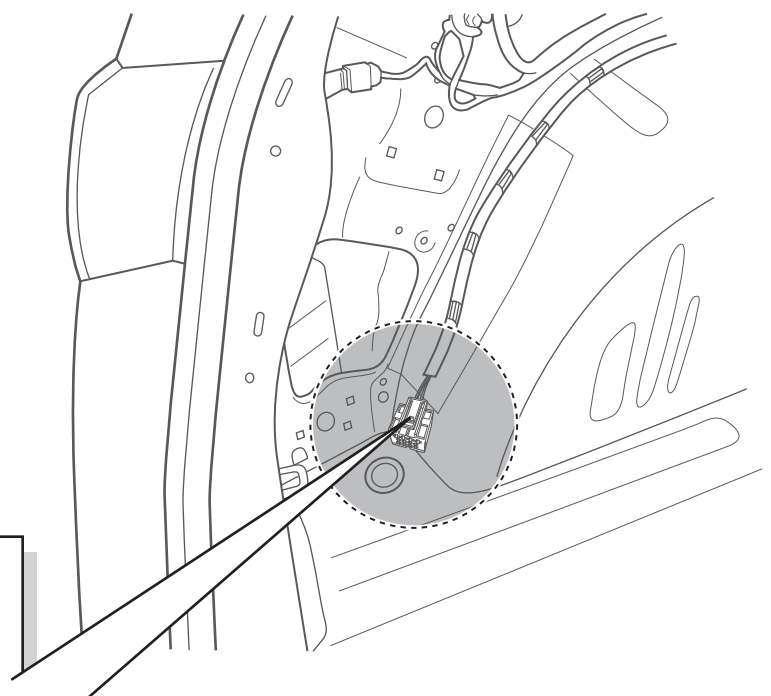
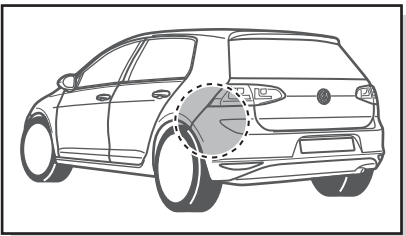

18

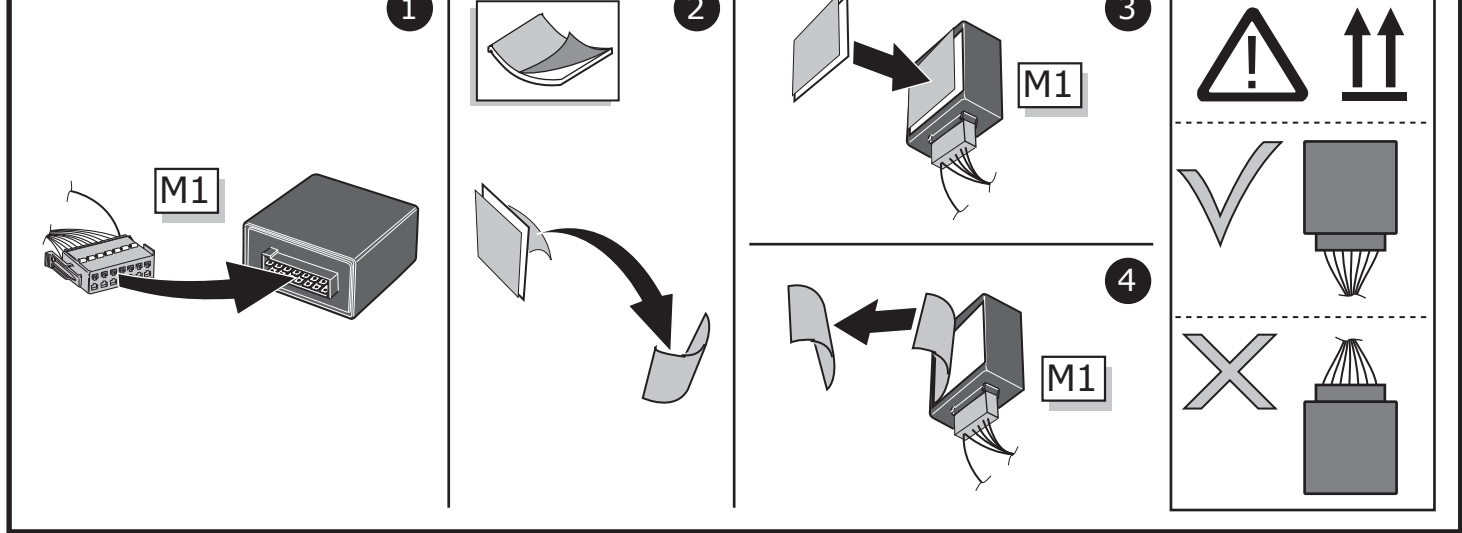

19

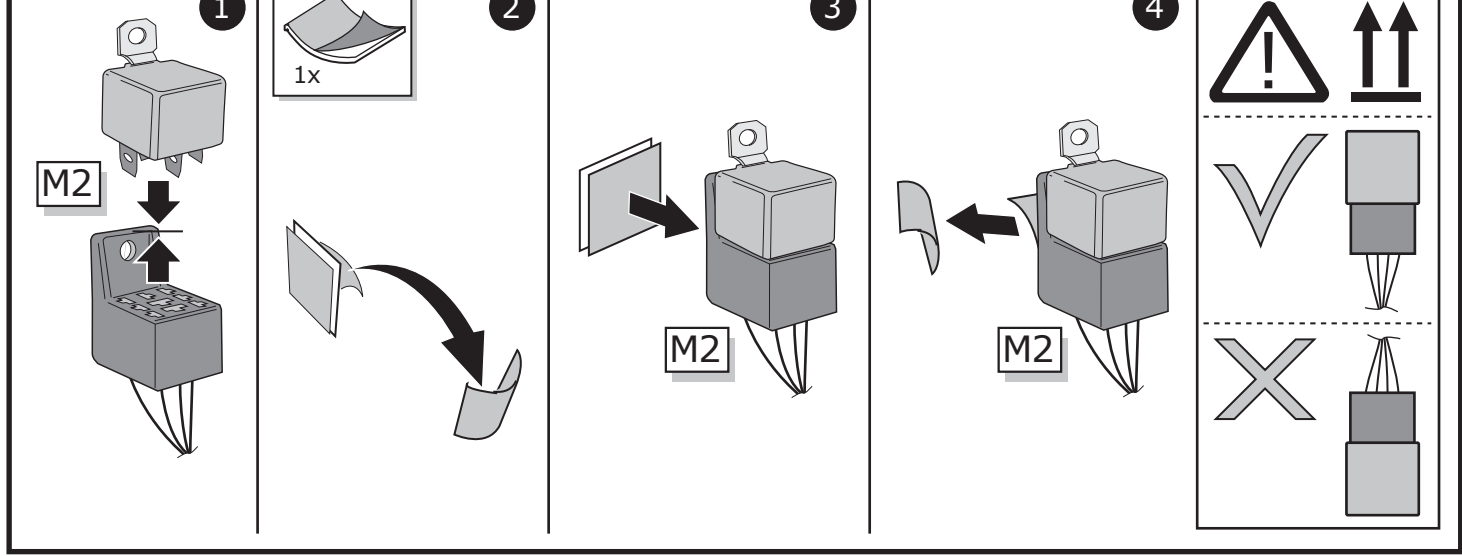

20

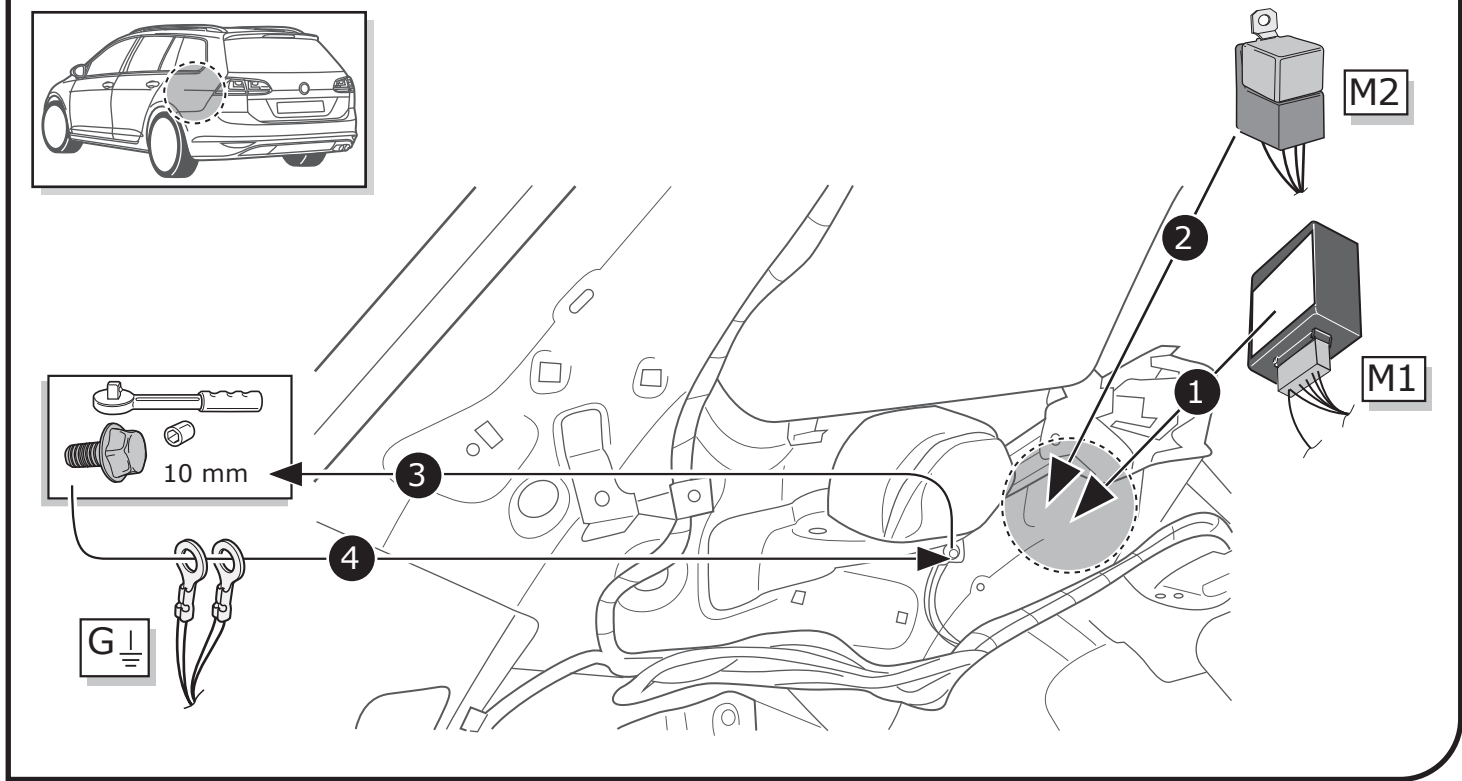

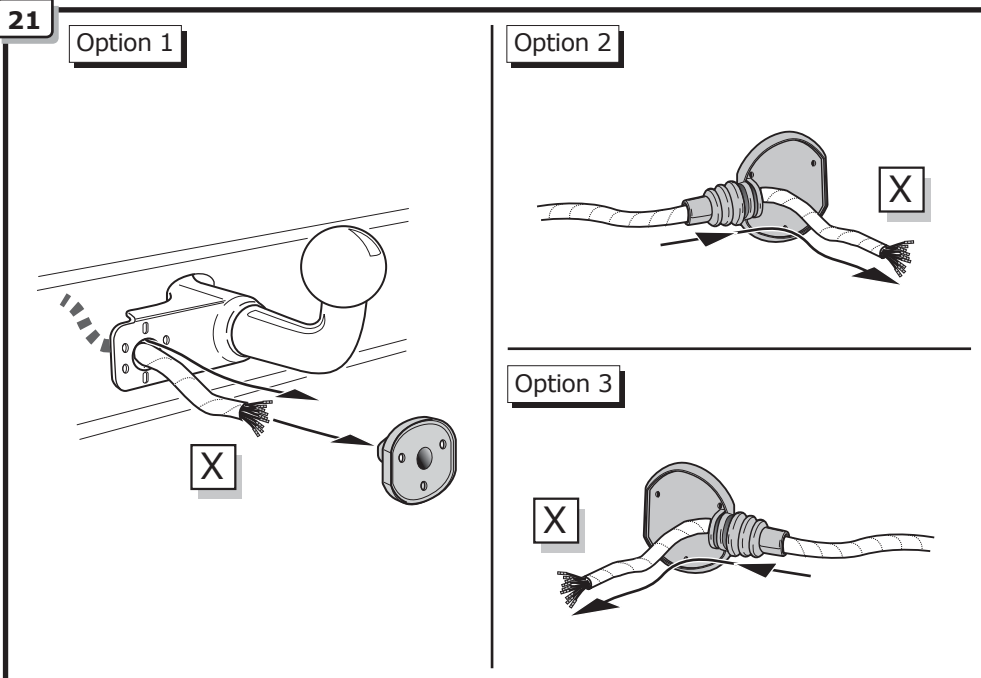

INFO

SOCKET CONNECTION

Page 13

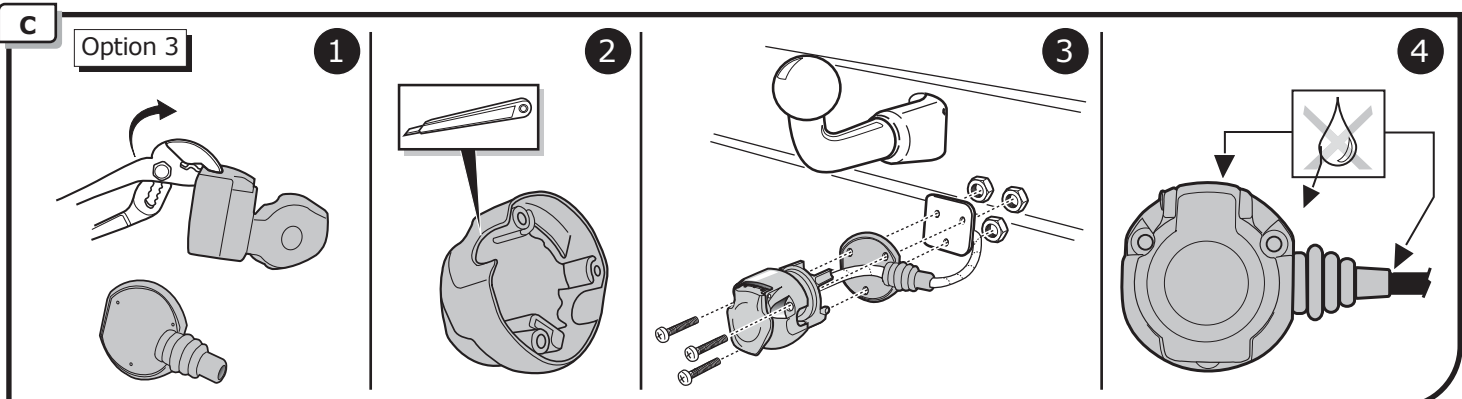
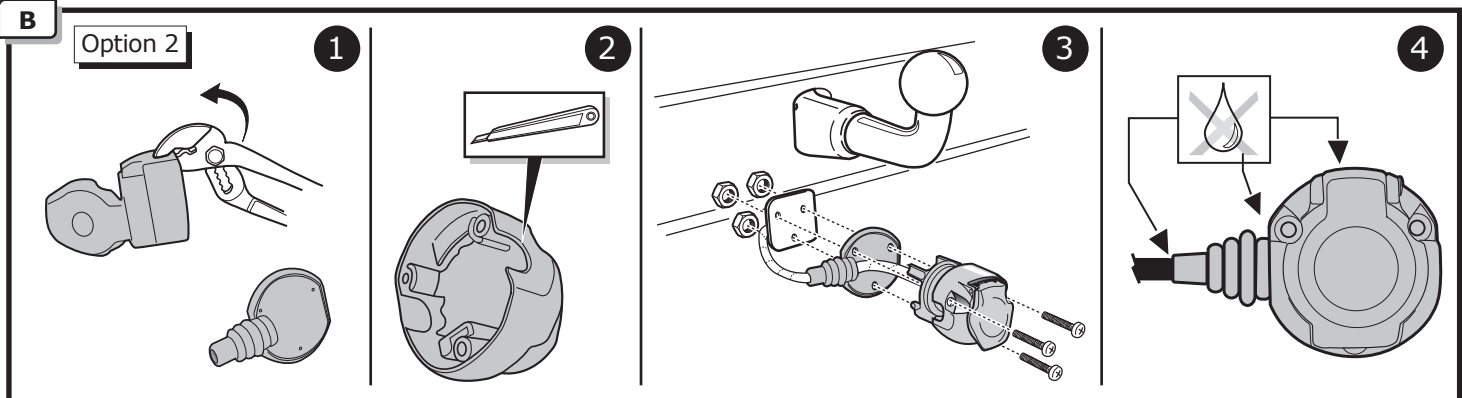
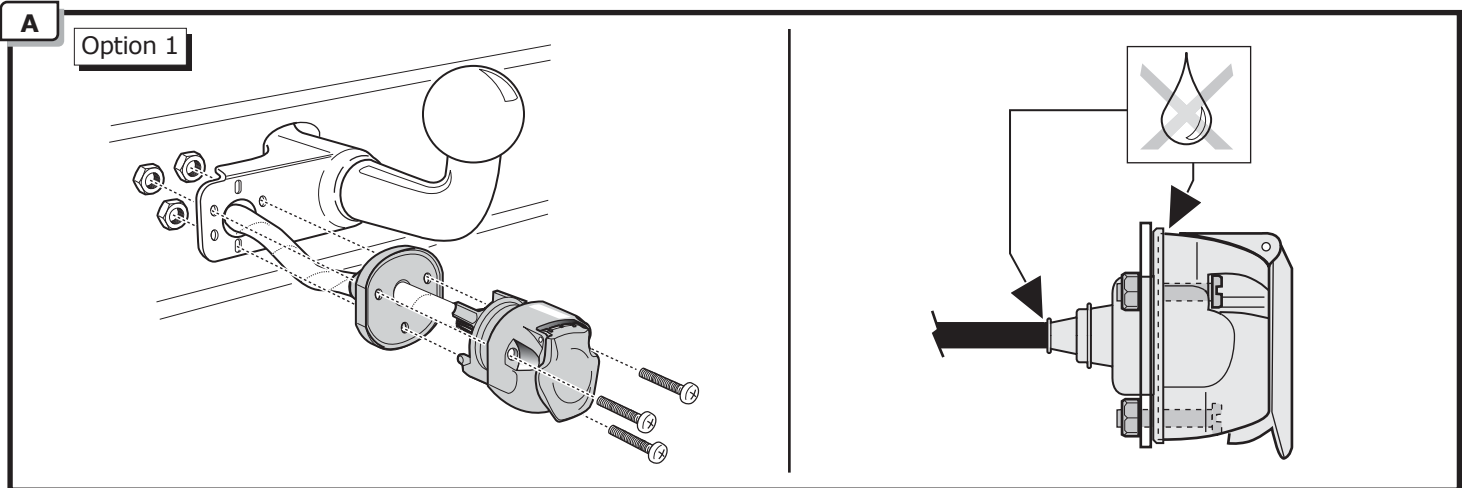

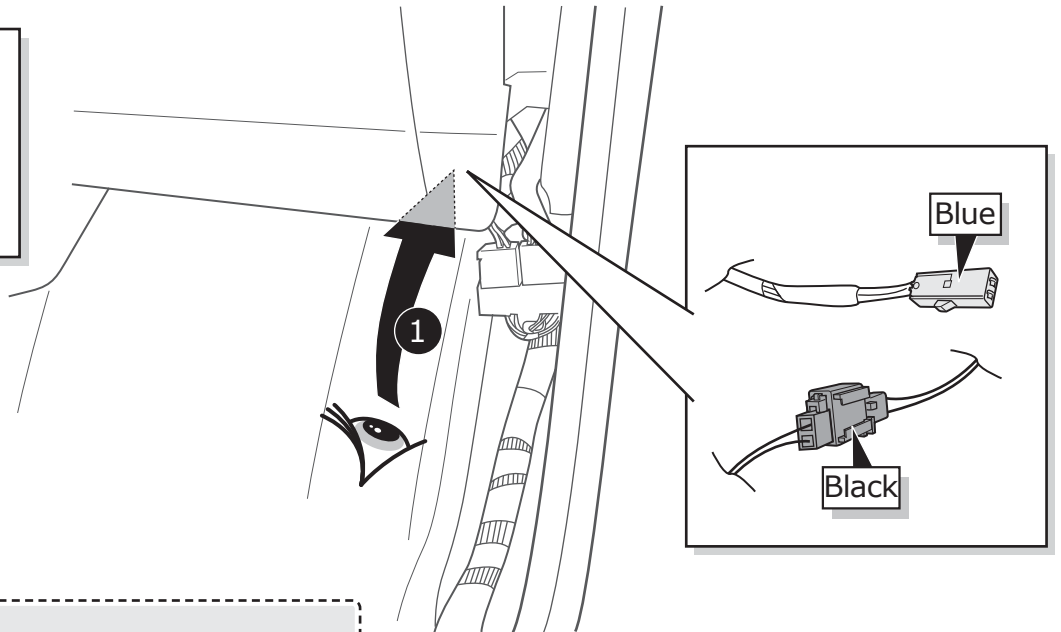
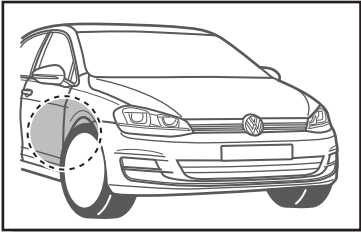



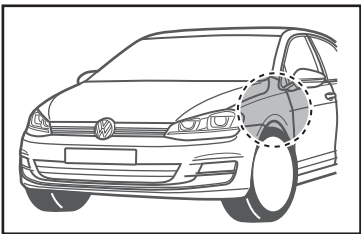
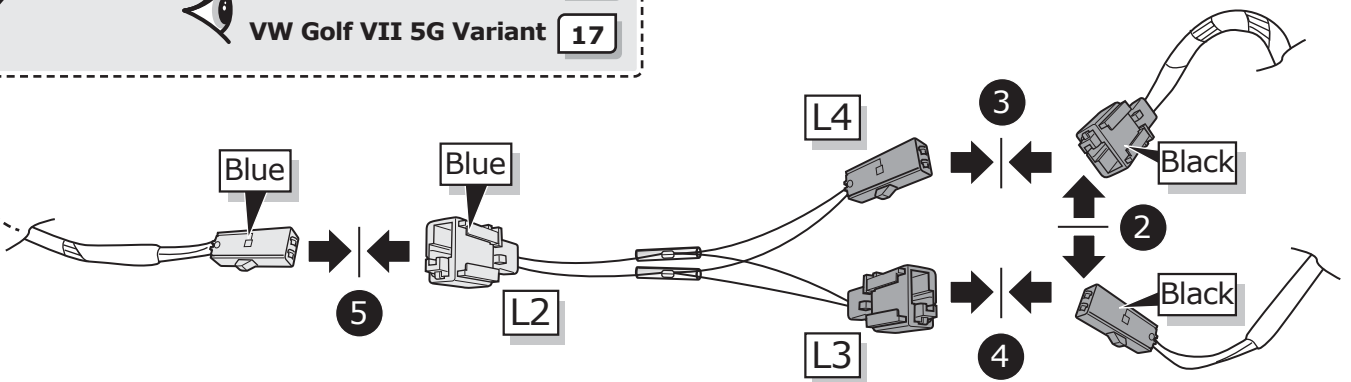

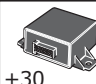

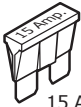
VW Golf VII 5G Limo 7
VW Golf VII 5G Variant 17



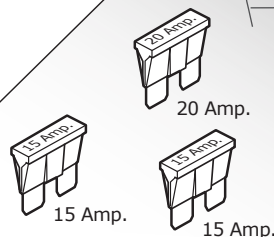

 20 Amp.
 Pos. 38

 +30

 15 Amp.
 Pos. 28

 +30

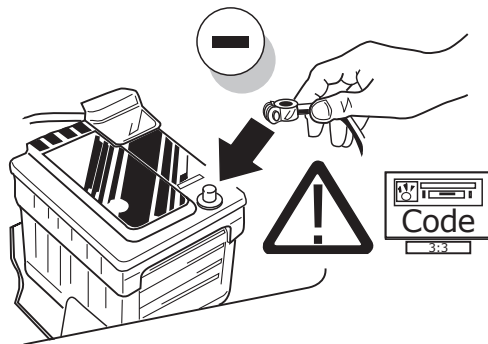
 15 Amp.
 Pos. 44

 +15



24



25

ONLINE CODING



26

! WARNING! IT MUST BE ENSURED THAT ALL THE REQUIREMENTS OF THE VEHICLE MANUFACTURER FOR CHANGES TO AND RETRO-FITTING ON THE VEHICLE AND/OR COOLING SYSTEM FOR THE OPERATION WITH A TRAILER ARE CARRIED OUT. SUBJECT TO CHANGE.

27

! TEST ALL THE CIRCUITS WITH A TEST DEVICE WITH THE CORRECT POWER LOAD FOR EACH FUNCTION. A TEST DEVICE WITH LED'S CANNOT BE USED FOR THIS PURPOSE.

INFO

REINSTALL TRIM.

28

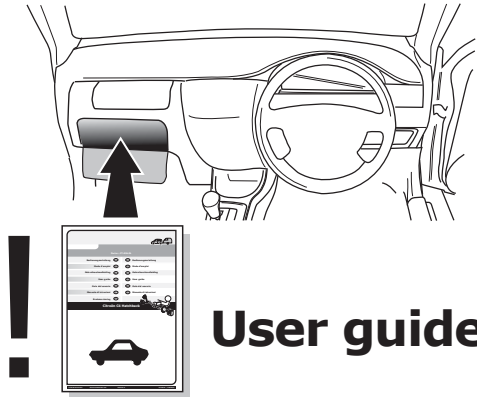

INFO

SOCKET CONNECTION

DIN/ISO 11446													
	1/L	2	3/31	4/R	5/58-R	6/54	7/58-L	8	9	10	11	12	13
Pmax	21W	21W		21W	42W	3x21W	42W	21W	180W/15Amp	180W/15Amp			
Colour	Black/ White	Blue	Brown	Black/ Green	Grey/ Red	Black/ Red	Grey/ Black	Black	Red	Yellow	Brown	Red/ Blue	Brown