

## Chevrolet Captiva 2006- Opel Antara 1-2007-

Partnr.: CH-003-DHU

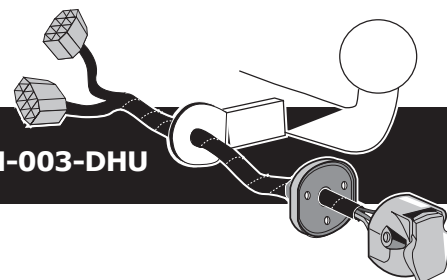

- Fitting instructions electric wiring kit tow bar with 13-P socket up to DIN/ISO Norm 11446.
- We would expressly point out that assembly not carried out properly by a competent installer will result in cancellation of any right to damage compensation, in particular those arising by virtue of the product liability act.
- Contents of these kits and their fitting manuals are subject to alteration without notice, please ensure that these instructions are read and fully understood before commencing installation.
- Do not overload circuits; the maximum loads per connection are detailed in this manual.
- Attention! Before Installation, please read this manual carefully and inform your customer to consult the vehicle owners manual to check for any vehicle modifications required before towing.
- In the event of functional problems, troubleshooting must be limited to about 0.5 hours, contact the technical support:  
[ukts@ecs-electronics.com](mailto:ukts@ecs-electronics.com) / 07440 202 052.



# Part list

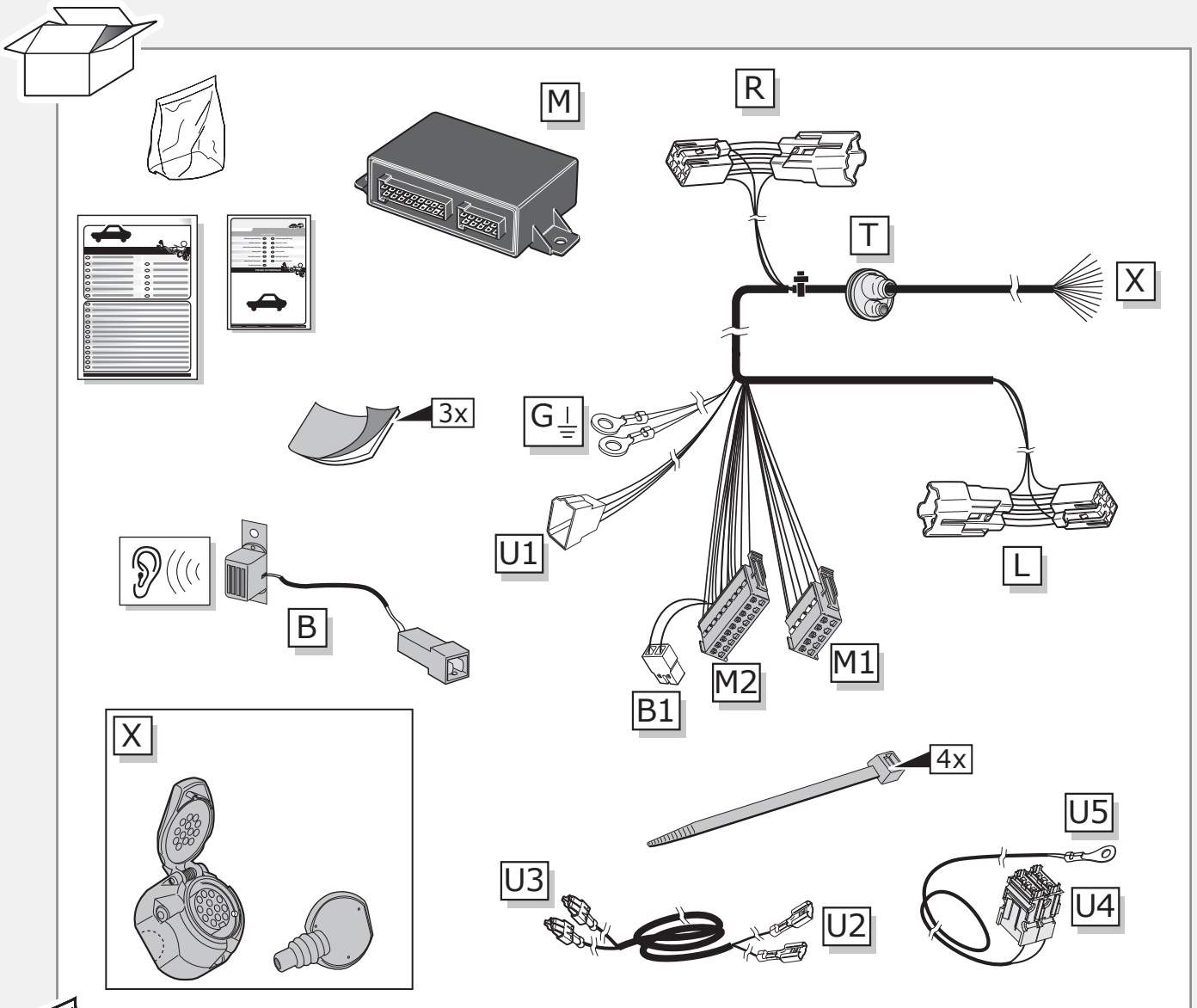

**\* OPTION P.D.C.**

**PARK DISTANCE CONTROL**

**PARK DISTANCE CONTROL**

**2x**

**Pag. 13**

- 3x**: Screw
- 3x**: Nut
- 1x**: Connector box
- 15x**: Wire
- 1x**: Connector box
- 1x**: Connector box
- 2x**: Connector box

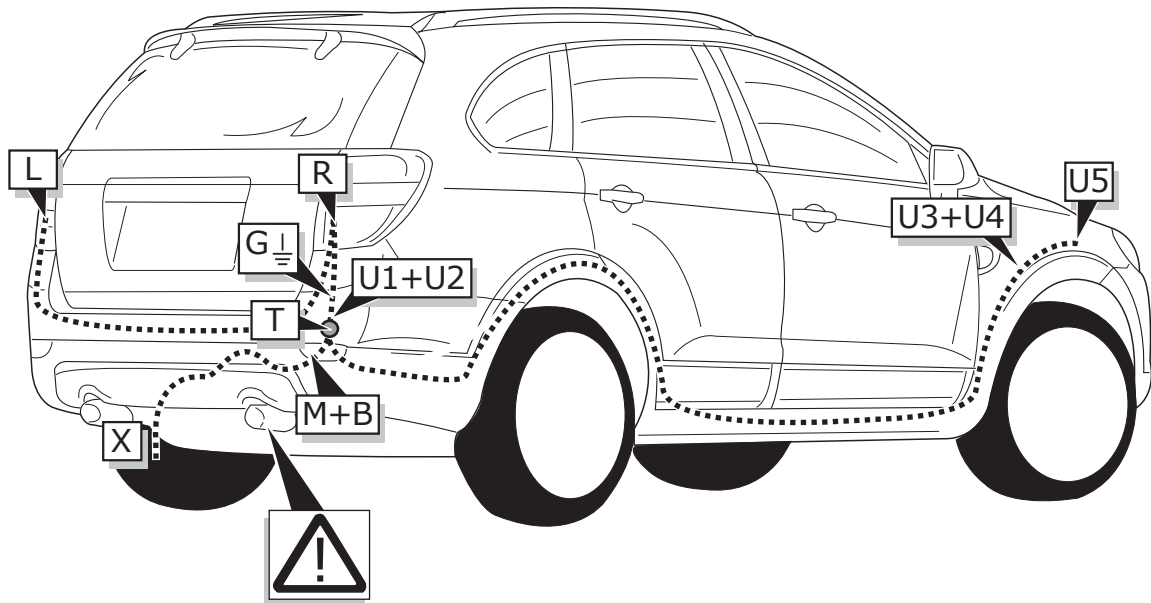

1

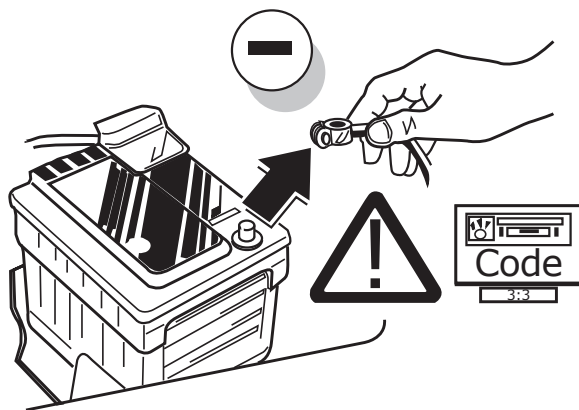

# Chevrolet Captiva

2

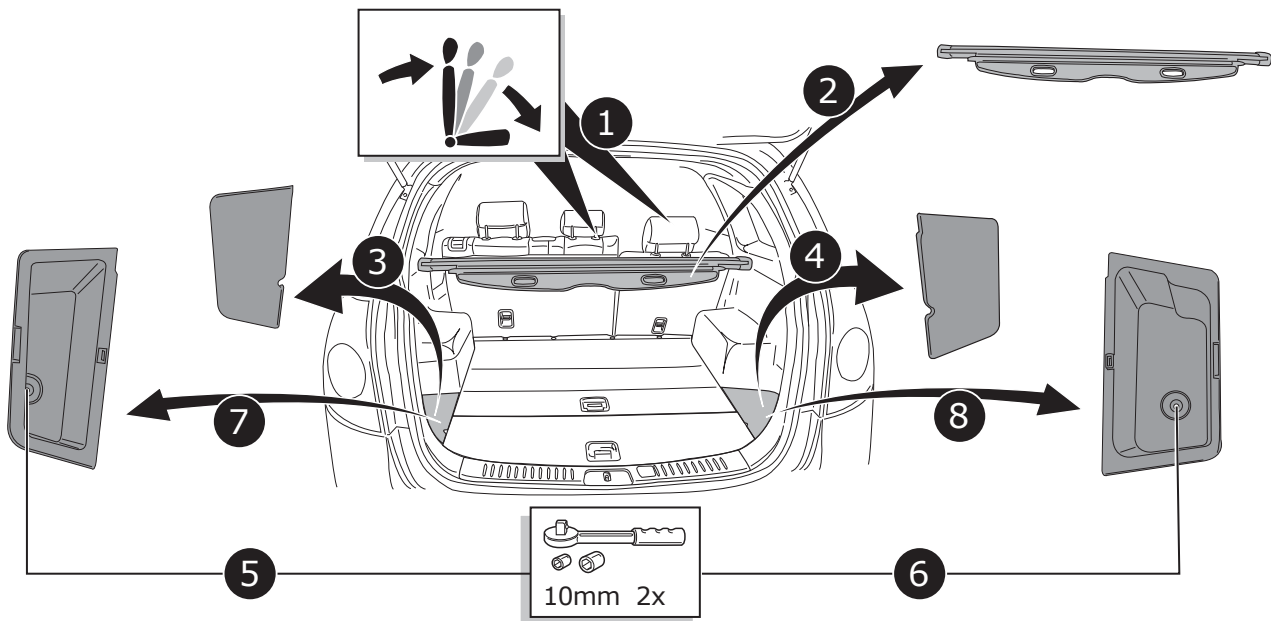

3

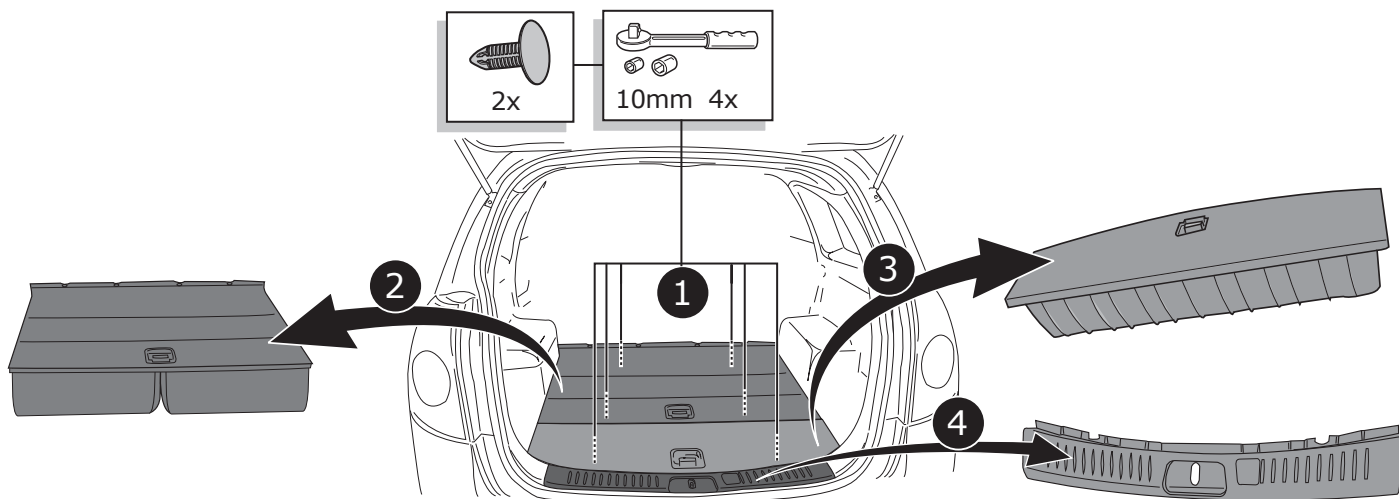

4

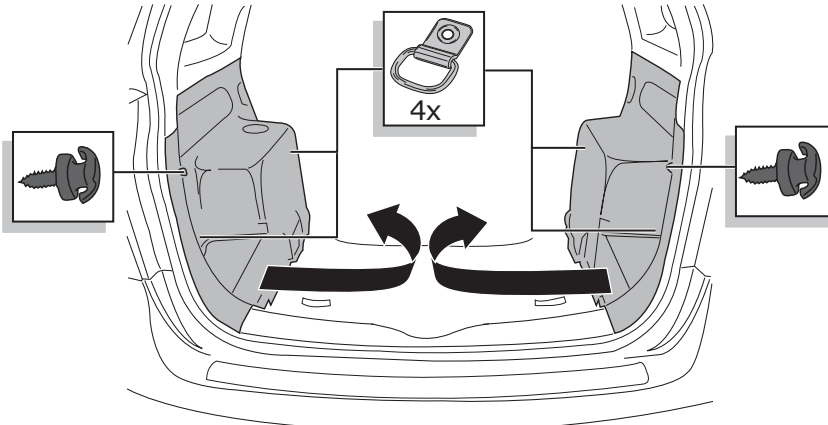

## Chevrolet Captiva

5

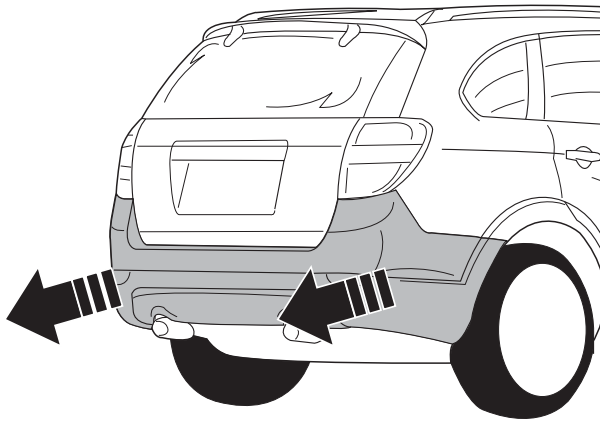

## Opel Antara

6

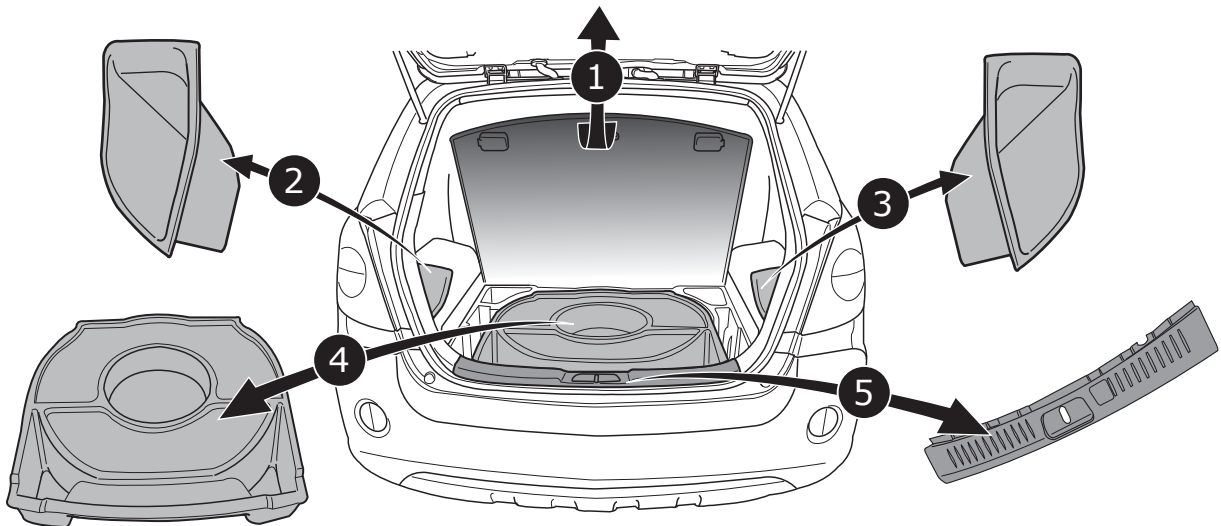

## Chevrolet Captiva & Opel Antara

7

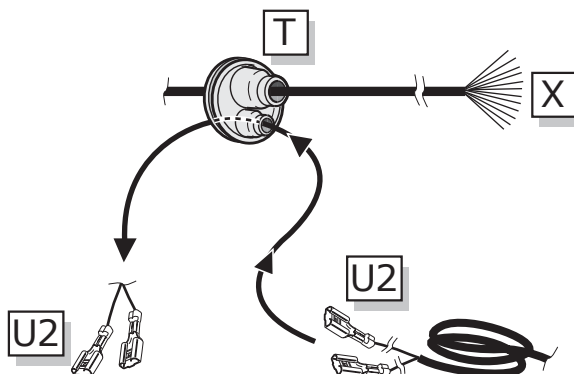

# Chevrolet Captiva

8

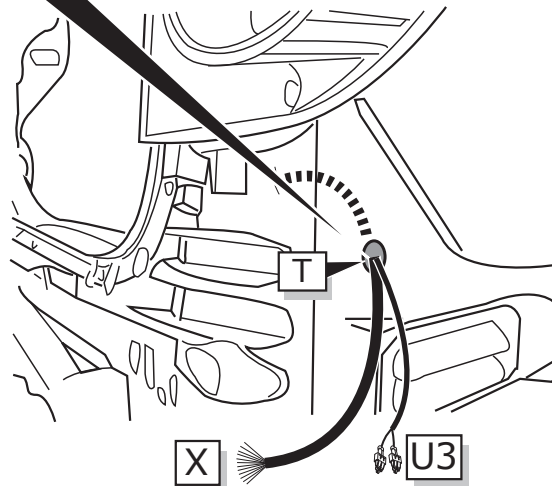
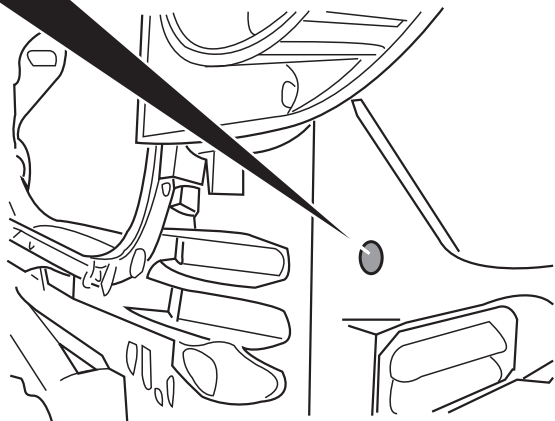
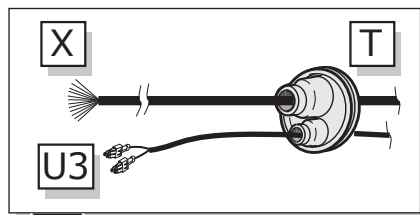
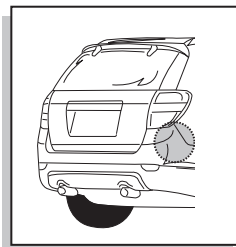
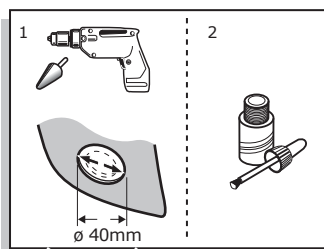

# Opel Antara

9

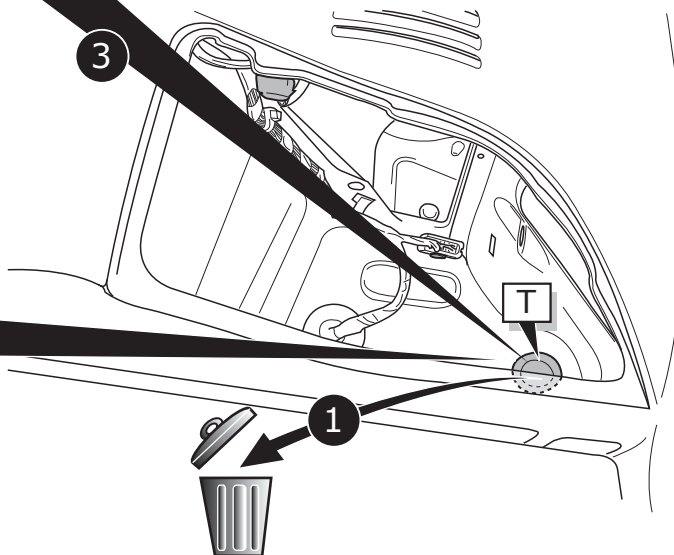
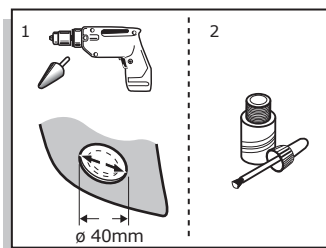
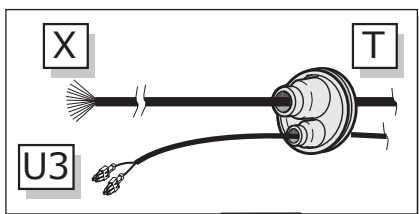
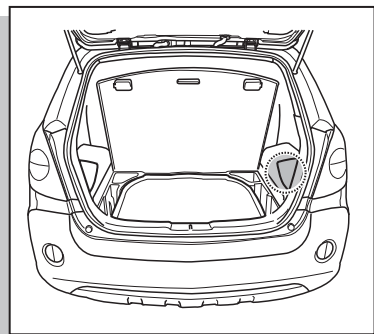

# Chevrolet Captiva & Opel Antara

**A**

Option 1

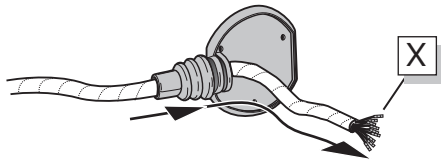

Option 2

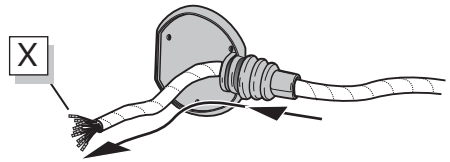

**B**

SOCKET CONNECTION



Pag. 12

**C**

Option 1

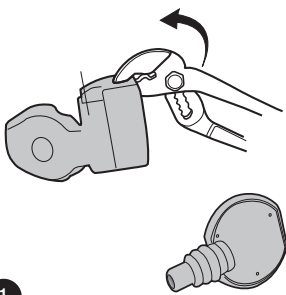

1

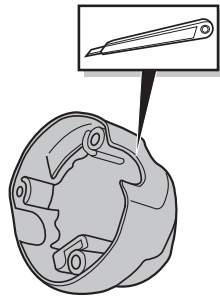

2

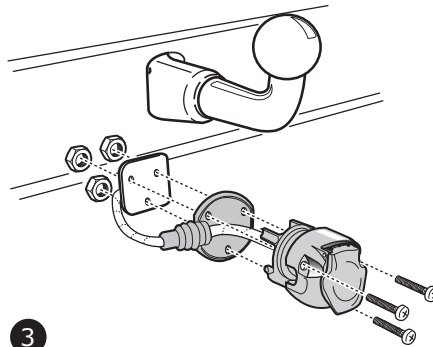

3

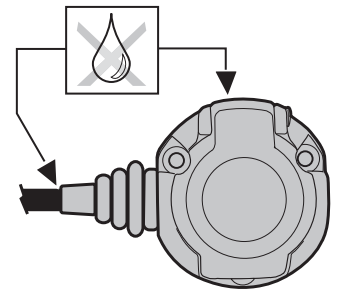

4

**D**

Option 2

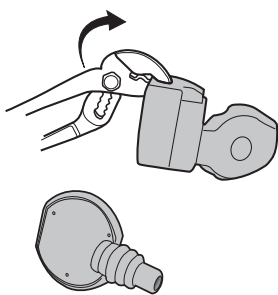

1

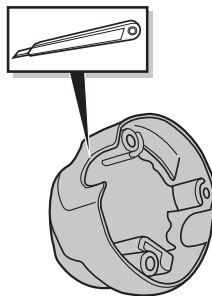

2

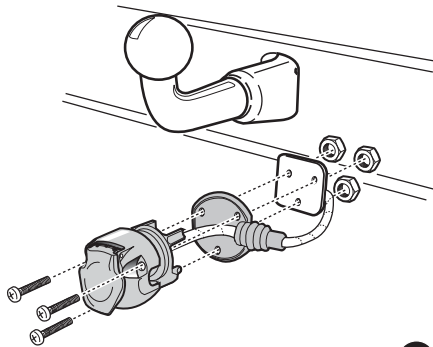

3

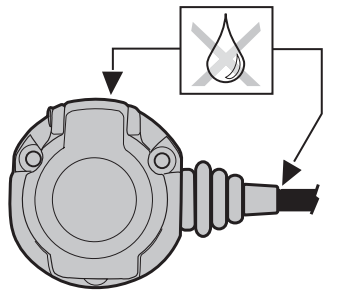

4

## Chevrolet Captiva

10

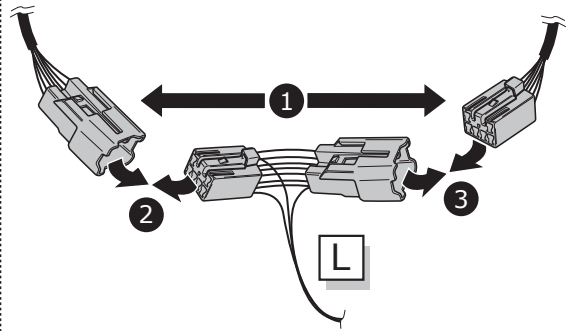
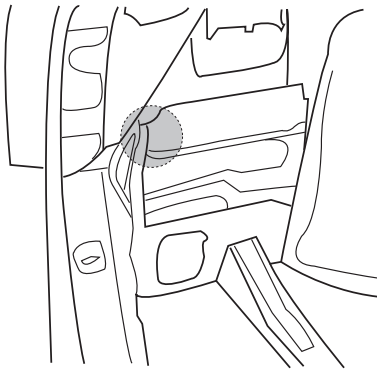
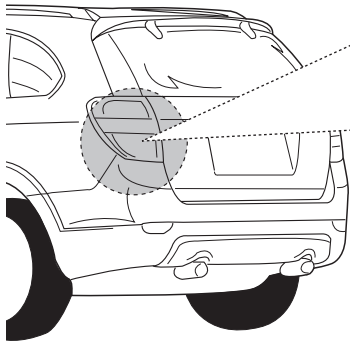

11

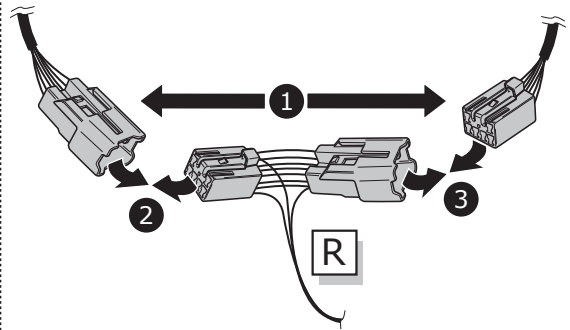
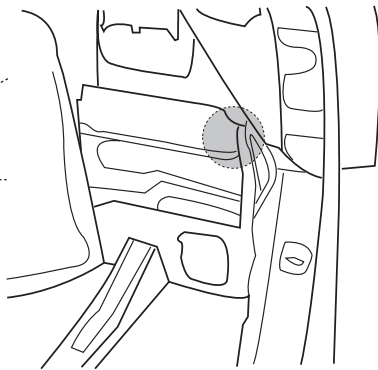
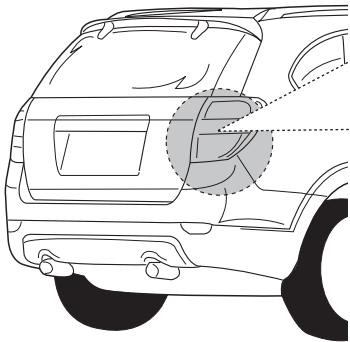

## Opel Antara

12

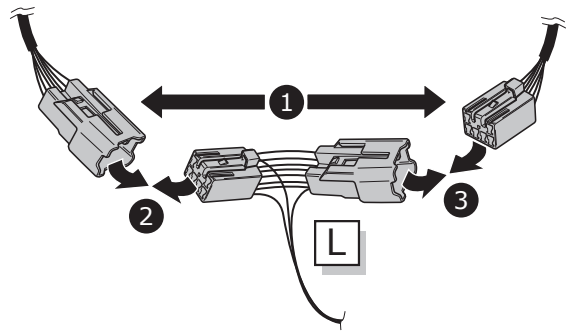
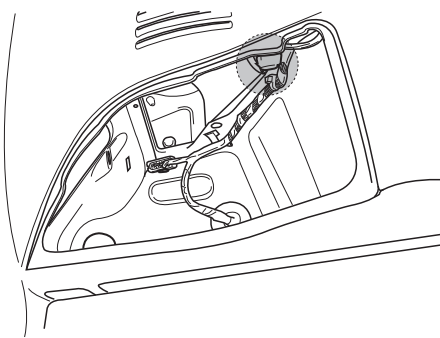
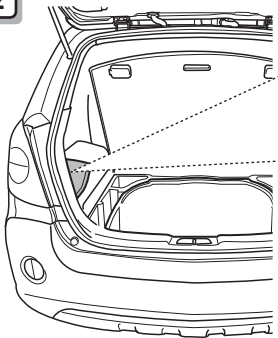

13

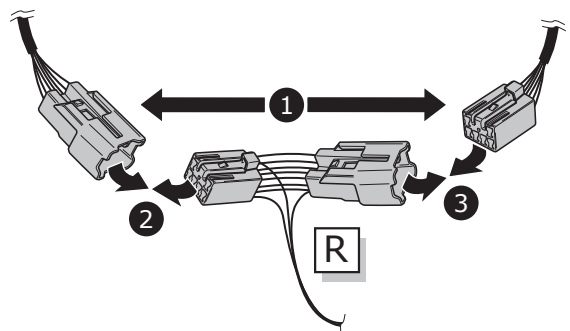
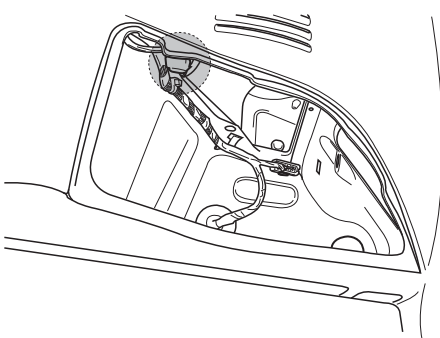
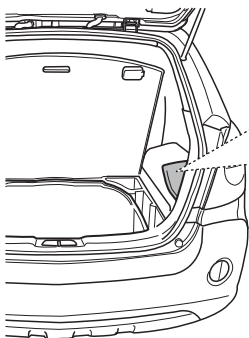



## Chevrolet Captiva

14

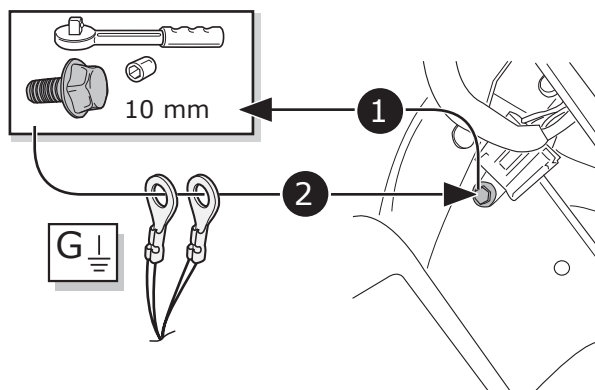
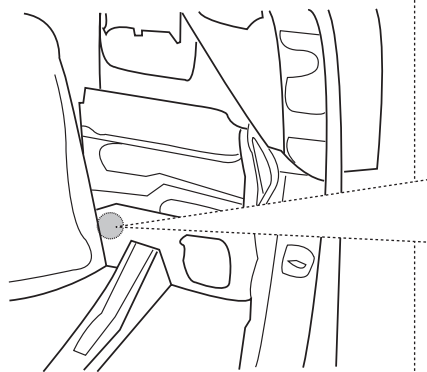

## Opel Antara

15

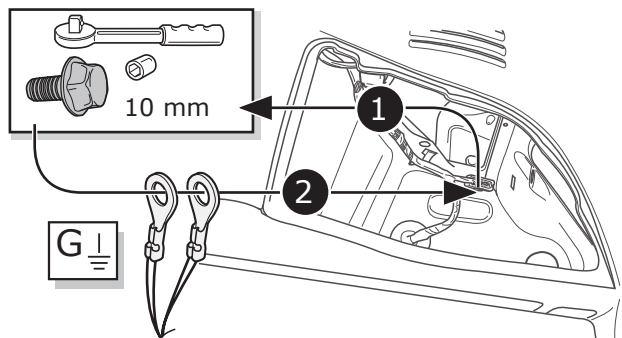
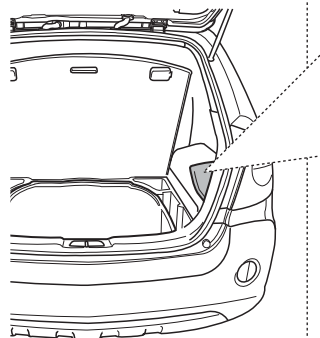

## Chevrolet Captiva & Opel Antara

16

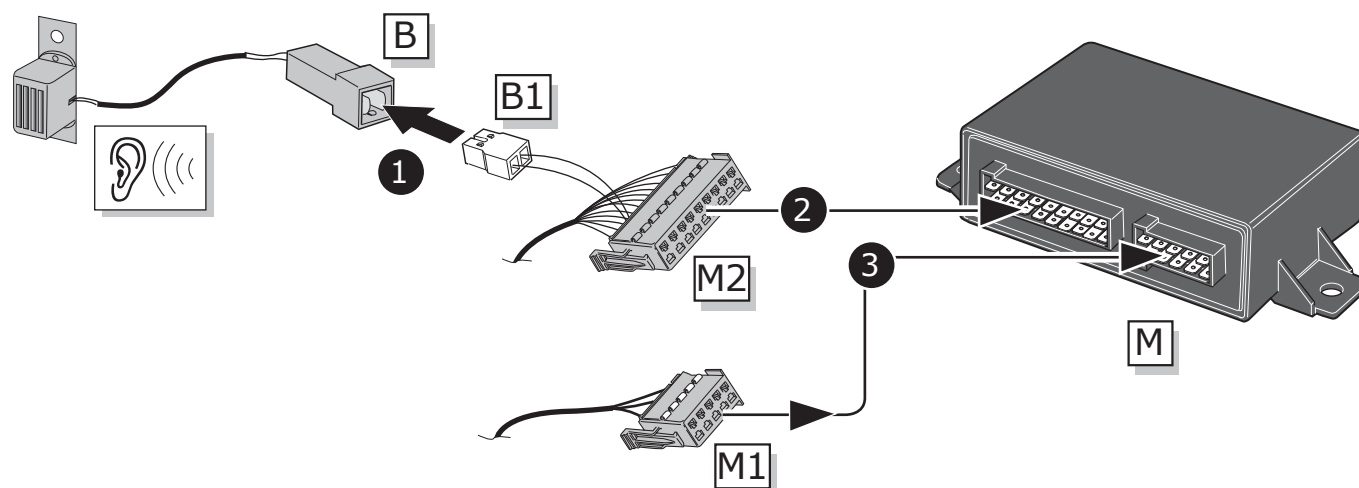

## Chevrolet Captiva & Opel Antara

17

1

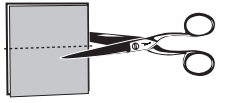

2

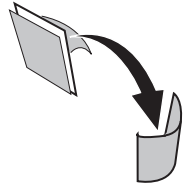

3

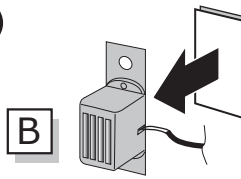

4

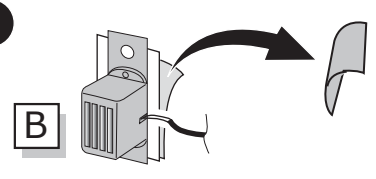

5

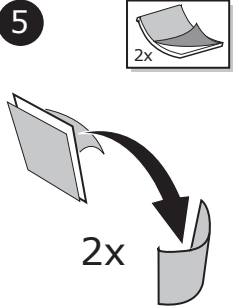

6

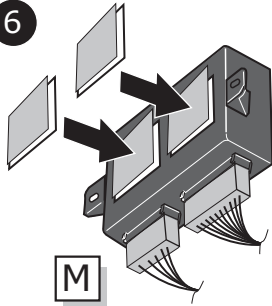

7

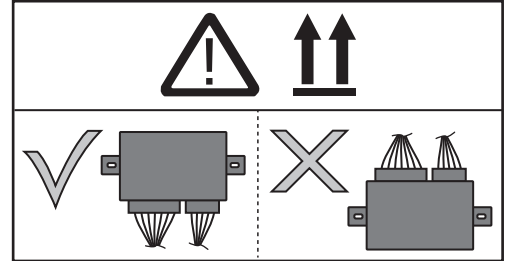
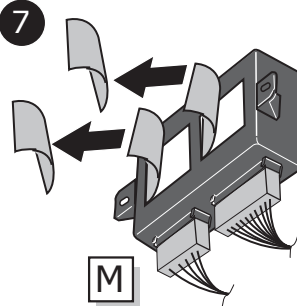

## Chevrolet Captiva

18

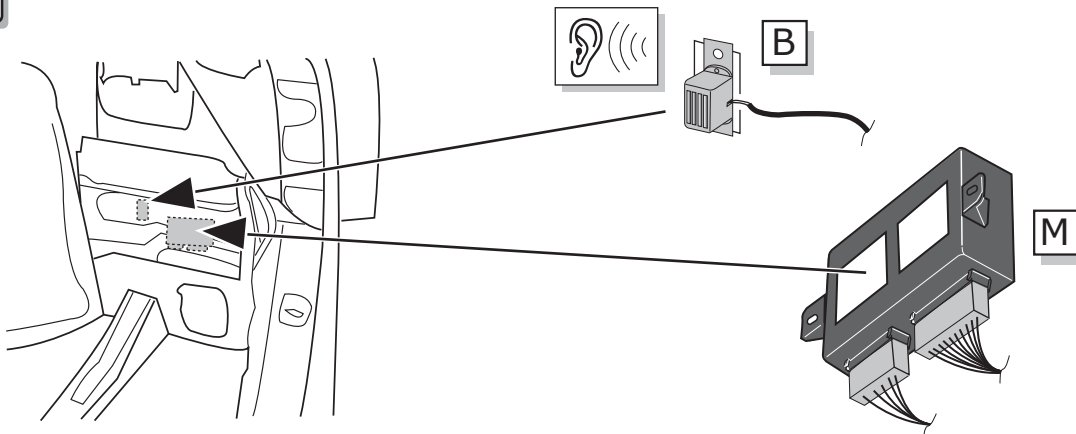

## Opel Antara

19

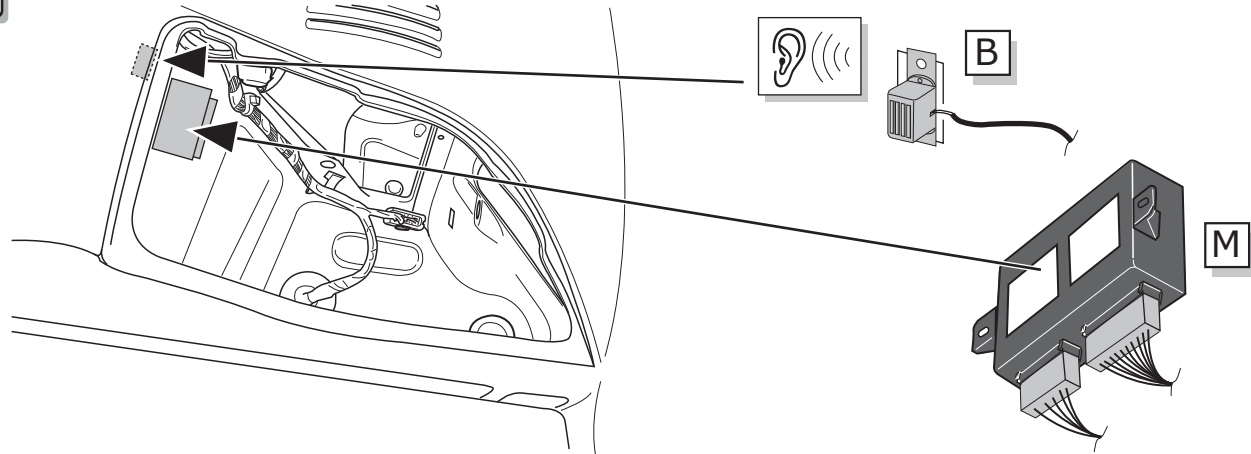

# Chevrolet Captiva & Opel Antara

20

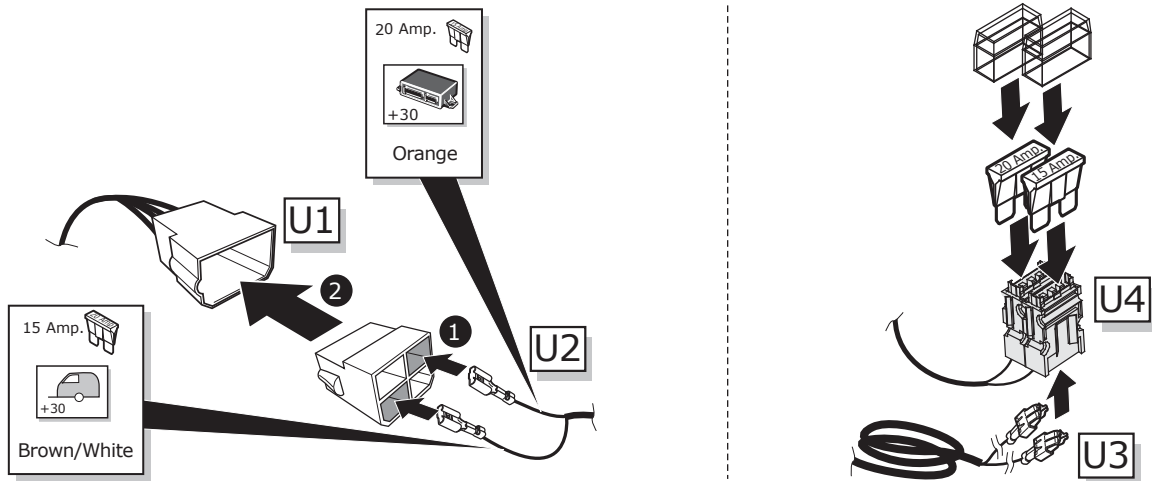

21

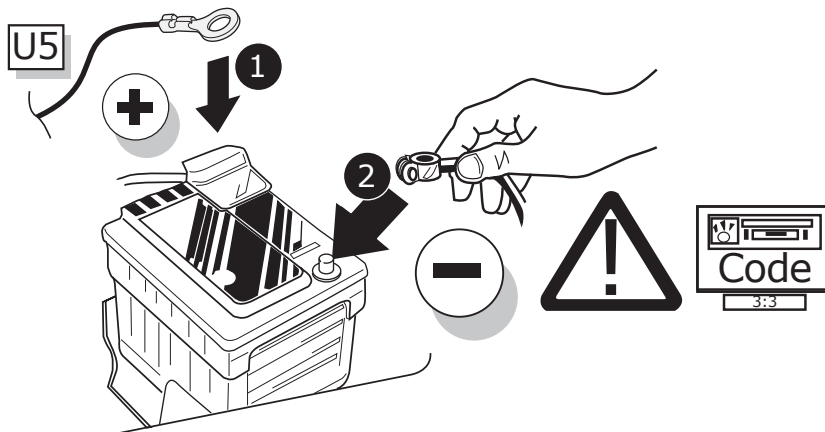

22



TEST ALL THE CIRCUITS WITH A TEST DEVICE WITH THE CORRECT POWER LOAD FOR EACH FUNCTION. A TEST DEVICE WITH LED'S CANNOT BE USED FOR THIS PURPOSE.

INFO

REINSTALL TRIM.

23

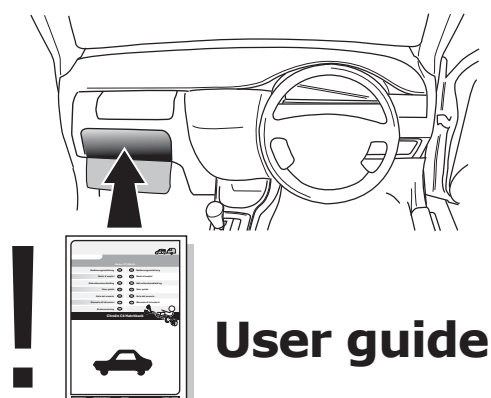

## INFO

### SOCKET CONNECTION

DIN/ISO 11446													
	1/L	2	3/31	4/R	5/58-R	6/54	7/58-L	8	9	10	11	12	13
Pmax	21W	2x21W		21W	52W	3x21W	52W	2x21W	180W/15Amp	180W/15Amp			
Colour	Yellow	Blue	White	Green	Brown	Red 1,00 mm <sup>2</sup>	Black	Black/ Red	Brown/ White	Red 2,50 mm <sup>2</sup>	White	Red/ Blue	White

